

FOR LEASE

35 HIGH STREET

BILLERICA, MA

33,066 SF
Class A Industrial Space



BUILDING SPECIFICATIONS

- + **Total Building:** 68,131 SF
- + **Total Available:** 33,066 SF
- + **Land Area:** 14.31 acres
- + **Year Built:** 1995
- + **Parking:** 20 spaces
- + **Construction:** Steel
- + **Roof:** Metal
- + **Clear Height:** 28'
- + **Power:** 1200A/277-480V
- + **Loading Docks:** Two loading docks, two drive-ins
- + **Sprinklers:** Dry



CONTACT US

DAVID CORKERY

First Vice President
+1 617 912 7036
david.corkery@cbre-ne.com

MARK REARDON

Executive Vice President/Partner
+1 617 912 7046
mark.reardon@cbre-ne.com

JAKE BORDEN

Vice President
+1 617 912 7057
jake.borden@cbre-ne.com

www.cbre-ne.com

CBRE | New England

35 HIGH STREET

BILLERICA, MA

FOR LEASE
33,066 SF
Class A Industrial Space



FLOOR PLAN

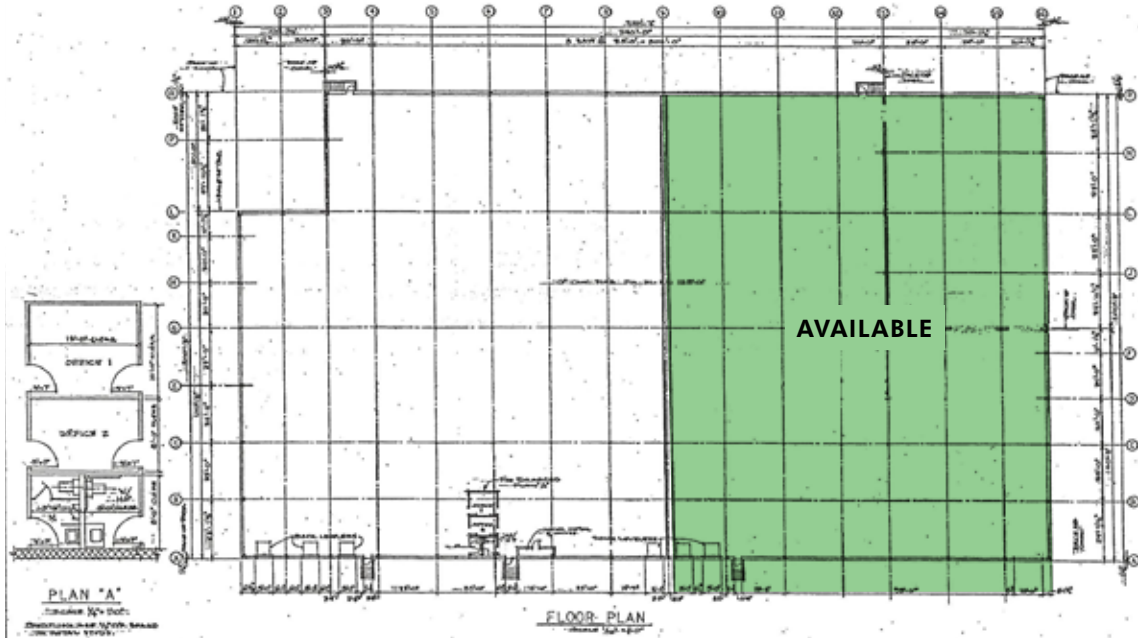

PROPERTY LOCATION

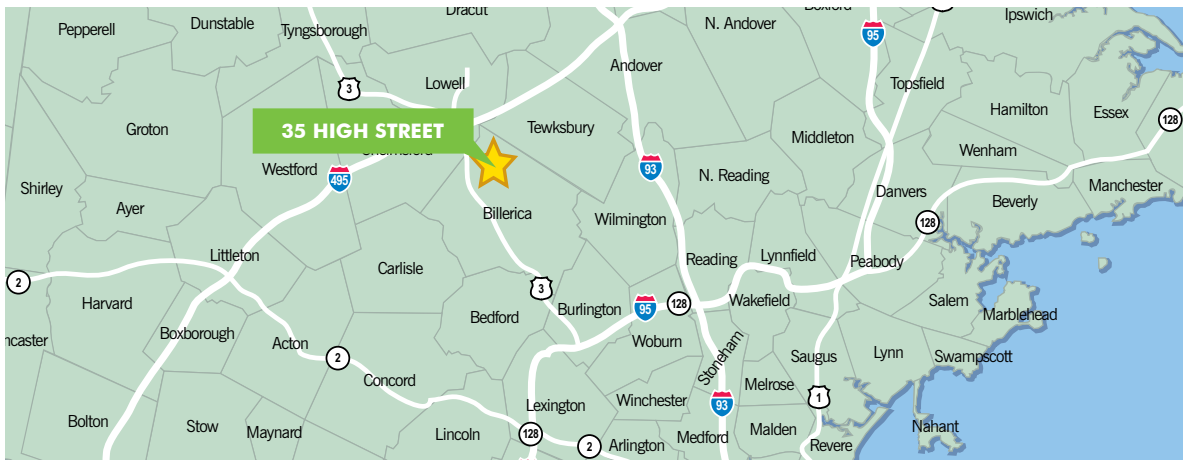

© 2018 CB Richard Ellis – N.E. Partners, LP. This information has been obtained from sources believed reliable. We have not verified it and make no guarantee, warranty or representation about it. Any projections, opinions, assumptions or estimates used are for example only and do not represent the current or future performance of the property. You and your advisors should conduct a careful, independent investigation of the property to determine to your satisfaction the suitability of the property for your needs. Photos herein are the property of their respective owners and use of these images without the express written consent of the owner is prohibited.

CBRE and the CBRE logo are service marks of CBRE, Inc. and/or its affiliated or related companies in the United States and other countries. All other marks displayed on this document are the property of their respective owners.

www.cbre-ne.com

CBRE | New England