

FOR SALE

12582 Lebanon Road, Mt. Juliet, TN 37122

Development Opportunity



615 THIRD AVE SOUTH
SUITE 500 | NASHVILLE, TN 37210
615 850 2700

For More
Information

RADLEY HENDRIXSON, CCIM

615 850 2745 | radley.hendrixson@colliers.com

SOHAILA WILLIS, CCIM

615 850 2757 | sohaila.willis@colliers.com

OVERVIEW

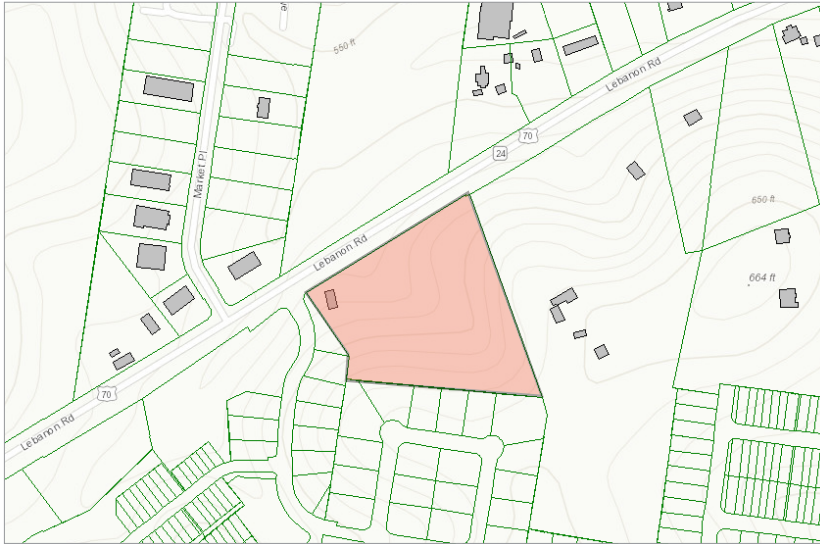

2019 DEMOGRAPHICS

	1 MILE	3 MILES	5 MILES
Population	1,303	37,435	85,828
Households	450	13,278	31,878
Average HH Income	\$103,400	\$85,315	\$79,102
Traffic Count	28,929 ADT on Lebanon Road		

SITE FEATURES | HIGHLIGHTS

- 7.2 Acres
- Located in the heart of Mt. Juliet
- Map 053 Parcel 102.00
- Adjoins Nichols Vale community (450 homes)
- Across the street from the new Green Hill High School
- Approximately 660' of road frontage on Lebanon Road
- All utilities at site
- Easy access

Sale Price: \$2,038,608

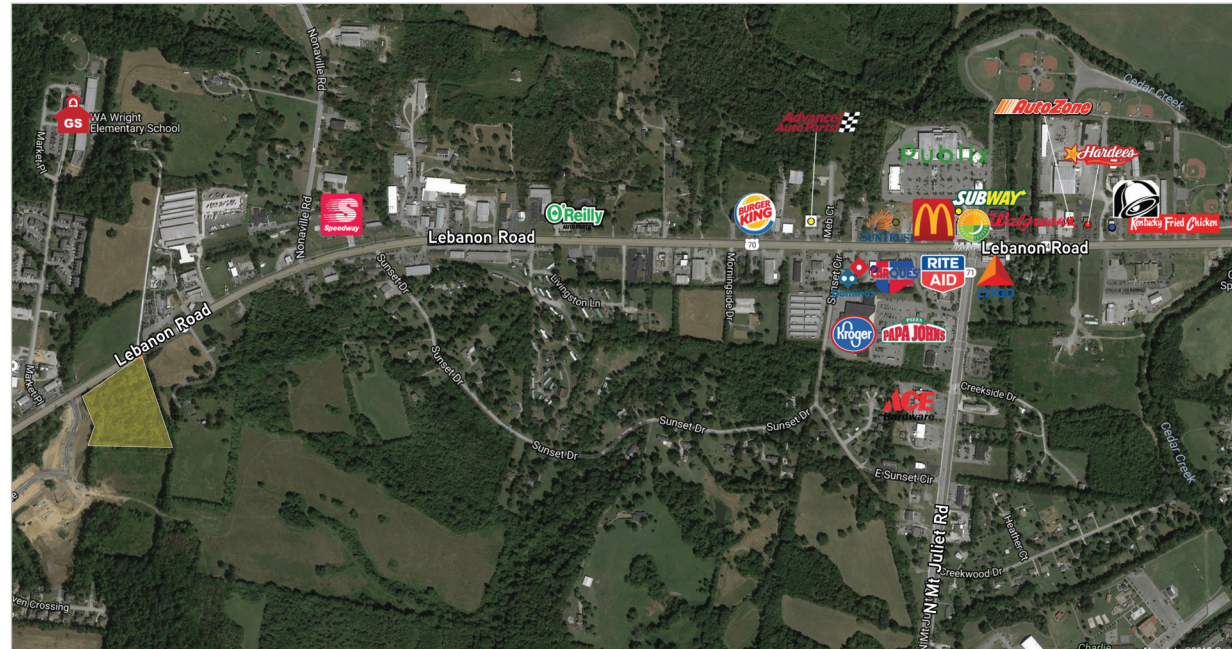

615 THIRD AVE SOUTH
SUITE 500 | NASHVILLE, TN 37210
615 850 2700

For More
Information

RADLEY HENDRIXSON, CCIM

615 850 2745 | radley.hendrixson@colliers.com

SOHAILA WILLIS, CCIM

615 850 2757 | sohaila.willis@colliers.com