

16,900 SF

Industrial Space For Lease



Prologis Meadowlands

300-330 Murray Hill Parkway
East Rutherford, NJ 07073



LOCATION

- Immediate access to NJ Turnpike Exit 16W, Interstate 80, Route 3, and Route 46
- ± 10 miles to New York City via Lincoln and Holland Tunnels
- ± 15 miles from Newark Liberty International Airport and Port Newark-Elizabeth
- 1 mile from Rutherford Train Station and 1 block from NJ Transit bus stop

FACILITY

- 49,210 SF total building size
- 16,900 SF available space
- 1,505 SF office
- 20' clear height
- 30' x 41' 6" column spacing
- 2 dock doors
- Power: 200 amps, 480/277 volts
- Wet sprinkler system

ADVANTAGES & AMENITIES

- Prologis Clear Lease® – Know your lease expenses and capital costs with greater certainty before you sign
- Fast, cost-effective forklift and racking sourcing through Prologis Essentials

16,900 SF

Industrial Space For Lease

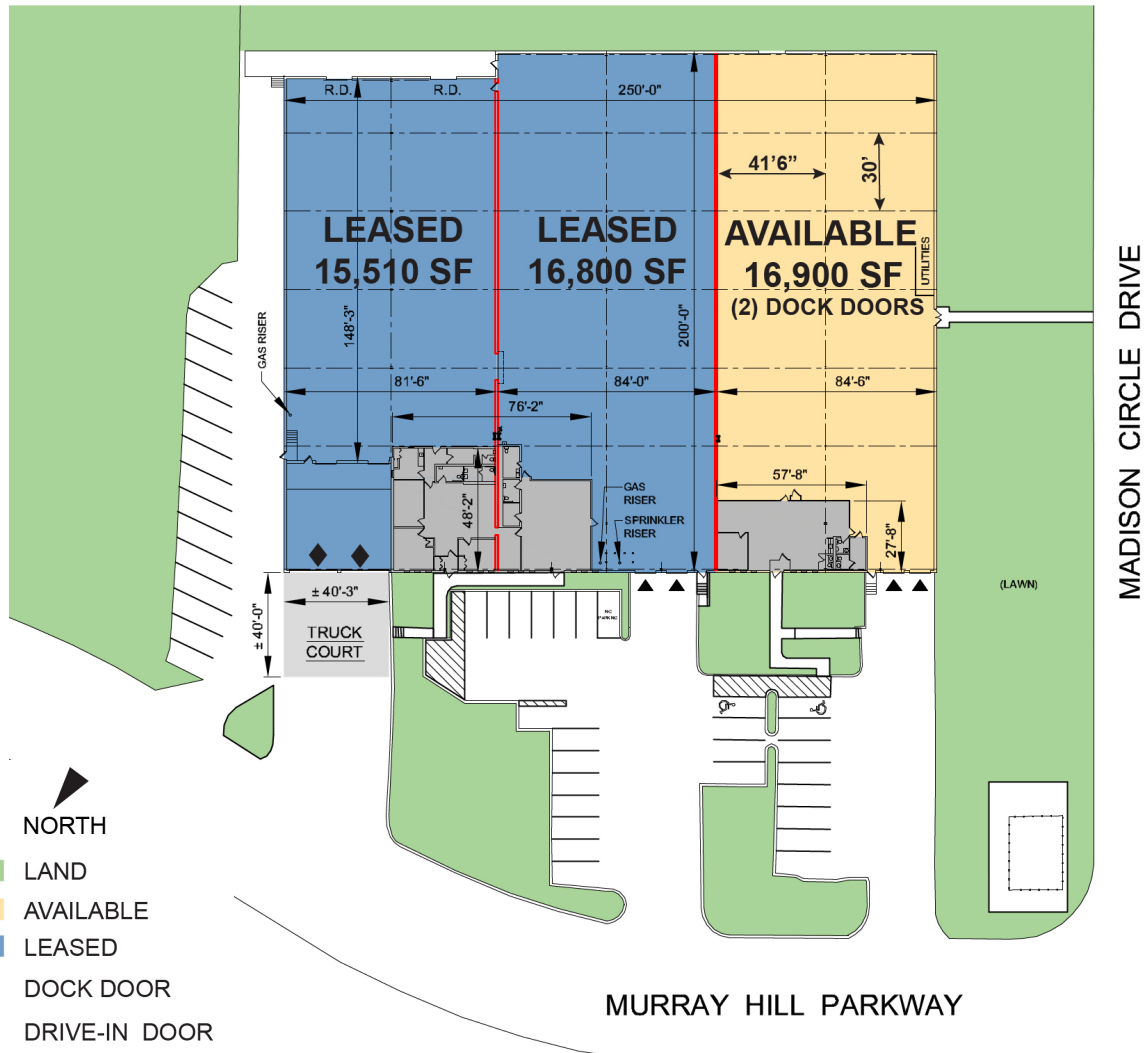

www.PrologisMeadowlands.com



CBRE, Inc.
Thomas F. Monahan
thomas.monahan@cbre.com
ph +1 201 712 5610
cell +1 973 568 6614
Park 80 West
Plaza Two
Saddle Brook, NJ 07663 USA

CBRE, Inc.
Stephen D'Amato
stephen.damato@cbre.com
ph +1 201 712 5616
cell +1 201 306 3788
Park 80 West
Plaza Two
Saddle Brook, NJ 07663 USA

CBRE, Inc.
Larry Schiffenhaus
larry.schiffenhaus@cbre.com
ph +1 201 712 5809
cell +1 201 532 5092
Park 80 West
Plaza Two
Saddle Brook, NJ 07663 USA

Prologis
Sarah Rutherford
srutherford@prologis.com
ph +1 201 528 9576
cell +1 551 206 6985
One Meadowlands Plaza
Suite 100
East Rutherford, NJ 07073 USA