

# Medical Office Space for Lease

5340 Elvas Avenue, Suite 100, Sacramento



## ±1,187 Square Feet Available

I am pleased to offer the following space:

Medical office suite available in the Elvas Medical Plaza. The property includes a serene courtyard garden setting and ample shaded parking.

Located on Elvas Avenue, the property is situated just moments from Sacramento State University and Sacramento's Midtown Hospitals.

- ◆ Ideally Situated Between Sacramento State University and Midtown Hospitals
- ◆ Fully Built-Out for Medical Use (including plumbing in all exam rooms!)
- ◆ Ample On-Site Parking
- ◆ Very Good Demographics
- ◆ \$2.10 Per Square Foot, Full Service

Sue Nelson 916.367.6352 [snelson@newmarkccarey.com](mailto:snelson@newmarkccarey.com) CA RE License #01413052

**Newmark  
Cornish & Carey**

3005 Douglas Boulevard, Suite 130, Roseville, CA 95661

[www.newmarkccarey.com](http://www.newmarkccarey.com)

# Medical Office Space for Lease

5340 Elvas Avenue, Suite 100, Sacramento



Suite 100 – ±1,187 SF

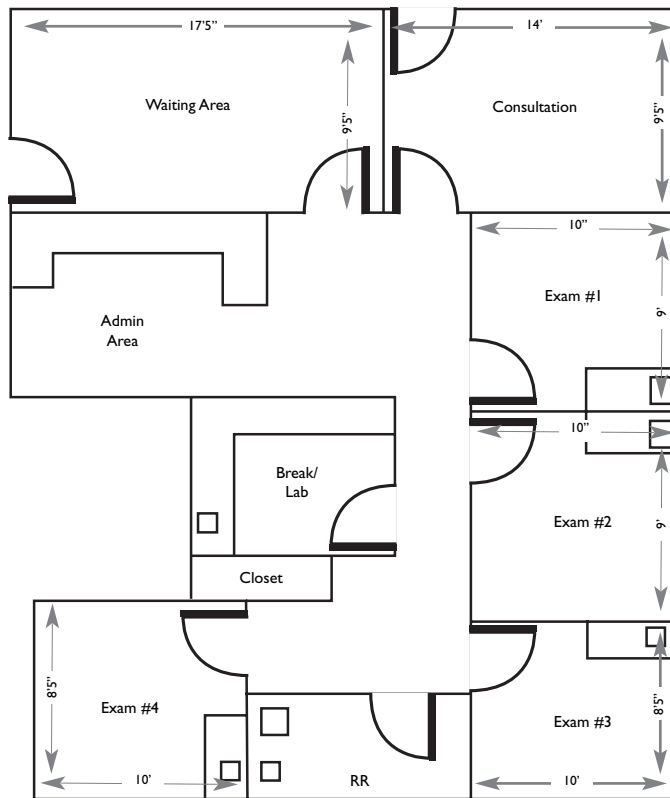

\* All dimensions are approximate.



Sue Nelson 916.367.6352 [snelson@newmarkccarey.com](mailto:snelson@newmarkccarey.com) CA RE License #01413052

**Newmark  
Cornish & Carey**

3005 Douglas Boulevard, Suite 130, Roseville, CA 95661

[www.newmarkccarey.com](http://www.newmarkccarey.com)

The information contained herein has been obtained from sources deemed reliable but has not been verified and no guarantee, warranty or representation, either express or implied, is made with respect to such information. Terms of sale or lease and availability are subject to change or withdrawal without notice.

08-1191-06/17