

PRIME RETAIL SPACE ADJACENT TO KOHL'S

Southaven, MS 38671 | 1160 Goodman Rd E | Goodman Rd E & Swinnea Rd | #719

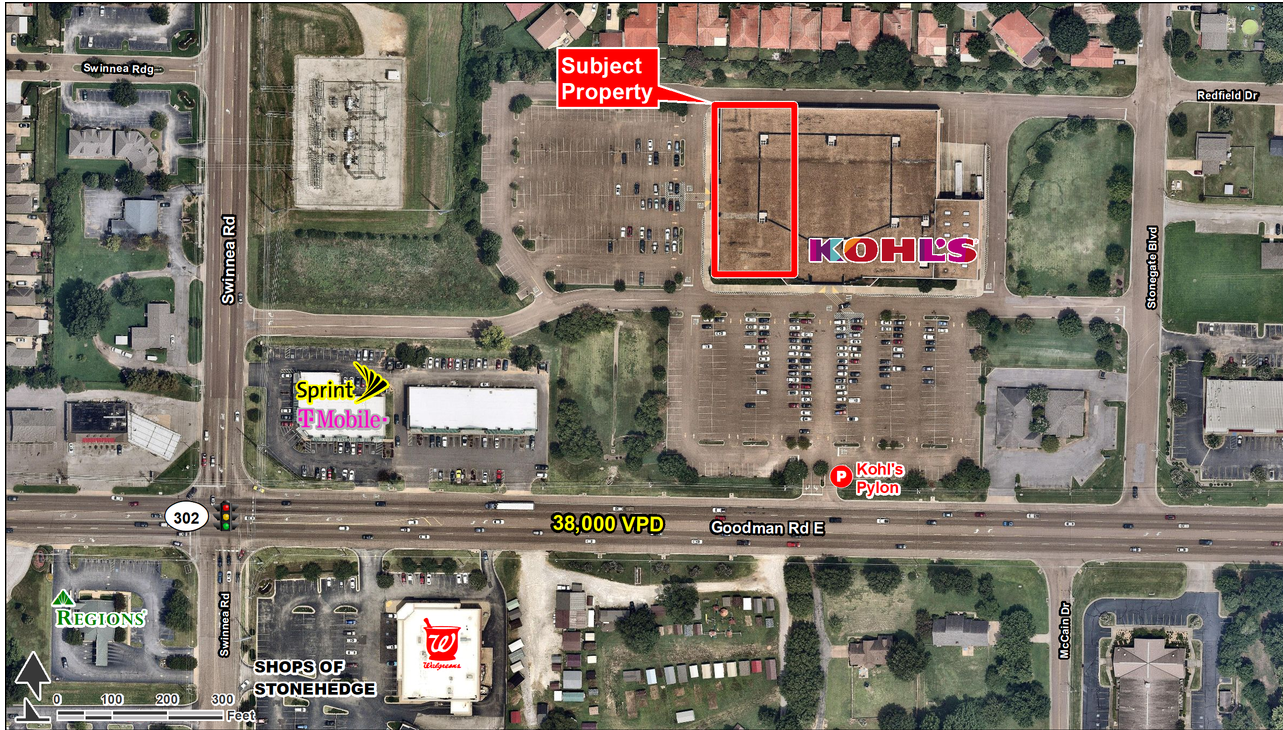

AVAILABLE SF:
24,300 SF

FRONTAGE:
APPROX 97' 5"

ZONING:
COMMERCIAL

RATES:
CALL FOR DETAILS

- 24,300 SF ± space available adjacent to Kohl's
- Located on Goodman Road, the primary east/west corridor in Desoto County
- Great co-tenant that generates high volume of daily customer traffic
- Abundant parking and great visibility

DEMOGRAPHICS	1 MILE	3 MILES	5 MILES	TRAFFIC COUNTS	
2018 POPULATION	38,142	101,111	169,214	I-55	63,000
2018 DAYTIME POPULATION	42,417	91,761	208,422	Goodman Rd E	38,000 VPD
2018 AVERAGE HH INCOME	\$67,625	\$63,822	\$60,947	Swinnea Rd	8,800 VPD
2018 MEDIAN HH INCOME	\$56,197	\$51,761	\$48,091		

AREA ANCHORS



FOR MORE INFORMATION, CONTACT EXCLUSIVE AGENT(S):
JOHN REED • john.reed@tscg.com • 901.334.5704



PRIME RETAIL SPACE ADJACENT TO KOHL'S

Southaven, MS 38671 | 1160 Goodman Rd E | Goodman Rd E & Swinnea Rd | #719

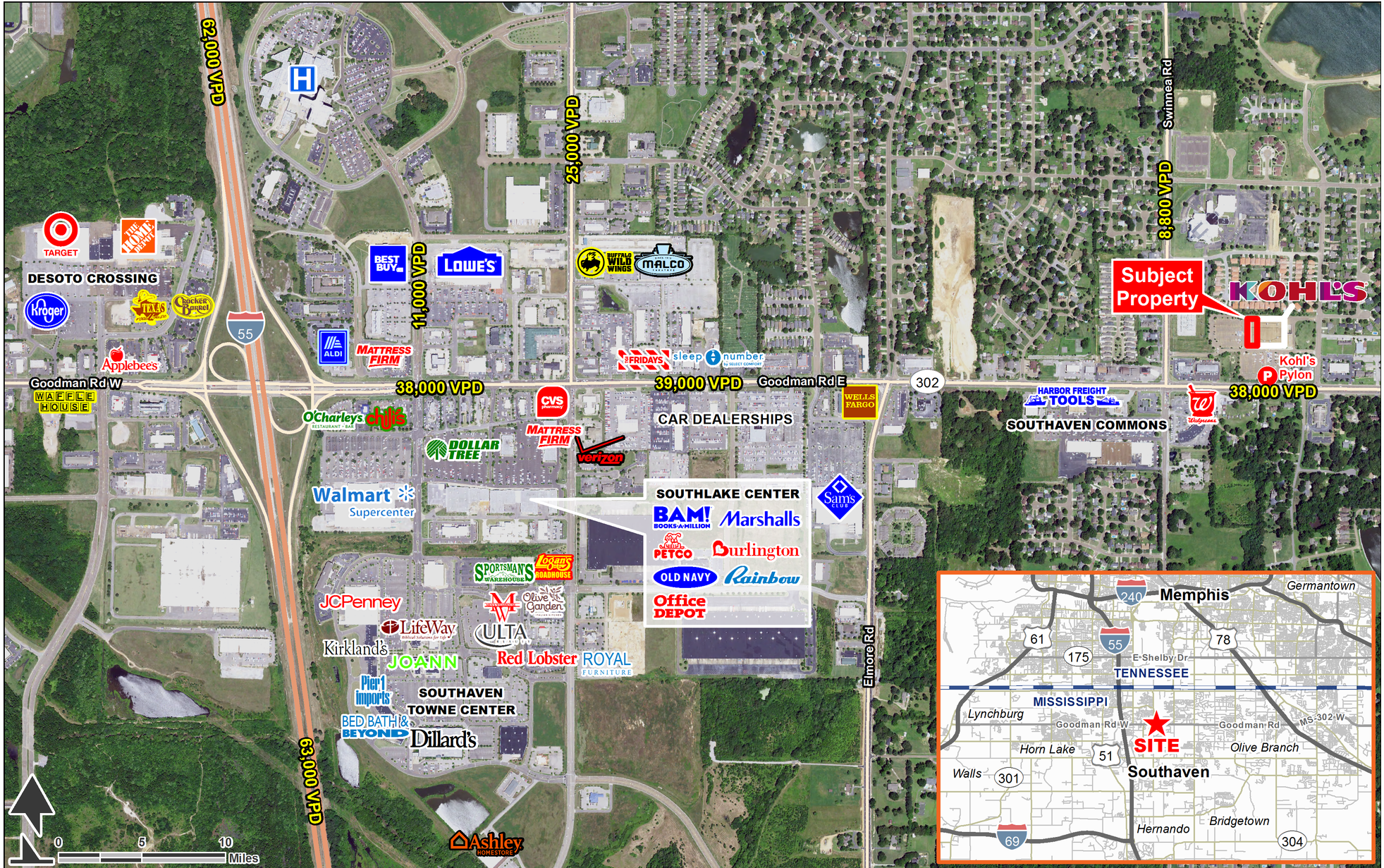

FOR MORE INFORMATION, CONTACT EXCLUSIVE AGENT(S):
 JOHN REED • john.reed@tscg.com • 901.334.5704



Demographics: Esri 2018 No warranty expressed or implied has been made as to the accuracy of the information provided herein, no liability assumed for error or omissions.

PRIME RETAIL SPACE ADJACENT TO KOHL'S

Southaven, MS 38671 | 1160 Goodman Rd E | Goodman Rd E & Swinnea Rd | #719



FOR MORE INFORMATION, CONTACT EXCLUSIVE AGENT(S):
JOHN REED • john.reed@tscg.com • 901.334.5704



Demographics: Esri 2018 No warranty expressed or implied has been made as to the accuracy of the information provided herein, no liability assumed for error or omissions.

PRIME RETAIL SPACE ADJACENT TO KOHL'S

Southaven, MS 38671 | 1160 Goodman Rd E | Goodman Rd E & Swinnea Rd | #719

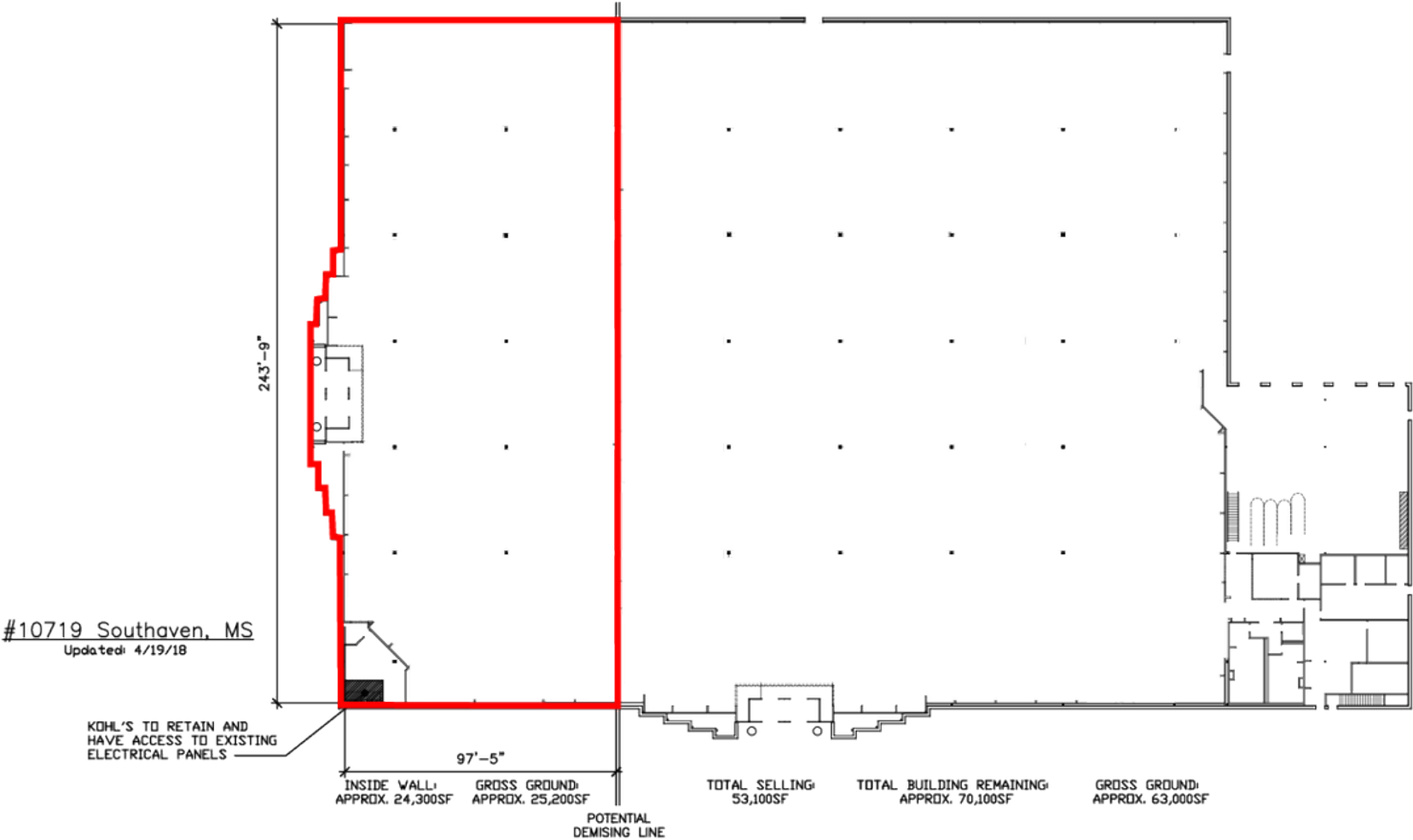

FOR MORE INFORMATION, CONTACT EXCLUSIVE AGENT(S):
JOHN REED • john.reed@tscg.com • 901.334.5704



Demographics: Esri 2018 No warranty expressed or implied has been made as to the accuracy of the information provided herein, no liability assumed for error or omissions.