

62 Joseph Street Moonachie, NJ



FOR LEASE

PROPERTY SPECS:

Available Space: 24,525 SF

Total Building Size: 45,600 SF

Office Space: +/- 1,500 SF

Ceiling Height: 18' Clear

Loading: 2 tailgates, 1 drive-in

Lease Rate: \$8.75 PSF NNN

Taxes: \$1.60 PSF

Availability: June 2018

Columns: 40' x 25'

Lot Size: 2.98 acres

Sprinkler: Wet

Heat: Gas

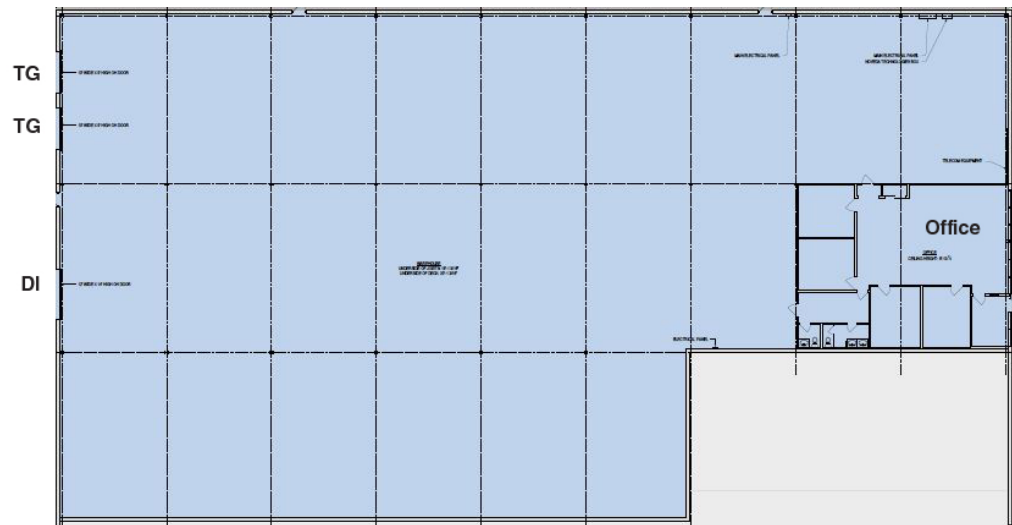

Comments: Well-maintained industrial building. Convenient to Routes 46, 80, 17, 3 as well as the Garden State Parkway and the NJ Turnpike.

For more information, please contact:

Gregory Sabato
gsabato@resource-realty.com

Scott Peck, SIOR
speck@resource-realty.com

Exclusive Leasing Agent:



973-299-0900

www.resource-realty.com

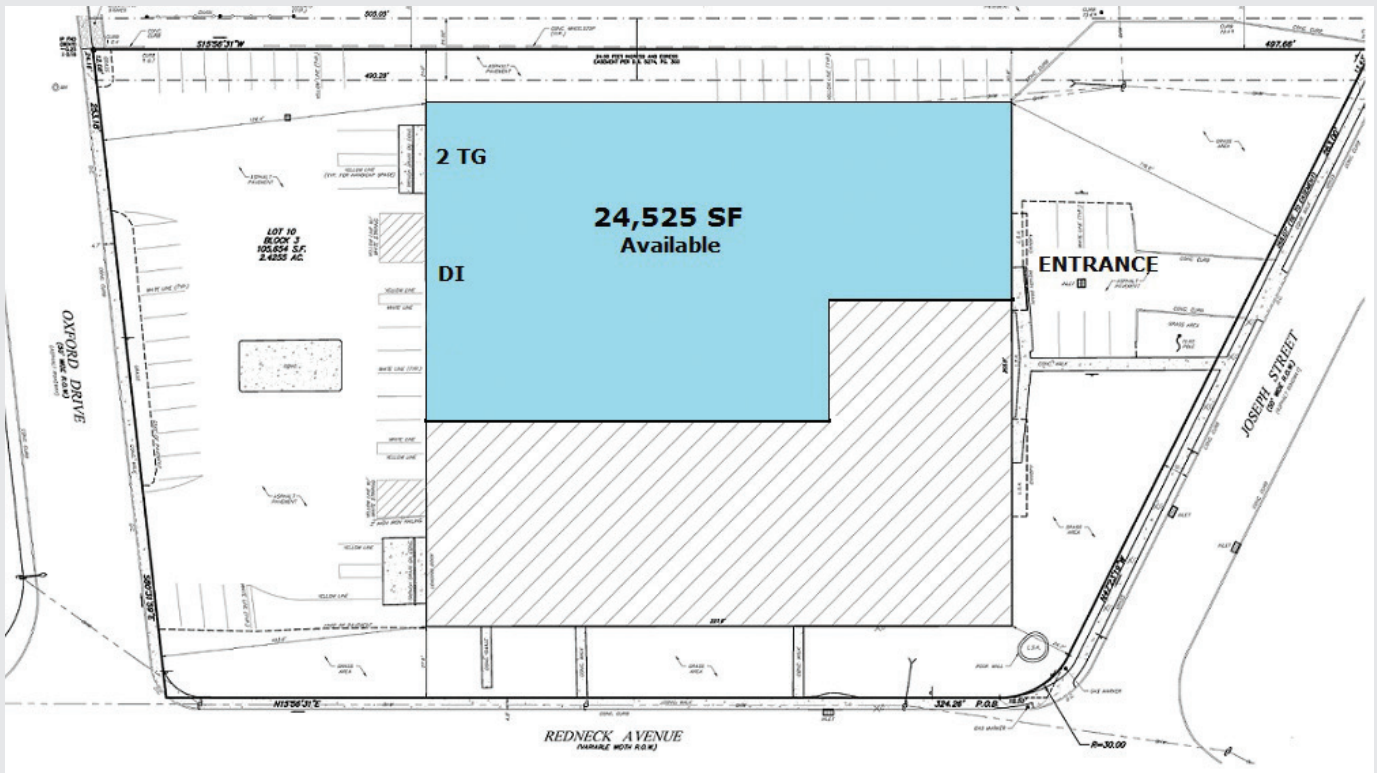

All information furnished is from sources deemed reliable. No representation is made as to the accuracy thereof and it is submitted subject to error, omission, change of price, prior sale or lease and withdrawal without notice. Any commission due cooperating brokers is subject to all of the terms and conditions upon which we and our clients have agreed.

Exclusive Leasing Agent:



973-299-0900
www.resource-realty.com