

AVAILABLE FOR LEASE  
3625 SWENSON AVENUE  
ST. CHARLES, ILLINOIS 60174



**BUILDING SPECIFICATIONS:**

<b>BUILDING SIZE:</b>	114,560 SF
<b>TOTAL AVAILABLE:</b>	28,800 SF
<b>OFFICE:</b>	To Suit
<b>CLEAR HEIGHT:</b>	22'
<b>LOADING:</b>	2 Interior Docks // 1 Drive-in Door
<b>PARKING:</b>	103 Surface Spaces, Incl. 4 HC; Ratio of 0.96 / 1,000 SF
<b>COLUMN SPACING:</b>	40'W x 40'D
<b>TAXES:</b>	\$0.90 PSF
<b>CAM AND INSURANCE:</b>	\$0.65 PSF (Includes Property Management)
<b>COMMENTS:</b>	<ul style="list-style-type: none"><li>› Located in Kane County</li><li>› Good Business Park Location</li><li>› Property Location Amid Executive Housing and Strong Labor Force</li><li>› End Cap Unit</li><li>› Professionally Managed by Lee Asset Management</li></ul>

**AVAILABLE SPACE:**

<b>UNIT 3625:</b>	28,800 SF
<b>OFFICE:</b>	To Suit
<b>LOADING:</b>	<ul style="list-style-type: none"><li>› 2 Interior Docks</li><li>› 1 Drive-in Door</li></ul>
<b>LEASE RATE:</b>	\$5.25 PSF Net
<b>AVAILABLE:</b>	Immediately (Space is Offered by Colliers for Sublease Through 1/31/2020)



**Nick Eboli**  
Executive Vice President  
neboli@lee-associates.com  
D 630.567.7812

**Andrew Block**  
Senior Associate  
ablock@lee-associates.com  
D 630.926.7649

**John Cassidy, SIOR**  
Principal  
jcassidy@lee-associates.com  
D 312.371.0098

OWNED BY:

**DRA**  
ADVISORS

All information furnished regarding property for sale, rental or financing is from sources deemed reliable, but no warranty or representation is made to the accuracy thereof and same is submitted to errors, omissions, change of price, rental or other conditions prior to sale, lease or financing or withdrawal without notice. No liability of any kind is to be imposed on the broker herein.

AVAILABLE FOR LEASE  
3625 SWENSON AVENUE  
ST. CHARLES, ILLINOIS 60174

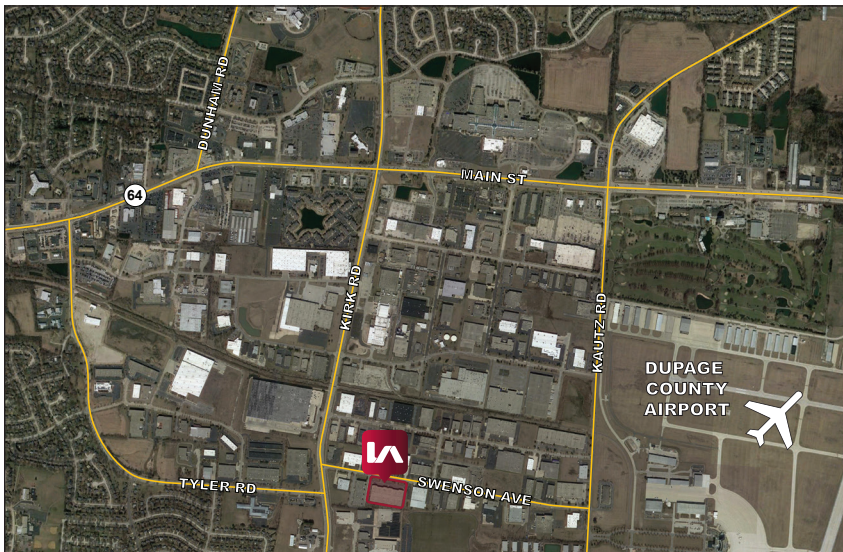
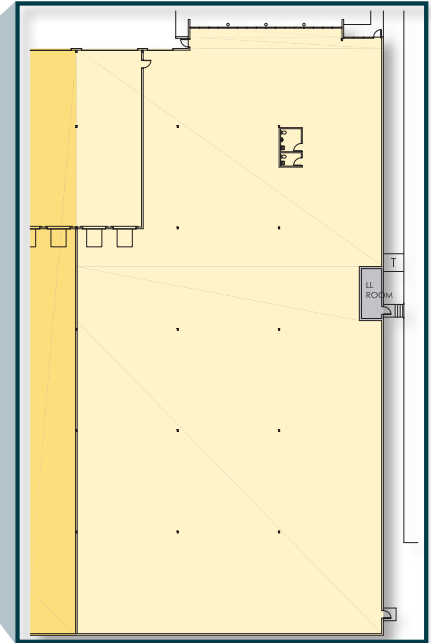
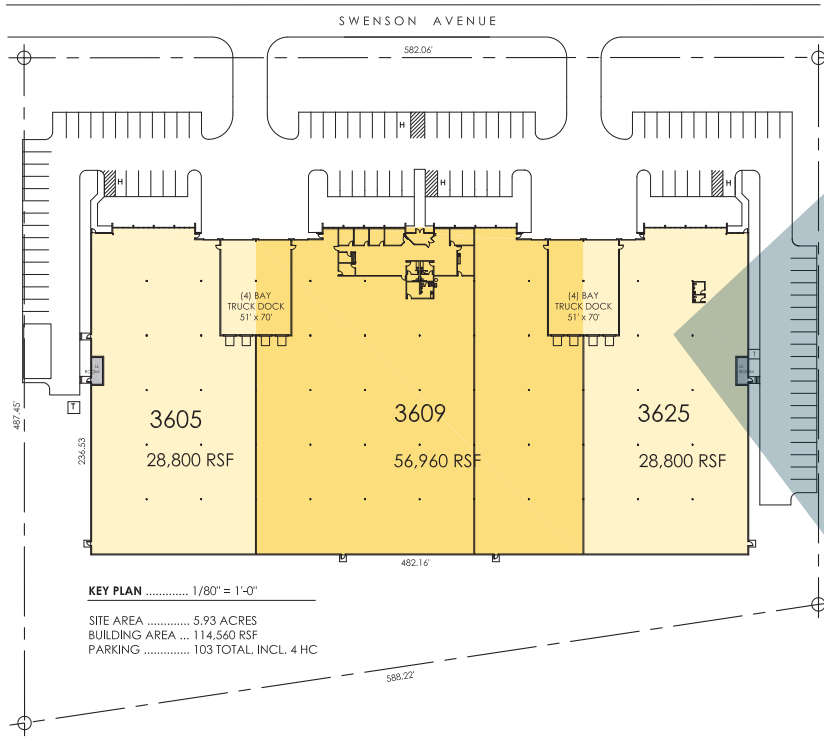

**LOCATION:**

**Nearby Amenities Include:**

Pheasant Run Golf Course, Prairie Landing Golf Course and St., Charles Country Club, Charlestown Mall, DuPage Airport

**Highway Access:**

8 Miles to I-88 via Kirk Rd  
13 Miles to I-355 via North Ave (Route 64)  
15 Miles I-90 via Route 59

**Nick Eboli**  
Executive Vice President  
neboli@lee-associates.com  
D 630.567.7812

**Andrew Block**  
Senior Associate  
ablock@lee-associates.com  
D 630.926.7649

**John Cassidy, SIOR**  
Principal  
jcassidy@lee-associates.com  
D 312.371.0098

OWNED BY:



All information furnished regarding property for sale, rental or financing is from sources deemed reliable, but no warranty or representation is made to the accuracy thereof and same is submitted to errors, omissions, change of price, rental or other conditions prior to sale, lease or financing or withdrawal without notice. No liability of any kind is to be imposed on the broker herein.