

# HARDY INDUSTRIAL CENTER

1228 BAMMEL ROAD | HOUSTON, TX

Owned and developed by:  
**VIGAVI** 

±7,500 SF CRANE-READY BUILDING — FOR LEASE OR SALE



- Hardy Industrial Center is a deed-restricted business park strategically located between The Woodlands and Bush Intercontinental Airport.
- Location allows for access to both I-45 and the Hardy Toll Road via FM 1960 and Bammel Road.
- Opportunities for build-to-suit and design-build projects.

## FEATURES

- ±7,500 SF crane-ready building
- Office: Build-to-suit
- 10-ton crane capacity with ±20' hook height
- 26' eave height
- 75' bay on 25' centers (75' x 100')
- Power: 400 amps, 480V, 3-phase
- Overhead door at (14' x 16')
- Regional detention provided
- Utilities in place
- Additional land available for expansion or build-to-suit
- Lease rate: \$1.00/SF NNN
- Sales price: \$105/SF

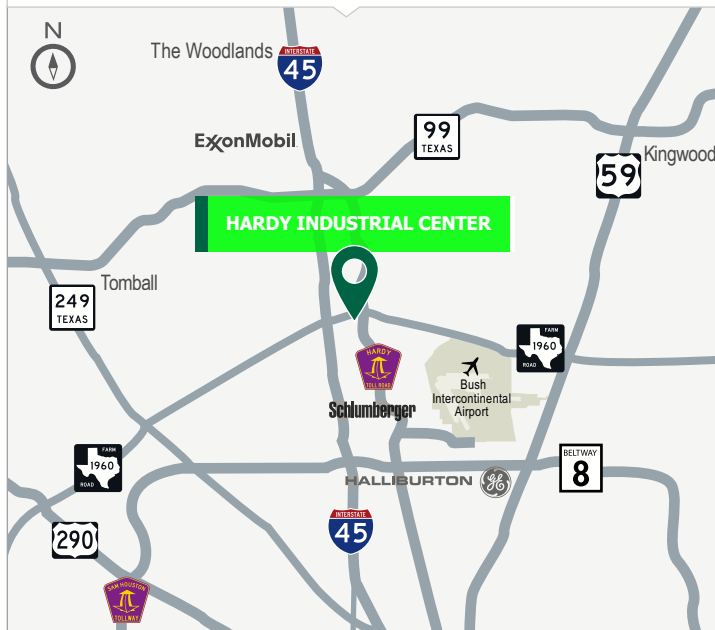

## CONTACT

Richard Quarles, SIOR  
Senior Vice President  
+1.713.888.4019  
richard.quarles@am.jll.com

Mark Nicholas, SIOR  
Executive Vice President  
+1 713.888.4024  
mark.nicholas@am.jll.com

Joe Berwick  
Senior Associate  
+1 713.425.5842  
joseph.berwick@am.jll.com

Disclaimer: The information contained herein is obtained from sources believed to be reliable. However, both Jones Lang LaSalle and Vigavi Realty LLC make no guarantees, warranties or representations as to the completeness or accuracy thereof. The presentation of this property is submitted subject to errors, omissions, change of price or conditions, and is subject to prior sale, lease or withdrawal without notice. ©2019, Jones Lang LaSalle. All rights reserved.



# HARDY INDUSTRIAL CENTER

1228 BAMMEL ROAD | HOUSTON, TX

Owned and developed by:  
**VIGAVI** 



- Site plan above is for guidance/context
- Developer is flexible on land size and configuration
- Multiple alternatives for transaction structure (Build-to-Suit, Design Build and Sale)

## CONTACT

Richard Quarles, SIOR  
Senior Vice President  
+1.713.888.4019  
richard.quarles@am.jll.com

Mark Nicholas, SIOR  
Executive Vice President  
+1 713.888.4024  
mark.nicholas@am.jll.com

Joe Berwick  
Senior Associate  
+1 713.425.5842  
joseph.berwick@am.jll.com

Disclaimer: The information contained herein is obtained from sources believed to be reliable. However, both Jones Lang LaSalle and Vigavi Realty LLC make no guarantees, warranties or representations as to the completeness or accuracy thereof. The presentation of this property is submitted subject to errors, omissions, change of price or conditions, and is subject to prior sale, lease or withdrawal without notice. ©2019. Jones Lang LaSalle. All rights reserved.



# HARDY INDUSTRIAL CENTER

1228 BAMMEL ROAD | HOUSTON, TX

Owned and developed by:



**±7,500 SF CRANE-READY BUILDING — FOR LEASE OR SALE**

## SITE PLAN

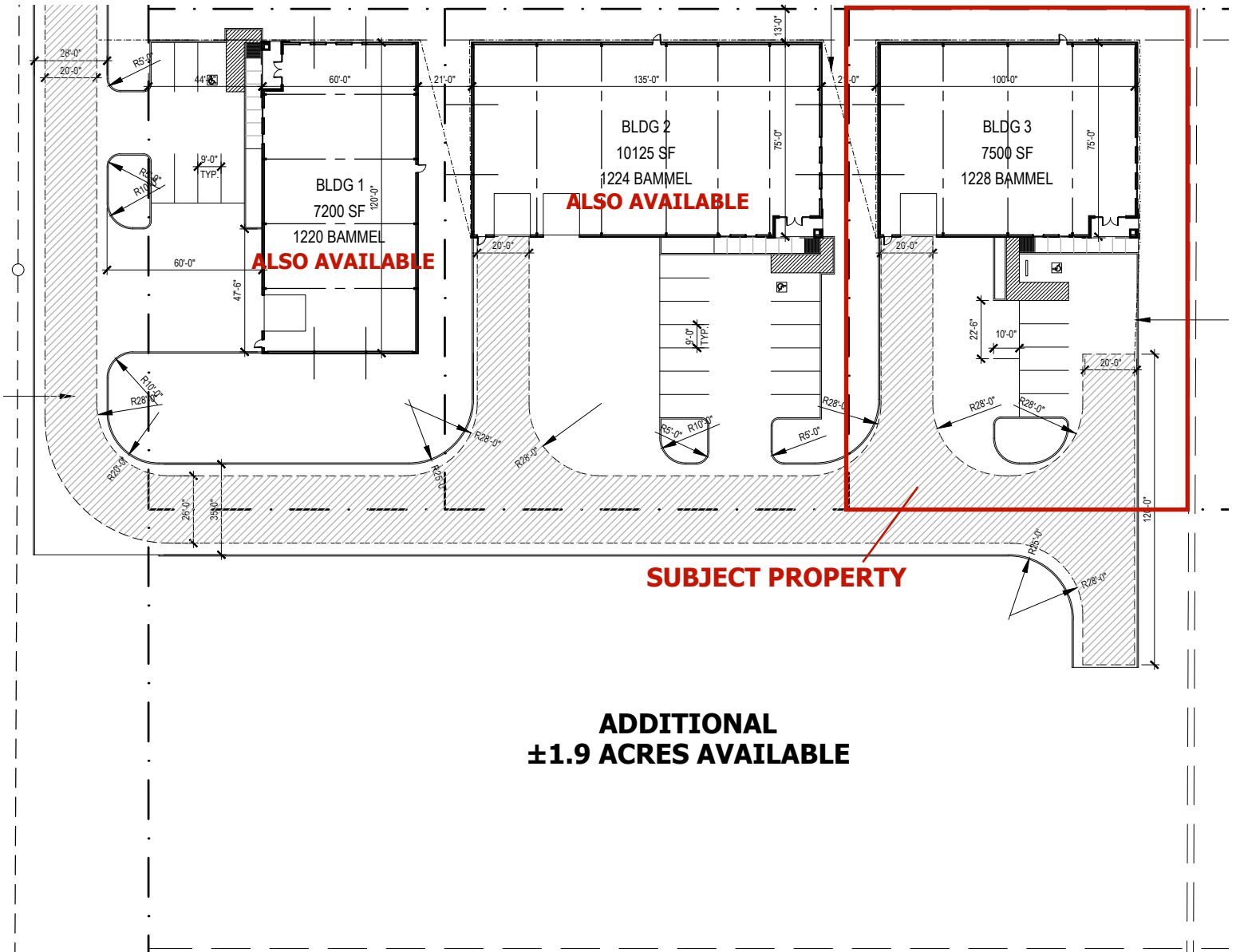

### CONTACT

**Richard Quarles, SIOR**  
Senior Vice President  
+1.713.888.4019  
richard.quarles@am.jll.com

**Mark Nicholas, SIOR**  
Executive Vice President  
+1 713.888.4024  
mark.nicholas@am.jll.com

**Joe Berwick**  
Senior Associate  
+1 713.425.5842  
joseph.berwick@am.jll.com

Disclaimer: The information contained herein is obtained from sources believed to be reliable. However, both Jones Lang LaSalle and Vigavi Realty LLC make no guarantees, warranties or representations as to the completeness or accuracy thereof. The presentation of this property is submitted subject to errors, omissions, change of price or conditions, and is subject to prior sale, lease or withdrawal without notice. ©2019. Jones Lang LaSalle. All rights reserved.

