

2036 Congressional Drive

Maryland Heights, MO 63146
www.cbre.com/stlouis

Lease Rate: \$6.95 / SF NNN



Property Information

- + Building Size: 30,000 SF
- + Space Available: 5,000 SF
- + Office Size: ±1,000 SF (20%)
- + Loading: One dock door with ability to add another
- + Clear height: 16'
- + Power: 3 phase, 240 volt, 120 amp
- + Wet sprinkler system
- + Existing floor drains
- + Excellent access to Page Ave and I-270
- + 2 minute drive to Westport Plaza amenities

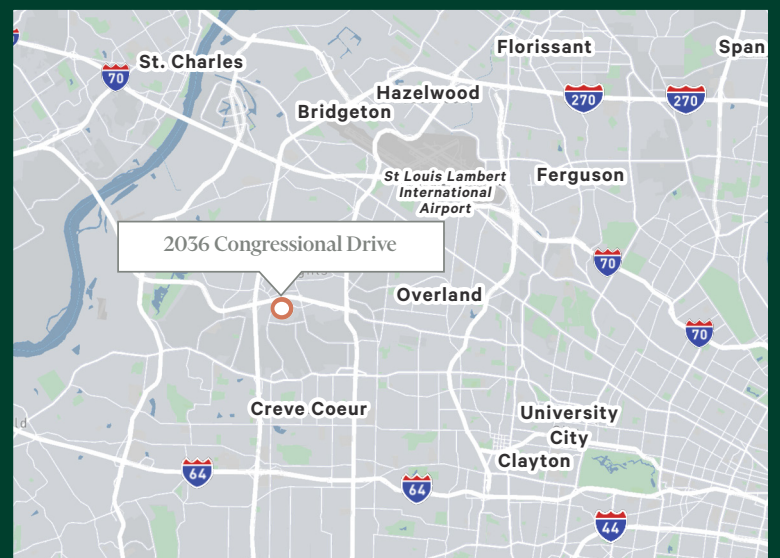

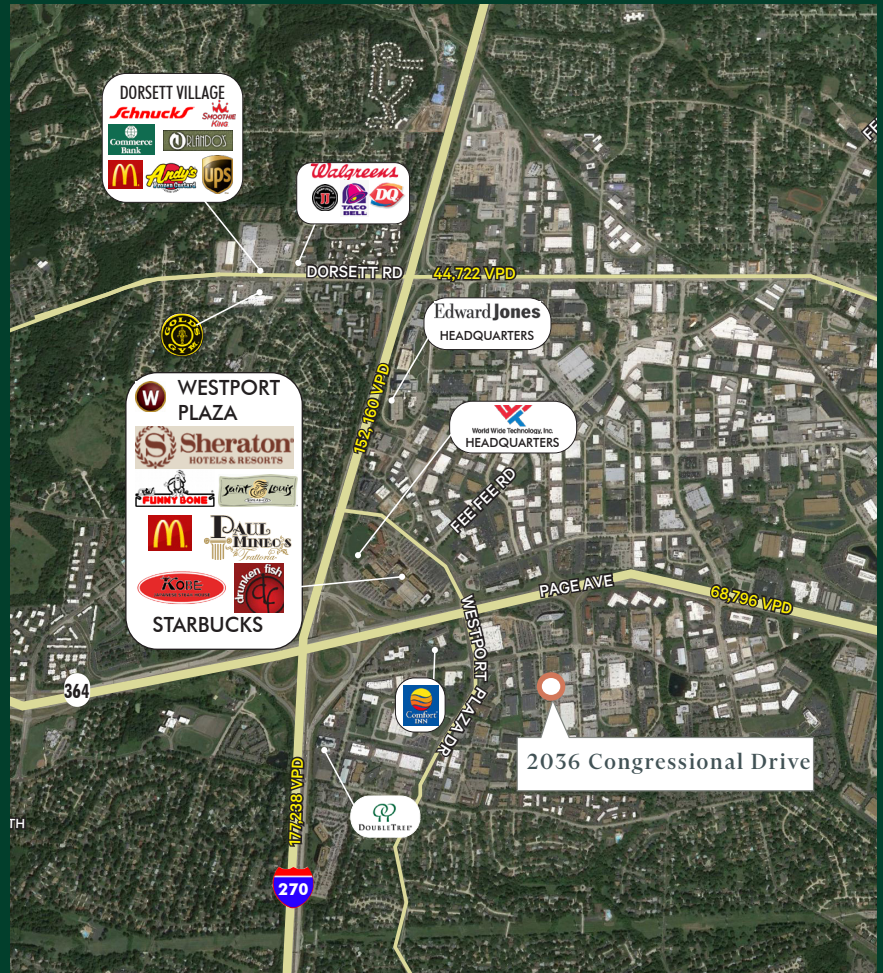
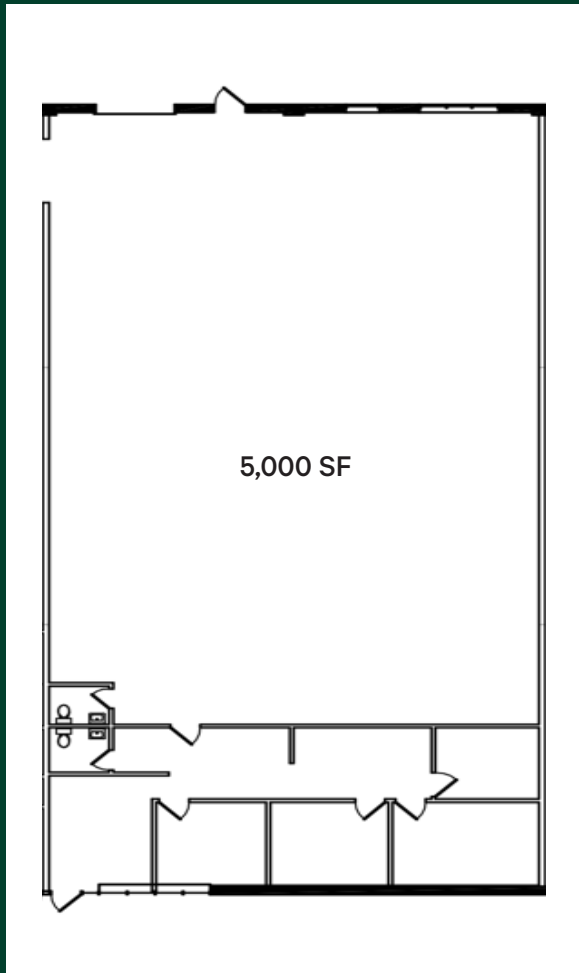

Contact Info

John Frith
Senior Associate
+1 314 655 6096
john.frith@cbre.com

CBRE, Inc.
190 Carondelet Plaza
St. Louis, MO 63011
+1 314 655 6000

© 2022 CBRE, Inc. All rights reserved. This information has been obtained from sources believed reliable, but has not been verified for accuracy or completeness. You should conduct a careful, independent investigation of the property and verify all information. Any reliance on this information is solely at your own risk. CBRE and the CBRE logo are service marks of CBRE, Inc. All other marks displayed on this document are the property of their respective owners, and the use of such logos does not imply any affiliation with or endorsement of CBRE. Photos herein are the property of their respective owners. Use of these images without the express written consent of the owner is prohibited.