



PROPERTY HIGHLIGHTS:

- Turn Key Space with Signage
- Fantastic Retail Property Built in 2015
- Walking Distance to West Falls Church Metro
- First Prominent Retail Building Entering the Falls Church Corridor
- Furniture available
- 2nd Floor Space with the ability to have both LIT Building and LIT Pylon Signage
- Plenty of Parking
- Next to Conte's Bike Shop, Jimmy Johns, Dentist, VA ABC, Computer Wingman

1,112 SF Built Out Second Floor Retail Space

STATISTICAL SNAPSHOT:

(Within 3mile radius)



EMPLOYEE
POPULATION
143,000



AVERAGE
HOUSEHOLD INCOME
\$145,367



TOTAL
POPULATION
153,500

SPACE DETAILS:

Space: 1,112 SF

Rental Rate: Negotiable

Property Type: Retail or Office Space

Building Size: 16,867 SF

Lot Size: 53,300 SF

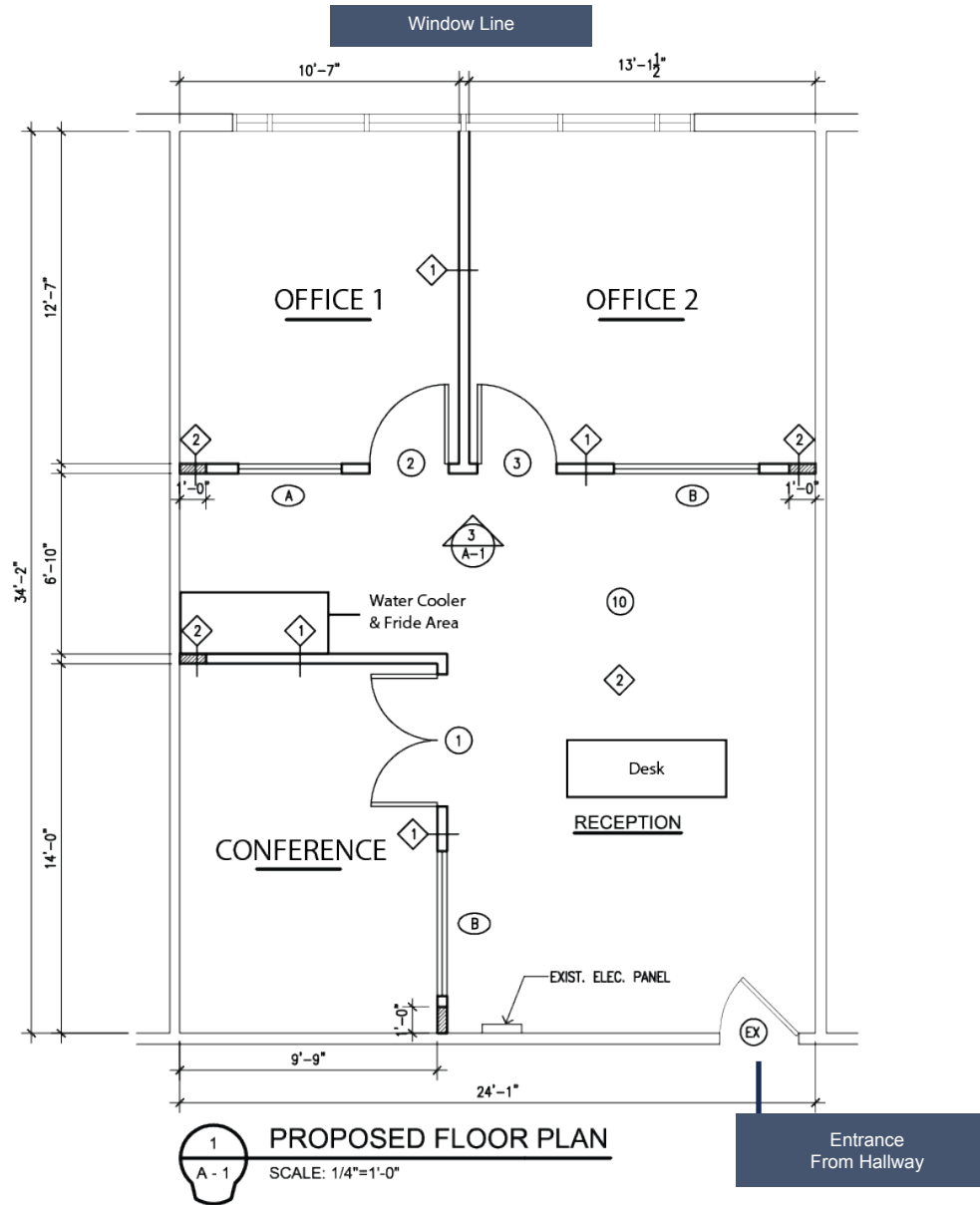

SITEPLAN



AERIAL VIEW

LONG & FOSTER[®] | COMMERCIAL
REAL ESTATE | DIVISION

Erik Ulsaker

Senior Commercial Agent

703.861.0373

eu@lnf.com

Jack Clauff

Commercial Agent

402.203.9702

clauffj@gmail.com