



## Hill Investment - Space Center East

20231 72nd Avenue S, Kent, Washington 98032

### Property Features

- 51,342 SF (3,450 SF office)
- 24' clear height
- 3 DH & 3 GL doors
- Fully insulated space
- Heavy power (2,400 amps of primary power)
- Upgraded T-8 lighting
- Lease rate: \$0.48 PSF, NNN (shell); \$0.85 PSF, NNN (office)
- NNN (est.) = \$0.22
- Landlord okay with 3 year term
- Available now



For more information:

**Arie Salomon, SIOR, CCIM**

+1 425 586 5636 • [asalomon@nai-psp.com](mailto:asalomon@nai-psp.com)

**Jeff Forsberg, CCIM**

+1 425 586 5610 • [jforsberg@nai-psp.com](mailto:jforsberg@nai-psp.com)

**Taylor Hoff, SIOR**

+1 425 586 5634 • [thoff@nai-psp.com](mailto:thoff@nai-psp.com)

Industrial for Lease

# Hill Investment - Space Center East

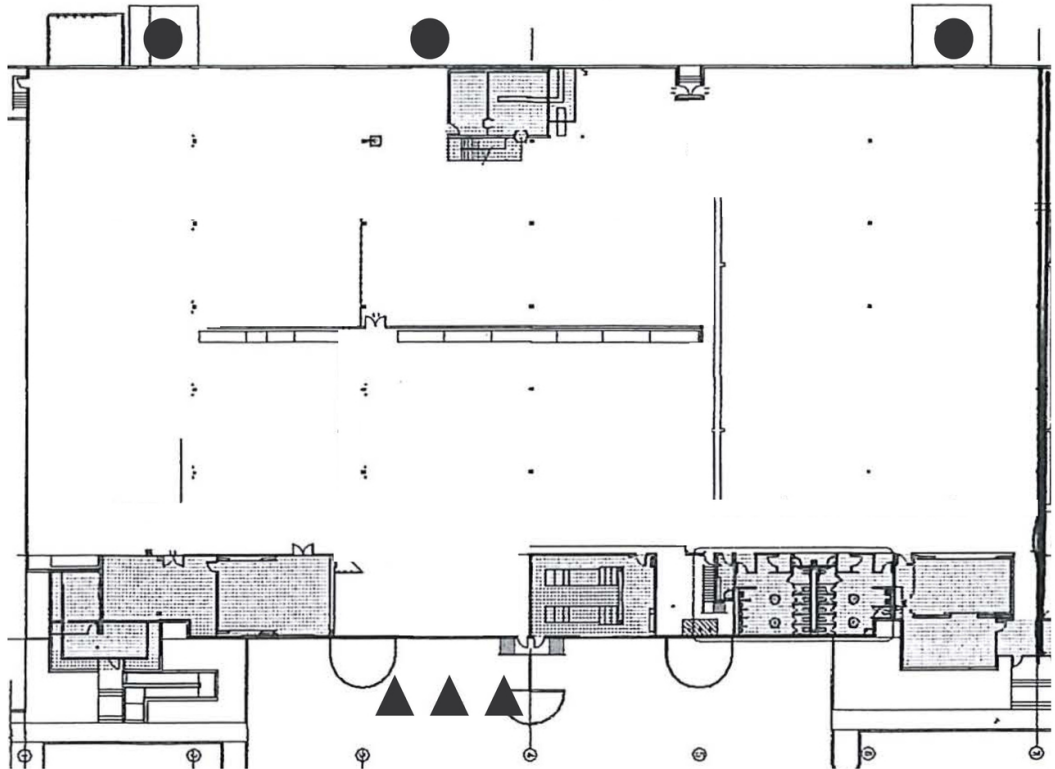

● = Grade Level Doors

▲ = Dock High Doors



600 108th Avenue NE, Suite 340

Bellevue, WA 98004

+1 425 586 5600

[nai-psp.com](http://nai-psp.com)

BELLEVUE | SEATTLE | TACOMA

THE INFORMATION CONTAINED HEREIN HAS BEEN GIVEN TO US BY THE OWNER OF THE PROPERTY OR OTHER SOURCES WE DEEM RELIABLE, WE HAVE NO REASON TO DOUBT ITS ACCURACY, BUT WE DO NOT GUARANTEE IT. ALL INFORMATION SHOULD BE VERIFIED PRIOR TO PURCHASE OR LEASE.