

Jansmick Land 84.51 acres

For Sale: \$3.50 - \$10.00/ sq. ft.



2500 W 49th Street Suite 100
Sioux Falls, SD 57105
605 357 7100
naisiouxfalls.com



Troy Fawcett
CCIM, SIOR
605 444 7120
605 321 2199
tfawcett@naisiouxfalls.com



Craig Hagen
CCIM, SIOR
605 444 7115
605 310 4227
chagen@naisiouxfalls.com

NAI Sioux Falls

FEATURES

Jansmick Land
84.51 acres

- 84.51 acres total
- Zoning: I-1 and C-4 and O
- Seller would consider sub-dividing or assembling lots, contact broker for details
- Adjacent to I-29 and 1 mile south of I-90
- Northeast intersection of Benson Road and I-29
- Area neighbors include: Sanford Sports Complex, Fleet Farm, Animal Health International, Sioux Falls Regional Airport, First Premier Bankcard, Max Muscle, Feeding South Dakota
- Located in Opportunity Zone

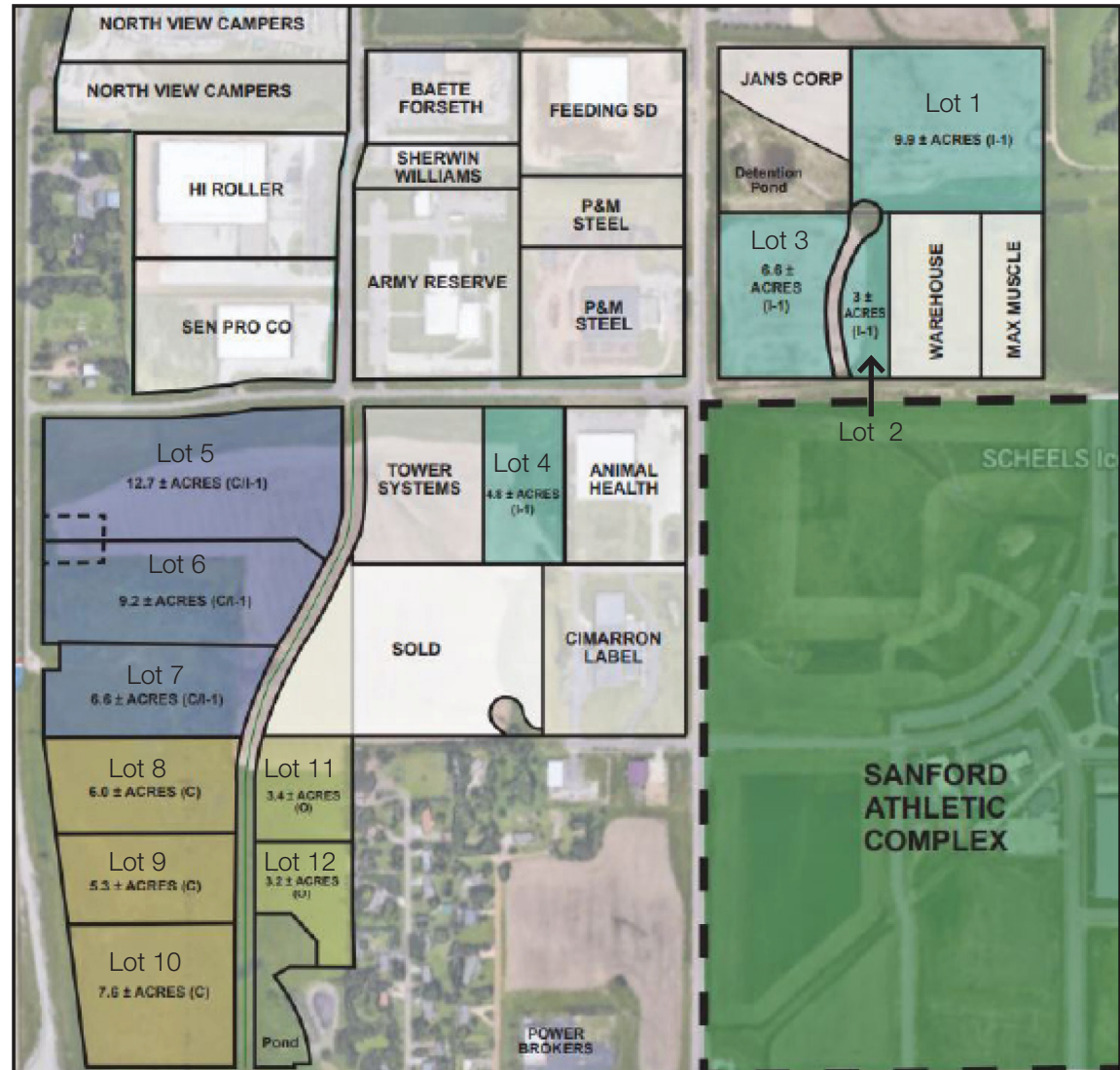

Lot Size Price/ sq. ft.

- | Lot | Size | Price/ sq. ft. |
|---------|----------------|------------------------|
| Lot 1: | +/- 9.9 acres | \$3.50/ sq. ft. |
| Lot 2: | +/- 3.0 acres | \$4.00/ sq. ft. |
| Lot 3: | +/- 6.6 acres | \$5.00/ sq. ft. |
| Lot 4: | +/- 4.8 acres | \$4.00/ sq. ft. |
| Lot 5: | +/- 12.7 acres | \$4.00-\$6.00/ sq. ft. |
| Lot 6: | +/- 9.2 acres | \$5.00/ sq. ft. |
| Lot 7: | +/- 6.6 acres | \$5.00/ sq. ft. |
| Lot 8: | +/- 6.0 acres | \$8.00/ sq. ft. |
| Lot 9: | +/- 5.3 acres | \$8.00/ sq. ft. |
| Lot 10: | +/- 7.6 acres | \$10.00/ sq. ft. |
| Lot 11: | +/- 3.4 acres | \$4.00-\$5.00/ sq. ft. |
| Lot 12: | +/- 3.2 acres | \$4.00-\$5.00/ sq. ft. |

AREA MAP

Jansmick Land
84.51 acres

