



**CUSHMAN &
WAKEFIELD**
Commerce

FOR LEASE

9017 South Riverside Dr (700 West)
Sandy, Utah



Property Highlights

- Newly constructed building
- Up to 7,738 square feet available on the 1st floor
- Two suites available: 3,950 SF and 3,788 SF
- \$23.00 per SF, full service
- Space is in shell condition and ready for TI's
- Direct access to I-15 via 9000 South on/off ramp

Dana Baird, ccim
Executive Director
+1 801 303 5526
dbaird@comre.com

Mike Richmond
Executive Director
+1 801 303 5434
mrichmond@comre.com

170 South Main Street Suite 1600
Salt Lake City, UT
Main +1 801 322 2000
Fax +1 801 322 2040
comre.com

Independently Owned and Operated / A Member of the Cushman & Wakefield Alliance

Cushman & Wakefield Copyright 2017. No warranty or representation, express or implied, is made to the accuracy or completeness of the information contained herein, and same is submitted subject to errors, omissions, change of price, rental or other conditions, withdrawal without notice, and to any special listing conditions imposed by the property owner(s). As applicable, we make no representation as to the condition of the property (or properties) in question.



**CUSHMAN &
WAKEFIELD**
Commerce

FOR LEASE

9017 South Riverside Dr (700 West)
Sandy, Utah

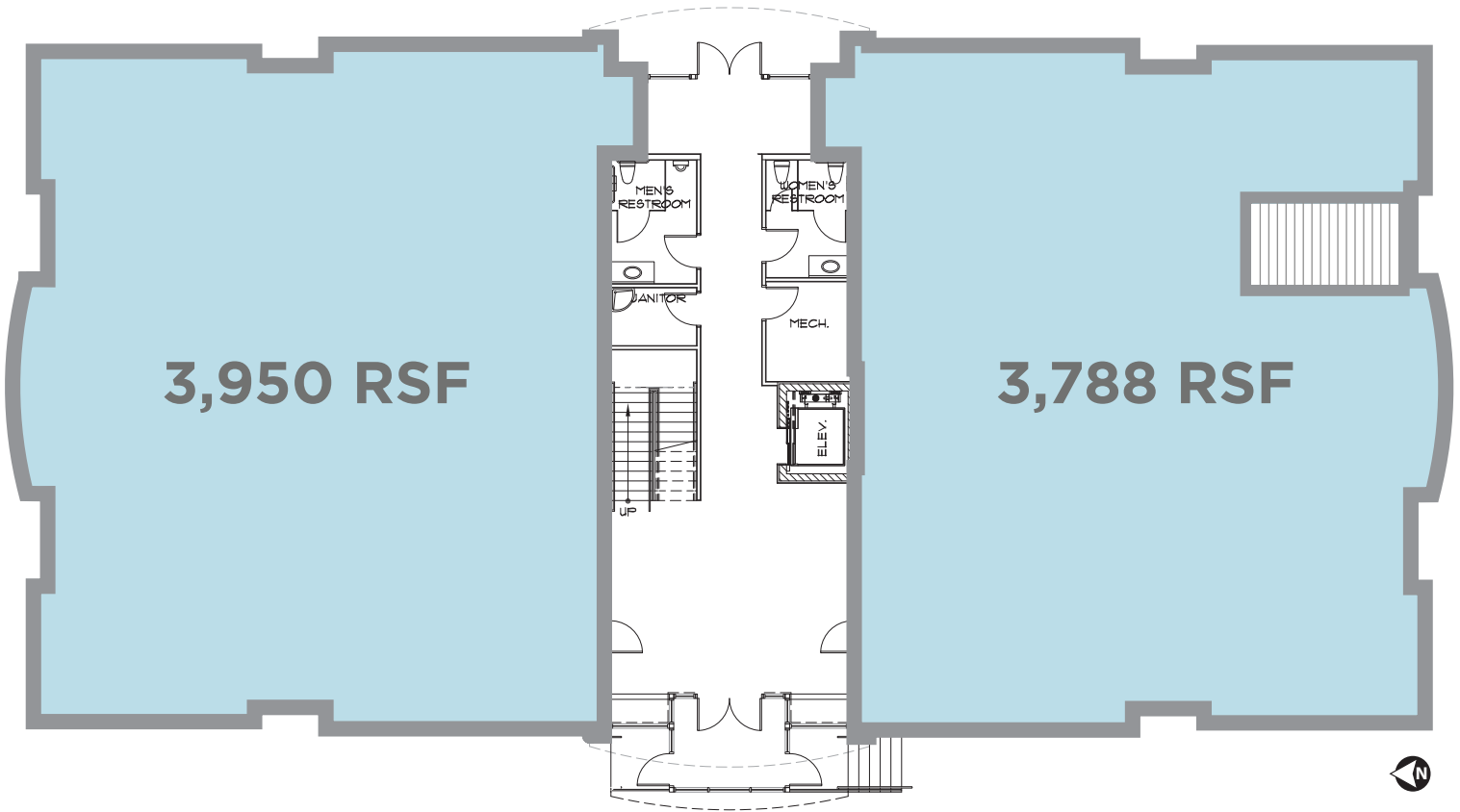

Mike Richmond
Executive Director
+1 801 303 5434
mrichmond@comre.com

Dana Baird, ccm
Executive Director
+1 801 303 5526
dbaird@comre.com

170 South Main Street Suite 1600
Salt Lake City, UT 84101
Main +1 801 322 2000
Fax +1 801 322 2040
comre.com

Independently Owned and Operated / A Member of the Cushman & Wakefield Alliance

Cushman & Wakefield Copyright 2017. No warranty or representation, express or implied, is made to the accuracy or completeness of the information contained herein, and same is submitted subject to errors, omissions, change of price, rental or other conditions, withdrawal without notice, and to any special listing conditions imposed by the property owner(s). As applicable, we make no representation as to the condition of the property (or properties) in question.
(path: G:\1 - Projects\Richmond, Mike\1 - Flyers\9017sRiversideDrive)



**CUSHMAN &
WAKEFIELD**
Commerce

FOR LEASE

9017 South Riverside Dr (700 West)
Sandy, Utah



Mike Richmond
Executive Director
+1 801 303 5434
mrichmond@comre.com

Dana Baird, ccm
Executive Director
+1 801 303 5526
dbaird@comre.com

170 South Main Street Suite 1600
Salt Lake City, UT 84101
Main +1 801 322 2000
Fax +1 801 322 2040
comre.com

Independently Owned and Operated / A Member of the Cushman & Wakefield Alliance

Cushman & Wakefield Copyright 2017. No warranty or representation, express or implied, is made to the accuracy or completeness of the information contained herein, and same is submitted subject to errors, omissions, change of price, rental or other conditions, withdrawal without notice, and to any special listing conditions imposed by the property owner(s). As applicable, we make no representation as to the condition of the property (or properties) in question.
(path: G:\1 - Projects\Richmond, Mike\1 - Flyers\9017sRiversideDrive)



**CUSHMAN &
WAKEFIELD**
Commerce

FOR LEASE

9017 South Riverside Dr (700 West)
Sandy, Utah

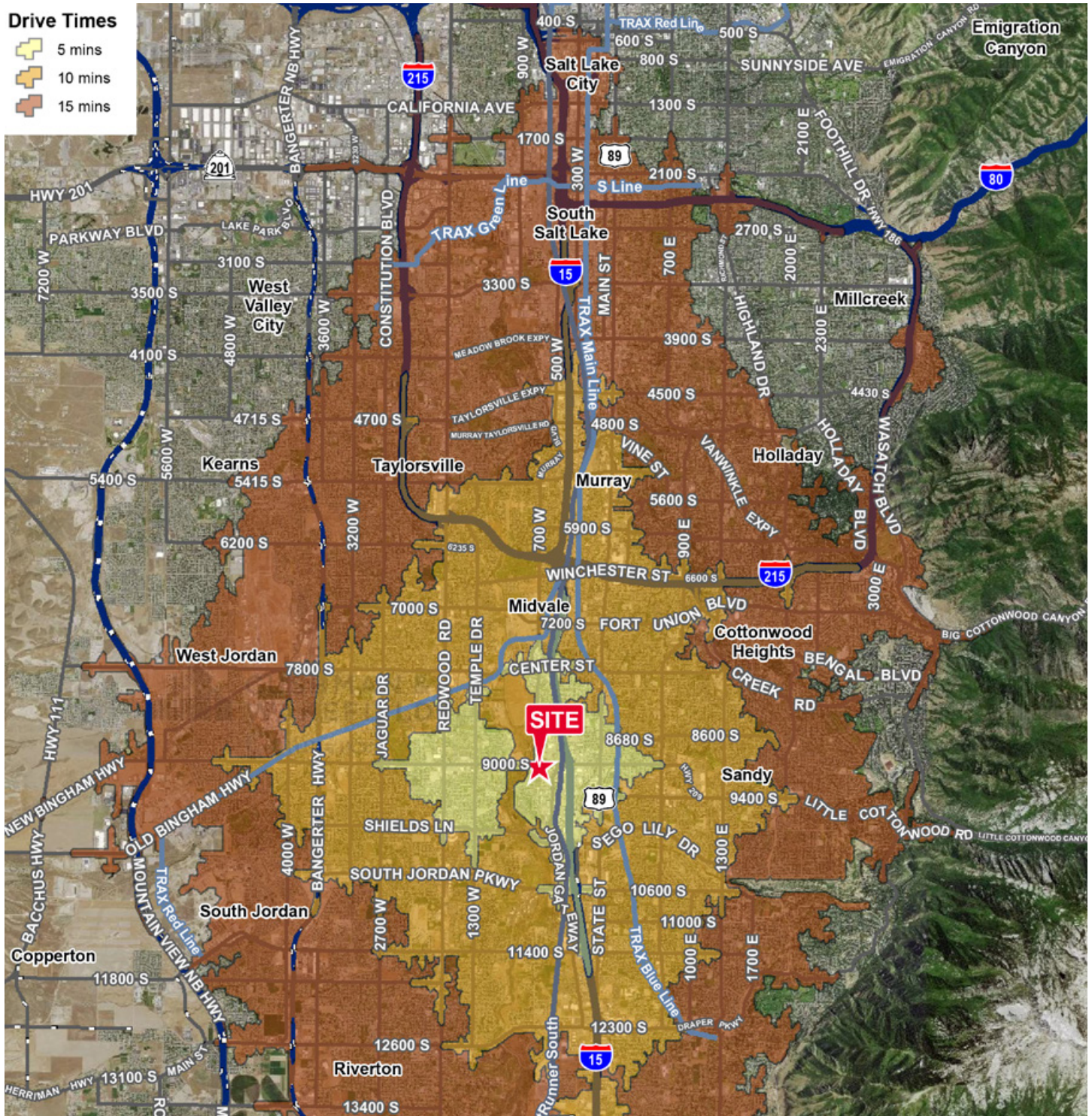

Mike Richmond
Executive Director
+1 801 303 5434
mrichmond@comre.com

Dana Baird, ccim
Executive Director
+1 801 303 5526
dbaird@comre.com

170 South Main Street Suite 1600
Salt Lake City, UT 84101
Main +1 801 322 2000
Fax +1 801 322 2040
comre.com

Independently Owned and Operated / A Member of the Cushman & Wakefield Alliance

Cushman & Wakefield Copyright 2017. No warranty or representation, express or implied, is made to the accuracy or completeness of the information contained herein, and same is submitted subject to errors, omissions, change of price, rental or other conditions, withdrawal without notice, and to any special listing conditions imposed by the property owner(s). As applicable, we make no representation as to the condition of the property (or properties) in question.

(path: G:\1 - Projects\Richmond, Mike\1 - Flyers\9017sRiversideDrive)