

PRIME RETAIL SPACE ADJACENT TO KOHL'S

Mobile, AL 36695 | 845 Schillinger Rd S. | Airport Blvd & Schillinger Rd | #1023



AVAILABLE SF:
24,600 SF

FRONTAGE:
APPROX. 98' 0"

ZONING:
COMMERCIAL

RATES:
CALL FOR DETAILS

AREA ANCHORS



- 24,600 +/- SF space available adjacent to Kohl's
- Located on Schillinger Road S., the primary north/south corridor in Mobile
- Great surrounding tenant mix with high traffic counts on Schillinger Road
- Abundant parking

DEMOGRAPHICS	3 MILES	5 MILES	7 MILES	TRAFFIC COUNTS	
2018 POPULATION	49,878	121,087	184,102	Schillinger Road	34,370 VPD
2018 DAYTIME POPULATION	49,967	109,061	192,204	Airport Blvd	33,320 VPD
2018 AVERAGE HH INCOME	\$78,287	\$79,191	\$75,045		
2018 MEDIAN HH INCOME	\$56,519	\$57,375	\$54,407		



FOR MORE INFORMATION, CONTACT EXCLUSIVE AGENT(S):
KATHY DENNIS, CCIM • kathy.dennis@tscg.com • 205.776.6708



PRIME RETAIL SPACE ADJACENT TO KOHL'S

Mobile, AL 36695 | 845 Schillinger Rd S. | Airport Blvd & Schillinger Rd | #1023

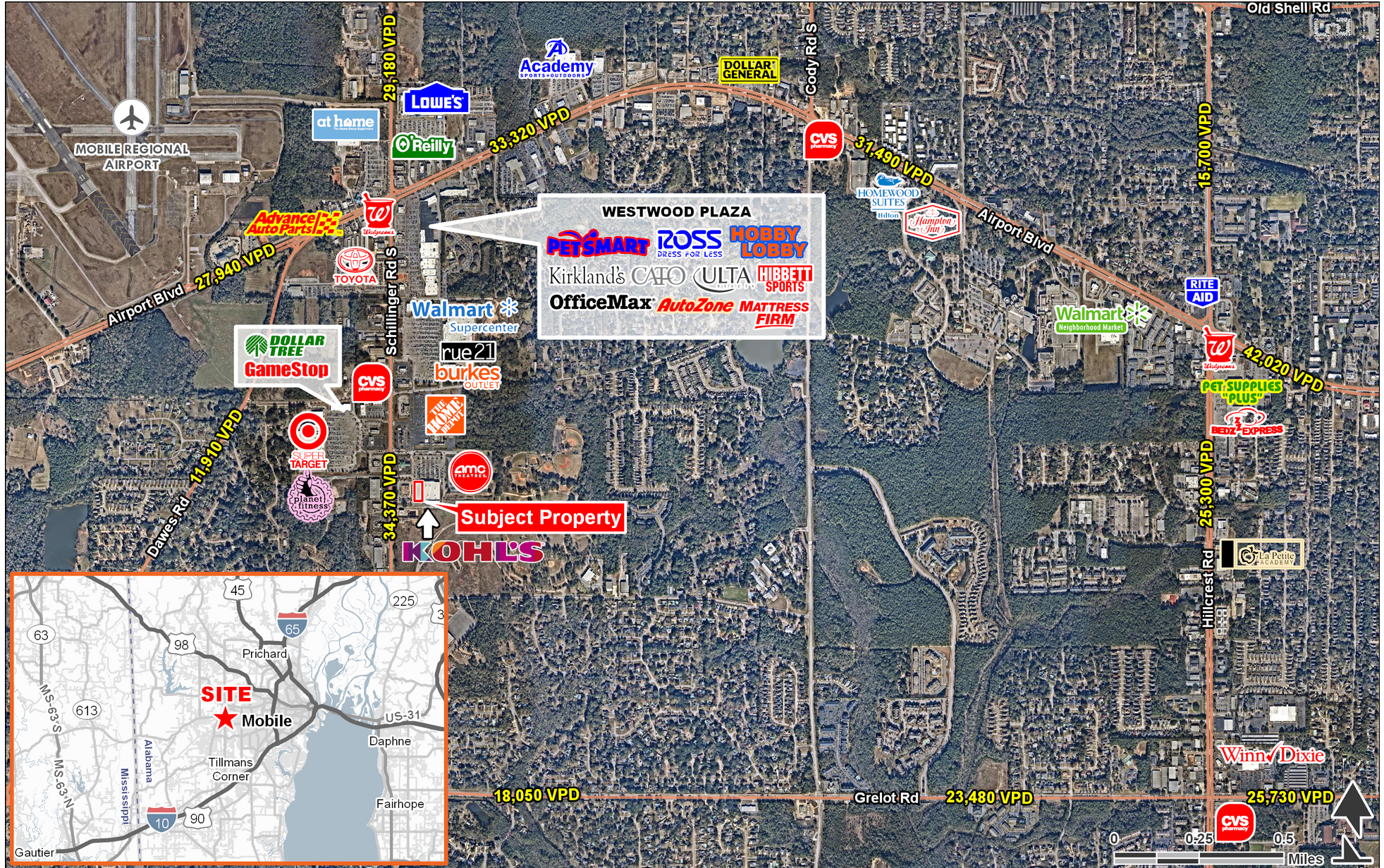

FOR MORE INFORMATION, CONTACT EXCLUSIVE AGENT(S):
 KATHY DENNIS, CCIM • kathy.dennis@tscg.com • 205.776.6708



Demographics: Esri 2018 No warranty expressed or implied has been made as to the accuracy of the information provided herein, no liability assumed for error or omissions.

PRIME RETAIL SPACE ADJACENT TO KOHL'S

Mobile, AL 36695 | 845 Schillinger Rd S. | Airport Blvd & Schillinger Rd | #1023

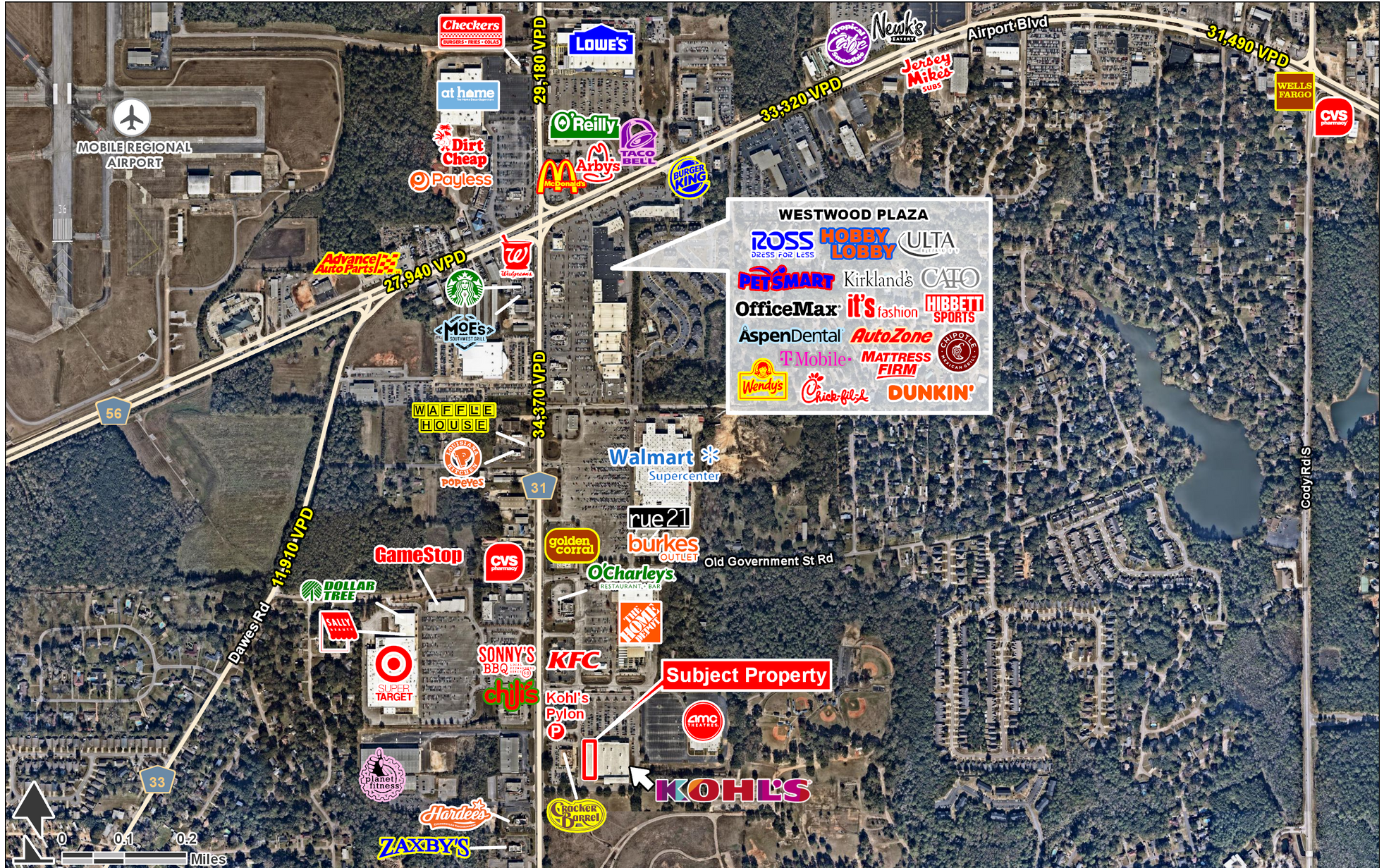

FOR MORE INFORMATION, CONTACT EXCLUSIVE AGENT(S):
 KATHY DENNIS, CCIM • kathy.dennis@tscg.com • 205.776.6708



Demographics: Esri 2018 No warranty expressed or implied has been made as to the accuracy of the information provided herein, no liability assumed for error or omissions.

PRIME RETAIL SPACE ADJACENT TO KOHL'S

Mobile, AL 36695 | 845 Schillinger Rd S. | Airport Blvd & Schillinger Rd | #1023

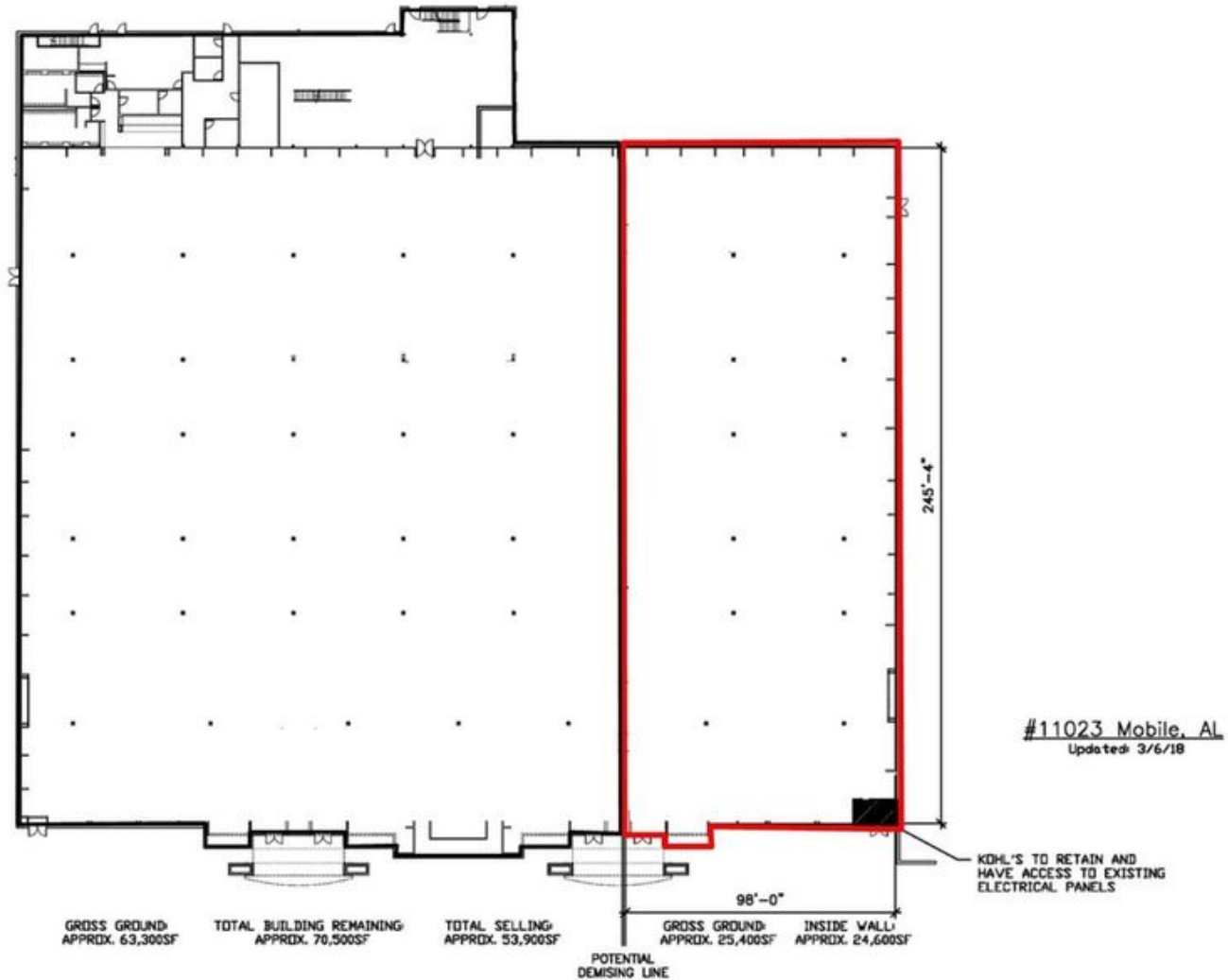

FOR MORE INFORMATION, CONTACT EXCLUSIVE AGENT(S):
KATHY DENNIS, CCIM • kathy.dennis@tscg.com • 205.776.6708

