

**FULL FLOOR OF 31,580 RSF WITH PANORAMIC VIEWS OF THE HUDSON RIVER AND LOWER MANHATTAN**  
**HIGH END POTENTIAL PRE BUILTS**

Entire 6th Floor- 31,580 RSF  
 Partial 10th Floor- 8,466 RSF



MODERN OFFICE FINISHES IN THE HEART OF HUDSON SQUARE  
 LARGE WINDOWS & EXPOSED CEILING HEIGHTS OF 11'5"  
 MAMAN BAKERY RETAIL  
 CLOSE PROXIMITY TO TRANSPORTATION; 1 2 3 AND THE ACE ON CANAL STREET WITH MULTIPLE CITIBIKE STATIONS  
 LANDLORD WILL PRE BUILD FOR QUALIFIED TENANT

HUDSON SQUARE PROPERTIES



NEWMARK

**AVAILABILITIES:**  
**PARTIAL FLOOR 10**  
**TEST FIT**

OFFICES	05
WORKSTATIONS	47
CONFERENCE ROOMS	02
COPY/ PRINT	01
PANTRY	01
WELLNESS ROOM	01
IT	01
STORAGE	01

RSF	8,509
-----	-------

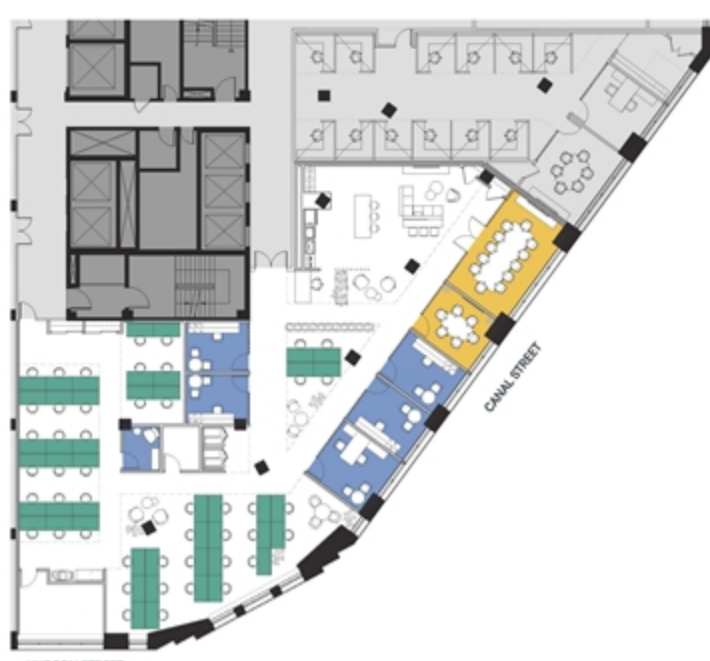

HUDSON SQUARE PROPERTIES

NEWMARK

**AVAILABILITIES:**  
**ENTIRE FLOOR 6**  
**TEST FIT - NORMAL DENSITY**

OFFICES	10
WORKSTATIONS	101
CONFERENCE ROOMS	09
MEETING ROOMS	02
PHONE ROOMS	05
COPY/ PRINT	01
PANTRY	01
WELLNESS ROOM	01
IT	01
STORAGE	01

RSF	31,580
-----	--------



HUDSON SQUARE PROPERTIES

NEWMARK

**AVAILABILITIES:**  
**ENTIRE FLOOR 6**  
**TEST FIT - REDUCED DENSITY**

OFFICES	11
WORKSTATIONS	87
CONFERENCE ROOMS	08
MEETING ROOMS	03
PHONE ROOMS	05
COPY/ PRINT	01
PANTRY	01
WELLNESS ROOM	01
IT	01
STORAGE	01

RSF	31,580
-----	--------



HUDSON SQUARE PROPERTIES

NEWMARK

**CONTACTS:**  
**OFFICE LEASING**

Pete Shimkin  
 212-372-2150  
 peter.shimkin@nrmk.com

Ben Shapiro  
 212-372-2421  
 ben.shapiro@nrmk.com

David Falk  
 212-372-2271  
 david.falk@nrmk.com

Brittany Silver  
 212-372-2219  
 brittany.silver@nrmk.com

Jonathan Franzel  
 646-441-3815  
 jonathan.franzel@nrmk.com

HUDSON SQUARE PROPERTIES

NEWMARK

DOWNLOAD BROCHURE