

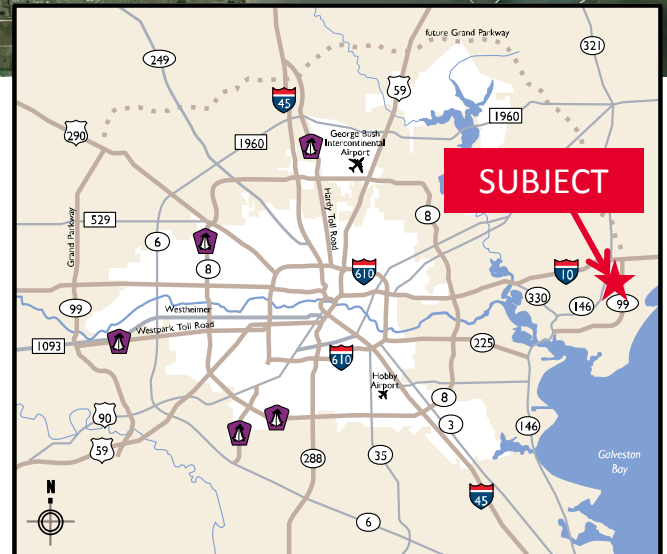

- ±33.92 Acres in Chambers County Texas
- On Grand Parkway (SH99) just South of Interstate 10
- Grand Parkway frontage: ±1,182.46'
- Kilgore Parkway frontage: ±892.37'
- City of Baytown water
- Asking price: \$2.35/sq. ft.



For more information, contact:

**B. Kelley Parker III, SIOR**  
(713) 963 2896  
[Kelley.Parker@cushwake.com](mailto:Kelley.Parker@cushwake.com)

**Coe Parker, SIOR**  
(713) 963 2825  
[Coe.Parker@cushwake.com](mailto:Coe.Parker@cushwake.com)

**John F. Littman, SIOR**  
(713) 963 2862  
[John.Littman@cushwake.com](mailto:John.Littman@cushwake.com)

**Cushman & Wakefield**  
Licensed Real Estate Brokers  
1330 Post Oak Boulevard | Suite 2700  
Houston, TX 77056  
[www.cushmanwakefield.com](http://www.cushmanwakefield.com)

±33.92 Acres  
Chambers County, TX



For more information, contact:

**B. Kelley Parker III, SIOR**  
(713) 963 2896  
[Kelley.Parker@cushwake.com](mailto:Kelley.Parker@cushwake.com)

**Coe Parker, SIOR**  
(713) 963 2825  
[Coe.Parker@cushwake.com](mailto:Coe.Parker@cushwake.com)

**John F. Littman, SIOR**  
(713) 963 2862  
[John.Littman@cushwake.com](mailto:John.Littman@cushwake.com)

**Cushman & Wakefield**  
Licensed Real Estate Brokers  
1330 Post Oak Boulevard | Suite 2700  
Houston, TX 77056  
[www.cushmanwakefield.com](http://www.cushmanwakefield.com)