

23840 DEQUINDRE ROAD
WARREN, MICHIGAN

INDUSTRIAL FOR SALE OR LEASE
4,260 Square Feet Available



**SIGNATURE
ASSOCIATES**
KNOW SIGNATURE | KNOW RESULTS

RECENT UPGRADES



PROPERTY FEATURES

- 4,260 square feet available
- 2,580 square feet of office
- 12'-16' clear height
- (1) 10x10 grade level door
- Zoned M-1
- Large paved and fenced lot
- Additional second floor storage and office space available which can be removed to increase shop area
- Great curb appeal
- Lease Rate: \$5.50/sq.ft. NNN
- Sale Price: \$225,000 (\$52.82/sq.ft.)



For more information, please contact:

BEN WILKIEMEYER

(248) 359 0624

bwilkiemeyer@signatureassociates.com

PAUL SAAD

(248) 359 0652

psaad@signatureassociates.com

SIGNATURE ASSOCIATES

One Towne Square, Suite 1200

Southfield, MI 48076

www.signatureassociates.com

23840 Dequindre Road – Warren, Michigan

Industrial For Sale or Lease

4,260
Square Feet
AVAILABLE

Site Plan

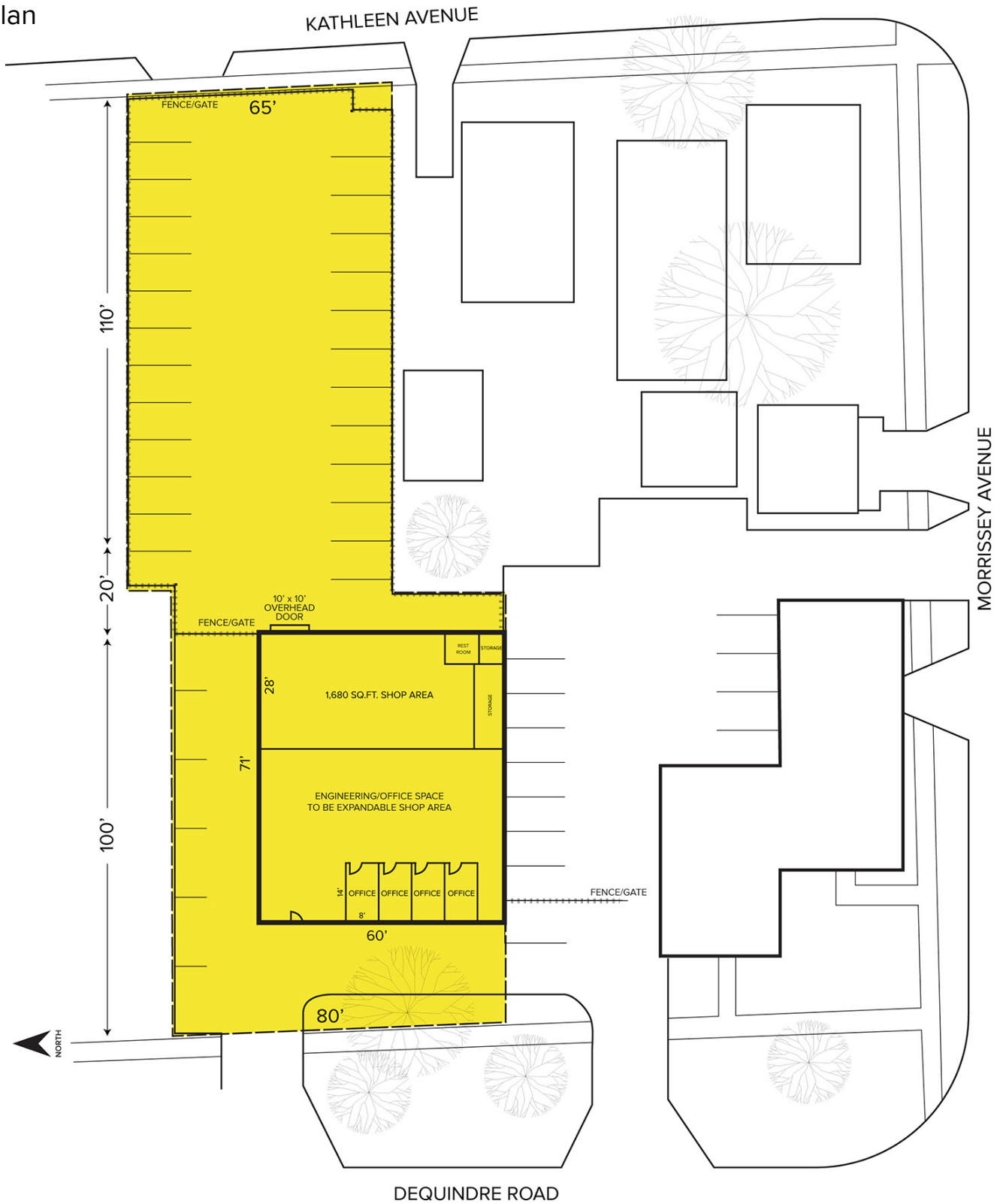

For more information, please contact:

BEN WILKIEMEYER

(248) 359 0624

bwilkiemeyer@signatureassociates.com

PAUL SAAD

(248) 359 0652

psaad@signatureassociates.com

SIGNATURE ASSOCIATES

One Towne Square, Suite 1200

Southfield, MI 48076

www.signatureassociates.com