

FOR SALE

LAND DEVELOPMENT OPPORTUNITY

ADAME
COMMERCIAL
REAL ESTATE SOLUTIONS

100 S PADRE ISLAND DRIVE | CORPUS CHRISTI, TX 78405



PROPERTY DESCRIPTION

Multiple tracts ranging from 0.47 acres to 7.30 acres within 100 SPID Business Park. The property has great exposure with access along SPID (Hwy. 358) between Old Brownsville Road & Bear Lane. All tracts are located within the 100 SPID Business Park Association allowing business types such as office, retail, medical, restaurants, hotels & more!

PROPERTY HIGHLIGHTS

- Multiple Tracts
- Great Visibility

OFFERING SUMMARY

Sale Price: Subject To Offer

DEMOGRAPHICS	1 MILE	3 MILES	5 MILES
Total Households	264	9,459	36,254
Total Population	1,047	29,861	108,672
Average HH Income	\$39,263	\$38,987	\$39,966

MARK ADAME, CCIM, SIOR
mark@joeadame.com
O: 361.880.5888
C: 361.813.7245

JOEADAME.COM

100 S PADRE ISLAND DRIVE | CORPUS CHRISTI, TX 78405

Tract Size & Pricing

Zone: IL

*Large lots may be divided

Tract A:

3.65 acres platted (158,994 sqft)

\$6.00 per square foot

Tract B:

1.05 acres platted (45,738 sqft)

SOLD**Tract C:**

4.00 acres platted (210,394 sqft)

\$4.00 per square foot

Tract D:

4.34 acres platted (189,050 sqft)

\$4.00 per square foot

Tract E:

2.29 acres platted (99,752 sqft)

\$3.00 per square foot

Tract F:

5.48 acres un-platted (238,708 sqft)

\$3.00 per square foot

Tract G:

0.47 acres platted (20,473 sqft)

\$3.00 per square foot

Tract H:

2.10 acres un-platted (91,476 sqft)

\$3.00 per square foot

Tract I:

3.24 acres platted (141,134 sqft)

\$3.00 per square foot

Tract J:

7.30 acres platted (317,988 sqft)

\$3.00 per square foot

Tract K-2:

5.65 acres un-platted (246,114 sqft)

\$8.00 per square foot

Tract K-3:

7.03 acres un-platted (306,226 sqft)

\$8.00 per square foot

Call Durrill Properties for more information 361-884-8857

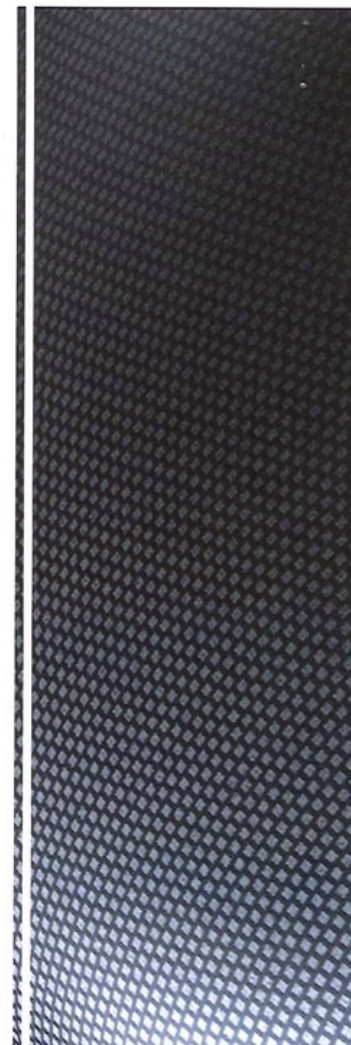

FOR SALE LAND DEVELOPMENT OPPORTUNITY

ADAME
COMMERCIAL
REAL ESTATE SOLUTIONS

100 S PADRE ISLAND DRIVE | CORPUS CHRISTI, TX 78405

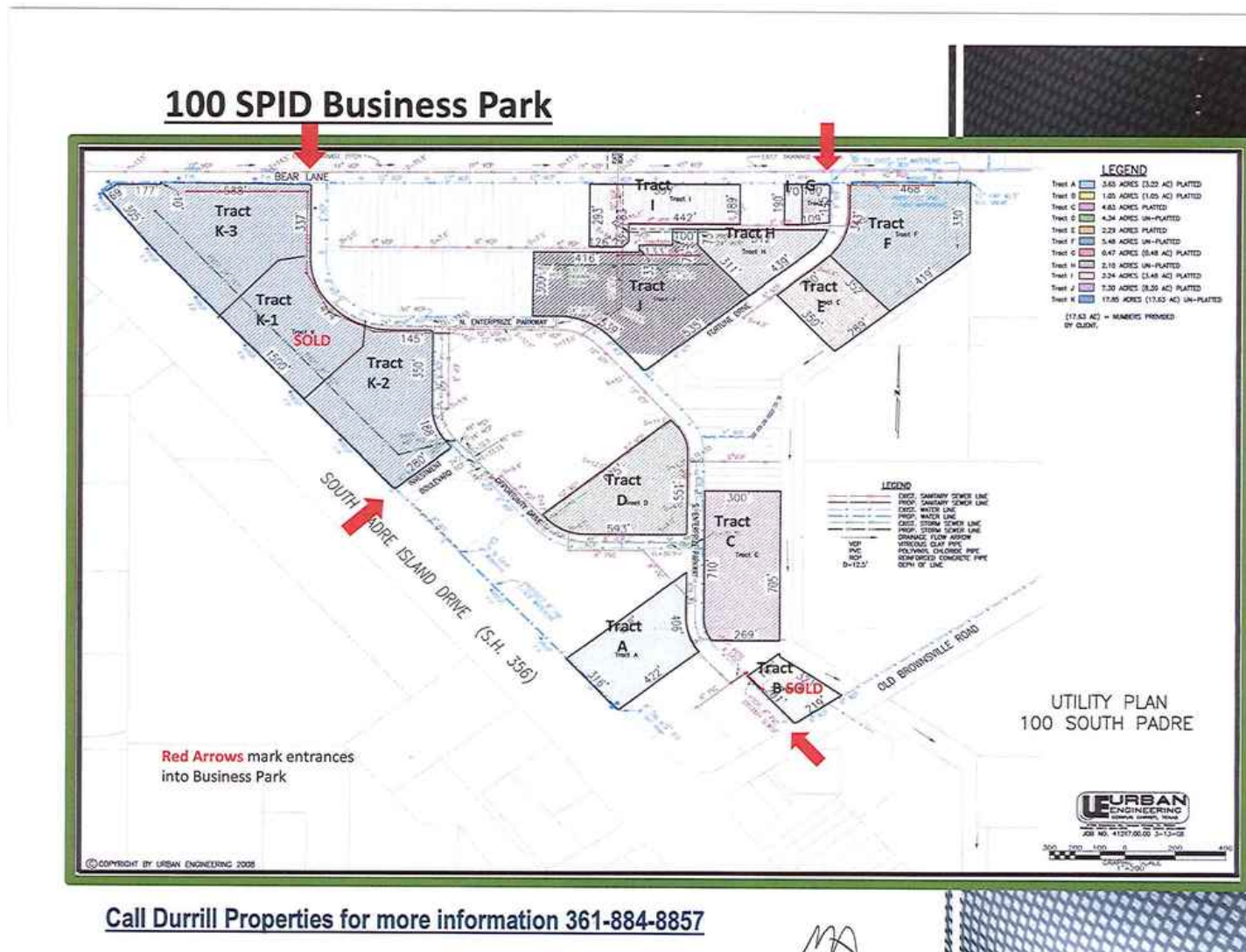

Call Durrill Properties for more information 361-884-8857

MARK ADAME, CCIM, SIOR
mark@joeadame.com
O: 361.880.5888
C: 361.813.7245

JOEADAME.COM

FOR SALE

LAND DEVELOPMENT OPPORTUNITY

ADAME
COMMERCIAL
REAL ESTATE SOLUTIONS

100 S PADRE ISLAND DRIVE | CORPUS CHRISTI, TX 78405

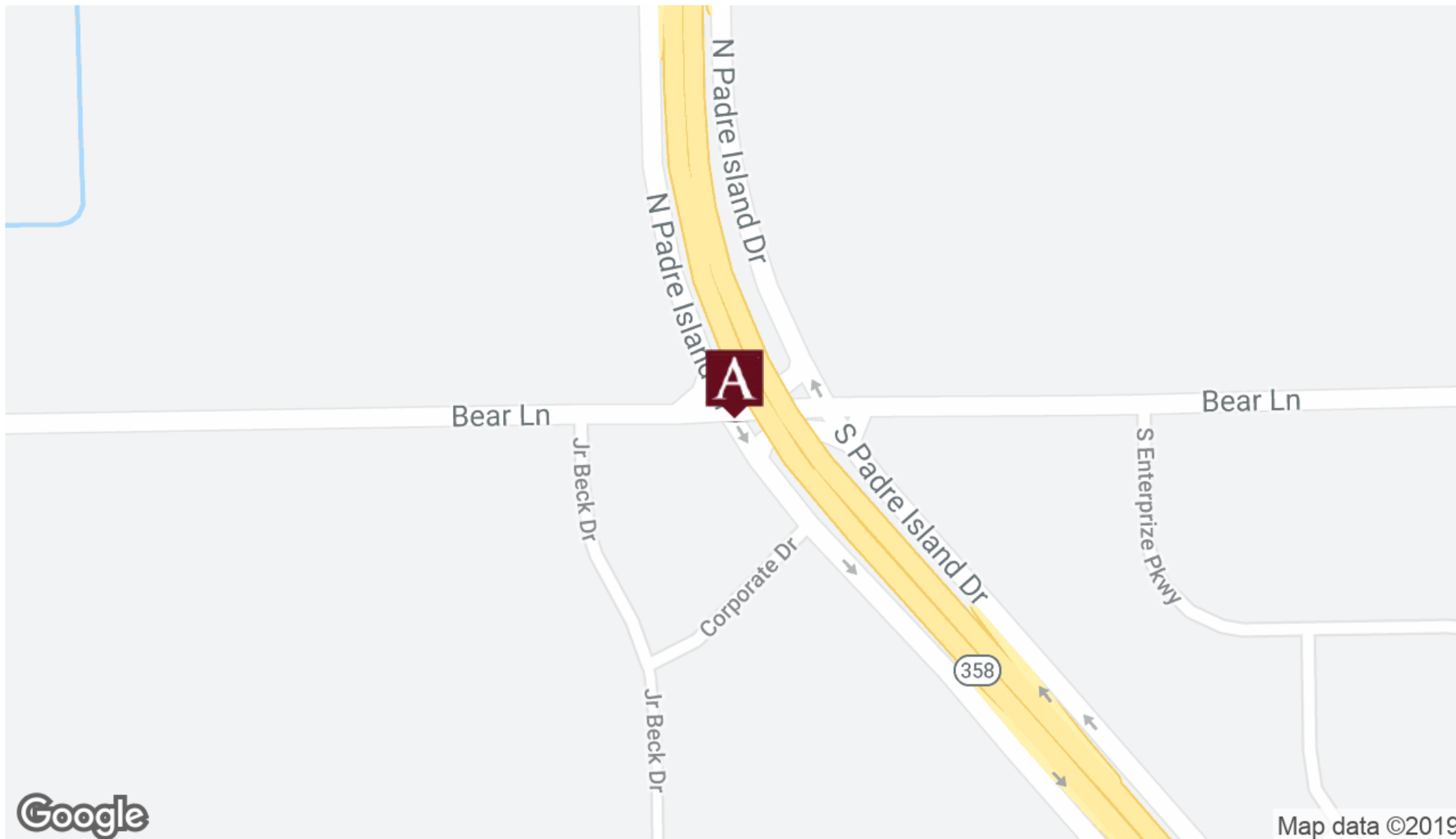

MARK ADAME, CCIM, SIOR
mark@joeadame.com
O: 361.880.5888
C: 361.813.7245

JOEADAME.COM

FOR SALE

LAND DEVELOPMENT OPPORTUNITY

ADAME
COMMERCIAL
REAL ESTATE SOLUTIONS

100 S PADRE ISLAND DRIVE | CORPUS CHRISTI, TX 78405

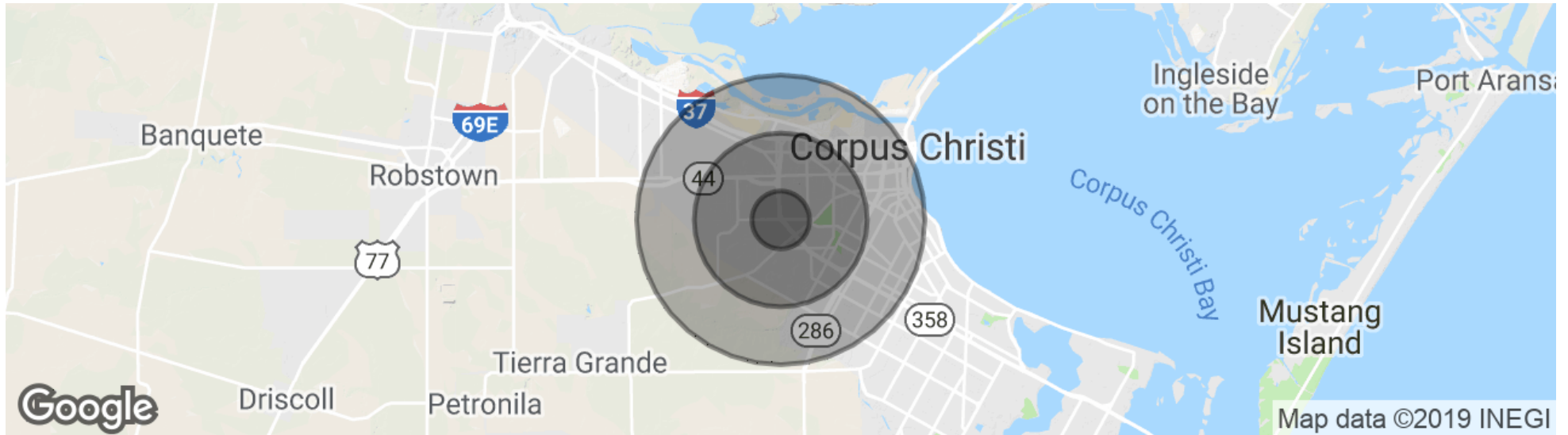

POPULATION

	1 MILE	3 MILES	5 MILES
Total population	1,047	29,861	108,672
Median age	30.4	34.8	34.4
Median age (Male)	27.6	32.0	32.9
Median age (Female)	32.7	37.1	35.6

HOUSEHOLDS & INCOME

	1 MILE	3 MILES	5 MILES
Total households	264	9,459	36,254
# of persons per HH	4.0	3.2	3.0
Average HH income	\$39,263	\$38,987	\$39,966
Average house value	\$49,700	\$58,631	\$67,267

** Demographic data derived from 2010 US Census*

MARK ADAME, CCIM, SIOR
mark@joadame.com
O: 361.880.5888
C: 361.813.7245

JOEADAME.COM



Information About Brokerage Services

Texas law requires all real estate license holders to give the following information about brokerage services to prospective buyers, tenants, sellers and landlords.



TYPES OF REAL ESTATE LICENSE HOLDERS:

- **A BROKER** is responsible for all brokerage activities, including acts performed by sales agents sponsored by the broker.
- **A SALES AGENT** must be sponsored by a broker and works with clients on behalf of the broker.

A BROKER'S MINIMUM DUTIES REQUIRED BY LAW (A client is the person or party that the broker represents):

- Put the interests of the client above all others, including the broker's own interests;
- Inform the client of any material information about the property or transaction received by the broker;
- Answer the client's questions and present any offer to or counter-offer from the client; and
- Treat all parties to a real estate transaction honestly and fairly.

A LICENSE HOLDER CAN REPRESENT A PARTY IN A REAL ESTATE TRANSACTION:

AS AGENT FOR OWNER (SELLER/LANDLORD): The broker becomes the property owner's agent through an agreement with the owner, usually in a written listing to sell or property management agreement. An owner's agent must perform the broker's minimum duties above and must inform the owner of any material information about the property or transaction known by the agent, including information disclosed to the agent or subagent by the buyer or buyer's agent.

AS AGENT FOR BUYER/TENANT: The broker becomes the buyer/tenant's agent by agreeing to represent the buyer, usually through a written representation agreement. A buyer's agent must perform the broker's minimum duties above and must inform the buyer of any material information about the property or transaction known by the agent, including information disclosed to the agent by the seller or seller's agent.

AS AGENT FOR BOTH - INTERMEDIARY: To act as an intermediary between the parties the broker must first obtain the written agreement of *each party* to the transaction. The written agreement must state who will pay the broker and, in conspicuous bold or underlined print, set forth the broker's obligations as an intermediary. A broker who acts as an intermediary:

- Must treat all parties to the transaction impartially and fairly;
- May, with the parties' written consent, appoint a different license holder associated with the broker to each party (owner and buyer) to communicate with, provide opinions and advice to, and carry out the instructions of each party to the transaction.
- Must not, unless specifically authorized in writing to do so by the party, disclose:
 - o that the owner will accept a price less than the written asking price;
 - o that the buyer/tenant will pay a price greater than the price submitted in a written offer; and
 - o any confidential information or any other information that a party specifically instructs the broker in writing not to disclose, unless required to do so by law.

AS SUBAGENT: A license holder acts as a subagent when aiding a buyer in a transaction without an agreement to represent the buyer. A subagent can assist the buyer but does not represent the buyer and must place the interests of the owner first.

TO AVOID DISPUTES, ALL AGREEMENTS BETWEEN YOU AND A BROKER SHOULD BE IN WRITING AND CLEARLY ESTABLISH:

- The broker's duties and responsibilities to you, and your obligations under the representation agreement.
- Who will pay the broker for services provided to you, when payment will be made and how the payment will be calculated.

LICENSE HOLDER CONTACT INFORMATION: This notice is being provided for information purposes. It does not create an obligation for you to use the broker's services. Please acknowledge receipt of this notice below and retain a copy for your records.

Joe Adame & Associates, Inc.	416864	joe@joeadame.com	361-880-5888
Licensed Broker /Broker Firm Name or Primary Assumed Business Name	License No.	Email	Phone
Joe Adame	145894	joe@joeadame.com	361-880-5888
Designated Broker of Firm	License No.	Email	Phone
Mark Adame	480169	mark@joeadame.com	361-880-5888
Licensed Supervisor of Sales Agent/ Associate	License No.	Email	Phone
Mark Adame	480169	mark@joeadame.com	361-880-5888
Sales Agent/Associate's Name	License No.	Email	Phone

Buyer/Tenant/Seller/Landlord Initials

Date