

NEC 112TH AVENUE & SHERIDAN BOULEVARD

NEW SHOPS AND PAD SITE AVAILABLE IN WESTMINSTER



INFORMATION

- Finished PAD Site available for Sale, Lease, or Build-to-Suit. **Offsites and onsite completed**
- New 10,096 SF multi-tenant shops coming
- Located at the full turning movement along 112th Avenue with new overpass at Highway 36 connecting with Arista
- Approximately 250 new multifamily units proposed across the street
- Total of 2 acres available; can be demised
- Strong residential densities and traffic

TRAFFIC COUNTS

On 112th Ave west of Sheridan Blvd	13,957 cars/day
On 112th Ave east of Sheridan Blvd	18,499 cars/day
On Sheridan Blvd north of 112th Ave	37,340 cars/day ¹
On Sheridan Blvd north of 104th Ave	38,486 cars/day ¹

Source: DRCOG 2011, ¹2016

DEMOGRAPHICS

	1 MILE	3 MILE	5 MILE
Est. Population	13,397	107,306	285,627
Avg Household Inc	\$106,310	\$94,635	\$84,864
Employees	2,840	40,147	107,873
Businesses	290	3,824	10,123

Demographics Source: Applied Geographic Solutions 2017

5570 DTC Parkway, Suite 100 | Greenwood Village, CO 80111 | 303.534.0900 Fax: 303.831.1333 | www.sullivanhayes.com

SullivanHayes
B R O K E R A G E

we are
RETAIL

A MEMBER OF
CHAINLINKS
RETAIL ADVISORS

AGENCY
DISCLOSURE

Bryan Slaughter
303.370.7459 | bslaughter@sullivanhayes.com

NEC 112TH AVENUE & SHERIDAN BOULEVARD

NEW SHOPS AND PAD SITE AVAILABLE IN WESTMINSTER

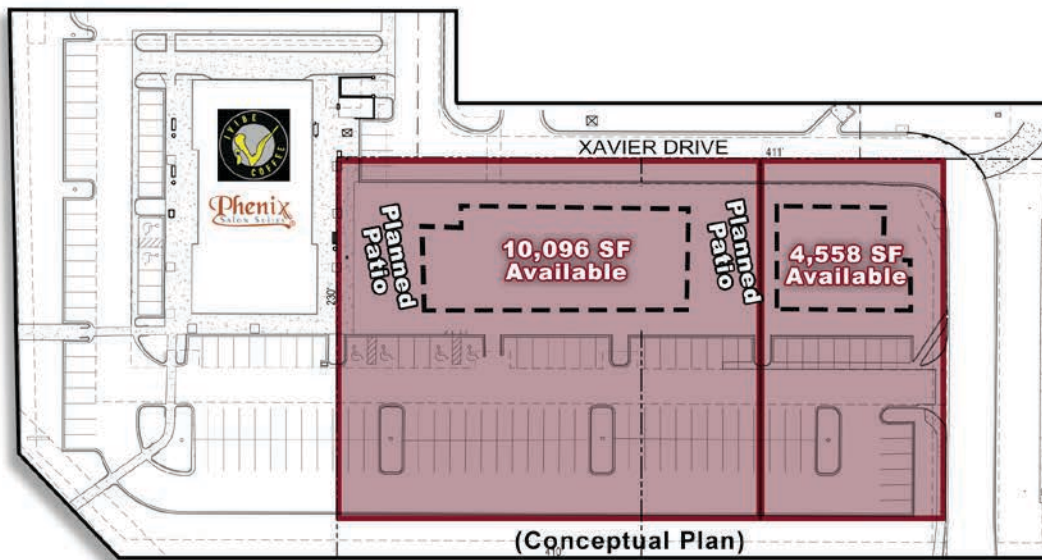

The information contained herein has been compiled from sources believed to be reliable. However, SullivanHayes has not independently verified the same and makes no guarantee, warranty or representation about such information. Any opinions, assumptions or projections used are for illustrative purposes only and do not necessarily represent the current or future performance of the property. Site plans, renderings, aerials, marketing data, pricing and other terms are subject to change at any time. You and your tax, financial and legal advisors should make a thorough independent investigation of the property to determine its suitability to your needs. SullivanHayes, its broker associates and its salespersons, are or will be acting as agents of the seller/lessor with the duty to represent the interests of the seller/lessor. SullivanHayes will not act as your agent unless an agency agreement is signed and in effect.