



RETAIL PROPERTY FOR LEASE

6135 E. VIRGINIA BEACH BOULEVARD

NORFOLK, VA 23502



6135 E. VIRGINIA BEACH BOULEVARD

NORFOLK, VA 23502

PROPERTY OVERVIEW



OFFERING SUMMARY

Available SF:	10,908 SF
Lease Rate:	Negotiable
Building Size:	10,908 SF

PROPERTY OVERVIEW

This former Rite Aid is located on the southwest corner of Virginia Beach Boulevard at Kempsville Road in Norfolk just east of Janaf and Military Circle Mall.

PROPERTY HIGHLIGHTS

- Visible from Interstate 64
- Across from Rick Hendrick Chevrolet
- Just north of Sentara Leigh Hospital

DEMOGRAPHICS

	1 Mile	3 Miles	5 Miles
Total Households:	2,426	32,226	106,722
Total Population:	7,022	86,042	287,689
Average HH Income:	\$56,235	\$65,107	\$62,909

6135 E. VIRGINIA BEACH BOULEVARD

NORFOLK, VA 23502

FLOOR PLAN

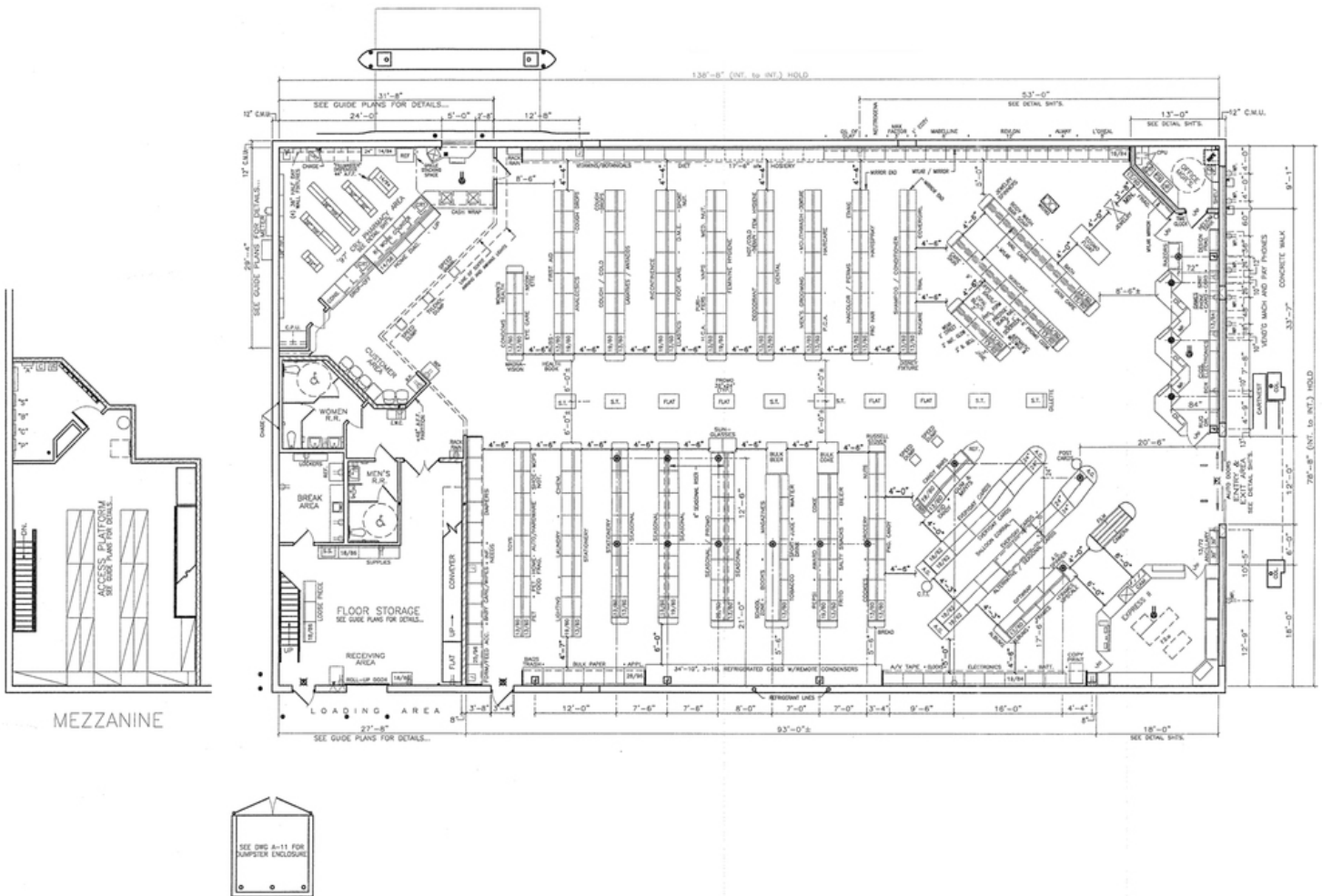

6135 E. VIRGINIA BEACH BOULEVARD

NORFOLK, VA 23502

SITE PLAN

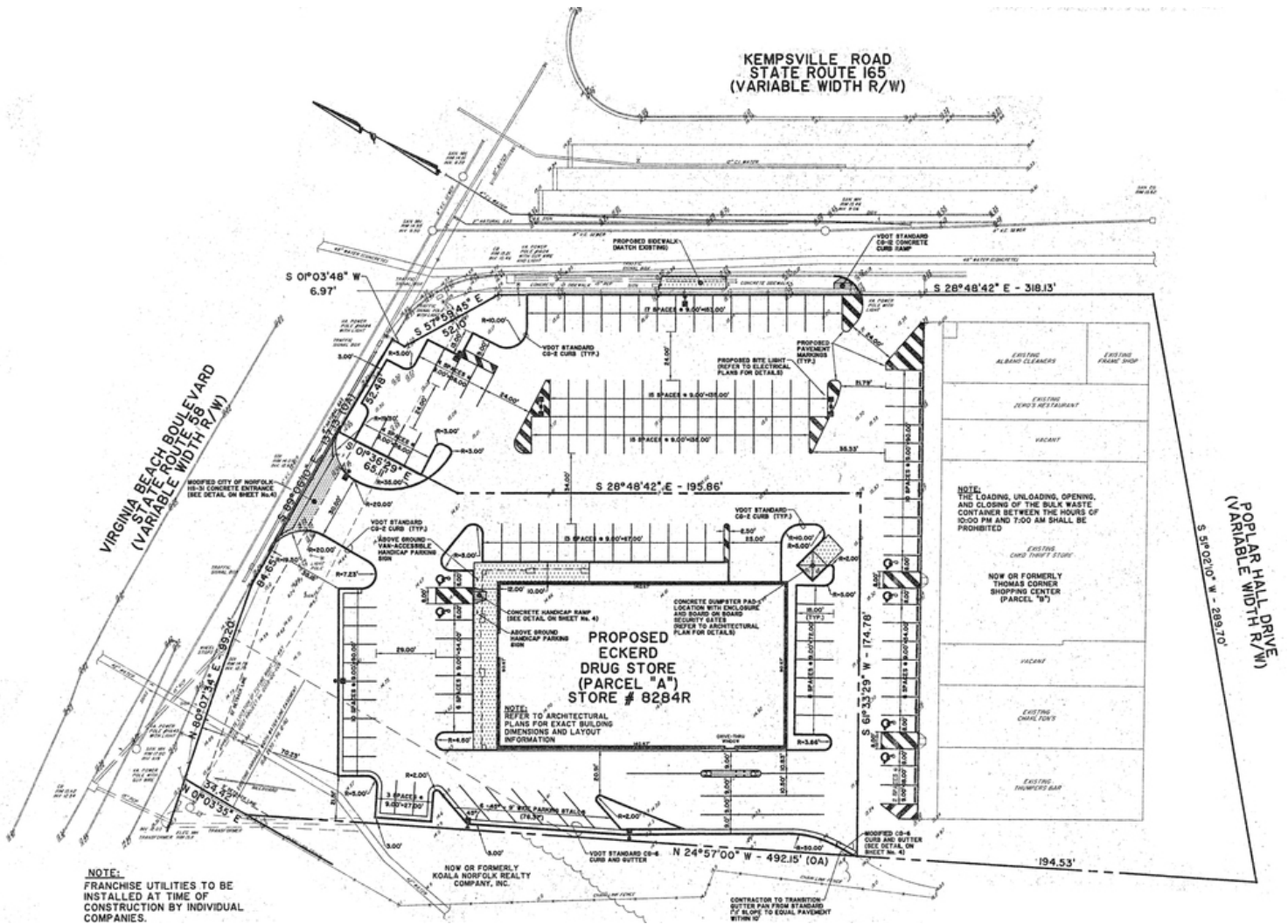

RETAILER MAP

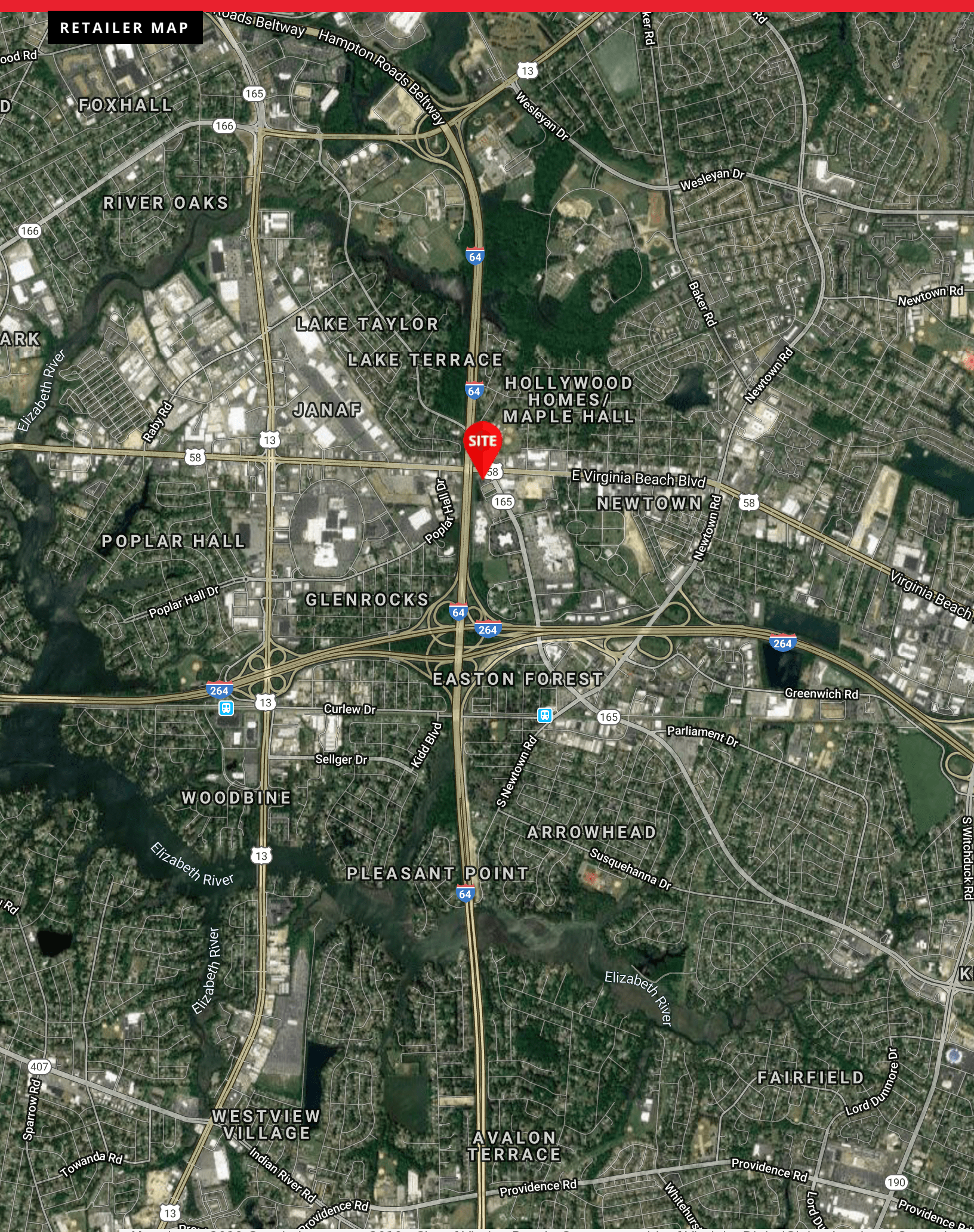

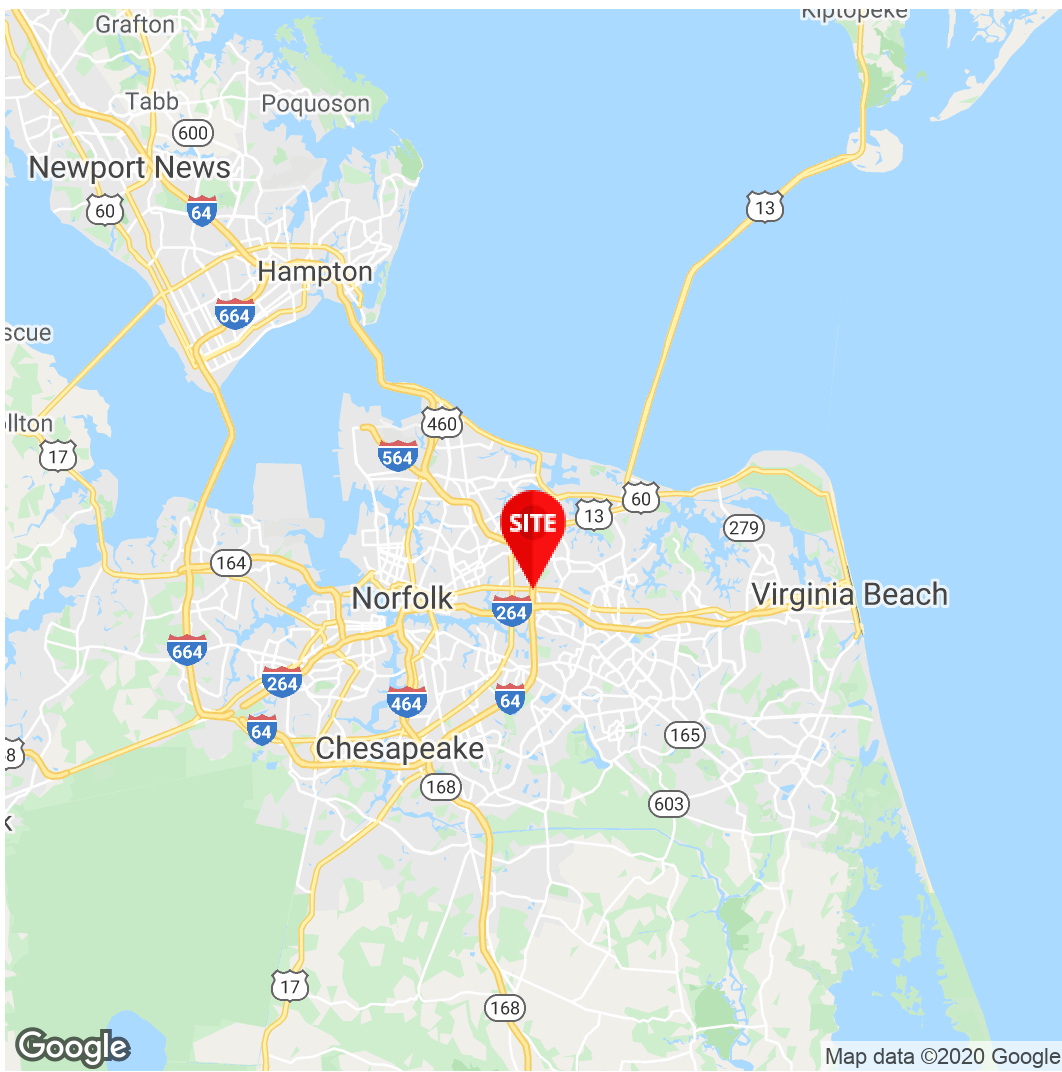

Levi Thomson
 Senior Vice President
 757.333.4382
 Lthomson@divaris.com

Kris Fuller
 Sales And Leasing
 Associate
 757.333.4321
 Kris.fuller@divaris.com



The information contained herein should be considered confidential and remains the sole property of Divaris Real Estate, Inc. at all times. Although every effort has been made to ensure accuracy, no liability will be accepted for any errors or omissions. Disclosure of any information contained herein is prohibited except with the express written permission of Divaris Real Estate, Inc.