

ASH BUSINESS CENTER



UNDER NEW OWNERSHIP

OFFICE // FLEX // WAREHOUSE

4670-5010 SOUTH ASH AVENUE // TEMPE // ARIZONA

FOR MORE INFORMATION:

Leroy Breinholt
o. 480.966.6593
c. 602.377.4687
lbreinholt@cpiaz.com

Darin Edwards
o. 480.214.1117
c. 480.628.8661
dedwards@cpiaz.com

Commercial Properties Inc.
2323 W. University Dr.
Tempe, AZ
www.cpiaz.com

PROPERTY FEATURES

- » ±6,300 SF Suite Available For Lease
- » GID Zoned, City of Tempe
- » Grade Level Loading
- » 14' - 16' Minimum Clear Height
- » Ample Parking
- » Convenient access Multiple Freeways
- » Pending Improvements: Landscape, Exterior Paint, Roof, HVAC, Signage
- » Contact Broker for Lease Rate



The information contained herein is believed to be accurate but is not warranted as to its accuracy and may change or be updated without notice. Seller or landlord makes no representation as to the environmental condition of the property and recommends purchaser's or tenant's independent investigation. 05 01 18

ASH BUSINESS CENTER

SITE PLAN

■ AVAILABLE

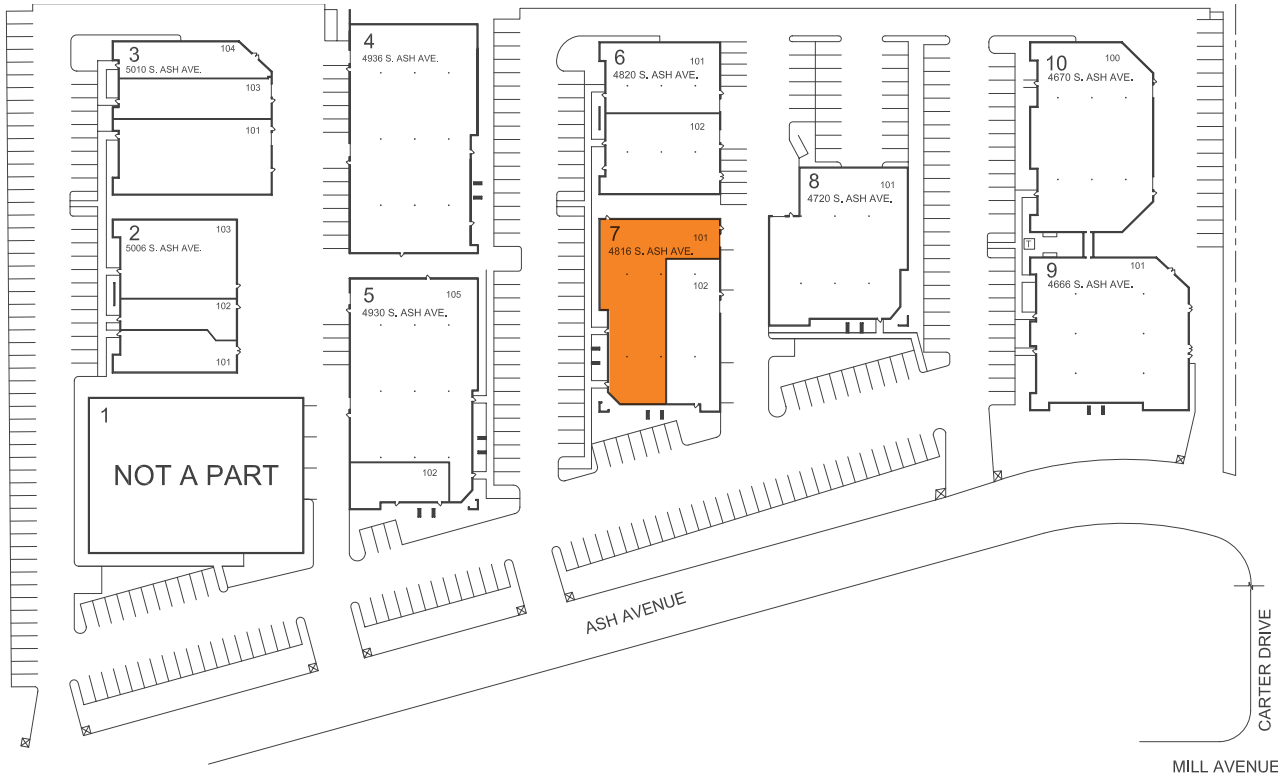

FOR MORE INFORMATION

Leroy Breinholt
 o. 480.966.6593
 c. 602.377.4687
 lbreinholt@cpi.az.com

Darin Edwards
 o. 480.214.1117
 c. 480.628.8661
 dedwards@cpi.az.com

AVAILABILITIES

BUILDING	SUITE	TOTAL SF	OFFICE%	COMMENTS
4816	101	6,300	70-100%	Reception area, 5 offices, conference room, bullpen, break room, 2 large ultra-stall restrooms, & 100% A/C cooled.

ASH BUSINESS CENTER
 4670-5010 SOUTH ASH AVENUE
 TEMPE, AZ



COMMERCIAL PROPERTIES INC.
 Locally Owned. Globally Connected. SPAC
 TEMPE: 2323 W. University Drive, Tempe, AZ 85281 | 480.966.2301
 SCOTTSDALE: 7025 N. Scottsdale Rd., Suite 220, Scottsdale, AZ 85253 | www.cpi.az.com



ASH BUSINESS CENTER

4816 S AVENUE SUITE 101



INTERIOR SHOTS

FOR MORE INFORMATION:

Leroy Breinholt
o. 480.966.6593
c. 602.377.4687
lbreinholt@cpiaz.com

Darin Edwards
o. 480.214.1117
c. 480.628.8661
dedwards@cpiaz.com

ASH BUSINESS CENTER
4670-5010 SOUTH ASH AVENUE
TEMPE, AZ

 **COMMERCIAL PROPERTIES INC.**
Locally Owned. Globally Connected. 
TEMPE: 2323 W. University Drive, Tempe, AZ 85281 | 480.966.2301
SCOTTSDALE: 7025 N. Scottsdale Rd., Suite 220, Scottsdale, AZ 85253 | www.cpiaz.com

 **bkm**
CAPITAL
PARTNERS

ASH BUSINESS CENTER

SITE PLAN - 4816

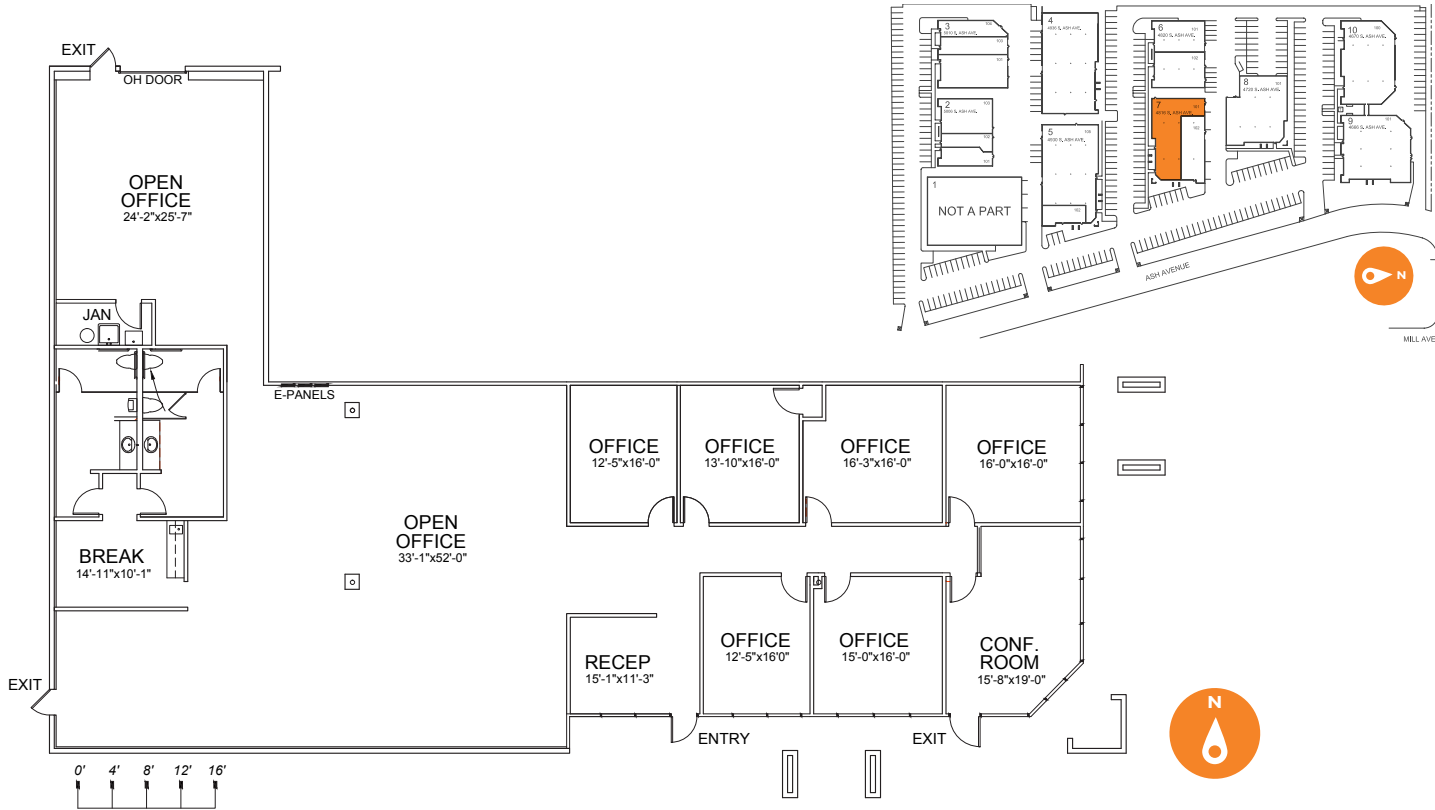

FOR MORE INFORMATION

Leroy Breinholt
 o. 480.966.6593
 c. 602.377.4687
 lbreinholt@cpiaz.com

Darin Edwards
 o. 480.214.1117
 c. 480.628.8661
 dedwards@cpiaz.com

AVAILABILITIES

BUILDING	SUITE	TOTAL SF	OFFICE%	COMMENTS
4816	101	6,300	70-100%	Reception area, 5 offices, conference room, bullpen, break room, 2 large ultra-stall restrooms, & 100% A/C cooled.

ASH BUSINESS CENTER
 4670-5010 SOUTH ASH AVENUE
 TEMPE, AZ

ASH BUSINESS PARK



FOR MORE INFORMATION:

Leroy Breinholt
o. 480.966.6593
c. 602.377.4687
lbreinholt@cpiaz.com

Darin Edwards
o. 480.214.1117
c. 480.628.8661
dedwards@cpiaz.com

ASH BUSINESS CENTER
4670-5010 SOUTH ASH AVENUE
TEMPE, AZ

ASH BUSINESS CENTER

AMENITIES

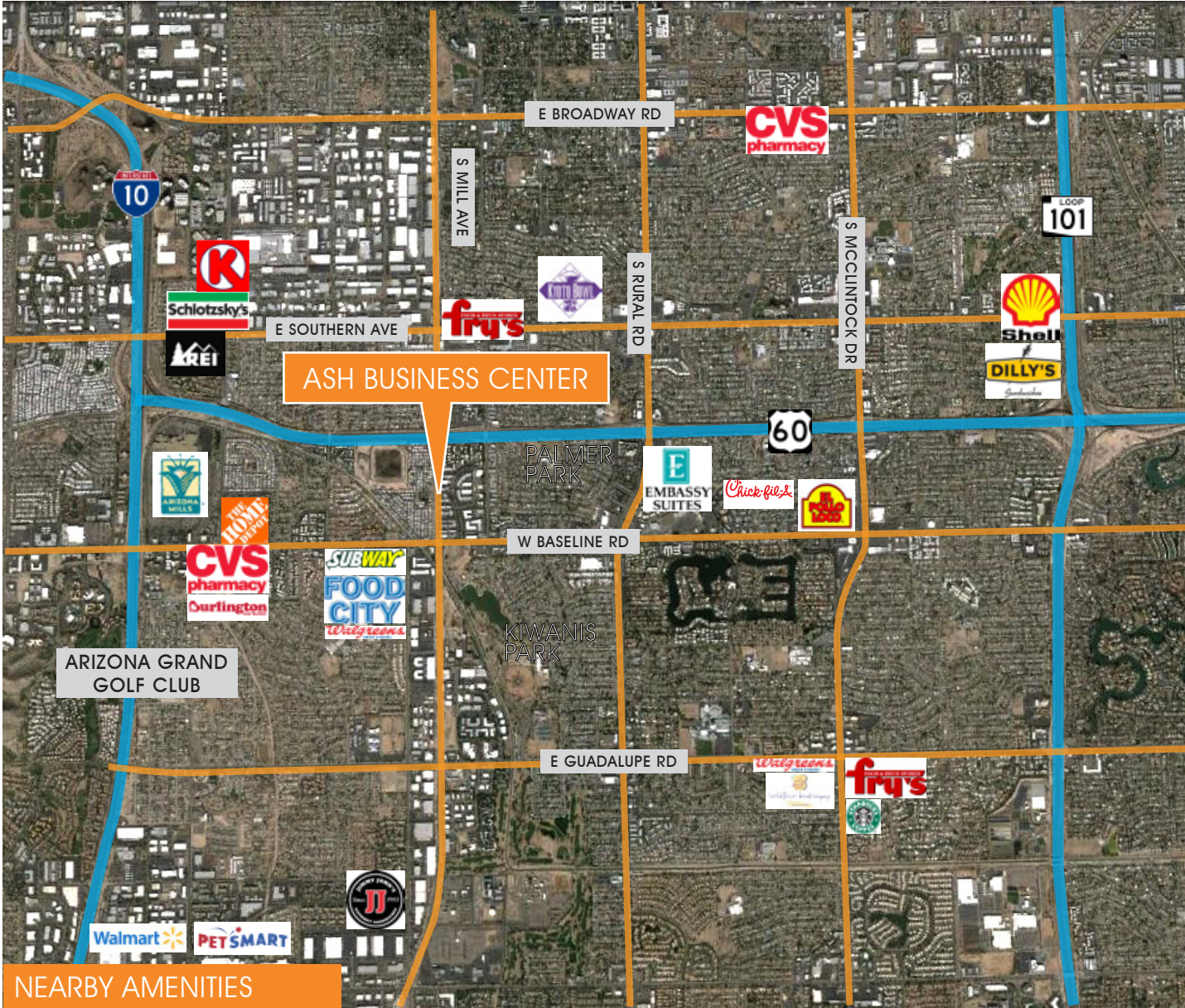

NEARBY AMENITIES

FOR MORE INFORMATION:

Leroy Breinholt
o. 480.966.6593
c. 602.377.4687
lbreinholt@cpiaz.com

Darin Edwards
o. 480.214.1117
c. 480.628.8661
dedwards@cpiaz.com

ASH BUSINESS CENTER
4670-5010 SOUTH ASH AVENUE
TEMPE, AZ

ASH BUSINESS PARK



FOR MORE INFORMATION:

Leroy Breinholt
o. 480.966.6593
c. 602.377.4687
lbreinholt@cpi.az.com

Darin Edwards
o. 480.214.1117
c. 480.628.8661
dedwards@cpi.az.com

ASH BUSINESS CENTER
4670-5010 SOUTH ASH AVENUE
TEMPE, AZ



Locally Owned. Globally Connected. 

TEMPE: 2323 W. University Drive, Tempe, AZ 85281 | 480.966.2301
SCOTTSDALE: 7025 N. Scottsdale Rd., Suite 220, Scottsdale, AZ 85253 | www.cpi.az.com

