

14492-14500 SHELDON RD
PLYMOUTH, MICHIGAN

OFFICE FOR LEASE

4,147 – 23,000 Square Feet Available



**SIGNATURE
ASSOCIATES**
KNOW SIGNATURE | KNOW RESULTS

PLYMOUTH EXECUTIVE PARK



PROPERTY FEATURES

- 4,147 – 23,000 square feet available
- Convenient access to M-14, I-275 and I-96
- Attractive leasehold improvements
- Sprinklers
- Available immediately
- Lease Rate: \$12.50/sf NNN

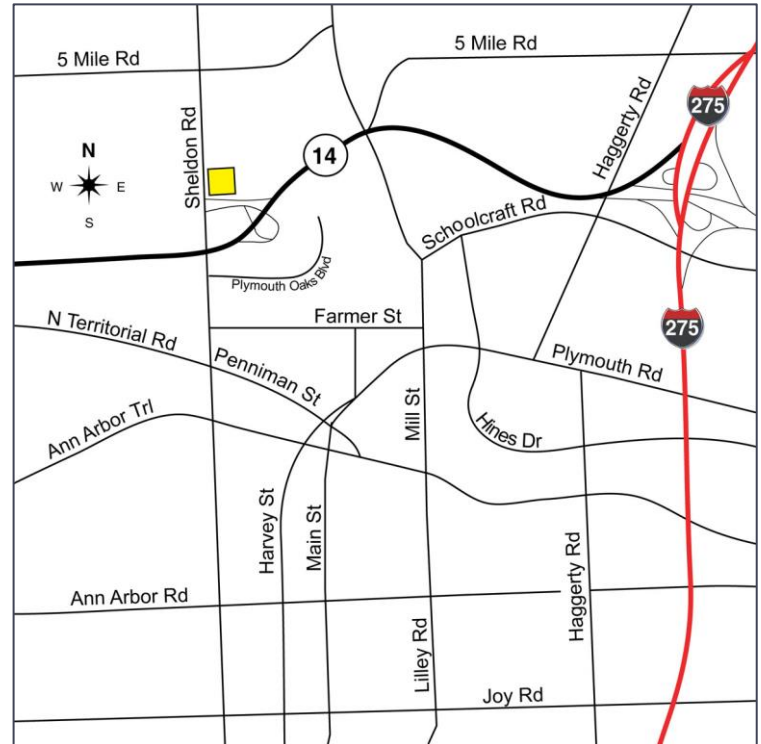

For more information, please contact:

DAVE GREEN

(248) 948 4184

dgreen@signatureassociates.com

SIGNATURE ASSOCIATES

One Towne Square, Suite 1200

Southfield, MI 48076

www.signatureassociates.com

Information is subject to verification and no liability for errors or omissions is assumed. Price is subject to change and listing withdrawal.

14492 - 14500 Sheldon Road - Plymouth, Michigan

Office For Lease

4,147 - 23,000
Square Feet
AVAILABLE

14496 Sheldon
Suite 200 | 23,000 RSF

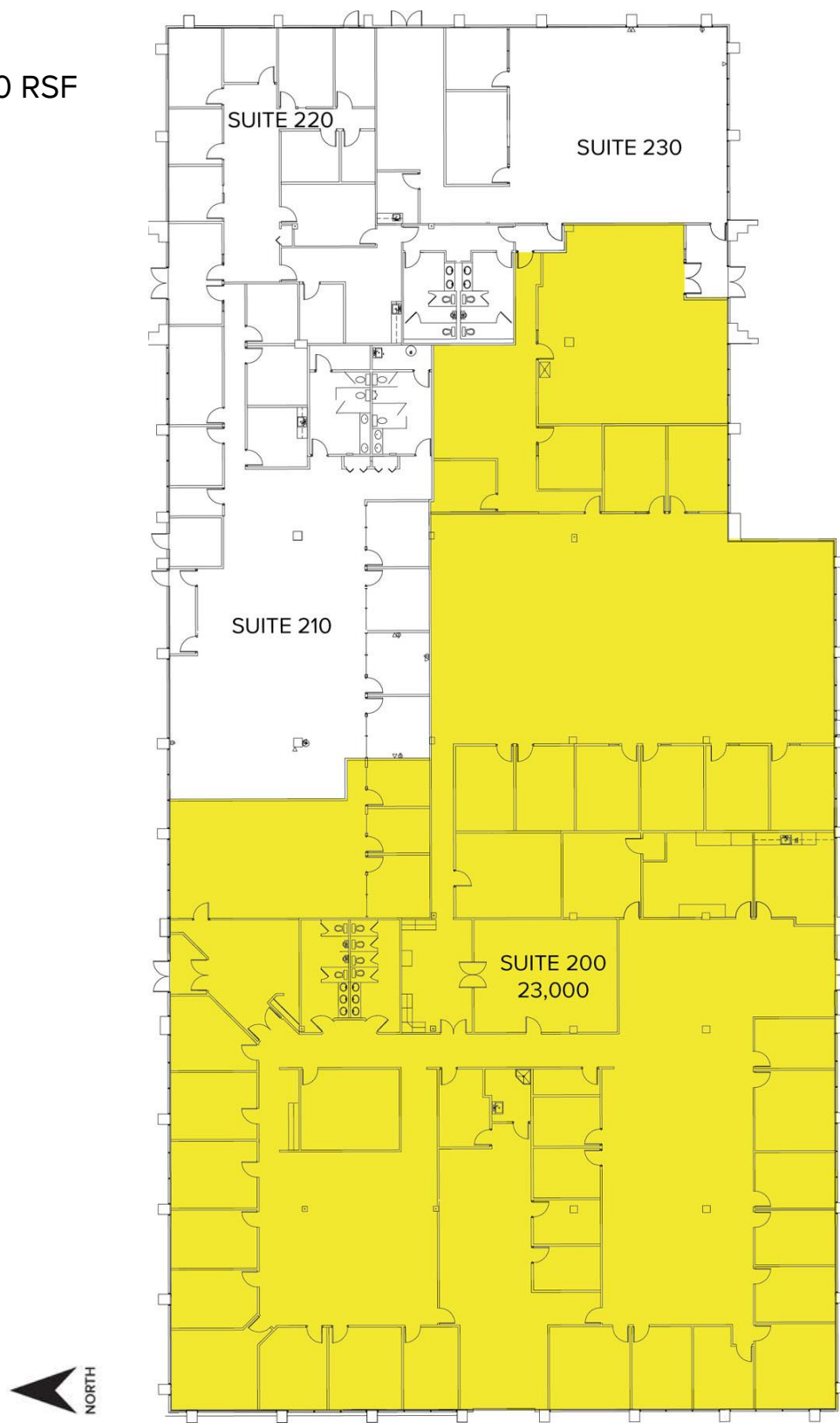

For more information, please contact:

DAVE GREEN
(248) 948 4184
dgreen@signatureassociates.com

SIGNATURE ASSOCIATES
One Towne Square, Suite 1200
Southfield, MI 48076
www.signatureassociates.com

14492 - 14500 Sheldon Road - Plymouth, Michigan

Office For Lease

4,147 - 23,000
Square Feet
AVAILABLE

14500 Sheldon - Suite 120 | 4,147 SF



For more information, please contact:

DAVE GREEN
(248) 948 4184
dgreen@signatureassociates.com

SIGNATURE ASSOCIATES
One Towne Square, Suite 1200
Southfield, MI 48076
www.signatureassociates.com