

FOR LEASE

1305 TACOMA AVENUE

TACOMA, WA 98402



PROPERTY INFO

- + 8,214 RSF available, divisible to ±2,710 SF
- + \$22 PSF, Full Service
- + 4/1,000 parking
- + Signage available
- + Storage space available
- + Easy customer parking
- + Coffee shop on site

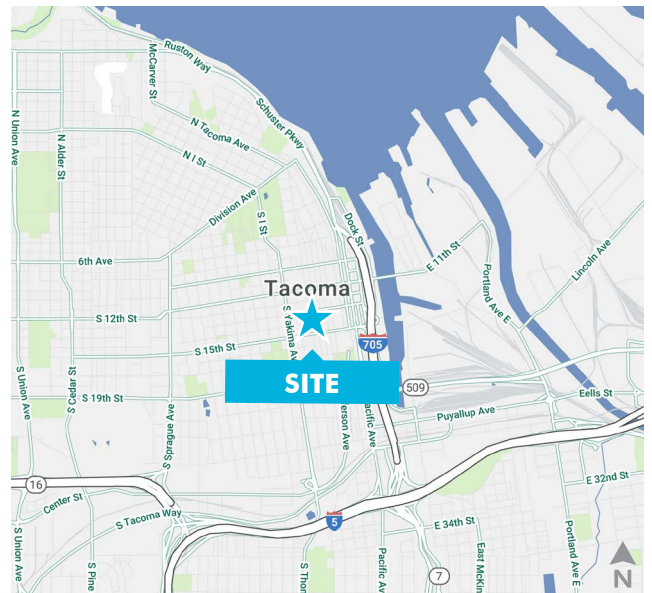

CONTACT US

JOHN BAUDER

First Vice President
+1 253 596 0047
john.bauder@cbre.com

HARRISON LAIRD

Vice President
+1 253 596 0030
harrison.laird@cbre.com

CBRE, INC.

1201 Pacific Avenue
Suite 1502
Tacoma, WA 98402

www.cbre.us/tacoma

CBRE

FOR LEASE 1305 TACOMA AVENUE

TACOMA, WA 98402



SECOND FLOOR

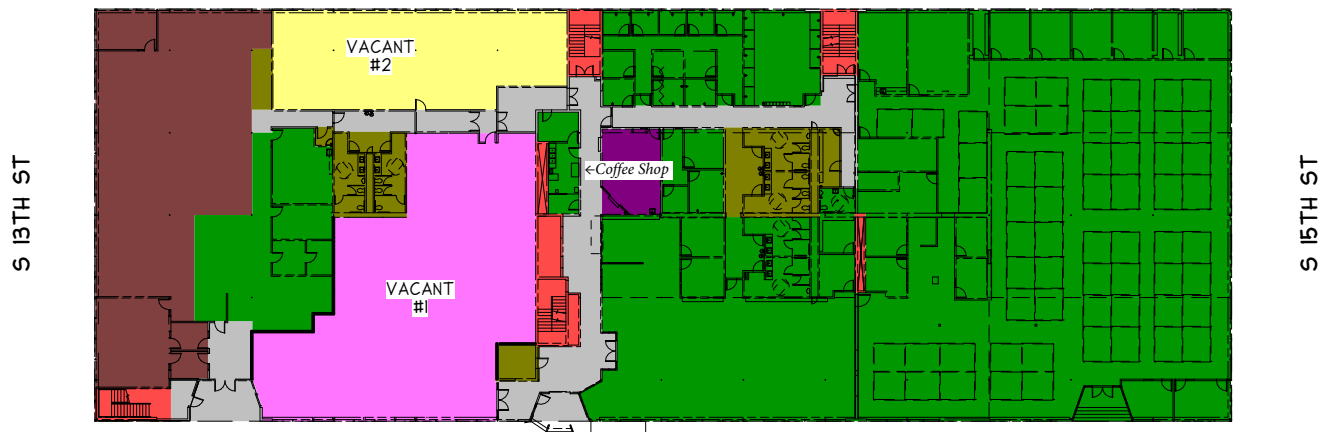

- SERVICE & AMENITY AREAS
- VERTICAL PENETRATIONS
- COMMON CIRCULATION
- TENANT: VACANT #1 5,504 SF
- TENANT: VACANT #2 2,710 SF

TACOMA AVENUE

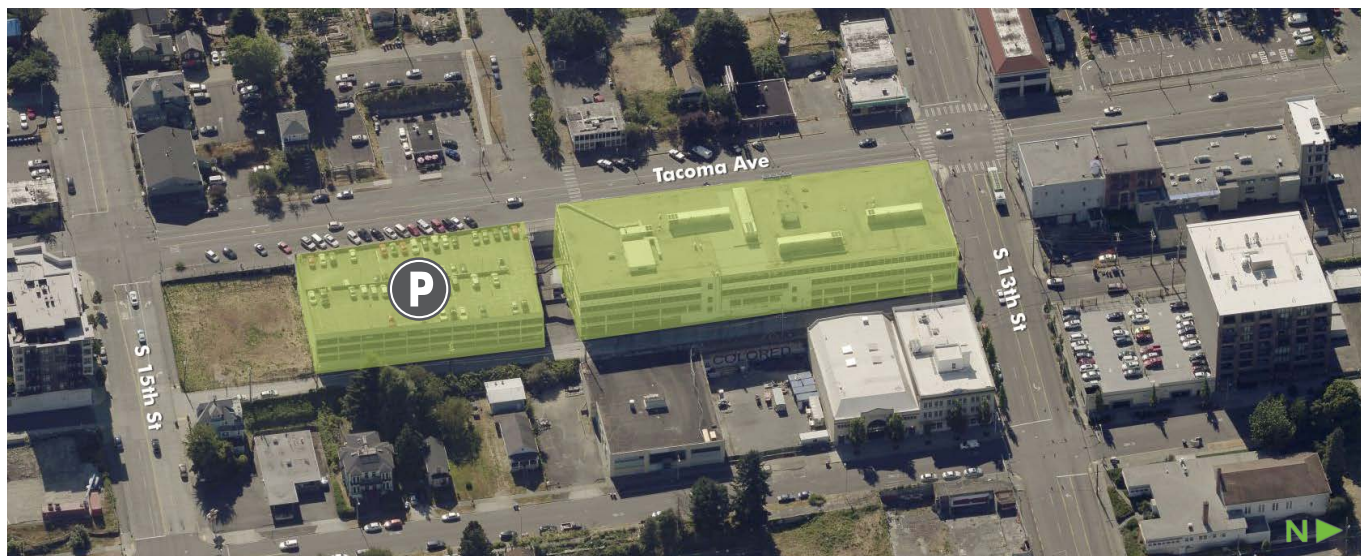

© 2019 CBRE, Inc. All rights reserved. This information has been obtained from sources believed reliable, but has not been verified for accuracy or completeness. You should conduct a careful, independent investigation of the property and verify all information. Any reliance on this information is solely at your own risk. CBRE and the CBRE logo are service marks of CBRE, Inc. All other marks displayed on this document are the property of their respective owners, and the use of such logos does not imply any affiliation with or endorsement of CBRE. Photos herein are the property of their respective owners. Use of these images without the express written consent of the owner is prohibited. rb 07.24.19