

# FOR LEASE Tye City Building

ENTIRE BUILDING AVAILABLE - 3828 RSF



206 E. Main Street  
Monroe, WA 98272

Unit A (Main):	959 RSF	UNIT C:	883 RSF
Unit B (Main):	1,088 RSF	UNIT D:	899 RSF

- Prime downtown Monroe location
- High traffic storefront visibility
- Can subdivide into 4 separate suites
- Available for sale w/ 7-11 (one parcel)
- 19 total stalls (w/ 7-Eleven), street parking
- Close proximity to SR 522 and Hwy 2
- Ideal for professional services
- \$14.00 PSF, NNN

For additional information, or to schedule a tour, please contact:

**BRENT NELSON**  
425.455.2664  
brent@saratogaeq.com



**SARATOGA**  
EQUITIES

[WWW.SARATOGAEQUITIES.COM](http://WWW.SARATOGAEQUITIES.COM)



# Tye City Building

3828 SF—Entire Bldg.

Unit A:	959 RSF	UNIT C:	883 RSF
Unit B:	1,088 RSF	UNIT D:	899 RSF

NORTH →

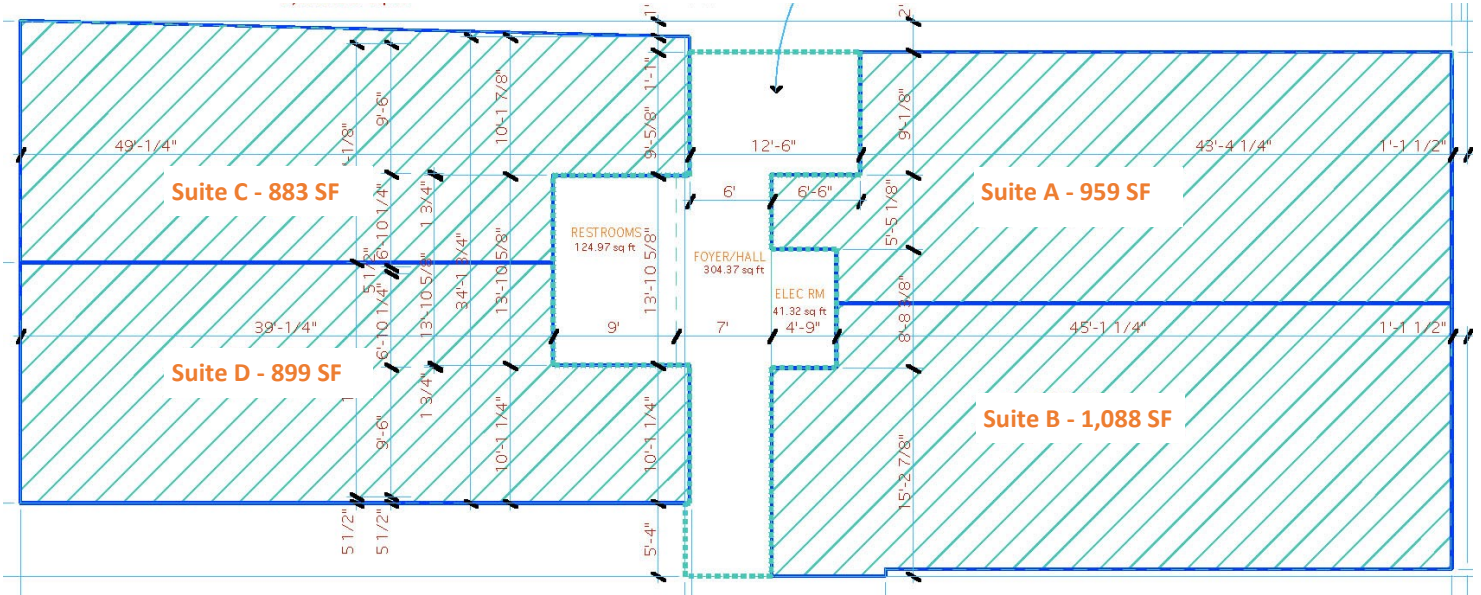

Unit A:	2,047 RSF
Unit B:	1,782 RSF

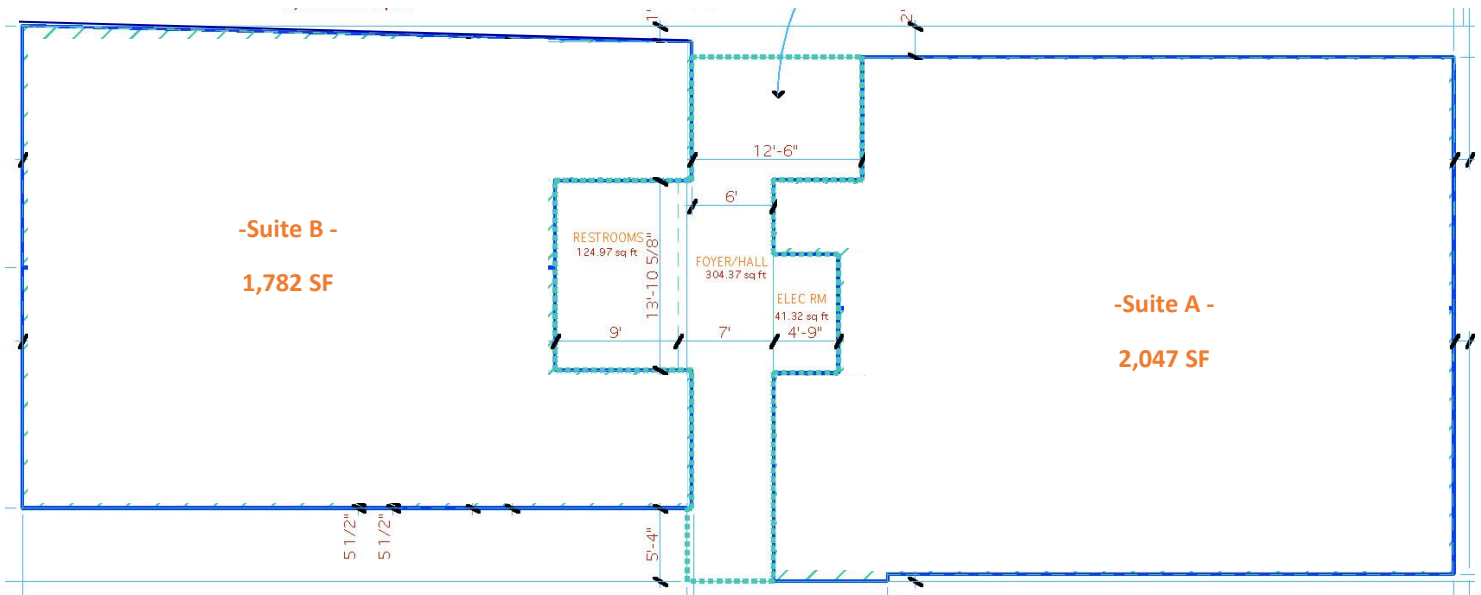

**SARATOGA**  
EQUITIES

[WWW.SARATOGAEQUITIES.COM](http://WWW.SARATOGAEQUITIES.COM)