

## LOCATION

Building G  
12047 NE Glenn Widing Dr  
Portland OR 97219

## TOTAL SQ.FT. OFFICE SQ.FT.

15,611 sq.ft.  
BTS

## DOCK-HIGH DOORS DRIVE-IN DOORS CLEAR HEIGHT

6  
1  
18'

## FEATURES

End-cap space  
Excellent access to I-205 and  
Portland International Airport

## RATE

\$.60/sq.ft. - Shell  
\$.90/sq.ft. - Office  
NNN

## LEASING CONTACT

Jake Bigby  
jakeb@PacTrust.com  
360-737-6300



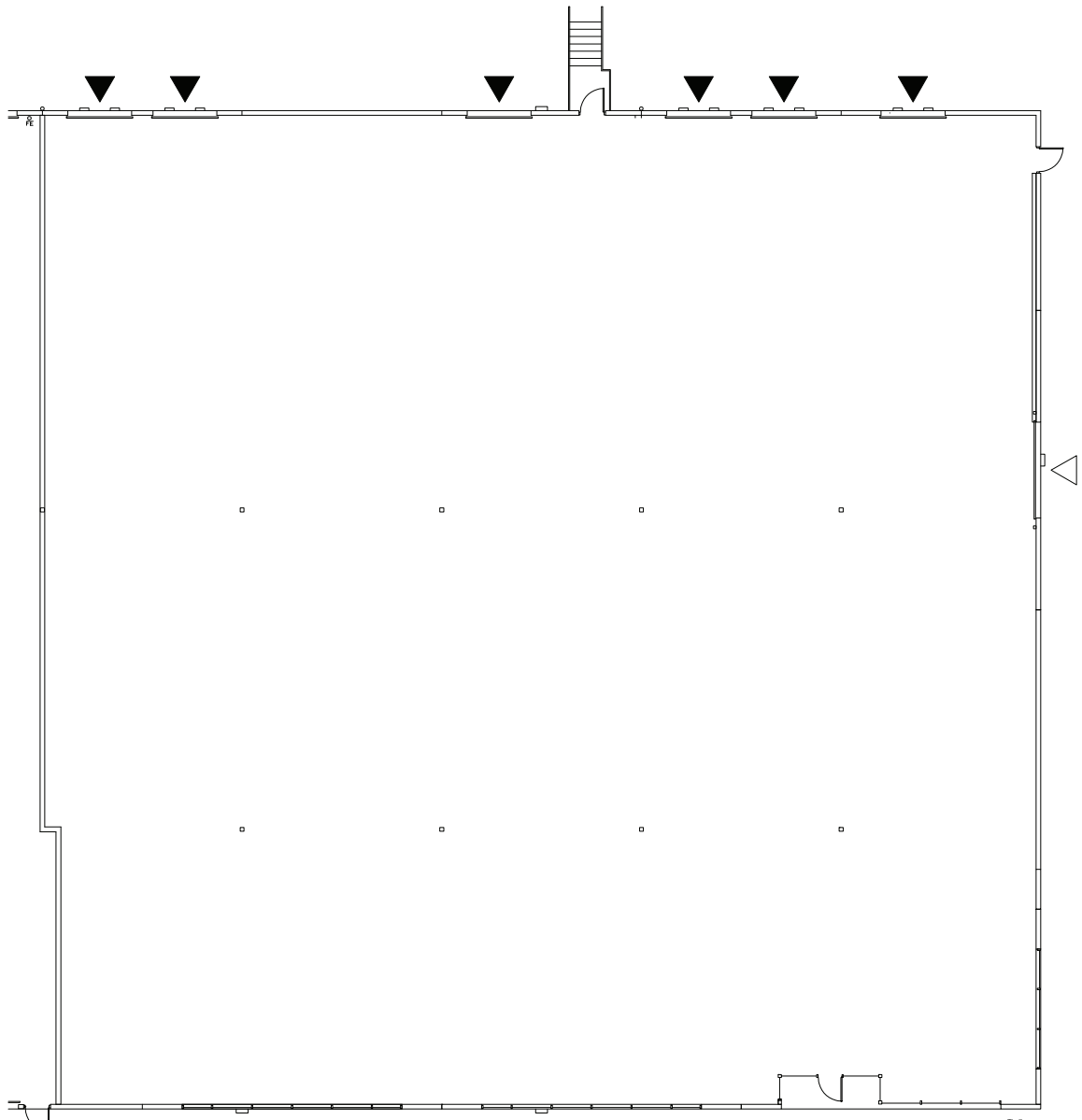

**FLOOR PLAN**



- ▽ GRADE ACCESS
- ▼ DOCK ACCESS

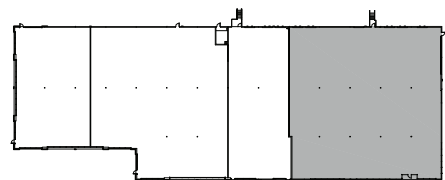
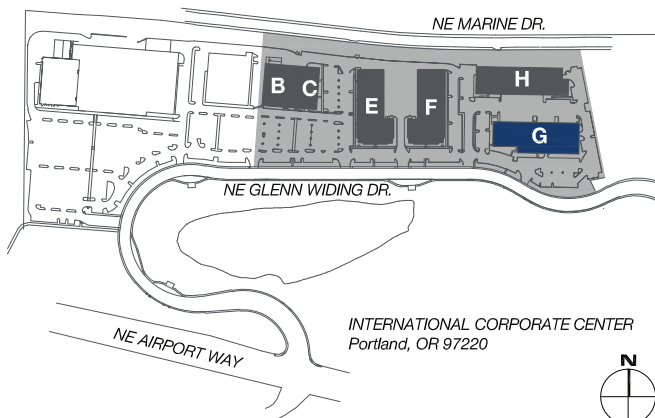

**BUILDING PLAN**

