

# Queen Creek Marketplace

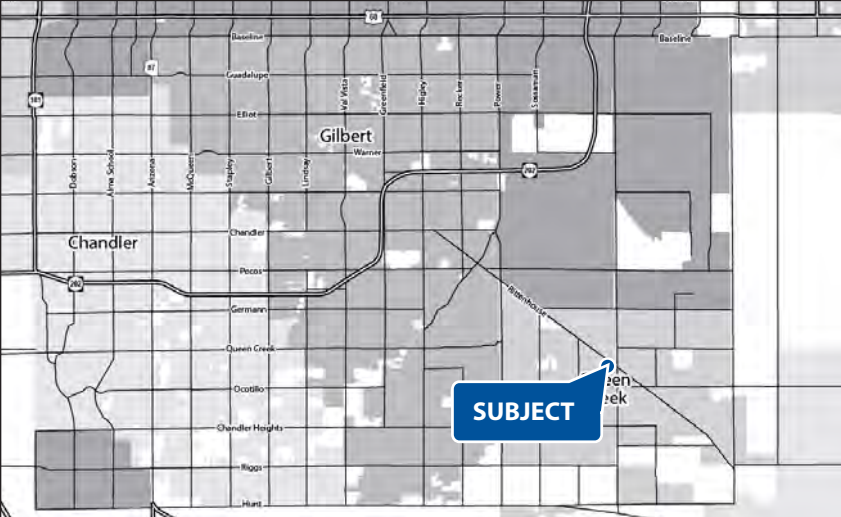

**NOW OPEN!**



## SHOP SPACE & PADS AVAILABLE

### ADDRESS

• 21398 S Ellsworth Loop Road | Queen Creek, AZ 85142

### AVAILABILITY

- Shop Space & End Caps Available
- 7 Pads Available
- 3,980 SF End Cap with Potential Patio
- 2,826 SF

### FEATURES

- The project features a tenant mix of over 35 national retailers including Super-Target, Kohl's, TJ Maxx, Ross and Harkins.

- Traffic Counts  
S Rittenhouse Road & S Ellsworth Loop Road - 34,100 cpd  
S Ellsworth Loop Rd & E Ocotillo Road - 35,900 cpd  
Loop 202 - 125,000 cpd

### NOTABLE TENANTS

- Super Target
- PetsMart
- Bed Bath & Beyond
- Old Navy
- Ross
- Kohl's
- Pita Jungle
- T.J. Maxx

### COMING SOON!



| 2019 Demographics    | 1 MILE    | 3 MILE    | 5 MILE    |
|----------------------|-----------|-----------|-----------|
| Estimated Population | 8,863     | 50,816    | 126,188   |
| Avg Household Income | \$103,495 | \$116,741 | \$110,366 |
| Daytime Population   | 10,154    | 41,816    | 95,663    |

**Matt Milinovich**  
D 480 423 7959  
C 602 885 9393  
matt.milinovich@avisonyoung.com

**James DeCremer**  
D 480 423 7958  
C 602 909 0957  
james.decremer@avisonyoung.com

2777 E Camelback Road  
Suite 230  
Phoenix, AZ 85016  
avisonyoung.com





| #              | TENANT                       | SIZE     |
|----------------|------------------------------|----------|
| <b>Shops A</b> |                              |          |
| 1              | Alliance Urgent Care         | 3,905 sf |
| 4              | Great Clips                  | 1,000 sf |
| 6              | Massage Envy                 | 3,000 sf |
| 8              | Sprint                       | 2,175 sf |
| 10             | Tips and Toes                | 1,425 sf |
| 11             | The Joint                    | 1,495 sf |
| 13             | Pacific Dental               | 3,950 sf |
| <b>Shops B</b> |                              |          |
| B101           | Torrid                       | 3,000 sf |
| B102           | Pressed for Time Dry Cleaner | 1,230 sf |
| B103           | V's Barber Shop              | 1,000 sf |
| B104           | Available                    | 1,500 sf |
| B105           | 360 PT                       | 3,500 sf |
| B106           | Available                    | 2,800 sf |

| #              | TENANT                | SIZE     |
|----------------|-----------------------|----------|
| <b>Shops C</b> |                       |          |
| 1-2            | Maurice's             | 4,000 sf |
| 3-4            | Americas Best Eyewear | 3,500 sf |
| 5              | Available             | 2,826 sf |
| 6              | GNC                   | 1,350 sf |
| 7              | Sally Beauty          | 1,350 sf |
| 8              | Bath & Body Works     | 3,500 sf |
| 9              | Justice               | 4,500 sf |
| <b>Shops E</b> |                       |          |
| 1              | Available             | 3,980 sf |
| 3              | Bikes Direct          | 1,840 sf |
| 4-6            | Frazee Paints         | 4,555 sf |
| <b>Shops F</b> |                       |          |
| 1              | Subway                | 1,845 sf |
| 2              | Crumb Cookies         | 1,240 sf |
| 3              | Data Doctors          | 1,283 sf |

| #              | TENANT             | SIZE     |
|----------------|--------------------|----------|
| 5              | Verizon            | 3,803 sf |
| 7              | Nekter Juice Bar   | 1,768 sf |
| 8              | Chipotle           | 2,400 sf |
| <b>Shops G</b> |                    |          |
| 1              | Paradise Bakery    | 4,500 sf |
| 4              | 2 B Wireless       | 1,400 sf |
| 5              | Yogurt Jungle      | 1,200 sf |
| 6              | Thai Chili         | 1,600 sf |
| 7              | Ahipoke Bowl       | 1,493 sf |
| 8              | Smashburger        | 2,200 sf |
| <b>Shops H</b> |                    |          |
| 1              | Pita Jungle        | 4,150 sf |
| 3-5            | Sauce              | 3,747 sf |
| <b>Pads</b>    |                    |          |
| A              | Olive Garden       | 7,582 sf |
| B              | Chase Bank         | 5,608 sf |
| C              | Buffalo Wild Wings | 8,000 sf |

| #            | TENANT       | SIZE     |
|--------------|--------------|----------|
| D            | Village Inn  | 8,000 sf |
| E            | Available    | 7,000 sf |
| F            | Available    | 7,000 sf |
| G            | Available    | 8,000 sf |
| H            | Barrio Queen | 8,000 sf |
| I            | In-N-Out     | 4,000 sf |
| J            | Del Taco     | 7,000 sf |
| K            | Chick-Fil-A  | 4,225 sf |
| L            | Barro's      | 4,000 sf |
| M            | Applebee's   | 7,000 sf |
| 1            | Available    | 7,153 sf |
| 2            | Available    | 7,763 sf |
| 3            | Available    | 7,475 sf |
| 4            | Available    | 7,475 sf |
| <b>Major</b> |              |          |
| Partial G    | Skechers     | 5,854 sf |



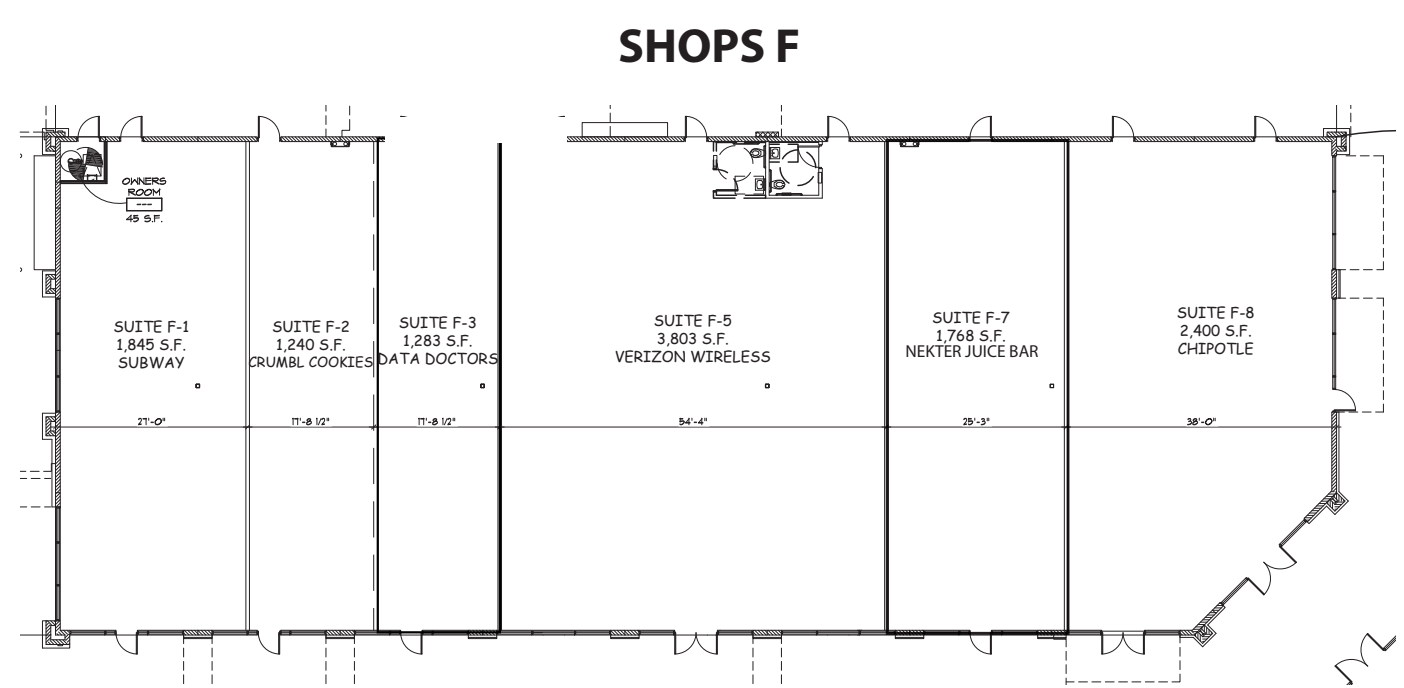
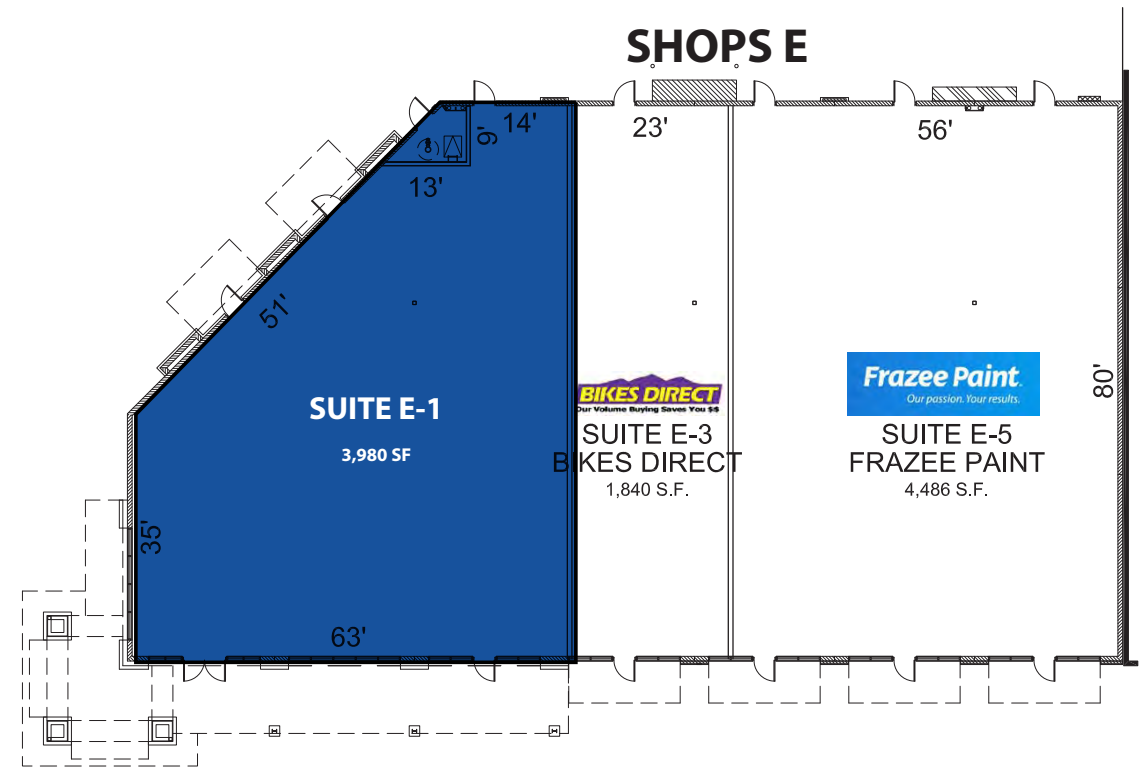
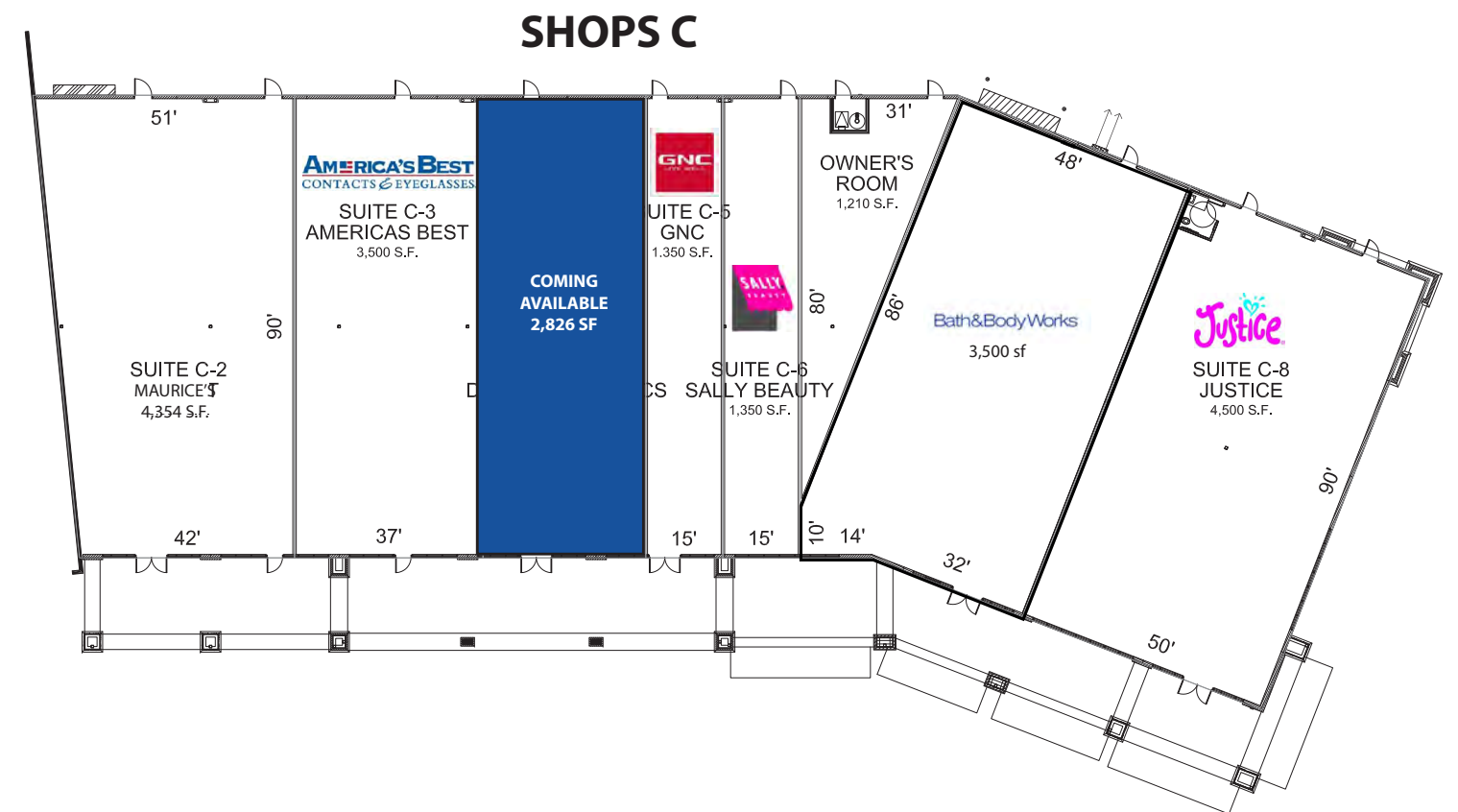
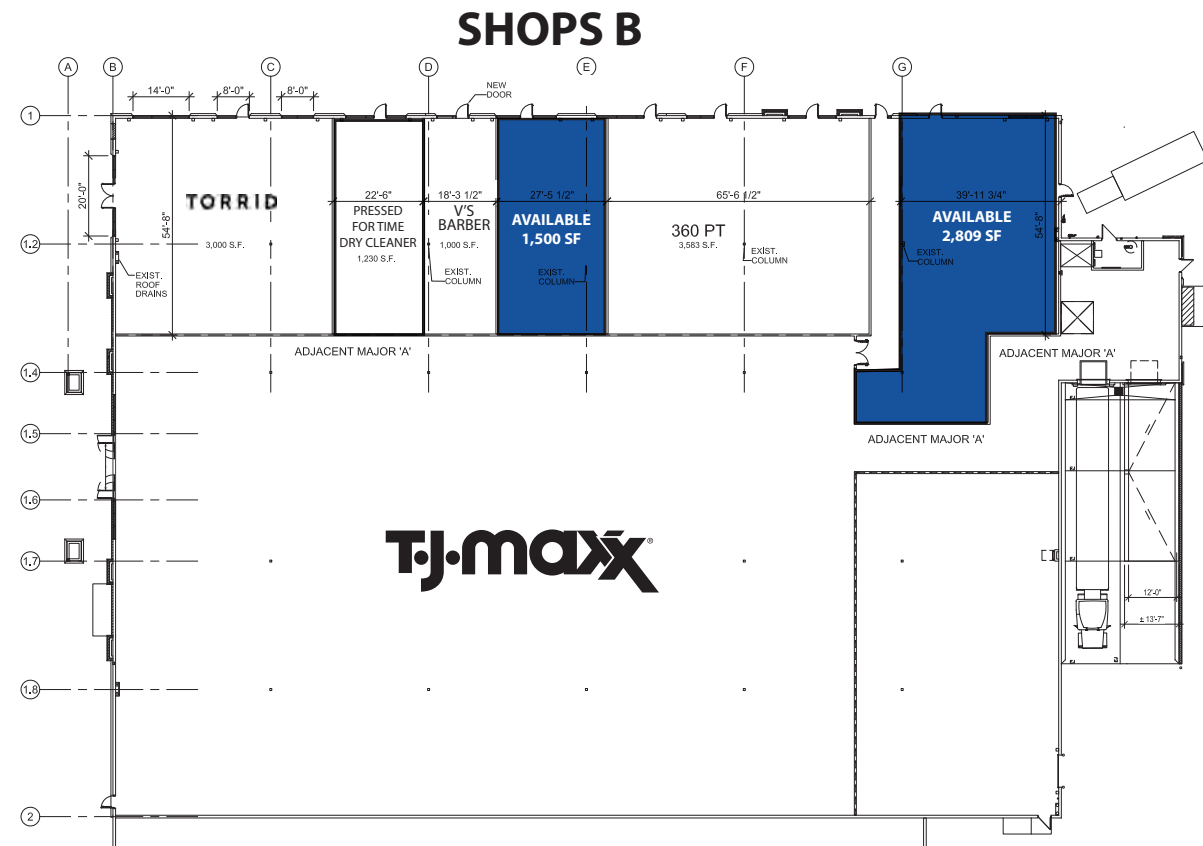



# Queen Creek Marketplace Trade Area





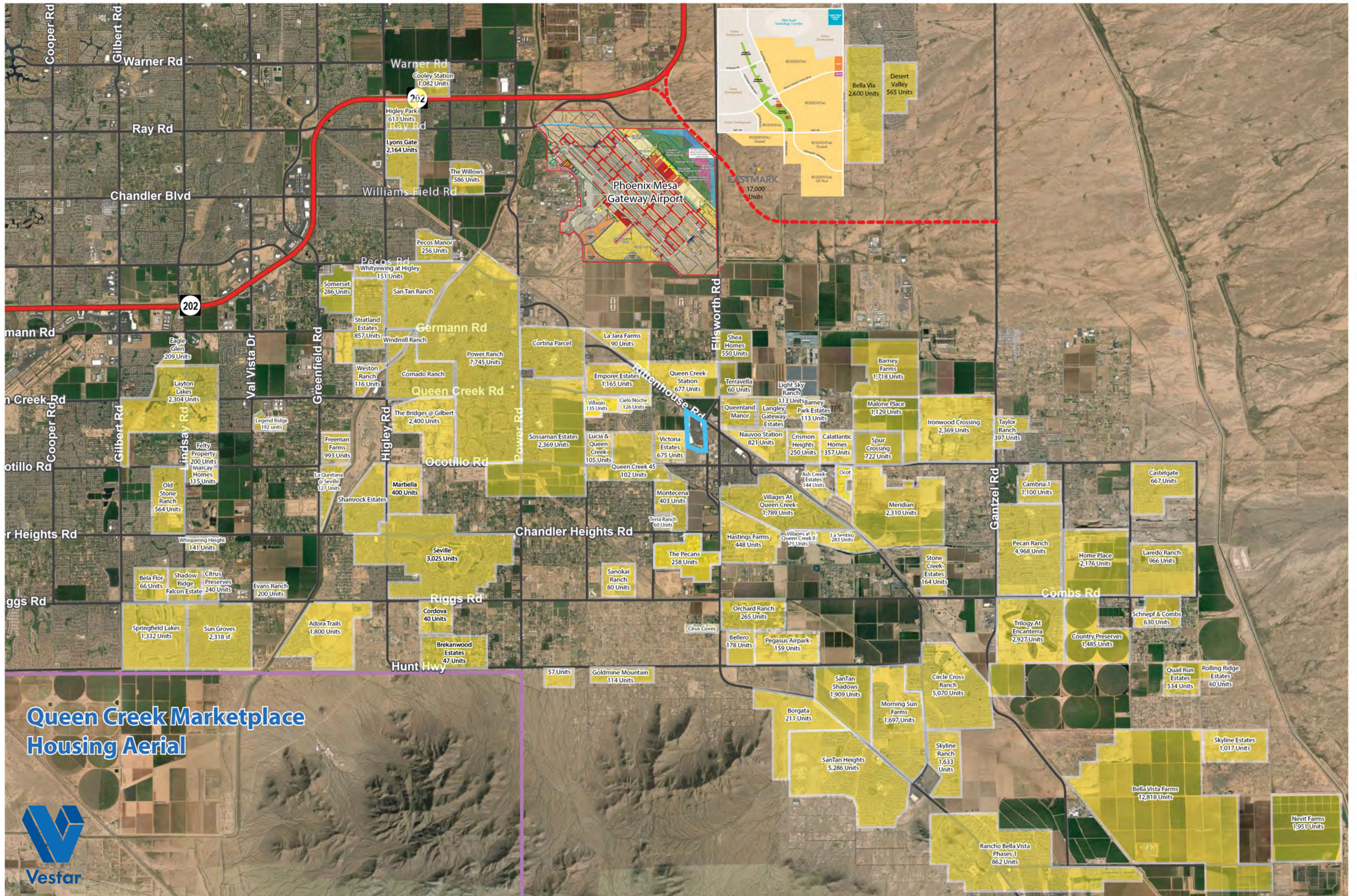



Queen Creek Marketplace  
Ring: 1 mile radius

Prepared by Esri  
Latitude: 33.25435  
Longitude: -111.64204

| Summary                         | Census 2010 | 2019  | 2024     |
|---------------------------------|-------------|-------|----------|
| Population                      | 4,283       | 8,863 | 10,598   |
| Households                      | 1,392       | 2,586 | 3,058    |
| Families                        | 1,114       | 2,063 | 2,432    |
| Average Household Size          | 3.08        | 3.43  | 3.47     |
| Owner Occupied Housing Units    | 1,001       | 2,035 | 2,464    |
| Renter Occupied Housing Units   | 391         | 551   | 594      |
| Median Age                      | 28.6        | 31.2  | 30.6     |
| Trends: 2019 - 2024 Annual Rate | Area        | State | National |
| Population                      | 3.64%       | 1.37% | 0.77%    |
| Households                      | 3.41%       | 1.36% | 0.75%    |
| Families                        | 3.35%       | 1.28% | 0.68%    |
| Owner HHs                       | 3.90%       | 1.69% | 0.92%    |
| Median Household Income         | 2.96%       | 2.59% | 2.70%    |

| Households by Income     | 2019      |         | 2024      |         |
|--------------------------|-----------|---------|-----------|---------|
|                          | Number    | Percent | Number    | Percent |
| <\$15,000                | 163       | 6.3%    | 167       | 5.5%    |
| \$15,000 - \$24,999      | 105       | 4.1%    | 100       | 3.3%    |
| \$25,000 - \$34,999      | 196       | 7.6%    | 177       | 5.8%    |
| \$35,000 - \$49,999      | 192       | 7.4%    | 187       | 6.1%    |
| \$50,000 - \$74,999      | 477       | 18.4%   | 485       | 15.9%   |
| \$75,000 - \$99,999      | 393       | 15.2%   | 464       | 15.2%   |
| \$100,000 - \$149,999    | 567       | 21.9%   | 754       | 24.7%   |
| \$150,000 - \$199,999    | 268       | 10.4%   | 393       | 12.9%   |
| \$200,000+               | 225       | 8.7%    | 332       | 10.9%   |
| Median Household Income  | \$83,422  |         | \$96,522  |         |
| Average Household Income | \$103,495 |         | \$119,158 |         |
| Per Capita Income        | \$30,870  |         | \$35,250  |         |

| Population by Age | Census 2010 |         | 2019   |         | 2024   |         |
|-------------------|-------------|---------|--------|---------|--------|---------|
|                   | Number      | Percent | Number | Percent | Number | Percent |
| 0 - 4             | 471         | 11.0%   | 863    | 9.7%    | 1,077  | 10.2%   |
| 5 - 9             | 477         | 11.1%   | 902    | 10.2%   | 1,076  | 10.2%   |
| 10 - 14           | 415         | 9.7%    | 836    | 9.4%    | 998    | 9.4%    |
| 15 - 19           | 305         | 7.1%    | 618    | 7.0%    | 757    | 7.1%    |
| 20 - 24           | 219         | 5.1%    | 453    | 5.1%    | 516    | 4.9%    |
| 25 - 34           | 728         | 17.0%   | 1,294  | 14.6%   | 1,764  | 16.6%   |
| 35 - 44           | 713         | 16.7%   | 1,518  | 17.1%   | 1,782  | 16.8%   |
| 45 - 54           | 433         | 10.1%   | 1,061  | 12.0%   | 1,170  | 11.0%   |
| 55 - 64           | 289         | 6.8%    | 682    | 7.7%    | 736    | 6.9%    |
| 65 - 74           | 164         | 3.8%    | 440    | 5.0%    | 476    | 4.5%    |
| 75 - 84           | 51          | 1.2%    | 156    | 1.8%    | 201    | 1.9%    |
| 85+               | 16          | 0.4%    | 40     | 0.5%    | 44     | 0.4%    |

| Race and Ethnicity         | Census 2010 |         | 2019   |         | 2024   |         |
|----------------------------|-------------|---------|--------|---------|--------|---------|
|                            | Number      | Percent | Number | Percent | Number | Percent |
| White Alone                | 3,454       | 80.6%   | 6,970  | 78.6%   | 8,102  | 76.4%   |
| Black Alone                | 174         | 4.1%    | 360    | 4.1%    | 479    | 4.5%    |
| American Indian Alone      | 38          | 0.9%    | 88     | 1.0%    | 114    | 1.1%    |
| Asian Alone                | 138         | 3.2%    | 280    | 3.2%    | 377    | 3.6%    |
| Pacific Islander Alone     | 1           | 0.0%    | 4      | 0.0%    | 5      | 0.0%    |
| Some Other Race Alone      | 325         | 7.6%    | 770    | 8.7%    | 1,002  | 9.5%    |
| Two or More Races          | 153         | 3.6%    | 392    | 4.4%    | 520    | 4.9%    |
| Hispanic Origin (Any Race) | 841         | 19.6%   | 1,877  | 21.2%   | 2,436  | 23.0%   |

Data Note: Income is expressed in current dollars.

Source: U.S. Census Bureau, Census 2010 Summary File 1. Esri forecasts for 2019 and 2024.



©2020 Avison Young - Arizona, LTD. All rights reserved. E. & O.E.: The information contained herein was obtained from sources which we deem reliable and, while thought to be correct, is not guaranteed by Avison Young.



Target  
Ring: 1 mile radius

Prepared by Esri  
Latitude: 33.25435  
Longitude: -111.64204

Trends 2019-2024

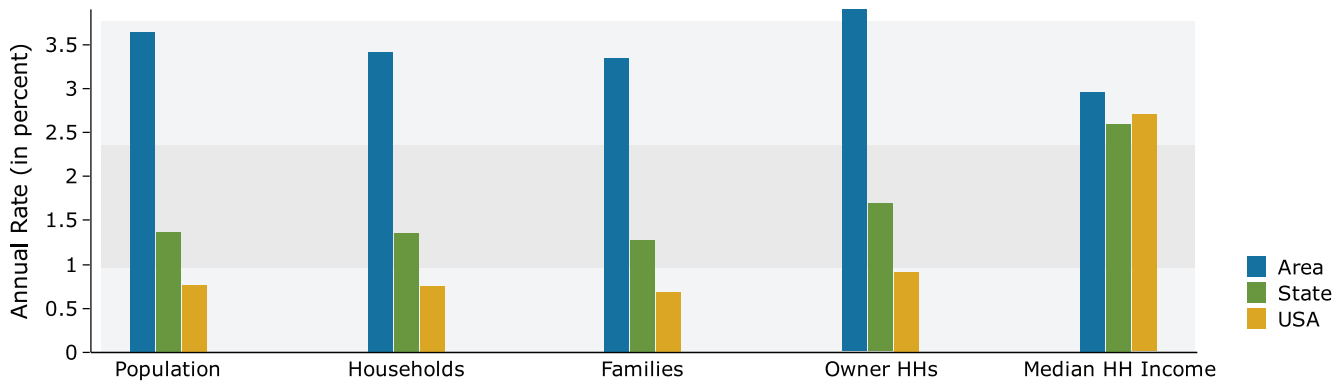

Population by Age

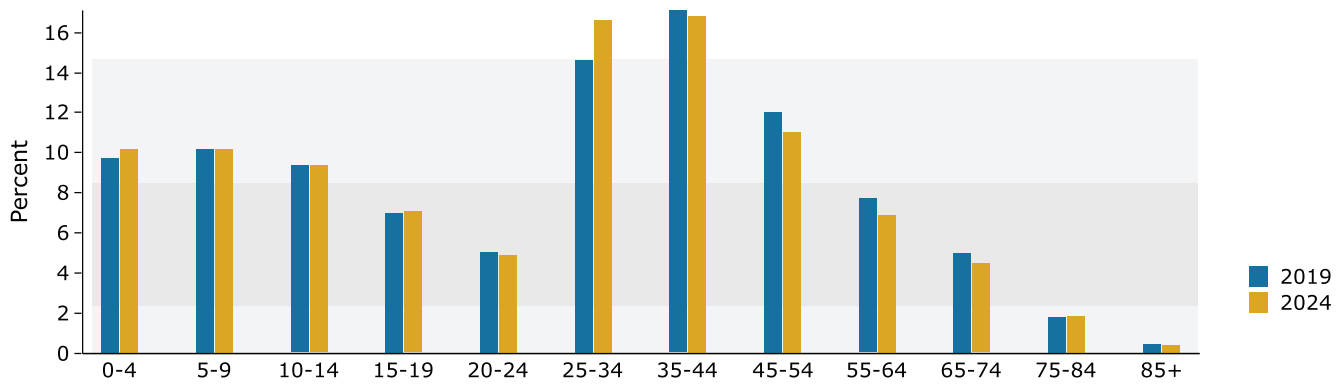

2019 Household Income

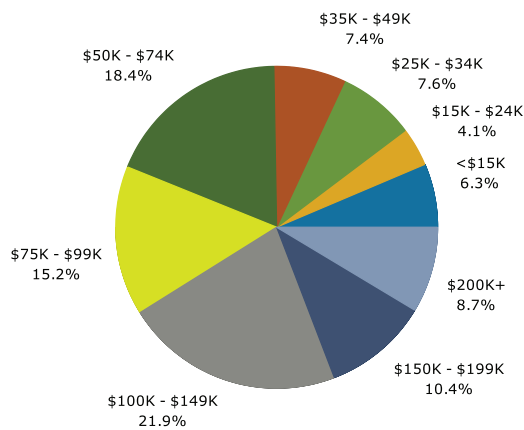

2019 Population by Race

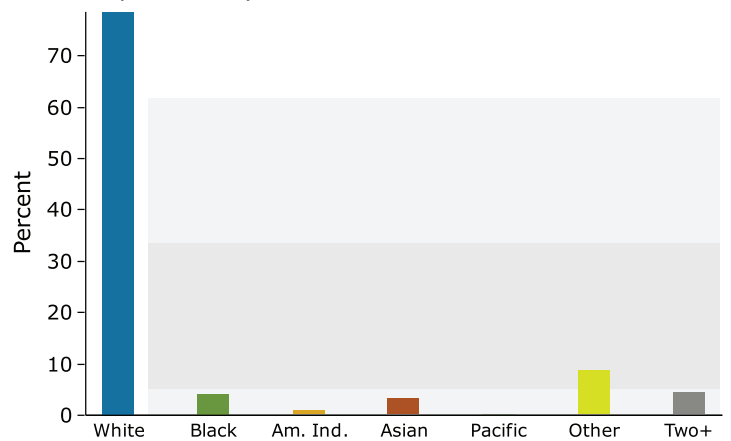

2019 Percent Hispanic Origin: 21.2%

Source: U.S. Census Bureau, Census 2010 Summary File 1. Esri forecasts for 2019 and 2024.



©2020 Avison Young - Arizona, LTD. All rights reserved. E. & O.E.: The information contained herein was obtained from sources which we deem reliable and, while thought to be correct, is not guaranteed by Avison Young.



Target  
Ring: 3 mile radius

Prepared by Esri  
Latitude: 33.25435  
Longitude: -111.64204

| Summary                         | Census 2010 |         | 2019      |         | 2024      |         |
|---------------------------------|-------------|---------|-----------|---------|-----------|---------|
| Population                      | 29,632      |         | 50,816    |         | 60,119    |         |
| Households                      | 9,028       |         | 14,692    |         | 17,189    |         |
| Families                        | 7,524       |         | 12,206    |         | 14,251    |         |
| Average Household Size          | 3.28        |         | 3.46      |         | 3.50      |         |
| Owner Occupied Housing Units    | 7,313       |         | 12,523    |         | 14,897    |         |
| Renter Occupied Housing Units   | 1,715       |         | 2,169     |         | 2,293     |         |
| Median Age                      | 31.2        |         | 32.3      |         | 31.7      |         |
| Trends: 2019 - 2024 Annual Rate | Area        |         | State     |         | National  |         |
| Population                      | 3.42%       |         | 1.37%     |         | 0.77%     |         |
| Households                      | 3.19%       |         | 1.36%     |         | 0.75%     |         |
| Families                        | 3.15%       |         | 1.28%     |         | 0.68%     |         |
| Owner HHs                       | 3.53%       |         | 1.69%     |         | 0.92%     |         |
| Median Household Income         | 1.78%       |         | 2.59%     |         | 2.70%     |         |
| Households by Income            | 2019        |         |           |         | 2024      |         |
|                                 | Number      |         | Percent   |         | Number    | Percent |
| <\$15,000                       | 619         |         | 4.2%      |         | 627       | 3.6%    |
| \$15,000 - \$24,999             | 475         |         | 3.2%      |         | 432       | 2.5%    |
| \$25,000 - \$34,999             | 701         |         | 4.8%      |         | 615       | 3.6%    |
| \$35,000 - \$49,999             | 1,153       |         | 7.8%      |         | 1,105     | 6.4%    |
| \$50,000 - \$74,999             | 2,167       |         | 14.7%     |         | 2,155     | 12.5%   |
| \$75,000 - \$99,999             | 2,491       |         | 17.0%     |         | 2,819     | 16.4%   |
| \$100,000 - \$149,999           | 3,730       |         | 25.4%     |         | 4,763     | 27.7%   |
| \$150,000 - \$199,999           | 1,679       |         | 11.4%     |         | 2,317     | 13.5%   |
| \$200,000+                      | 1,677       |         | 11.4%     |         | 2,357     | 13.7%   |
| Median Household Income         |             |         | \$96,617  |         | \$105,541 |         |
| Average Household Income        |             |         | \$116,741 |         | \$132,174 |         |
| Per Capita Income               |             |         | \$33,830  |         | \$37,877  |         |
| Population by Age               | Census 2010 |         | 2019      |         | 2024      |         |
|                                 | Number      | Percent | Number    | Percent | Number    | Percent |
| 0 - 4                           | 2,919       | 9.9%    | 4,657     | 9.2%    | 5,731     | 9.5%    |
| 5 - 9                           | 3,332       | 11.2%   | 5,014     | 9.9%    | 5,972     | 9.9%    |
| 10 - 14                         | 2,911       | 9.8%    | 4,820     | 9.5%    | 5,519     | 9.2%    |
| 15 - 19                         | 2,137       | 7.2%    | 3,591     | 7.1%    | 4,308     | 7.2%    |
| 20 - 24                         | 1,201       | 4.1%    | 2,484     | 4.9%    | 2,780     | 4.6%    |
| 25 - 34                         | 4,157       | 14.0%   | 6,807     | 13.4%   | 9,271     | 15.4%   |
| 35 - 44                         | 4,891       | 16.5%   | 8,340     | 16.4%   | 9,579     | 15.9%   |
| 45 - 54                         | 3,199       | 10.8%   | 5,928     | 11.7%   | 6,614     | 11.0%   |
| 55 - 64                         | 2,578       | 8.7%    | 4,377     | 8.6%    | 4,542     | 7.6%    |
| 65 - 74                         | 1,662       | 5.6%    | 3,377     | 6.6%    | 3,722     | 6.2%    |
| 75 - 84                         | 509         | 1.7%    | 1,144     | 2.3%    | 1,740     | 2.9%    |
| 85+                             | 137         | 0.5%    | 278       | 0.5%    | 341       | 0.6%    |
| Race and Ethnicity              | Census 2010 |         | 2019      |         | 2024      |         |
|                                 | Number      | Percent | Number    | Percent | Number    | Percent |
| White Alone                     | 24,846      | 83.8%   | 41,136    | 81.0%   | 47,377    | 78.8%   |
| Black Alone                     | 971         | 3.3%    | 2,086     | 4.1%    | 2,833     | 4.7%    |
| American Indian Alone           | 219         | 0.7%    | 413       | 0.8%    | 532       | 0.9%    |
| Asian Alone                     | 809         | 2.7%    | 1,475     | 2.9%    | 1,956     | 3.3%    |
| Pacific Islander Alone          | 44          | 0.1%    | 97        | 0.2%    | 128       | 0.2%    |
| Some Other Race Alone           | 1,760       | 5.9%    | 3,672     | 7.2%    | 4,762     | 7.9%    |
| Two or More Races               | 983         | 3.3%    | 1,937     | 3.8%    | 2,531     | 4.2%    |
| Hispanic Origin (Any Race)      | 5,063       | 17.1%   | 9,874     | 19.4%   | 12,727    | 21.2%   |

Data Note: Income is expressed in current dollars.

Source: U.S. Census Bureau, Census 2010 Summary File 1. Esri forecasts for 2019 and 2024.





Target  
Ring: 3 mile radius

Prepared by Esri  
Latitude: 33.25435  
Longitude: -111.64204

Trends 2019-2024

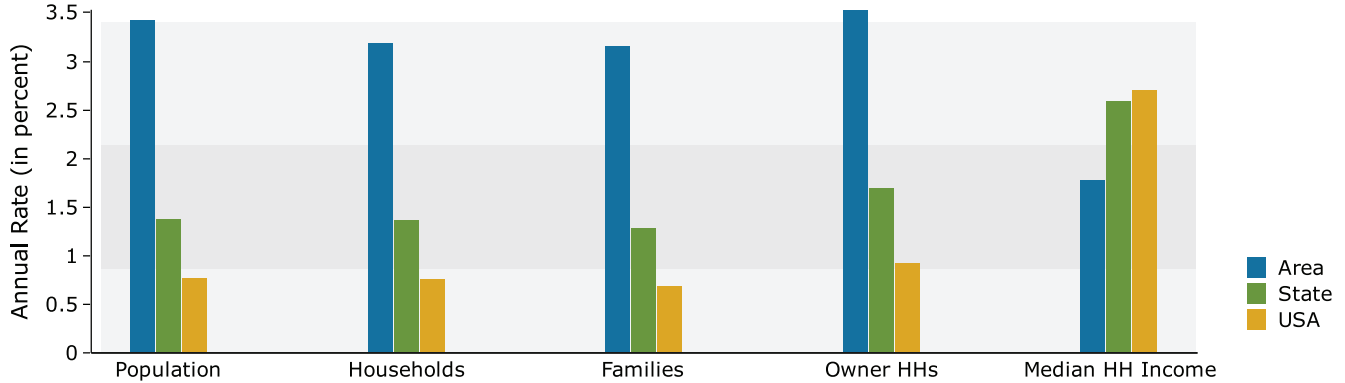

Population by Age

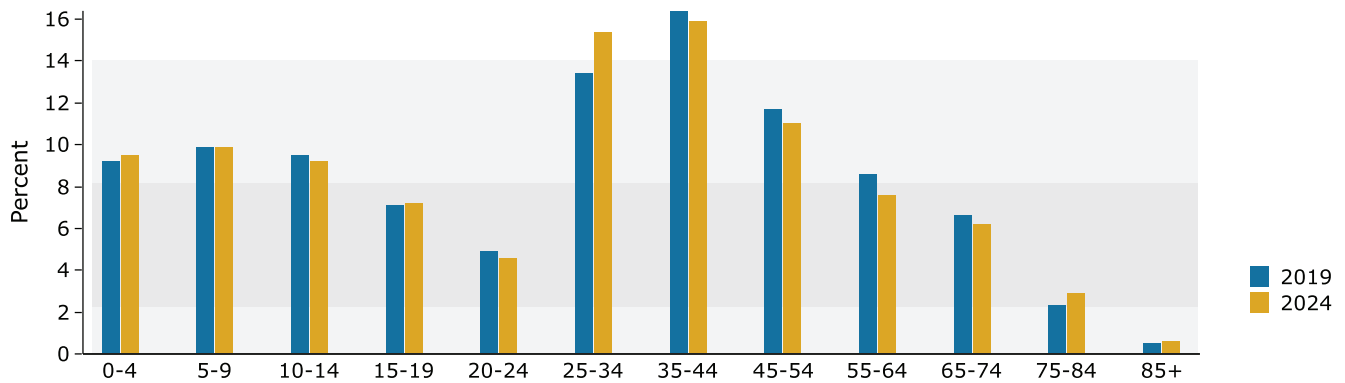

2019 Household Income

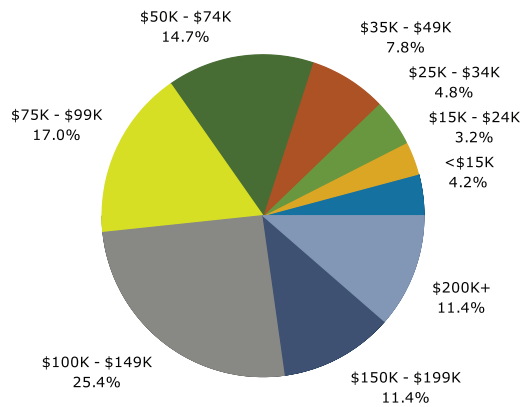

2019 Population by Race

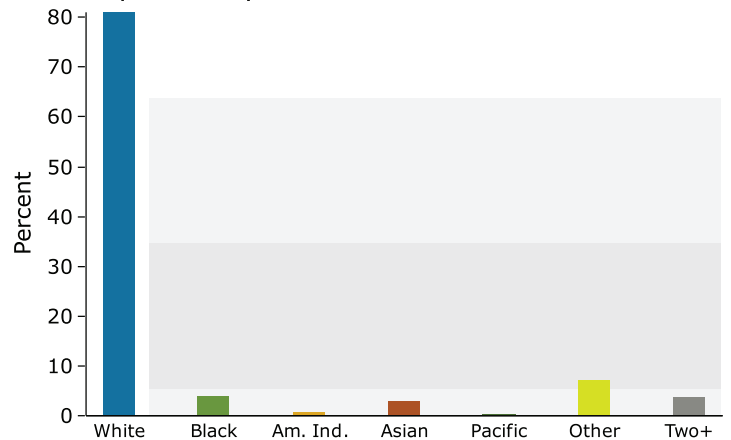

2019 Percent Hispanic Origin: 19.4%

Source: U.S. Census Bureau, Census 2010 Summary File 1. Esri forecasts for 2019 and 2024.



©2020 Avison Young - Arizona, LTD. All rights reserved. E. & O.E.: The information contained herein was obtained from sources which we deem reliable and, while thought to be correct, is not guaranteed by Avison Young.





Target  
Ring: 5 mile radius

Prepared by Esri  
Latitude: 33.25435  
Longitude: -111.64204

| Summary                         | Census 2010 | 2019    | 2024      |         |         |         |
|---------------------------------|-------------|---------|-----------|---------|---------|---------|
| Population                      | 81,595      | 126,188 | 145,029   |         |         |         |
| Households                      | 25,348      | 38,696  | 44,257    |         |         |         |
| Families                        | 20,832      | 31,425  | 35,831    |         |         |         |
| Average Household Size          | 3.21        | 3.25    | 3.27      |         |         |         |
| Owner Occupied Housing Units    | 19,754      | 31,984  | 37,252    |         |         |         |
| Renter Occupied Housing Units   | 5,594       | 6,711   | 7,006     |         |         |         |
| Median Age                      | 30.3        | 32.1    | 31.6      |         |         |         |
| Trends: 2019 - 2024 Annual Rate | Area        | State   | National  |         |         |         |
| Population                      | 2.82%       | 1.37%   | 0.77%     |         |         |         |
| Households                      | 2.72%       | 1.36%   | 0.75%     |         |         |         |
| Families                        | 2.66%       | 1.28%   | 0.68%     |         |         |         |
| Owner HHs                       | 3.10%       | 1.69%   | 0.92%     |         |         |         |
| Median Household Income         | 2.58%       | 2.59%   | 2.70%     |         |         |         |
| Households by Income            | 2019        |         | 2024      |         |         |         |
|                                 | Number      | Percent | Number    | Percent |         |         |
| <\$15,000                       | 1,608       | 4.2%    | 1,562     | 3.5%    |         |         |
| \$15,000 - \$24,999             | 1,291       | 3.3%    | 1,167     | 2.6%    |         |         |
| \$25,000 - \$34,999             | 1,953       | 5.0%    | 1,753     | 4.0%    |         |         |
| \$35,000 - \$49,999             | 3,638       | 9.4%    | 3,430     | 7.8%    |         |         |
| \$50,000 - \$74,999             | 6,689       | 17.3%   | 6,621     | 15.0%   |         |         |
| \$75,000 - \$99,999             | 6,314       | 16.3%   | 6,873     | 15.5%   |         |         |
| \$100,000 - \$149,999           | 9,316       | 24.1%   | 11,347    | 25.6%   |         |         |
| \$150,000 - \$199,999           | 4,091       | 10.6%   | 5,872     | 13.3%   |         |         |
| \$200,000+                      | 3,794       | 9.8%    | 5,633     | 12.7%   |         |         |
| Median Household Income         | \$89,747    |         | \$101,918 |         |         |         |
| Average Household Income        | \$110,366   |         | \$127,565 |         |         |         |
| Per Capita Income               | \$33,750    |         | \$38,829  |         |         |         |
| Population by Age               | Census 2010 |         | 2019      |         | 2024    |         |
|                                 | Number      | Percent | Number    | Percent | Number  | Percent |
| 0 - 4                           | 8,476       | 10.4%   | 11,663    | 9.2%    | 13,794  | 9.5%    |
| 5 - 9                           | 9,062       | 11.1%   | 12,223    | 9.7%    | 13,927  | 9.6%    |
| 10 - 14                         | 7,851       | 9.6%    | 11,792    | 9.3%    | 13,210  | 9.1%    |
| 15 - 19                         | 5,864       | 7.2%    | 8,971     | 7.1%    | 10,606  | 7.3%    |
| 20 - 24                         | 3,717       | 4.6%    | 6,550     | 5.2%    | 7,245   | 5.0%    |
| 25 - 34                         | 12,384      | 15.2%   | 17,136    | 13.6%   | 22,129  | 15.3%   |
| 35 - 44                         | 14,069      | 17.2%   | 20,392    | 16.2%   | 22,396  | 15.4%   |
| 45 - 54                         | 8,470       | 10.4%   | 14,476    | 11.5%   | 15,628  | 10.8%   |
| 55 - 64                         | 6,445       | 7.9%    | 10,831    | 8.6%    | 11,179  | 7.7%    |
| 65 - 74                         | 3,807       | 4.7%    | 8,580     | 6.8%    | 9,572   | 6.6%    |
| 75 - 84                         | 1,147       | 1.4%    | 2,907     | 2.3%    | 4,488   | 3.1%    |
| 85+                             | 303         | 0.4%    | 667       | 0.5%    | 857     | 0.6%    |
| Race and Ethnicity              | Census 2010 |         | 2019      |         | 2024    |         |
|                                 | Number      | Percent | Number    | Percent | Number  | Percent |
| White Alone                     | 67,359      | 82.6%   | 99,987    | 79.2%   | 111,853 | 77.1%   |
| Black Alone                     | 2,945       | 3.6%    | 5,343     | 4.2%    | 6,868   | 4.7%    |
| American Indian Alone           | 738         | 0.9%    | 1,277     | 1.0%    | 1,573   | 1.1%    |
| Asian Alone                     | 2,846       | 3.5%    | 4,922     | 3.9%    | 6,320   | 4.4%    |
| Pacific Islander Alone          | 130         | 0.2%    | 243       | 0.2%    | 299     | 0.2%    |
| Some Other Race Alone           | 4,726       | 5.8%    | 9,290     | 7.4%    | 11,662  | 8.0%    |
| Two or More Races               | 2,853       | 3.5%    | 5,127     | 4.1%    | 6,453   | 4.4%    |
| Hispanic Origin (Any Race)      | 14,068      | 17.2%   | 25,775    | 20.4%   | 32,312  | 22.3%   |

Data Note: Income is expressed in current dollars.

Source: U.S. Census Bureau, Census 2010 Summary File 1. Esri forecasts for 2019 and 2024.





Target  
Ring: 5 mile radius

Prepared by Esri  
Latitude: 33.25435  
Longitude: -111.64204

Trends 2019-2024

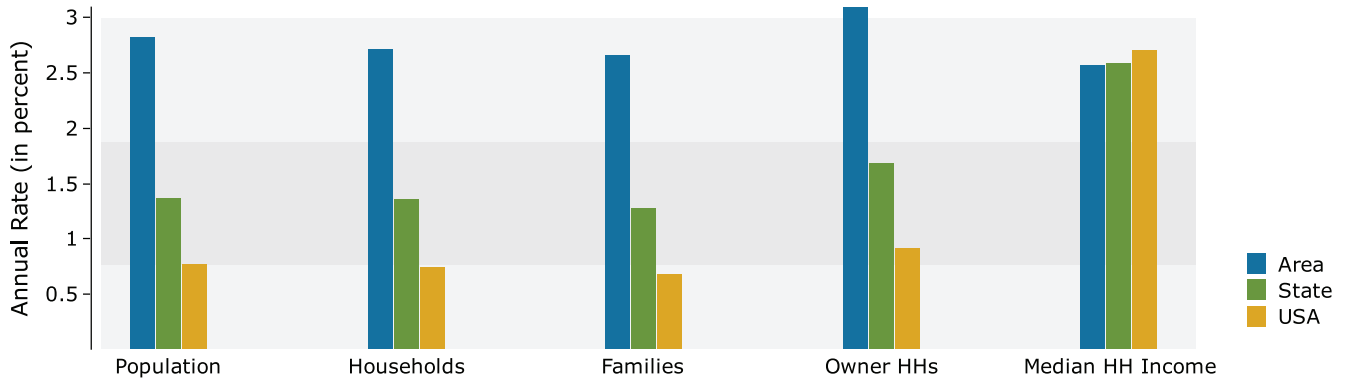

Population by Age

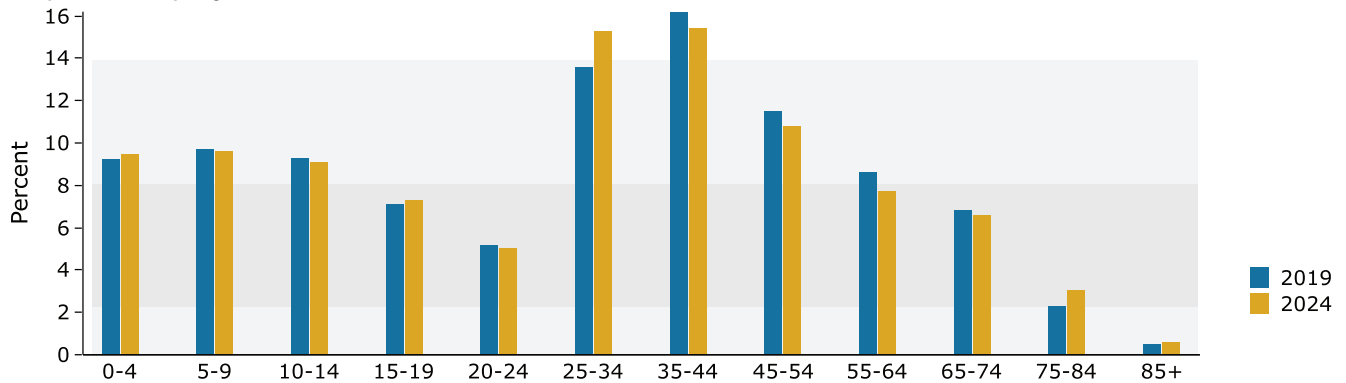

2019 Household Income

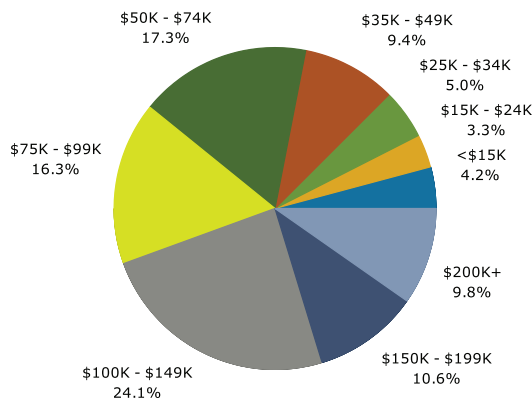

2019 Population by Race

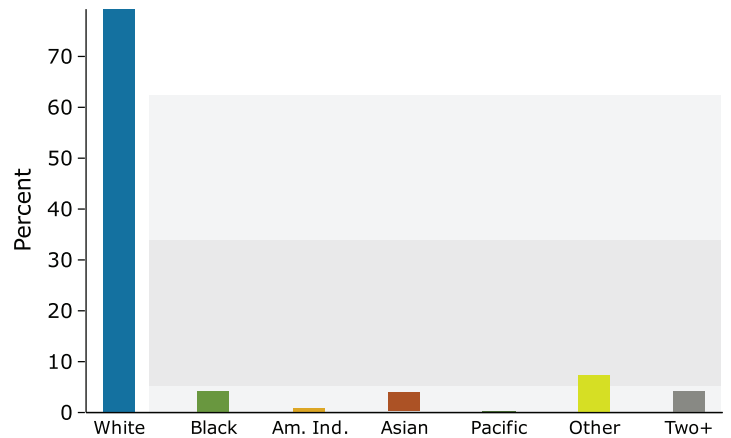

2019 Percent Hispanic Origin: 20.4%

Source: U.S. Census Bureau, Census 2010 Summary File 1. Esri forecasts for 2019 and 2024.



©2020 Avison Young - Arizona, LTD. All rights reserved. E. & O.E.: The information contained herein was obtained from sources which we deem reliable and, while thought to be correct, is not guaranteed by Avison Young.

