



**FOR LEASE**  
**980 SF**

**PRIME NORTH VALENCIA LOCATION**  
27955 Smyth Drive | Valencia, CA 91355

**BUILDING FEATURES**

- Single story office building
- Suite 102: 980 Sq. Ft.
- Prime north Valencia location
- Large window offices
- Beautiful common areas
- Minutes from other area amenities including Valencia Town Center, Valencia Country Club, TPC Valencia, Valencia Hyatt Hotel and Santa Clarita Conference Center and Spectrum Club
- Easy access to I-5 Freeway, state highway 126 and the Cross Valley Connector
- 4/1,000 parking ratio

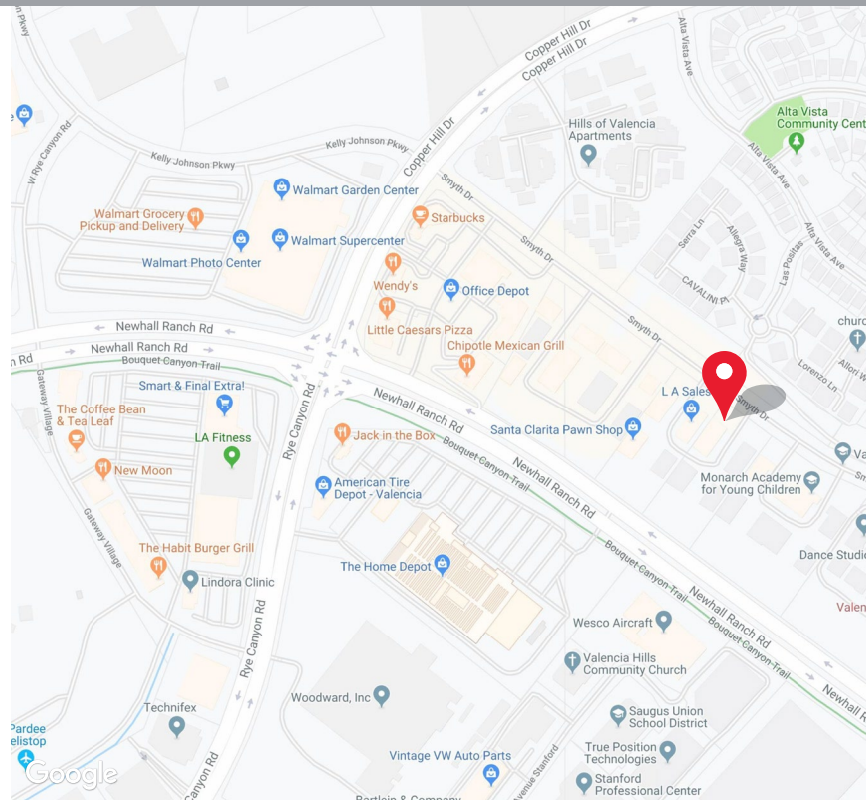

**RANDY CUDE**

Executive Vice President

📞 661.414.2004

✉ rcude@spectrumcre.com

DRE License #01005000

No warranty, express or implied, is made as to the accuracy of the information contained herein. This information is submitted subject to errors, omissions, change of price, rental or other conditions, withdrawal without notice, and is subject to any special listing conditions imposed by our principals. Cooperating brokers, buyers, tenants and other parties who receive this document should not rely on it, but should use it as a starting point of analysis, and should independently confirm the accuracy of the information contained herein through a due diligence review of the books, records, files and documents that constitute reliable sources of the information described herein. Spectrum Commercial Real Estate, Inc., CA DRE #02042805

# FOR LEASE

SWC of The Old Rd & Live Oak Rd | Castaic, CA

## SITE PLAN

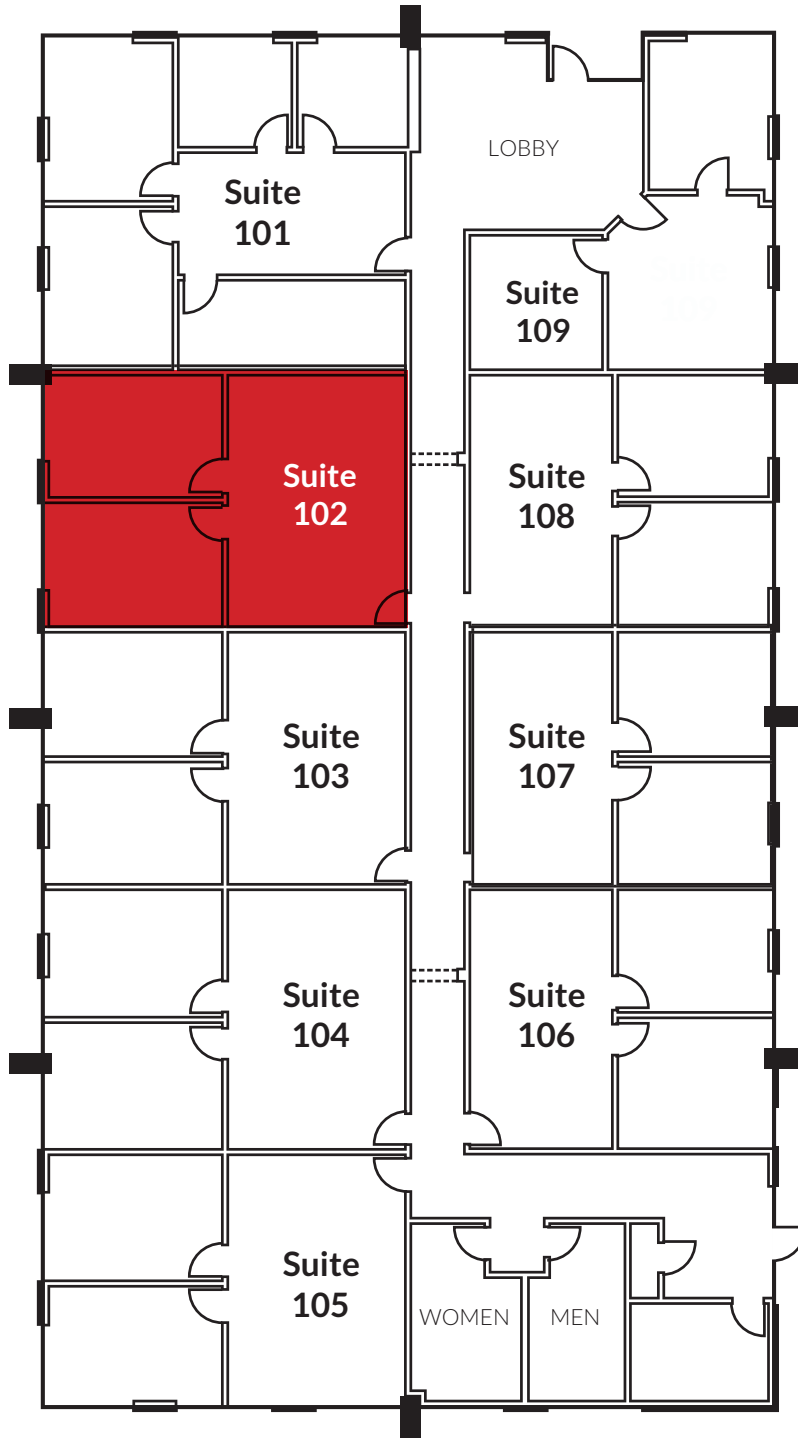

### RANDY CUDE

Executive Vice President

661.414.2004

rcude@spectrumcre.com

DRE License #01005000

No warranty, express or implied, is made as to the accuracy of the information contained herein. This information is submitted subject to errors, omissions, change of price, rental or other conditions, withdrawal without notice, and is subject to any special listing conditions imposed by our principals. Cooperating brokers, buyers, tenants and other parties who receive this document should not rely on it, but should use it as a starting point of analysis, and should independently confirm the accuracy of the information contained herein through a due diligence review of the books, records, files and documents that constitute reliable sources of the information described herein. Spectrum Commercial Real Estate, Inc., CA DRE #02042805