

Kifer Industrial Park

1360 Kifer Road, Sunnyvale, California



FEATURES

- ±56,358 SF Data Center / Lab / Manufacturing Building
- The entire facility is built-out with raised floor data center and data center support space
- Heavy Power
- Multiple telecom providers
- Pre-action fire suppression system
- Shared dock loading and receiving area
- Excellent access to Lawrence Expressway, Central Expressway, San Tomas Expressway, Highway 101 and Interstate 280
- San Jose International Airport is approximately 5 miles away
- Caltrain station in walking distance – Lawrence Station

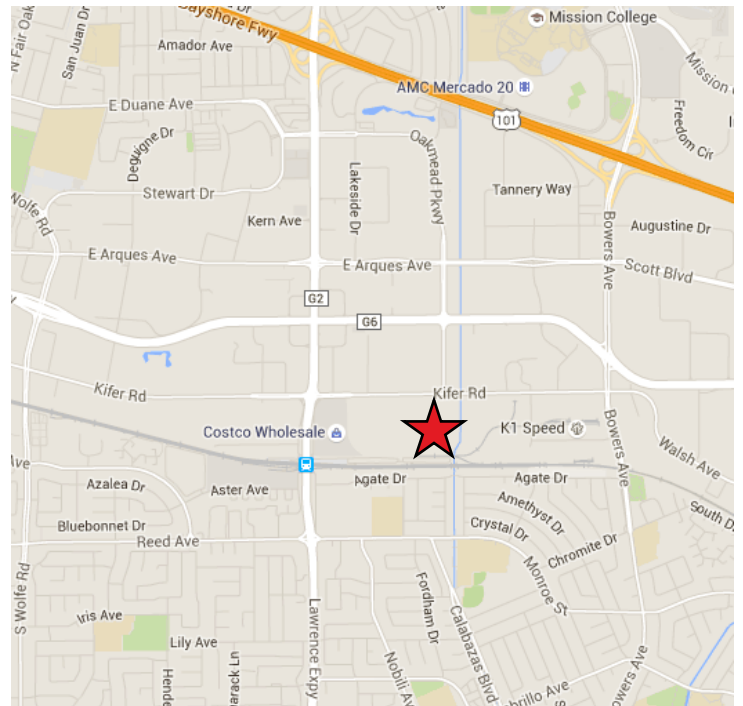

OWNED AND OPERATED BY

PS BUSINESS PARKS

www.psbusinessparks.com

FOR LEASING CONTACT:
408-453-9921

NGOC ROSSI
nrossi@psbusinessparks.com

KHANH TRINH
kt Trinh@psbusinessparks.com

Kifer Industrial Park

1360 Kifer Road, Sunnyvale, California

Photos



$\pm 24''$ Raised Floor, $\pm 22'$ Clear Height



$\pm 7,500$ kVA Electrical Capacity



3 $\pm 2,000$ kW / $\pm 2,500$ kVA standby diesel generators



7 ± 625 kVA UPS



OWNED AND OPERATED BY
PSBUSINESSPARKS
www.psbusinessparks.com

FOR LEASING CONTACT:
408-453-9921

NGOC ROSSI
nrossi@psbusinessparks.com

KHANH TRINH
ktrinh@psbusinessparks.com

Kifer Industrial Park

1360 Kifer Road, Sunnyvale, California

Floor Plan

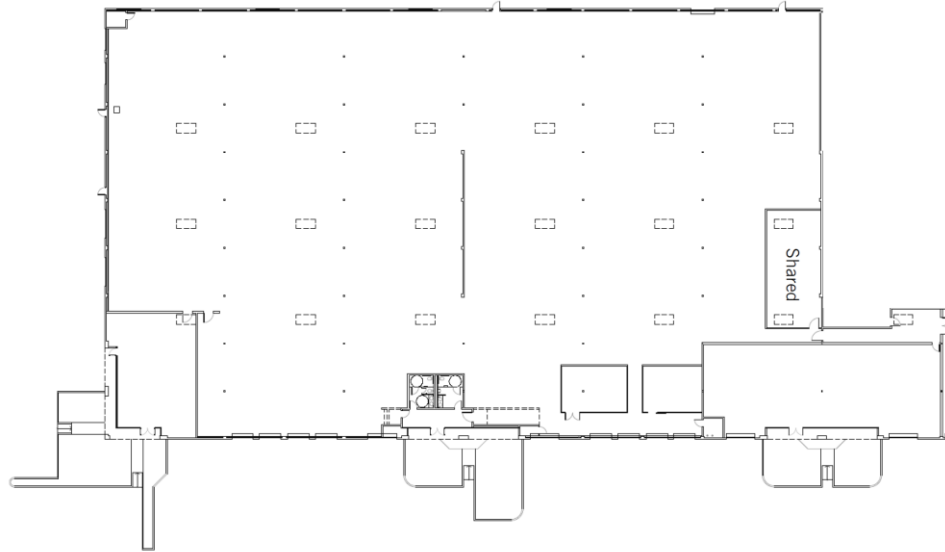

Site Plan

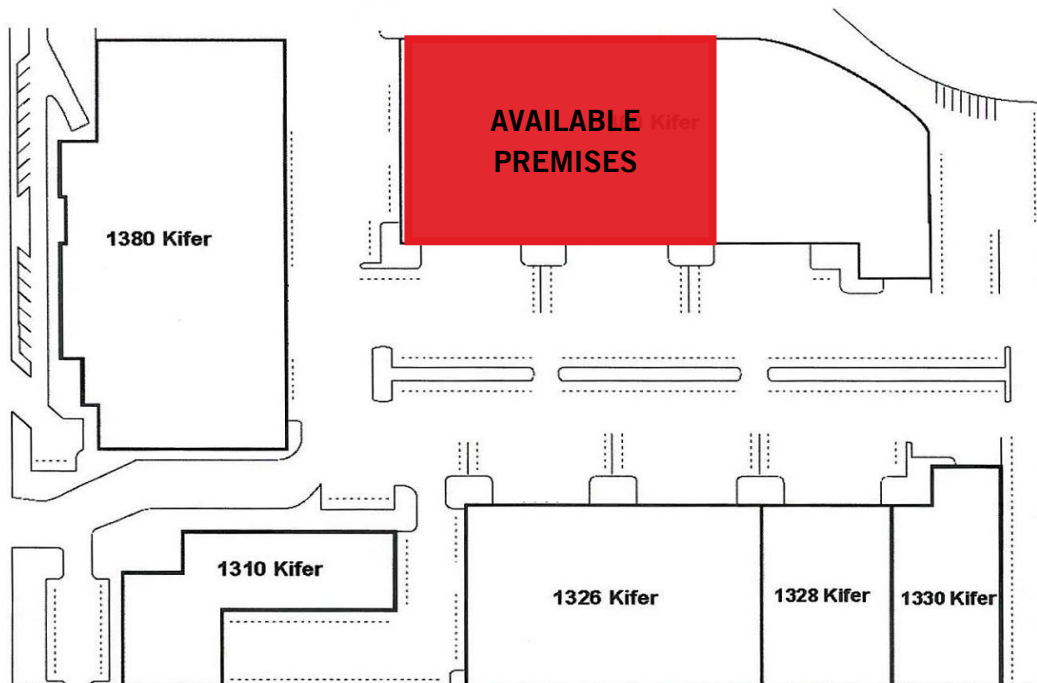

OWNED AND OPERATED BY

PSBUSINESSPARKS

www.psbusinessparks.com

FOR LEASING CONTACT:
408-453-9921

NGOC ROSSI
nrossi@psbusinessparks.com

KHANH TRINH
kt Trinh@psbusinessparks.com

Kifer Industrial Park

1360 Kifer Road, Sunnyvale, California

Building Specs

ELETRICAL SYSTEM SPECIFICATIONS

Electrical System Component	Component Capacity	Installed Qty	Installed Capacity	Usable Capacity
Data Center Area A AVAILABLE				
Transformers	± 2,500 kVA	3	± 7,500 kVA	± 7,500 kVA
Generators	±2,500 kVA	3	± 7,500 kVA	± 7,500 kVA
UPS	± 625 kVA	7	± 4,275 kVA	± 4,275 kVA
PDU's	± 200 kVA	15	± 3,000 kVA	± 3,000 kVA

MECHANICAL SYSTEM SPECIFICATIONS

Mechanical System Component	Component Capacity	Installed Qty	Installed Capacity	IT Cooling Capacity
Data Center Area A AVAILABLE				
Air Cooled Chillers	± 459 tons	4 Units	± 1,836 tons	
Data Center CRAC Units	± 20 tons	44 Units	± 880 tons	± 2.5 MW

Historically the building has been drawing ±7 MW or less of power, with a minimum ±4 MW available to the premises. PG&E currently has ±10 MW allocated to this building, but it is our understanding that the equipment on-site was designed to support up to ±22 MW. Based on demand, PG&E can investigate the potential of delivering additional power beyond the ±10 MW allocation to the building.

The information contained herein is believed to be accurate but is not warranted as to its accuracy and may change or be updated without notice. Landlord makes no representations as to the condition of the building, property, or its systems, including but not limited to the environmental conditions, and recommends tenant's independent investigations of the same.



OWNED AND OPERATED BY

PSBUSINESSPARKS

www.psbusinessparks.com

FOR LEASING CONTACT:
408-453-9921

NGOC ROSSI
nrossi@psbusinessparks.com

KHANH TRINH
kt Trinh@psbusinessparks.com

Kifer Industrial Park

1360 Kifer Road, Sunnyvale, California

Building Specs

BUILDING

- 1360 Kifer: Approximately ±56,358 square feet with its own primary electrical and mechanical systems

CLEAR HEIGHT

- ±22' Clear height from the slab
- ±24" Raised Floor

UTILITY POWER

- PG&E Services this site with a primary ±21 Kilo-volt service (KV)
- Electrical power for the data center is provided by PG&E via two ±12.47KV
- Feeders fed by three ±2,500 kVA Transformers
- The equipment on-site was designed to support up to ±22 MW. Based on demand, PG&E can investigate the potential of delivering additional power beyond the current allocation to the building
- Historical allocation to this building has been 10 MW

SECONDARY (EMERGENCY) POWER

- Approximately ±7,500 kVA of Generator power via three (3) ±2,500 kVA standby diesel generators

COOLING

- ±1,836 tons of cooling from air-cooled chilling plants supplying internal computer room air conditioning units (CRAC units)

FIRE PROTECTION

- Area (A) is protected by a dry-pipe pre-action fire sprinkler system

TELECOMMUNICATIONS

- Fiber Rich Area: Primary network communications from Level3 and CenturyLink
- Landlord has pending access agreements with AT&T, Comcast and Integra to provide additional connectivity to the building

RELATED FEATURES

- Exterior electrical and mechanical yards: Site contains attached and detached mechanical and electrical equipment support yards. No overhead or roof-mounted air conditioning equipment (with the exception of two package units for 1360's main electrical room), which is a plus for disaster and reliability planning

Additional Information Available Upon Request

The information contained herein is believed to be accurate but is not warranted as to its accuracy and may change or be updated without notice. Landlord makes no representations as to the condition of the building, property, or its systems, including but not limited to the environmental conditions, and recommends tenant's independent investigations of the same.



OWNED AND OPERATED BY

PSBUSINESSPARKS

www.psbusinessparks.com

**FOR LEASING CONTACT:
408-453-9921**

NGOC ROSSI
nrossi@psbusinessparks.com

KHANH TRINH
ktrinh@psbusinessparks.com