

OFFICE SPACE FOR LEASE
STROH PROFESSIONAL



12760 STROH RANCH WAY, PARKER, COLORADO 80134

FOR LEASE
2,000 SF
\$22.00 / SF
Parker, Colorado



BUILDING INFORMATION

- ▶ Available Space: 2,000 SF -Available 6/1/2022
- ▶ Lease Type: \$22.00 / SF
- ▶ Y.O.C: Full Service Gross
- ▶ Parking: 2001
- ▶ City / County: 4 / 1000
Parker / Douglas

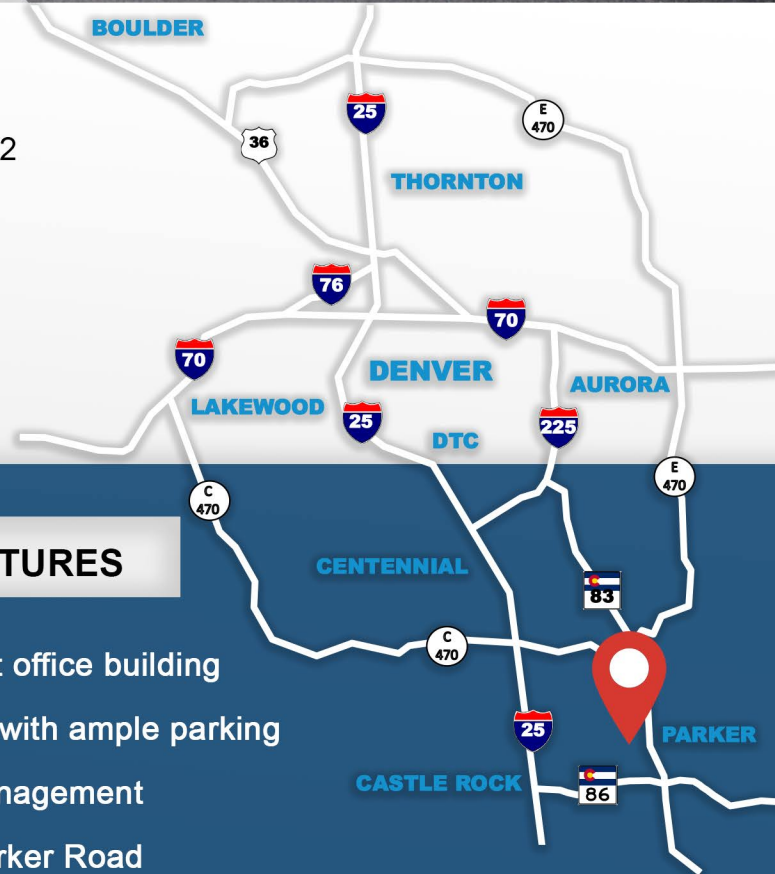

PROPERTY FEATURES

- Professional, quiet office building
- Strong tenant mix with ample parking
- Local property management
- 1/2 block off of Parker Road
- 7 minutes to E-470, 15 minutes to I-25, and 30 minutes to Downtown Denver

NICK NICKERSON

303-968-6183

nick@trevey.com

Information contained herein, while not guaranteed, is from sources believed reliable. Price, terms and information subject to change. Please call to confirm current property status and accuracy of information contained herein.

OFFICE SPACE FOR LEASE

STROH PROFESSIONAL



12760 STROH RANCH WAY, PARKER, COLORADO 80134

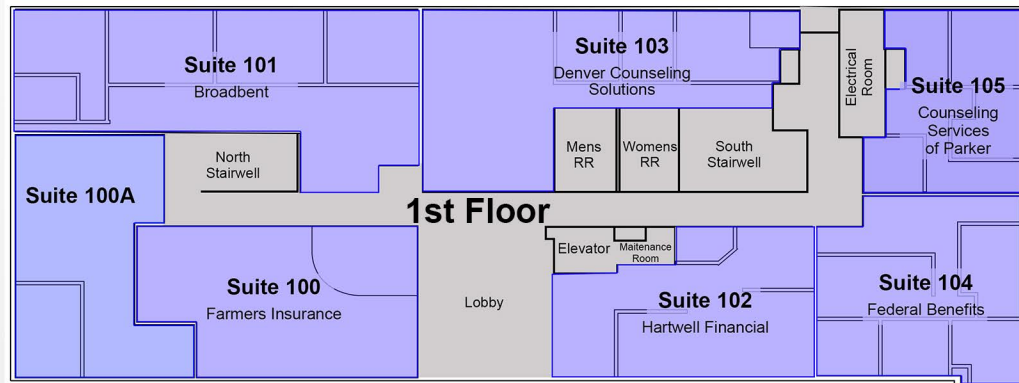
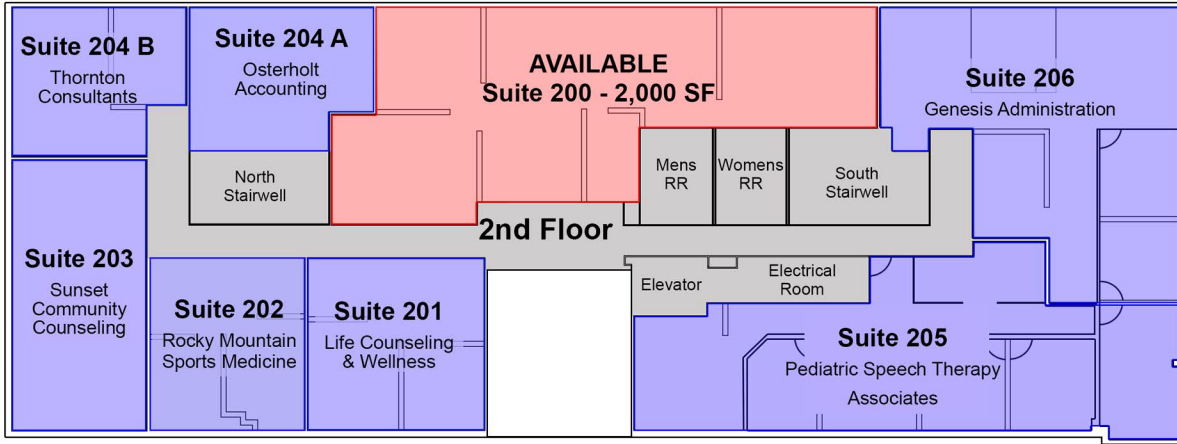

DEMOGRAPHICS

2021 POPULATION

1 MILE - 6,720
3 MILES - 50,951
5 MILES - 97,454

2026 POPULATION

1 MILE - 7,350
3 MILES - 55,882
5 MILES - 107,393

H.H. INCOME

1 MILE - \$120,981
3 MILES - \$126,546
5 MILES - \$127,092

TRAFFIC COUNTS

ANNUAL AVERAGE DAILY TRAFFIC

Approx. 44,000 VPD on Parker Rd
Approx. 8,000 VPD on Stroh Rd

NICK NICKERSON

303-968-6183
nick@trevey.com

