

FOR SALE

2 PARCELS AVAILABLE IN WORTHINGTON

1821

WEST DUBLIN GRANVILLE ROAD

Worthington, OH 43085



AVAILABLE FOR SALE

Two (2) parcel's on the SW corner of W. Dublin Granville and Olentangy River Road with easy access to Route 315, a major freeway system, and surrounded by residential neighborhood in the Worthington area market.

- + Asking Price \$295,000
- + ± 1.9 AC
- + Quick access to Route 315



CONTACT US

DON MATSANOFF

First Vice President
+1 614 430 5000
don.matsanoff@cbre.com

KIRK SMITH

Senior Associate
+1 614 430 5047
kirk.smith@cbre.com

www.cbre.us/columbus

CBRE

FOR SALE

LAND FOR SALE / DEVELOPMENT OPPORTUNITY

1821
WEST DUBLIN
GRANVILLE ROAD
Worthington, OH 43085



LOCATION MAP

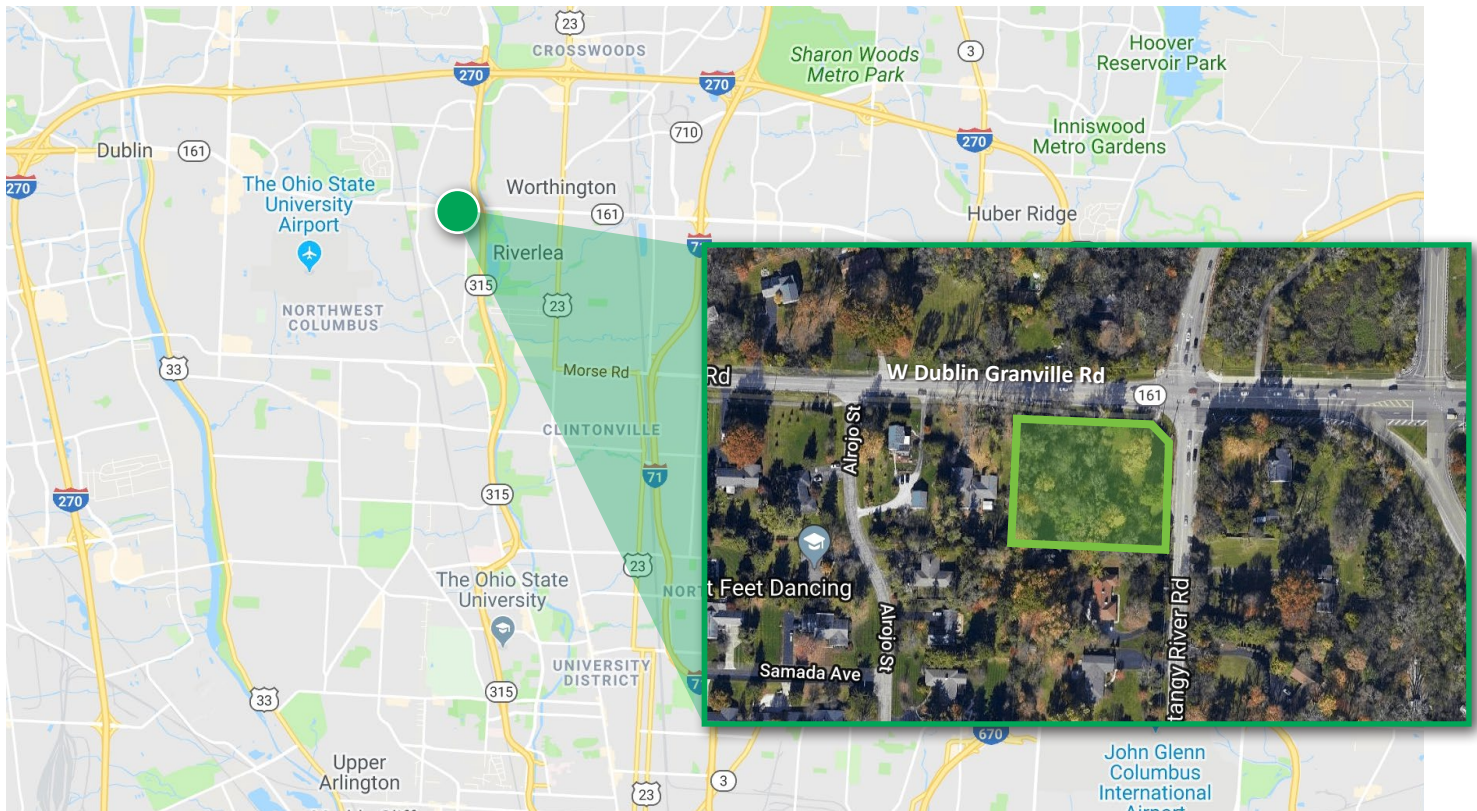

CONTACT US

DON MATSANOFF

First Vice President
+1 614 430 5000
don.matsanoff@cbre.com

KIRK SMITH

Senior Associate
+1 614 430 5047
kirk.smith@cbre.com

© 2018 CBRE, Inc. All rights reserved. This information has been obtained from sources believed reliable, but has not been verified for accuracy or completeness. You should conduct a careful, independent investigation of the property and verify all information. Any reliance on this information is solely at your own risk. CBRE and the CBRE logo are service marks of CBRE, Inc. All other marks displayed on this document are the property of their respective owners. Photos herein are the property of their respective owners. Use of these images without the express written consent of the owner is prohibited.

www.cbre.us/columbus

CBRE