

# FOR LEASE

3120 Brushy Creek Road Greer, SC 29650

**NAI** Earle Furman

**PALMS AT BRUSHY CREEK**  
Greer, SC



## Retail | 1,200 - 2,400 SF

- Available May, 2020
- Two 1,200 SF suites available
- Outdoor patio space
- Electric car charging station
- Park with playground & picnic shelter
- Skylights for tenant spaces
- Adjacent to 150 new townhomes
- Tenant's include an organic cafe and a kickboxing gym
- Traffic count: 9,700 vpd
- Lease rate: \$22.00/SF NNN



✉ **Fred "Alex" Campbell**  
O: +1 864 678 5984  
C: +1 864 901 3869  
acampbell@naiearlefurman.com

No Warranty Or Representation, Express Or Implied, Is Made As To The Accuracy Of The Information Contained Herein, And The Same Is Submitted Subject To Errors, Omissions, Change Of Price, Rental Or Other Conditions, Prior Sale, Lease Or Financing, Or Withdrawal Without Notice, And Of Any Special Listing Conditions Imposed By Our Principals. No Warranties Or Representations Are Made As To The Condition Of The Property Or Any Hazards Contained Therein Are Any To Be Implied.

📍 **101 E Washington St**  
Greenville, SC 29601  
naief.com

# FOR LEASE

3120 Brushy Creek Road Greer, SC 29650

## PALMS AT BRUSHY CREEK Greer, SC



### SITE FEATURES & CONTEXT

1. Proposed 8,600 SF Retail Building
2. Outdoor Patio Space
3. Drive-Through Lane
4. Electric Car Charging Station
5. Park with Playground and Picnic Shelter
6. Stairs/ Pedestrian Connection to Townhomes
7. Townhomes
8. Future Townhomes
9. New Sidewalk and Street Trees
10. Skylights for Tenant Spaces

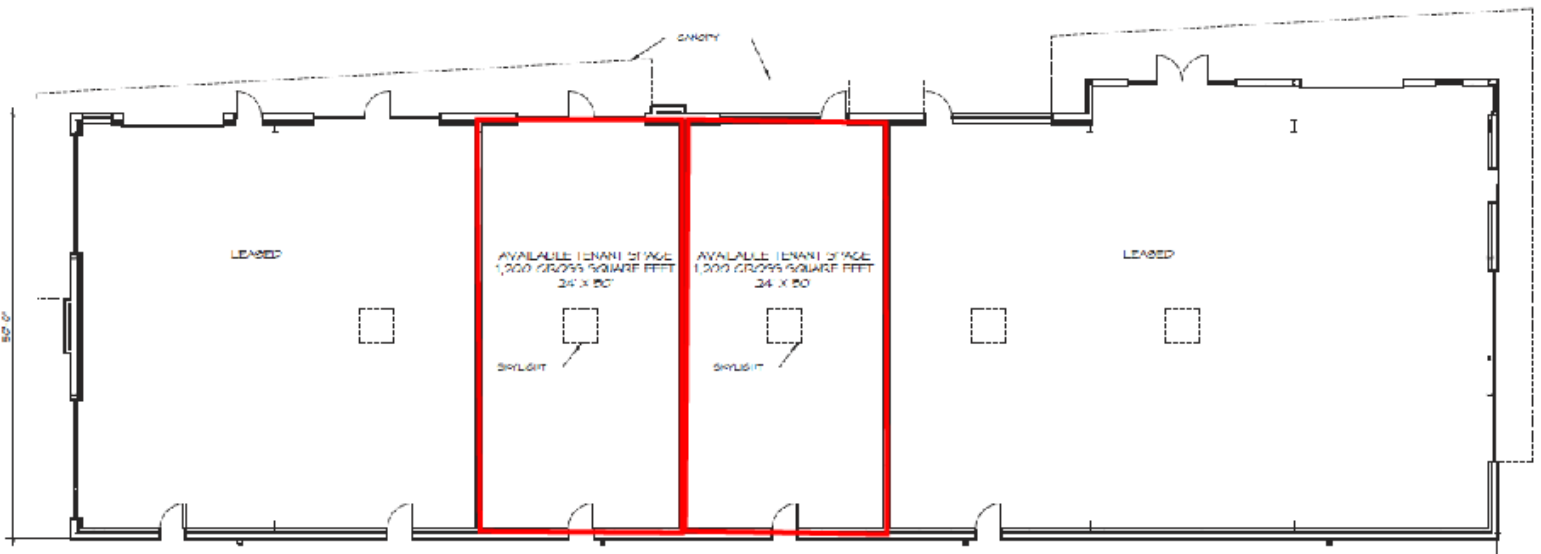

 **Fred "Alex" Campbell**  
 O: +1 864 678 5984  
 C: +1 864 901 3869  
 acampbell@naiearlefurman.com

No Warranty Or Representation, Express Or Implied, Is Made As To The Accuracy Of The Information Contained Herein, And The Same Is Submitted Subject To Errors, Omissions, Change Of Price, Rental Or Other Conditions, Prior Sale, Lease Or Financing, Or Withdrawal Without Notice, And Of Any Special Listing Conditions Imposed By Our Principals. No Warranties Or Representations Are Made As To The Condition Of The Property Or Any Hazards Contained Therein Are To Be Implied.

**NAI Earle Furman**