

# First Grand Parkway Commerce Center

SWQ of Grand Parkway & Morton Ranch Rd.  
Katy, Texas

## TWO REAR LOAD DISTRIBUTION BUILDINGS FOR LEASE



### 173,045 SF & 198,905 SF AVAILABLE

## WEST HOUSTON'S NEWEST DEVELOPMENT

NEW CONSTRUCTION • GREAT VISIBILITY • DIRECT ACCESS TO HWY 99

### BUILDING 1

- 173,045 SF - divisible
- 301 parking spaces (expandable up to 365)
- 130' truck court
- 46'-8" x 52' column spacing (60' speed bay)
- 32' clear height

### BUILDING 2

- 198,905 SF - divisible
- 310 parking spaces
- 130' truck court
- 56'-8" x 52' column spacing (60' speed bay)
- 32' clear height

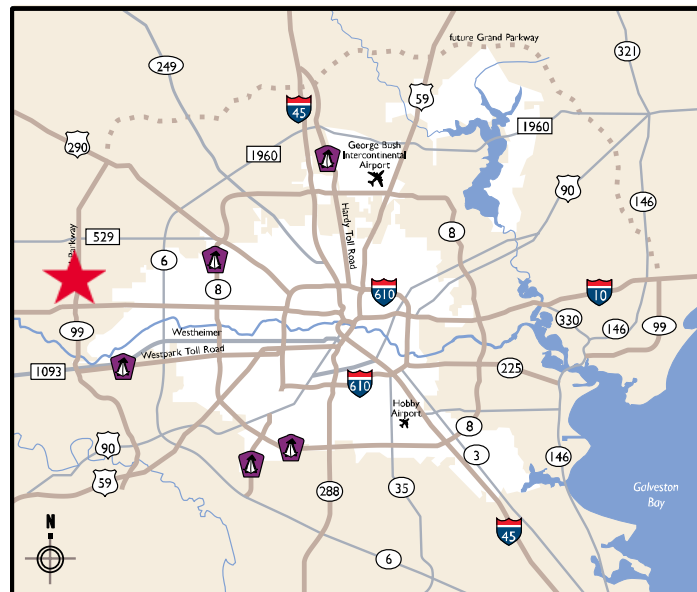

Allison Bergmann  
Director  
+1 713 963 2865

[allison.bergmann@cushwake.com](mailto:allison.bergmann@cushwake.com)



Beau Kaleel  
Senior Director  
+1 713 963 2844

[beau.kaleel@cushwake.com](mailto:beau.kaleel@cushwake.com)



FOR LEASE – REAR LOAD

# First Grand Parkway Commerce Center

SWQ of Grand Parkway & Morton Ranch Road  
Katy, Texas

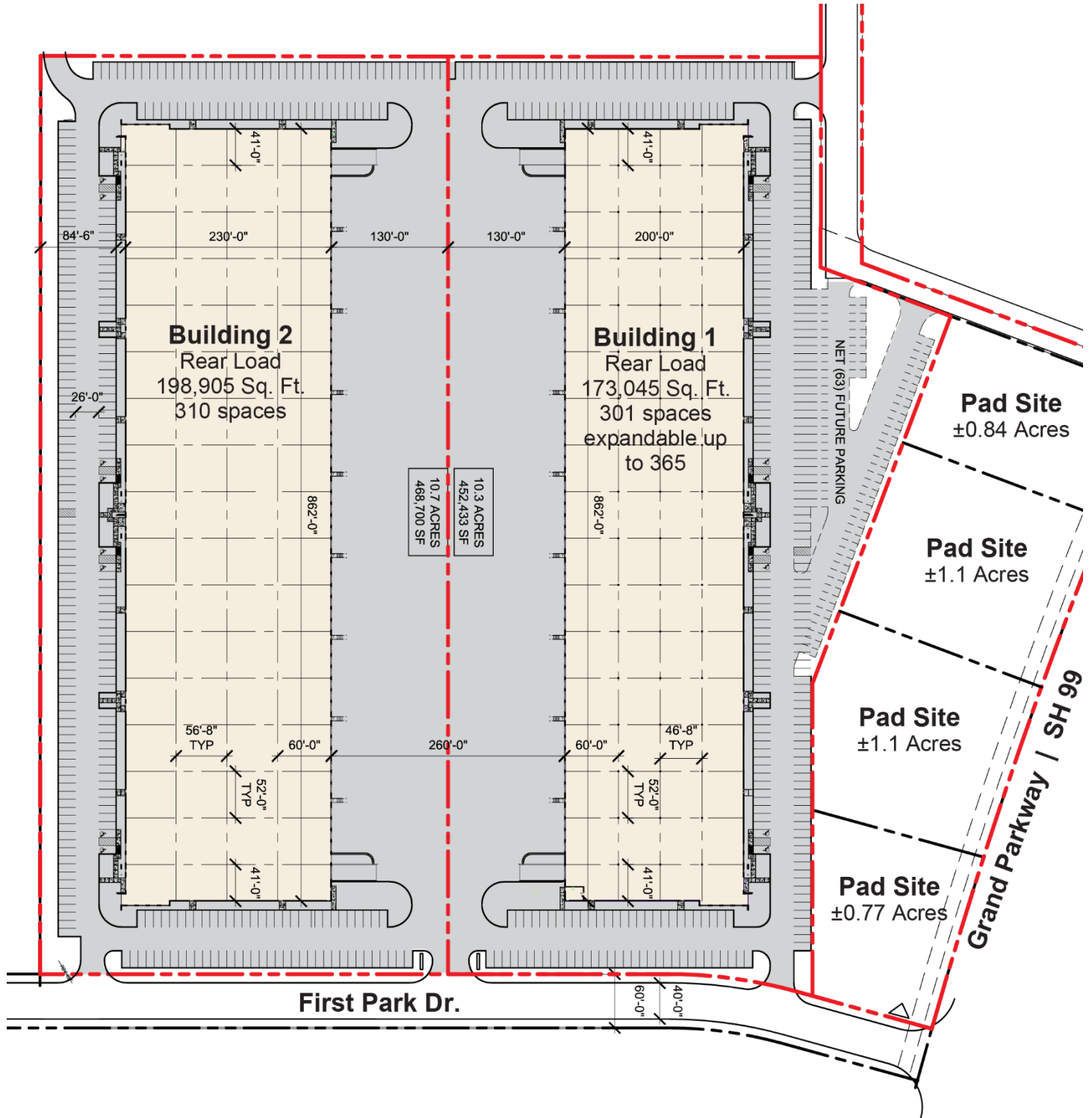

For more information, please contact:

**Allison Bergmann**  
 +1 713 963 2865  
[allison.bergmann@cushwake.com](mailto:allison.bergmann@cushwake.com)

**Beau Kaleel**  
 +1 713 963 2844  
[beau.kaleel@cushwake.com](mailto:beau.kaleel@cushwake.com)

Cushman & Wakefield  
 1330 Post Oak Blvd.  
 Ste. 2700  
 Houston, TX 77056  
 Phone: +1 713 877 1700





FOR LEASE - REAR LOAD

# First Grand Parkway Commerce Center

SWQ of Grand Parkway & Morton Ranch Road  
Katy, Texas



**Subject**

Allison Bergmann  
+1 713 963 2865  
[allison.bergmann@cushwake.com](mailto:allison.bergmann@cushwake.com)

Beau Kaleel  
+1 713 963 2844  
[beau.kaleel@cushwake.com](mailto:beau.kaleel@cushwake.com)

1330 Post Oak Blvd.  
Ste. 2700  
Houston, TX 77056  
Phone: +1 713 877 1700