

INTECH Three

INTECH Three • 6510 Telecom Drive • Indianapolis • Indiana • 46278



Park overview & amenities:

INTECH Park is the largest office development in Indiana.

Indiana's only privately held Certified Technology Park.

Advanced information technology infrastructure.

Attractive natural setting with water views.

2.5 miles of walking paths.

Hotels	Banking
Restaurants	Dry cleaning facilities
Daycare	

Location & access:

- > Northwest side of Indianapolis at I-465 & W.71st Street.
- > 15 minutes from the CBD and Indianapolis International Airport.
- > 1 mile of interstate frontage.
- > Excellent access via I-465 & I-65 - newly redesigned W. 71st Street interchange.
- > Close proximity to highly skilled labor pool.
- > IndyGo bus line route access.



I-465 signage available

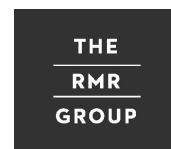

Available suites:

> First floor

Suite 110	9,665 RSF
Suite 160	5,497 RSF
Suite 165	3,097 RSF

> Second floor

Suite 200	38,700 RSF
-----------	------------

> Third floor

Suite 300	26,238 RSF *
Suite 320	2,477 RSF *

* Contiguous 28,715 RSF

First Floor Availability

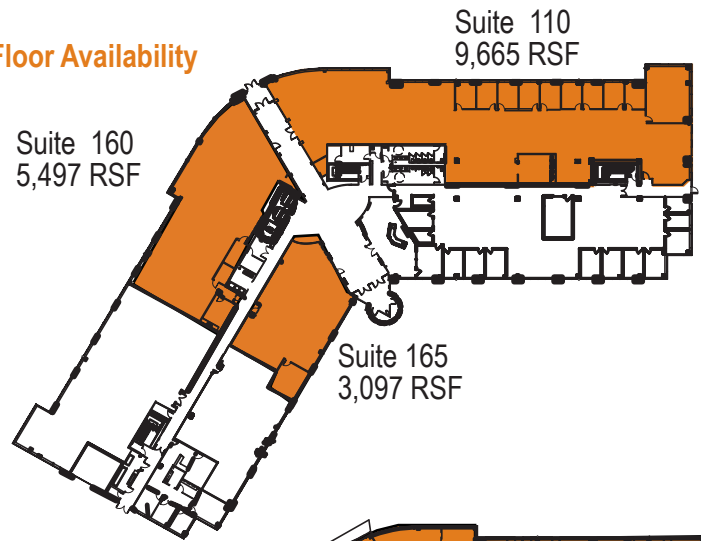

Second Floor Availability

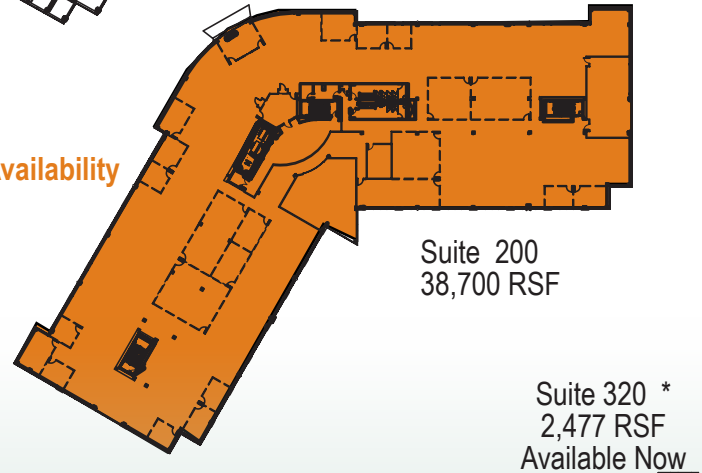

Third Floor Availability

Suite 300 *
26,238 RSF
Available Now

* Contiguous
28,715 RSF

Building & Park information:

- > 142,227 total square feet
- > 4-story, Class A office building
- > Beautifully-appointed lobby
- > +/- 39,900 square foot floor plates
- > 100 seat conference center (INTECH One)
- > Cafe (INTECH One)
- > 4/1,000 s.f. parking ratio



For more information, contact:

John Robinson
Managing Director
+317 810 7172
john.robinson@am.jll.com

Abby Zito
Vice President
+317 810 7173
abby.zito@am.jll.com



THE
RMR
GROUP