

STONE REAL ESTATE

209 SOUTH LASALLE



6,178

DIVISIBLE
Square feet available



56K

Office population in a
two block radius



110'4"

Frontage on
Adams Street

Available Retail in Prestigious Rookery



PROPERTY DESCRIPTION

Designed by Daniel Burnham and John Root with interior design by Frank Lloyd Wright, this building is famous for its prominence and iconic architecture.

AVAILABLE SPACE

6,178 square feet with 110'4" frontage on Adams Street with potential for outside seating

OFFICE POPULATION

An estimated 118,425 people work within a two block radius of the building.

WEEKDAY PEDESTRIAN TRAFFIC

An estimated 10,100 pedestrians on Adams Street per weekday.

COMMERCIAL TENANTS



\$112.7K

Average household income
in a 2 block radius



8.4K

Average daily sidewalk foot
traffic on LaSalle Street



18K

Vehicles per day at the
intersection

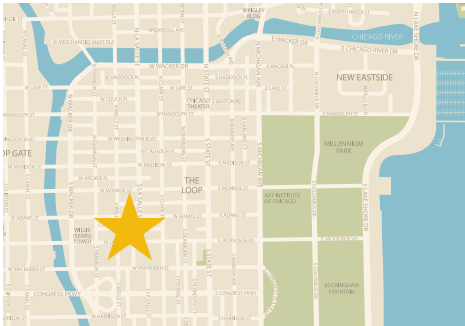

EXCLUSIVE AGENTS

Eric Kamen 312/782-1375
ekamen@stonerealestate.com

John Vance 312/782-1373
jvance@stonerealestate.com

PROPERTY MANAGEMENT

The John Buck Company

STONE
REAL ESTATE

STONE REAL ESTATE

209 SOUTH LASALLE

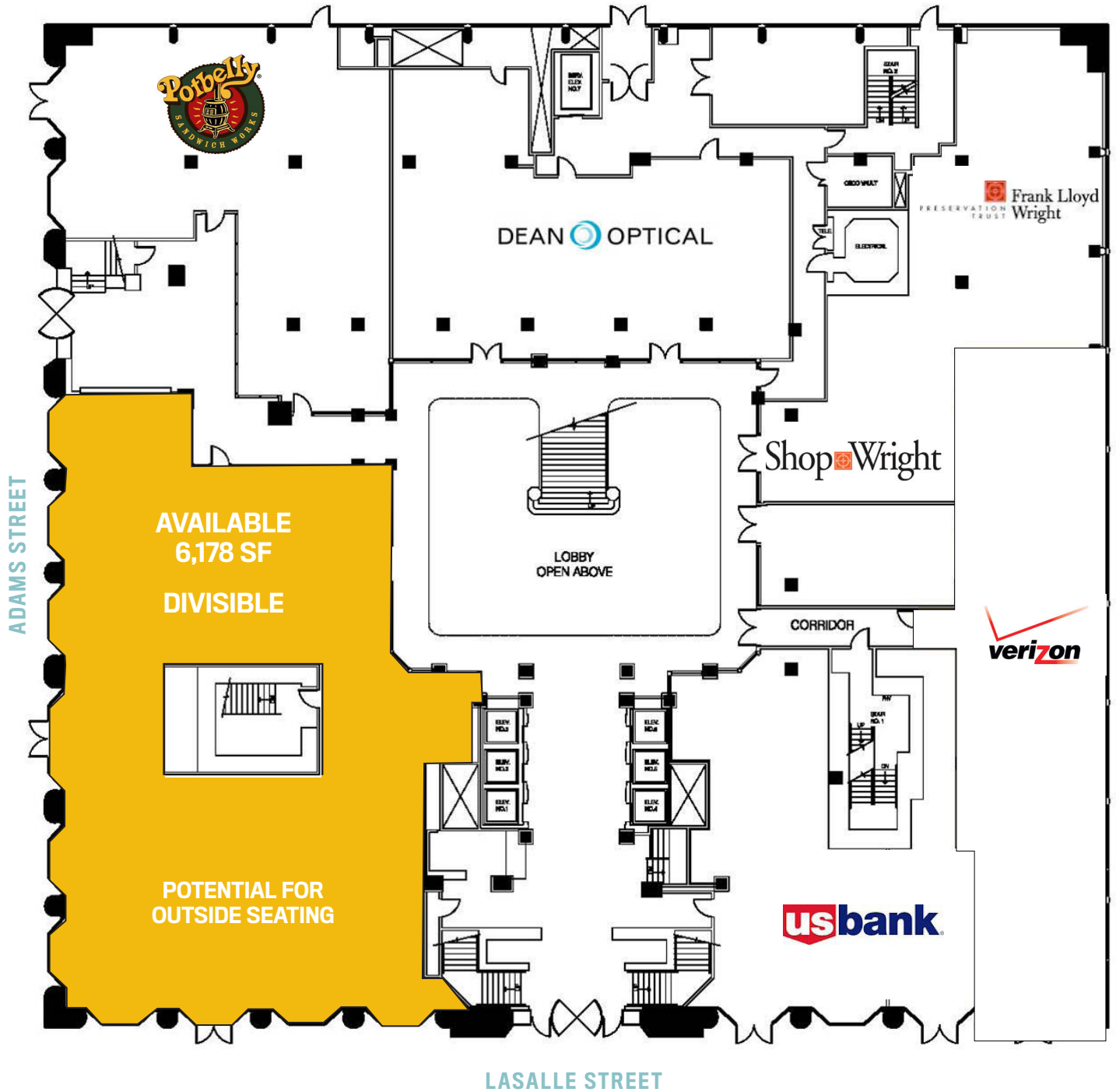

EXCLUSIVE AGENTS

Eric Kamen 312/782-1375
ekamen@stonerealestate.com

John Vance 312/782-1373
jvance@stonerealestate.com

PROPERTY MANAGEMENT

The John Buck Company

STONE
REAL ESTATE

CONCEPTUAL TWO-TENANT PLAN

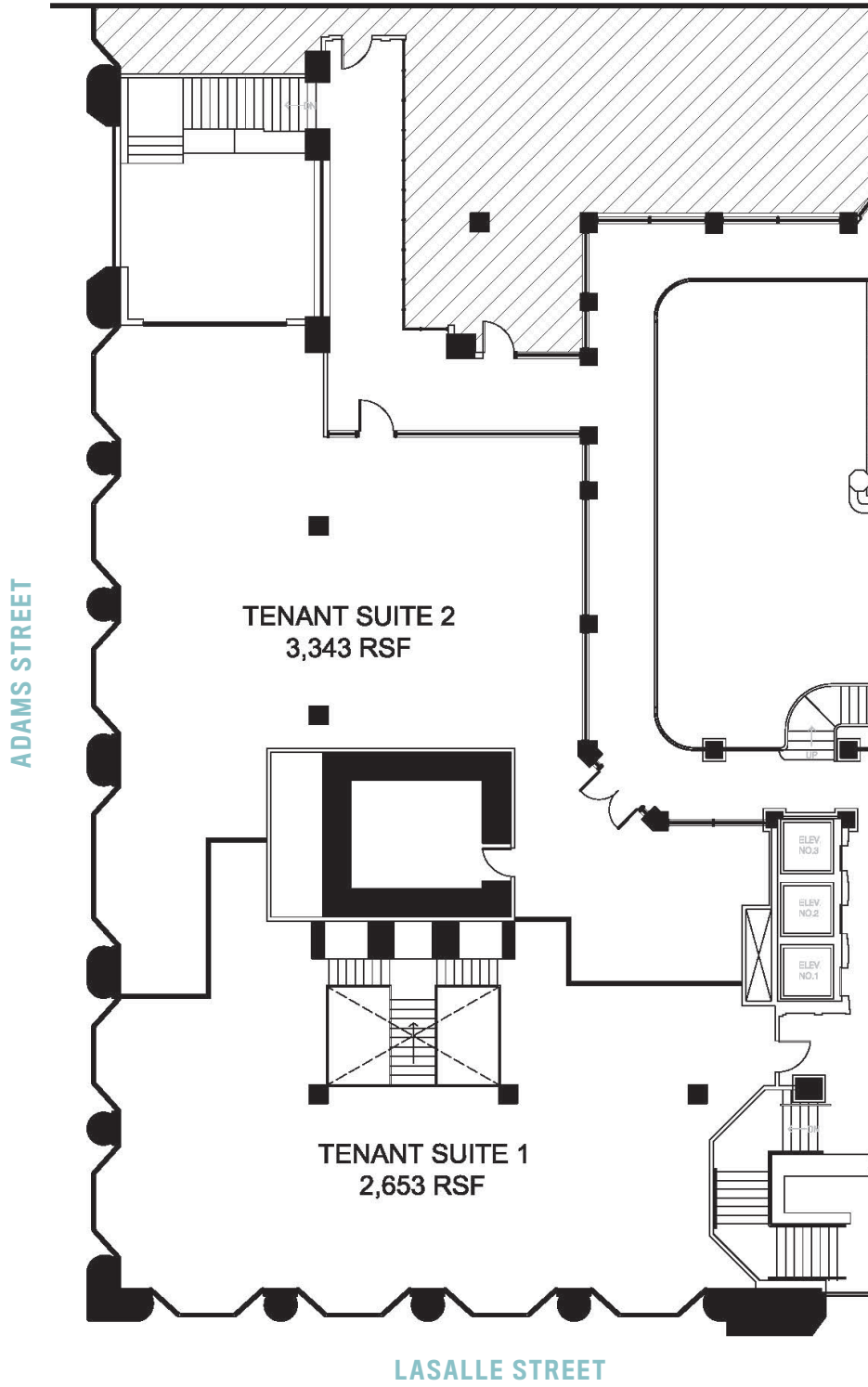

EXCLUSIVE AGENTS

Eric Kamen 312/782-1375
ekamen@stonerealestate.com

John Vance 312/782-1373
jvance@stonerealestate.com

PROPERTY MANAGEMENT

The John Buck Company

SECOND FLOOR PLAN

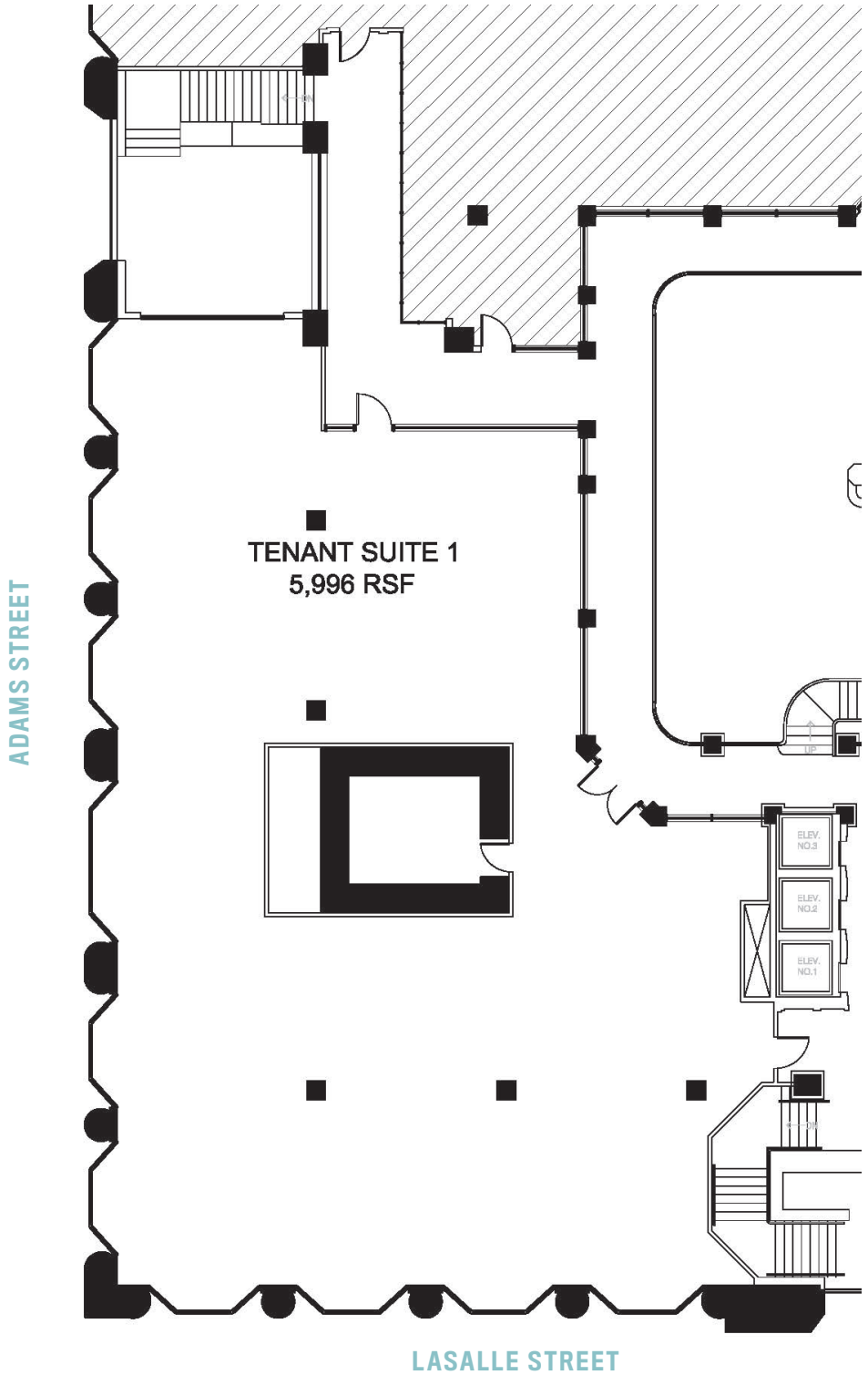

EXCLUSIVE AGENTS

Eric Kamen 312/782-1375
ekamen@stonerealestate.com

John Vance 312/782-1373
jvance@stonerealestate.com

PROPERTY MANAGEMENT

The John Buck Company

STONE REAL ESTATE
209 SOUTH LASALLE

ADAMS STREET RENDERING



EXCLUSIVE AGENTS

Eric Kamen 312/782-1375
ekamen@stonerealestate.com

John Vance 312/782-1373
jvance@stonerealestate.com

PROPERTY MANAGEMENT

The John Buck Company

STONE
REAL ESTATE