

OGDEN WEBER CENTER

2380 Washington Boulevard, Ogden, Utah 84401



FOR LEASE

\$18.00 PSF FULL SERVICE

PROPERTY FEATURES

- 4,518 – 21,931 SF Available
- Located in the Heart of Downtown Ogden
- Professional Co-Tenants
- Abundant Parking Available
 - Onsite Parking Garage with 3/1,000 Ratio
 - Additional adjacent surface parking available
- Adjacent to The Junction, Ogden's Downtown Entertainment District

FOR MORE
INFORMATION
CONTACT

CHRIS FALK, CCIM, SIOR
801.416.1024
chris.falk@ngkf.com

BRAXTON WILLIE, CCIM
801.416.1050
braxton.willie@ngkf.com



1755 East 1450 South, Suite 100 | Clearfield, Utah 84015 | 801.927.2000 | www.ngacres.com

This document has been prepared by Newmark Knight Frank for advertising and general information purposes only. While the information contained herein has been obtained from what are believed to be reliable sources, the same has not been verified for accuracy or completeness. Newmark Knight Frank accepts no responsibility or liability for the information contained in this document. Any interested party should conduct an independent investigation to verify the information contained herein.

OGDEN WEBER CENTER

2380 Washington Boulevard, Ogden, Utah 84401



OGDEN WEBER CENTER

2380 Washington Boulevard, Ogden, Utah 84401

FIRST LEVEL

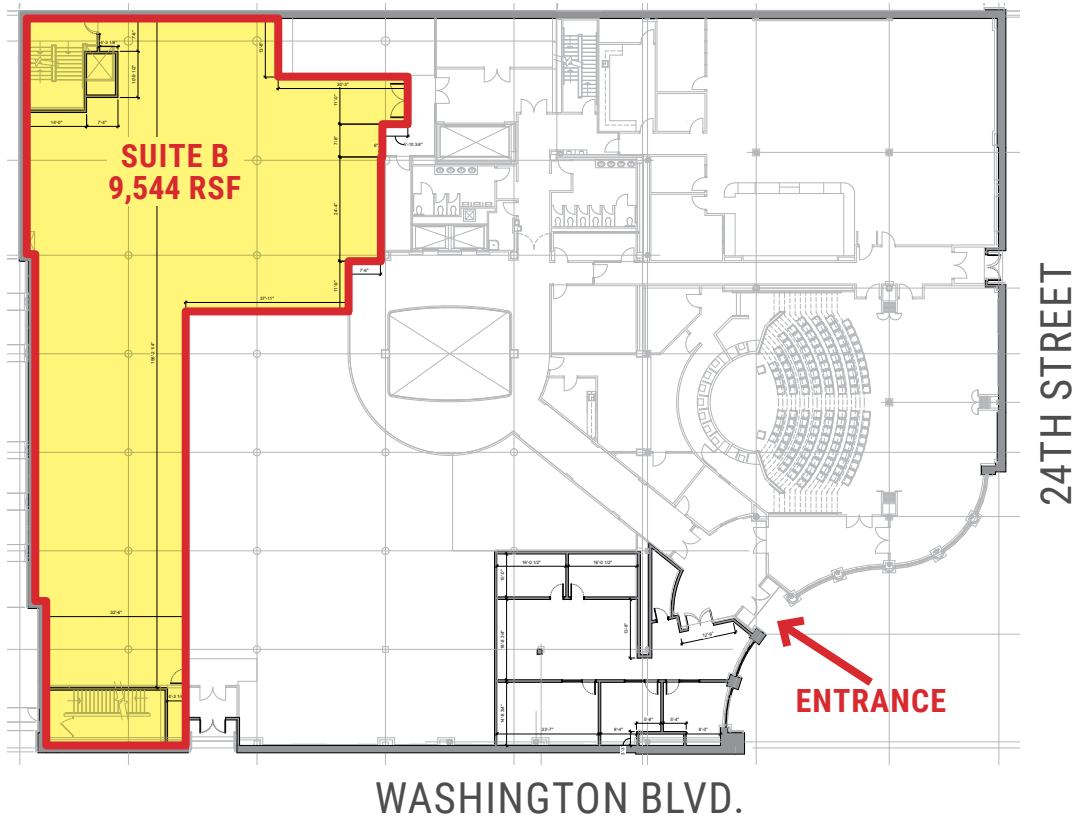

BELOW GRADE LEVEL

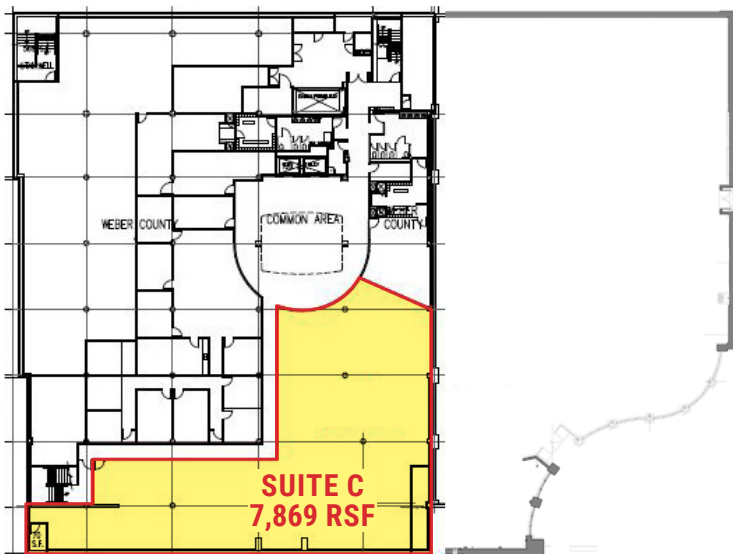

SECOND LEVEL

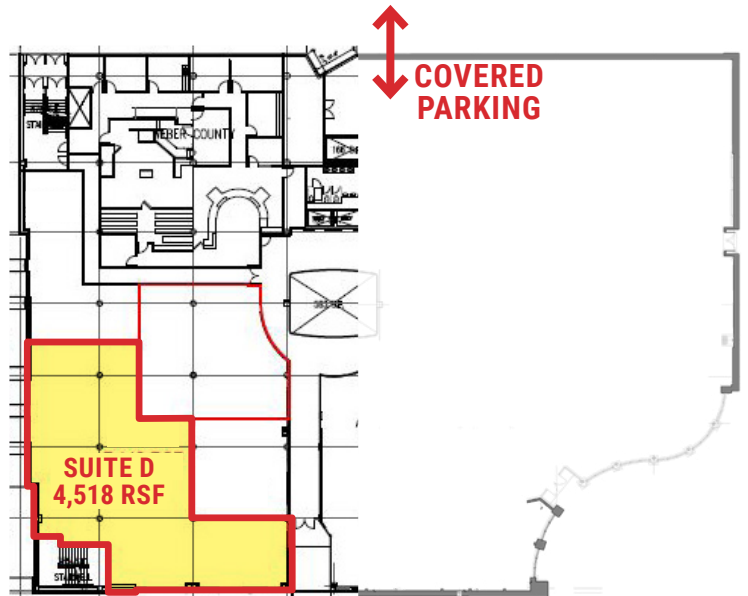

*Suites B, C & D are contiguous via stairwell connectivity