

For Lease

4,980 SF



14 Jules Lane, New Brunswick



For additional information, please contact:

Chad Hillyer
(732) 590-4173
chad.hillyer@am.jll.com



A project by:



The information contained herein is deemed reliable; however Bristol Group, Inc. does not guarantee its accuracy. Terms and conditions are subject to change.

For Lease

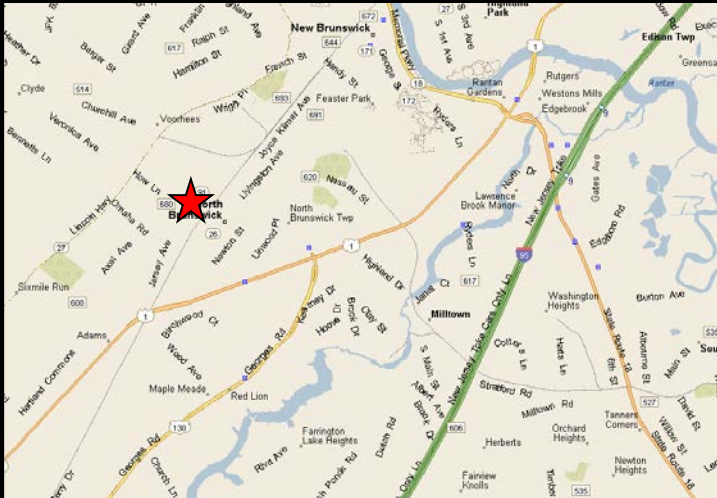
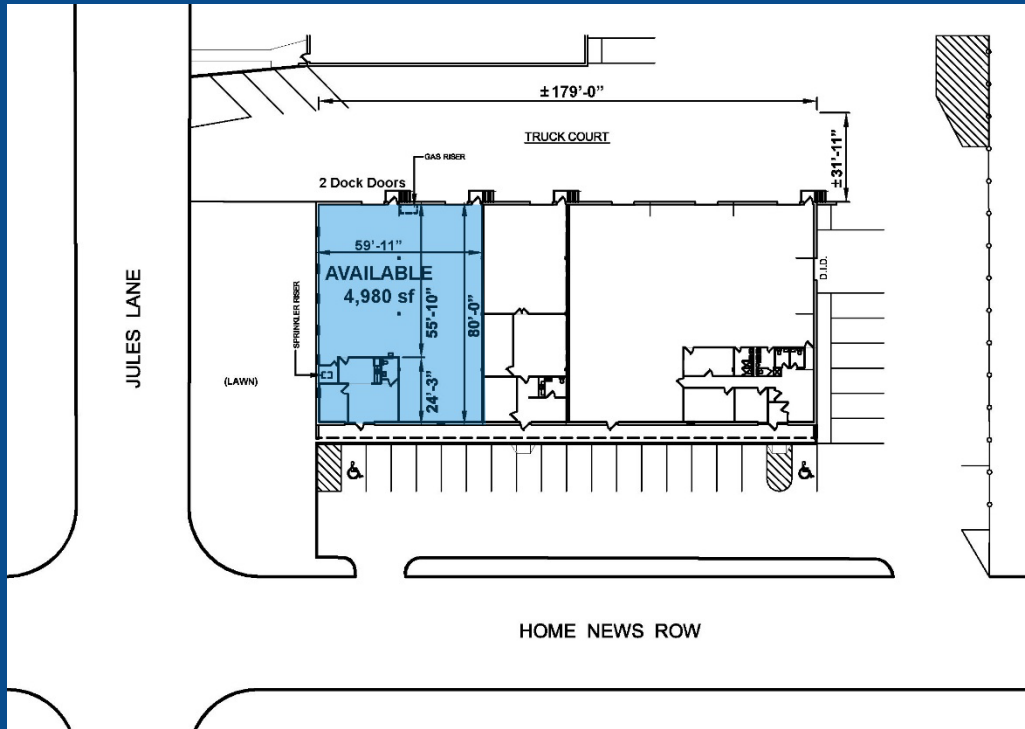

PROPERTY FEATURES:

- 14,940 SF total building size
- 4,980 SF available
- 645 SF office
- 17'9" clear ceiling height
- 2 loading docks
- 6 parking spaces

For additional information, please contact:

Chad Hillyer
(732) 590-4173
chad.hillyer@am.jll.com



A project by:



The information contained herein is deemed reliable; however Bristol Group, Inc. does not guarantee its accuracy. Terms and conditions are subject to change.