



PROVIDENCE GROUP CAPITAL

**FOR SALE**

# MIDTOWN OFFICE CONDOMINIUM FOR SALE

1355 GREENWOOD CLIFF (top floor) | CHARLOTTE, NC 28204

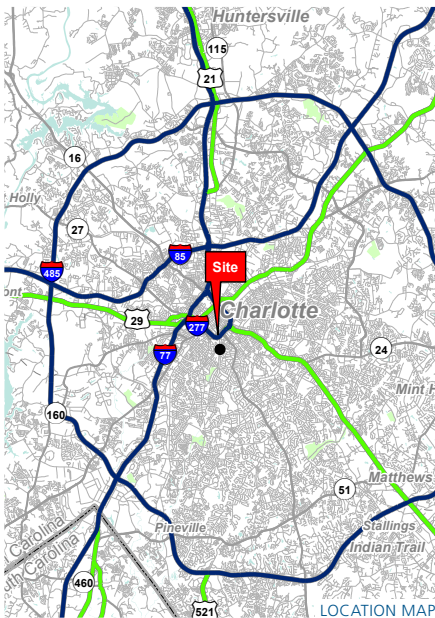

## PROPERTY INFORMATION

- Class A office space
- 6,488 rentable SF (4,976 useable SF)
- Terrace space: 1,486 SF (Two terraces - 743 SF each)
- Offering price: **\$2,400,000**
- Seller Leaseback: 3 years

## PROPERTY HIGHLIGHTS

- Seven (7) deeded covered parking spaces
- Conveniently located in the center of Midtown
- Easy access to Uptown and major highways (I-277, I-77 & I-85)
- Secured building access
- Little Sugar Creek Greenway 500 feet from the property
- Sweeping views of Uptown
- Showers in restrooms

DEMOGRAPHICS (2018)	1 MILE	3 MILE	5 MILE
POPULATION	12,425	122,911	268,334
DAYTIME EMPLOYMENT	42,734	167,384	258,394
COMBINED POPULATION	55,159	290,295	526,728
BUSINESS ESTABLISHMENTS	3,301	12,003	20,005

1616 Camden Rd. Suite 550 | Charlotte, NC 28203 | Phone (704) 365-0820 | WWW.PROVIDENCEGROUP.COM

Eric Nichols | enichols@providencegroup.com | JQ Freeman | jfreeman@providencegroup.com | Mary Bryant | mbryant@providencegroup.com

# MIDTOWN OFFICE CONDOMINIUM FOR SALE

1355 GREENWOOD CLIFF (top floor) | CHARLOTTE, NC 28204

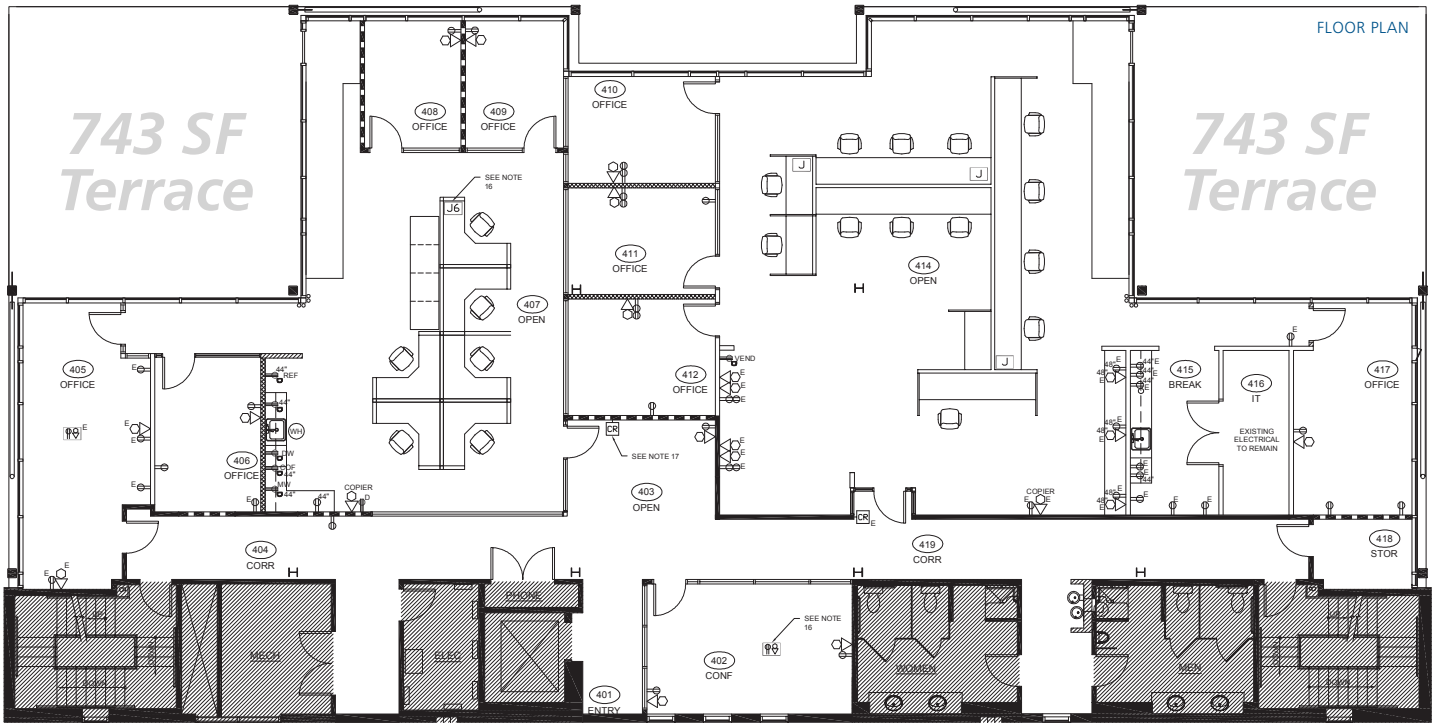

1616 Camden Rd. Suite 550 | Charlotte, NC 28203 | Phone (704) 365-0820 | WWW.PROVIDENCEGROUP.COM

Eric Nichols | enichols@providencegroup.com | JQ Freeman | jfreeman@providencegroup.com | Mary Bryant | mbryant@providencegroup.com



PROVIDENCE GROUP CAPITAL

**FOR SALE**

## MIDTOWN OFFICE CONDOMINIUM FOR SALE

1355 GREENWOOD CLIFF (*top floor*) | CHARLOTTE, NC 28204

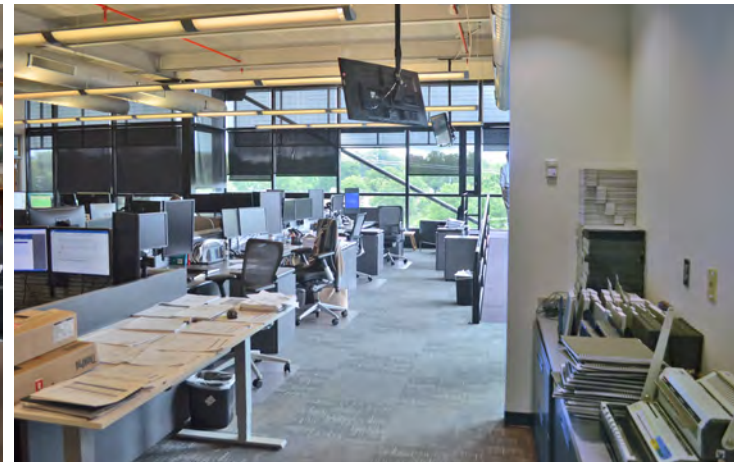

1616 Camden Rd. Suite 550 | Charlotte, NC 28203 | Phone (704) 365-0820 | [WWW.PROVIDENCEGROUP.COM](http://WWW.PROVIDENCEGROUP.COM)

Eric Nichols | [enichols@providencegroup.com](mailto:enichols@providencegroup.com) | JQ Freeman | [jfreeman@providencegroup.com](mailto:jfreeman@providencegroup.com) | Mary Bryant | [mbryant@providencegroup.com](mailto:mbryant@providencegroup.com)

---

# MIDTOWN OFFICE CONDOMINIUM FOR SALE

1355 GREENWOOD CLIFF *(top floor)* | CHARLOTTE, NC 28204

---

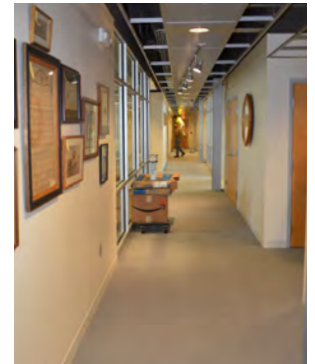

---

1616 Camden Rd. Suite 550 | Charlotte, NC 28203 | Phone (704) 365-0820 | [WWW.PROVIDENCEGROUP.COM](http://WWW.PROVIDENCEGROUP.COM)

Eric Nichols | [enichols@providencegroup.com](mailto:enichols@providencegroup.com) | JQ Freeman | [jfreeman@providencegroup.com](mailto:jfreeman@providencegroup.com) | Mary Bryant | [mbryant@providencegroup.com](mailto:mbryant@providencegroup.com)

---

© 2018 The Providence Group. All rights reserved. The information above has been obtained by sources deemed reliable. While we do not doubt its accuracy, we have not verified it and make no guarantee, warranty, or representation of it. It is your responsibility to independently confirm its accuracy and completeness. You and your advisors should conduct a careful, independent investigation of the property to determine to your satisfaction the suitability of the property for your needs.

