

±13,667 SF & ±17,748 SF



Office/R&D Space For Lease
Can be Combined for a Total of ±31,415 SF



TriPoint Business Park

1800 Bering Drive
San Jose, CA 95112

LOCATION

1800 Bering Drive of TriPoint Business Park is located on the corner of Bering Drive and Zanker Road and parallels Highway 101 in San Jose, CA.

FACILITY

- New Class "A" Interior Improvements Planned
- LEED Silver Certified Rehab Project
- Open Ceiling Creative Office Interior
- Lab Area
- 1,600 Amps @ 120/208 Volt
- Expanded Windowline
- Up to 16' Clear Height
- Great Expansion Potential within the Park
- Dock & Grade Loading
- ±3.47/1,000 Parking
- Available Now

ADVANTAGES AND AMENITIES

- Expansive Break Room
- Walking Distance to 24hr Fitness & Amenities



±13,667 SF & ±17,748 SF



Office/R&D Space For Lease
Can be Combined for a Total of ±31,415 SF



Alan Guterman
alan.guterman@cushwake.com
ph +1 408 615 3414
cell +1 408 888 0881
Lic #00884495
300 Santana Row, Fifth Floor
San Jose, CA 95128

Jon DeCoite
jon.decoite@cushwake.com
ph +1 408 615 3408
cell +1 408 843 3499
LIC #01471300
300 Santana Row, Fifth Floor
San Jose, CA 95128

Kelly Yoder
kelly.yoder@cushwake.com
ph +1 408 615 3427
cell +1 408 439 6672
LIC #01821117
300 Santana Row, Fifth Floor
San Jose, CA 95128

Steve Horton
steve.horton@cushwake.com
ph +1 408 615 3412
cell +1 408 726 1010
LIC #01127340
300 Santana Row, Fifth Floor
San Jose, CA 95128

Amy Pallas
apallas@prologis.com
ph +1 510 661 4087
cell +1 650 380 3129
LIC #00935272
3353 Gateway Boulevard
Fremont, CA 94538

[View Site Specific COVID-19 Prevention Plan](#)

No warranty or representation, expressed or implied, is made as to the accuracy of the information contained herein, and same is submitted subject to error and omissions.

www.prologis.com
CalDRE Lic #01944561

±13,667 SF & ±17,748 SF



Office/R&D Space For Lease

Can be Combined for a Total of ±31,415 SF

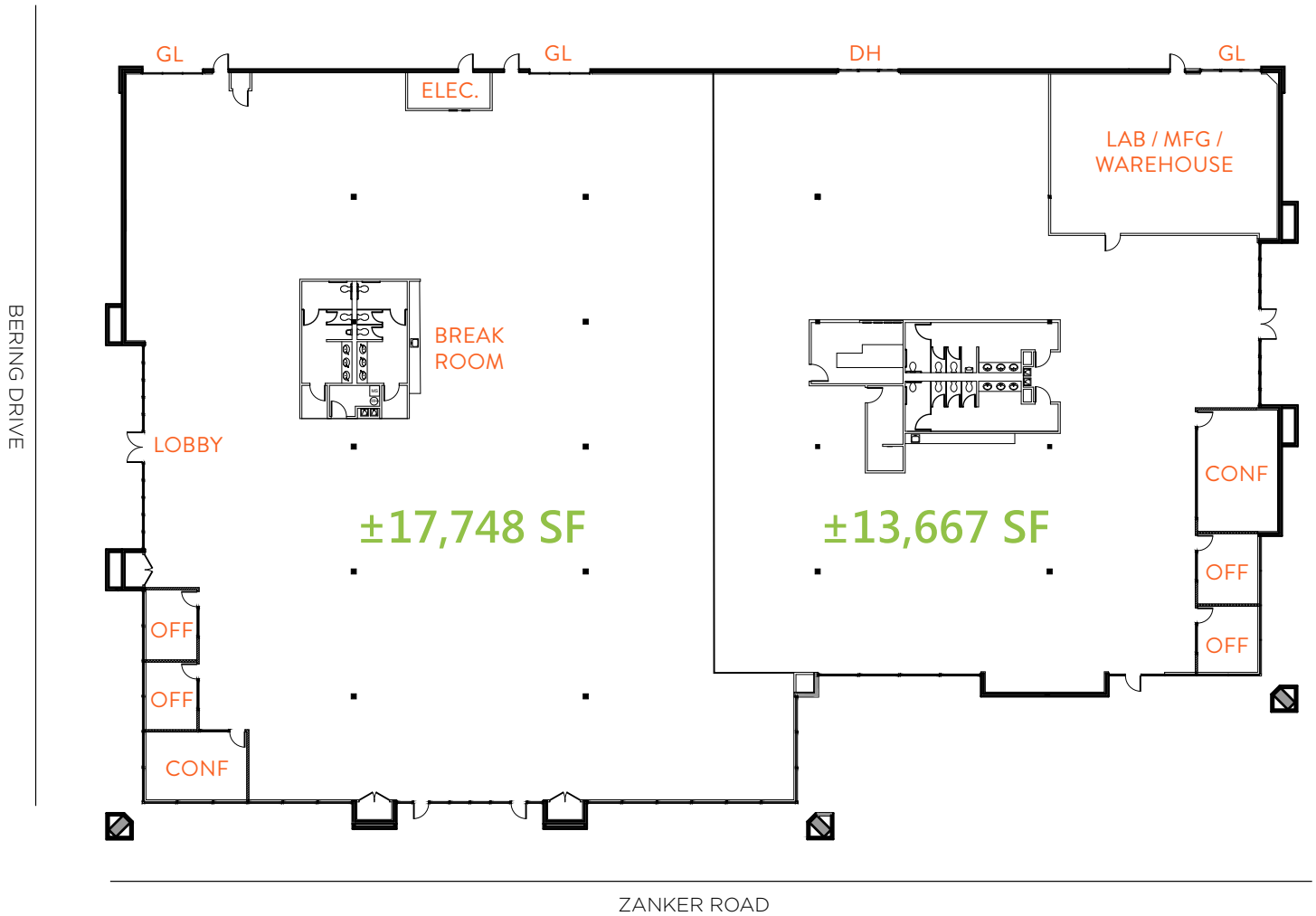

Alan Guterman
alan.guterman@cushwake.com
ph +1 408 615 3414
cell +1 408 888 0881
Lic #00884495
300 Santana Row, Fifth Floor
San Jose, CA 95128

Jon DeCoite
jon.decoite@cushwake.com
ph +1 408 615 3408
cell +1 408 843 3499
LIC #01471300
300 Santana Row, Fifth Floor
San Jose, CA 95128

Kelly Yoder
kelly.yoder@cushwake.com
ph +1 408 615 3427
cell +1 408 439 6672
LIC #01821117
300 Santana Row, Fifth Floor
San Jose, CA 95128

Steve Horton
steve.horton@cushwake.com
ph +1 408 615 3412
cell +1 408 726 1010
LIC #01127340
300 Santana Row, Fifth Floor
San Jose, CA 95128

Amy Pallas
apallas@prologis.com
ph +1 510 661 4087
cell +1 650 380 3129
LIC #00935272
3353 Gateway Boulevard
Fremont, CA 94538

[View Site Specific COVID-19 Prevention Plan](#)

No warranty or representation, expressed or implied, is made as to the accuracy of the information contained herein, and same is submitted subject to error and omissions.

www.prologis.com
CalDRE Lic #01944561

±31,415 SF



Office/R&D Space For Lease
Hypothetical Full Building Floor Plan

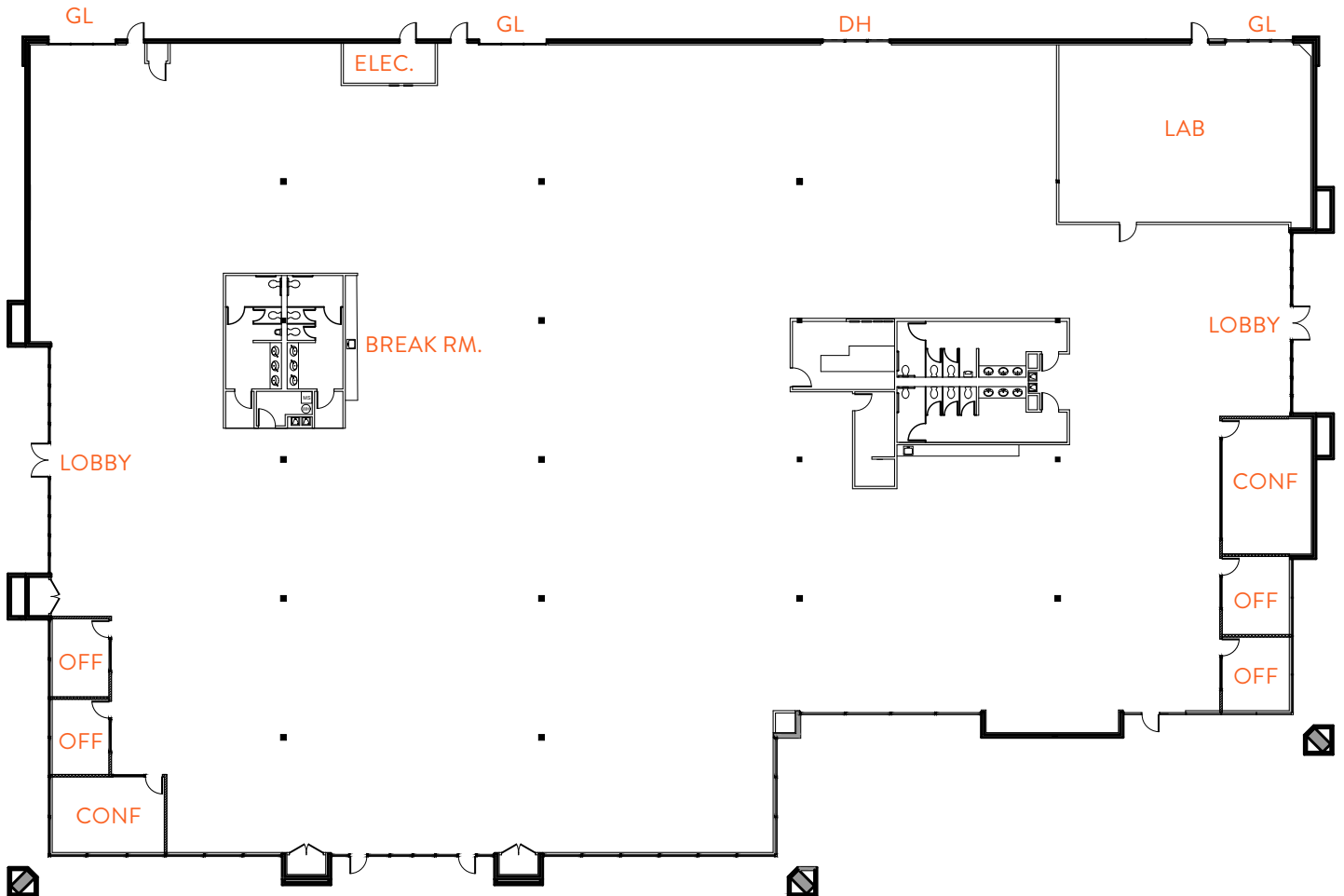

Alan Guterman
alan.guterman@cushwake.com
ph +1 408 615 3414
cell +1 408 888 0881
Lic #00884495
300 Santana Row, Fifth Floor
San Jose, CA 95128

Jon DeCoite
jon.decoite@cushwake.com
ph +1 408 615 3408
cell +1 408 843 3499
LIC #01471300
300 Santana Row, Fifth Floor
San Jose, CA 95128

Kelly Yoder
kelly.yoder@cushwake.com
ph +1 408 615 3427
cell +1 408 439 6672
LIC #01821117
300 Santana Row, Fifth Floor
San Jose, CA 95128

Steve Horton
steve.horton@cushwake.com
ph +1 408 615 3412
cell +1 408 726 1010
LIC #01127340
300 Santana Row, Fifth Floor
San Jose, CA 95128

Amy Pallas
apallas@prologis.com
ph +1 510 661 4087
cell +1 650 380 3129
LIC #00935272
3353 Gateway Boulevard
Fremont, CA 94538

[View Site Specific COVID-19 Prevention Plan](#)

No warranty or representation, expressed or implied, is made as to the accuracy of the information contained herein, and same is submitted subject to error and omissions.

www.prologis.com
CalDRE Lic #01944561

±13,667 SF & ±17,748 SF



Office/R&D Space For Lease
Can be Combined for a Total of ±31,415 SF

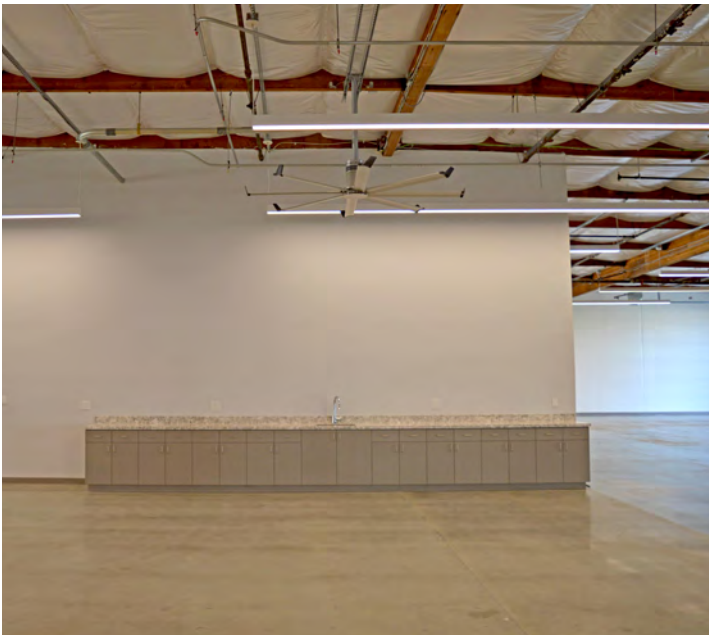

Alan Guterman
alan.guterman@cushwake.com
ph +1 408 615 3414
cell +1 408 888 0881
Lic #00884495
300 Santana Row, Fifth Floor
San Jose, CA 95128

Jon DeCoite
jon.decoite@cushwake.com
ph +1 408 615 3408
cell +1 408 843 3499
LIC #01471300
300 Santana Row, Fifth Floor
San Jose, CA 95128

Kelly Yoder
kelly.yoder@cushwake.com
ph +1 408 615 3427
cell +1 408 439 6672
LIC #01821117
300 Santana Row, Fifth Floor
San Jose, CA 95128

Steve Horton
steve.horton@cushwake.com
ph +1 408 615 3412
cell +1 408 726 1010
LIC #01127340
300 Santana Row, Fifth Floor
San Jose, CA 95128

Amy Pallas
apallas@prologis.com
ph +1 510 661 4087
cell +1 650 380 3129
LIC #00935272
3353 Gateway Boulevard
Fremont, CA 94538

[View Site Specific COVID-19 Prevention Plan](#)

No warranty or representation, expressed or implied, is made as to the accuracy of the information contained herein, and same is submitted subject to error and omissions.

www.prologis.com
CalDRE Lic #01944561

±13,667 SF & ±17,748 SF



Office/R&D Space For Lease

Can be Combined for a Total of ±31,415 SF



Alan Guterman
alan.guterman@cushwake.com
ph +1 408 615 3414
cell +1 408 888 0881
Lic #00884495
300 Santana Row, Fifth Floor
San Jose, CA 95128

Jon DeCoite
jon.decoite@cushwake.com
ph +1 408 615 3408
cell +1 408 843 3499
LIC #01471300
300 Santana Row, Fifth Floor
San Jose, CA 95128

Kelly Yoder
kelly.yoder@cushwake.com
ph +1 408 615 3427
cell +1 408 439 6672
LIC #01821117
300 Santana Row, Fifth Floor
San Jose, CA 95128

Steve Horton
steve.horton@cushwake.com
ph +1 408 615 3412
cell +1 408 726 1010
LIC #01127340
300 Santana Row, Fifth Floor
San Jose, CA 95128

Amy Pallas
apallas@prologis.com
ph +1 510 661 4087
cell +1 650 380 3129
LIC #00935272
3353 Gateway Boulevard
Fremont, CA 94538

[View Site Specific COVID-19 Prevention Plan](#)

No warranty or representation, expressed or implied, is made as to the accuracy of the information contained herein, and same is submitted subject to error and omissions.

www.prologis.com
Ca/DRE Lic #01944561