

FOR LEASE

2233 148th Ave NE
Bellevue, WA 98007

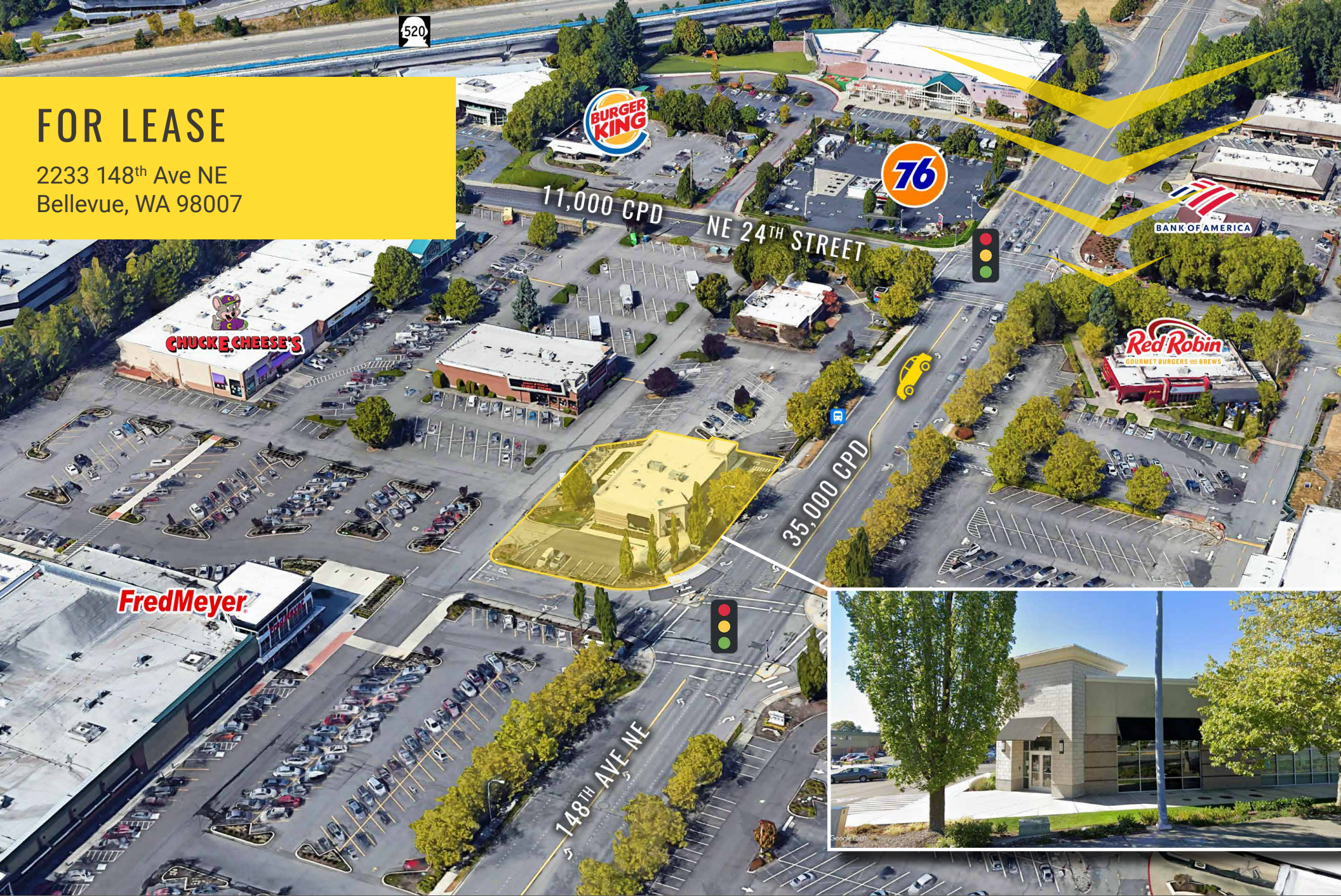

BELLEVUE FRED MEYER ANCHORED SHOP

Tim Weber | Blake Weber | Don Whittles

First Western Properties—Tacoma Inc. | 253.472.0404
6402 Tacoma Mall Blvd, Tacoma, WA 98409 | fwp-inc.com

SUMMARY

2233 148TH AVE NE is located in Bellevue's core, this opportunity is adjacent to Fred Meyer with Cross Parking and Cross Access Easement in Place.

2,288 SF RENTABLE 2,256 SF USABLE
FORMER HSBC END CAP

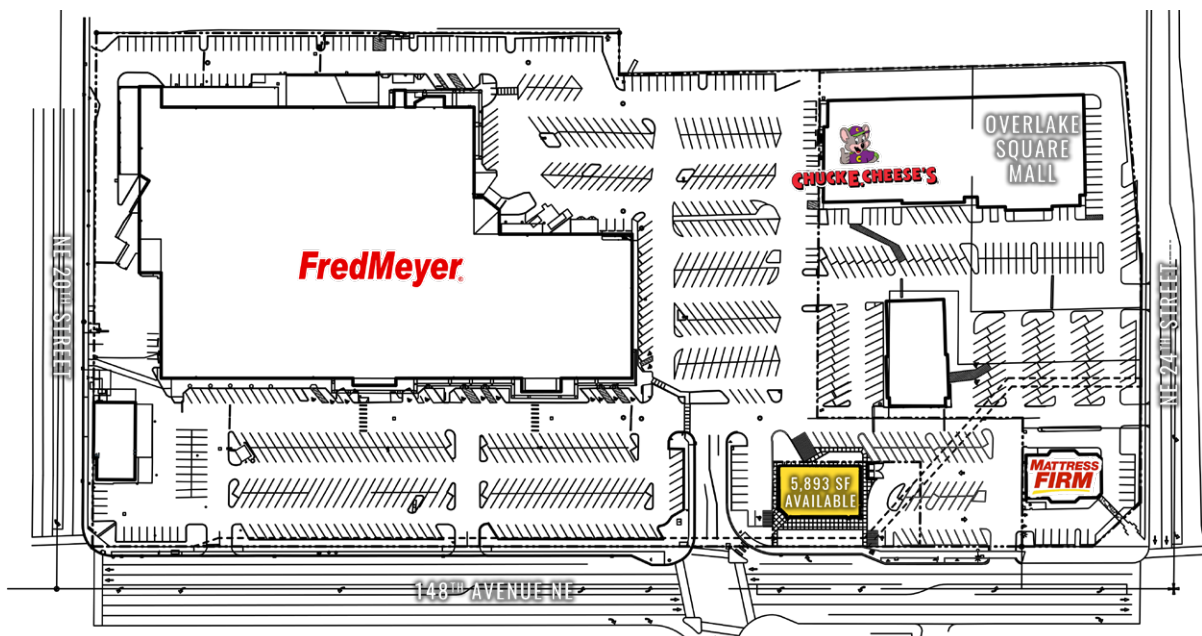

NEARBY TENANTS



Regis - 2022

Population

Average HH Income

Daytime Population

Mile 1

25,238

\$121,479

27,752

Mile 3

118,041

\$176,764

147,877

Mile 5

263,826

\$189,016

281,167

LOCATION AERIAL

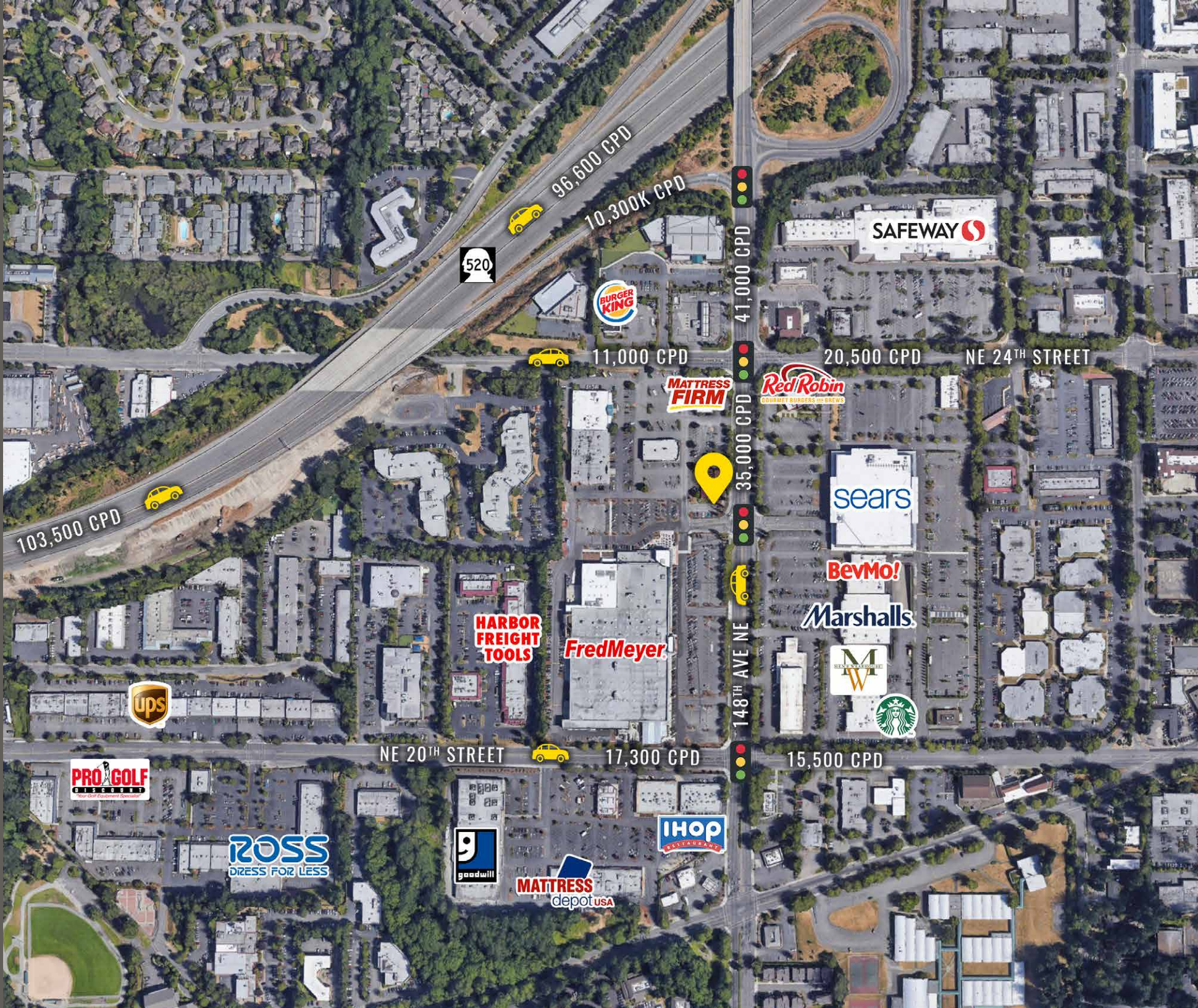

SITE PLAN

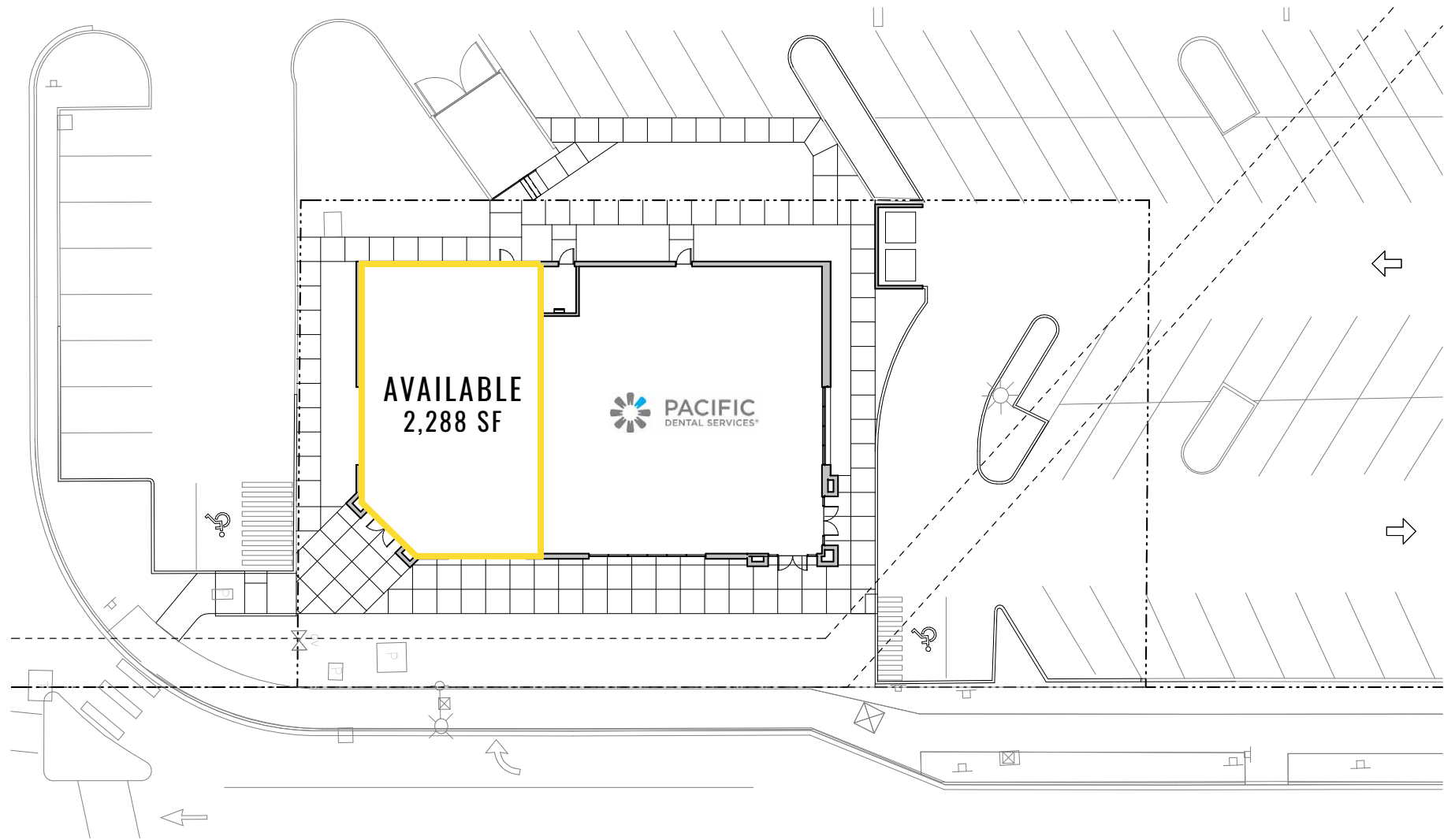

FORMER HSBC END CAP

RENDERINGS



TACOMA | KIRKLAND | PORTLAND | SEATTLE



RELATIONSHIP FOCUSED. RESULTS DRIVEN.

TIM WEBER

253.471.5502
tweber@firstwesternproperties.com

BLAKE WEBER

253.284.3646
bweber@firstwesternproperties.com

DON WHITTLES

253.471.5509
dwhittles@firstwesternproperties.com



First Western Properties—Tacoma Inc. | 253.472.0404
6402 Tacoma Mall Blvd, Tacoma, WA 98409 | fwp-inc.com

© First Western Properties, Inc. DISCLAIMER: The above information has been secured from sources believed to be reliable, however, no representations are made to its accuracy. Prospective tenants or buyers should consult their professional advisors and conduct their own independent investigation. Properties are subject to change in price and/or availability without notice.