

666

FIFTH AVE

BETWEEN 52ND AND 53RD STREETS

PRIME FLAGSHIP OPPORTUNITY

T+ TISSOT
SWISS WATCHES SINCE 1853

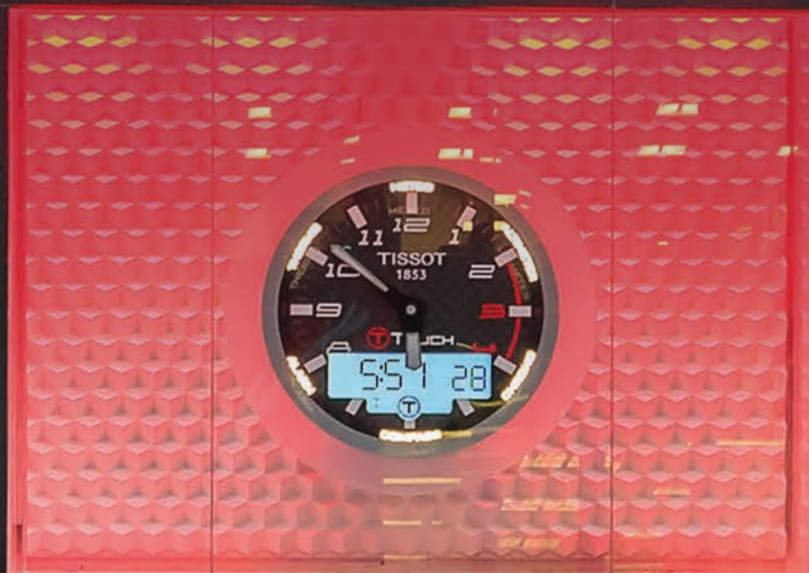

T+ TISSOT
SWISS WATCHES SINCE 1853



FULL TEN YEAR SUBLEASE OPPORTUNITY

6
66

FIFTH AVENUE



#BringTheLove

SPACE DETAILS AND STATS

GROUND FLOOR **2,030 FT**
 FRONTAGE **25 FT**
 POSSESSION **ARRANGED**
 TERM **10 YEAR SUBLEASE**
 ASKING RENT **UPON REQUEST**

COMMENTS

- Unparalleled Fifth Avenue 2-story branding opportunity
- Proximity to Rockefeller Center, St. Patrick's Cathedral, Moma, Central Park, Radio City Hall and Times Square
- Steps from the **E M** Fifth Avenue/53rd Street station
- One of the highest density of tourists and daytime office populations, with some of the most expensive retail real estate in the world
- Saks Fifth Avenue generates more than \$18,000 in revenue per square foot annually

- Apple's location on Fifth Avenue and 59th Street does nearly \$800 million per year out of 20,000 square feet of lower level space and is the highest grossing Apple store worldwide
- J. Crew's Rockefeller Center location does \$50 million in annual sales with no exposure to a major Avenue
- Rockefeller Center has over 650,000 sf of retail space with over 115 high end shops and restaurants



FOOT TRAFFIC
 11,000 Pedestrians an hour at peak times



TOURIST
 Rockefeller Center attracts 350,000 Daily visitors



OFFICE SPACE
 Surrounded by more than 153 million square feet of office space



HOTELS
 39 Hotels and over 2,200 hotel rooms within a .25 mile radius



MEDIUM INCOME
 Average household income is over \$180,000



WORKFORCE
 Over 140,000 day-time employees



TRANSPORTSTION
 7.6 million riders annually at 5th Ave/53 Street station

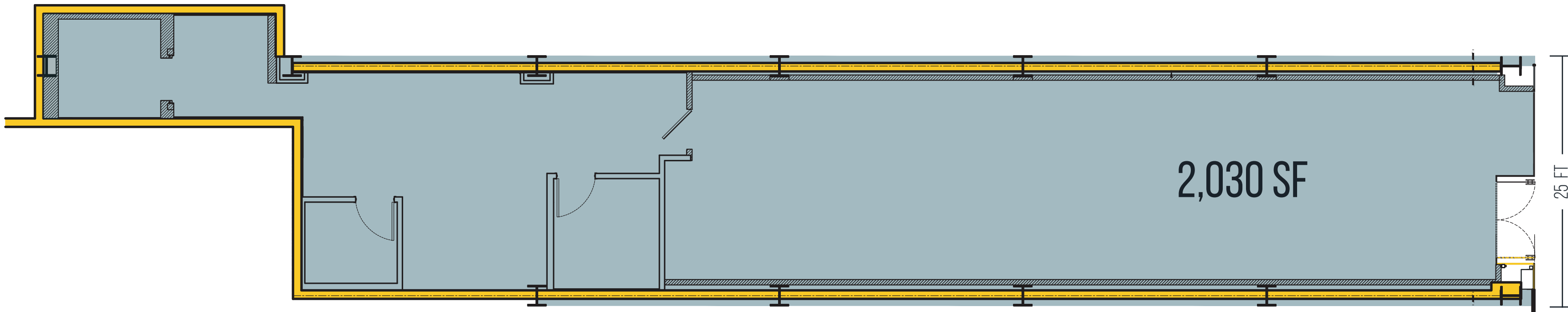

AREA MAP

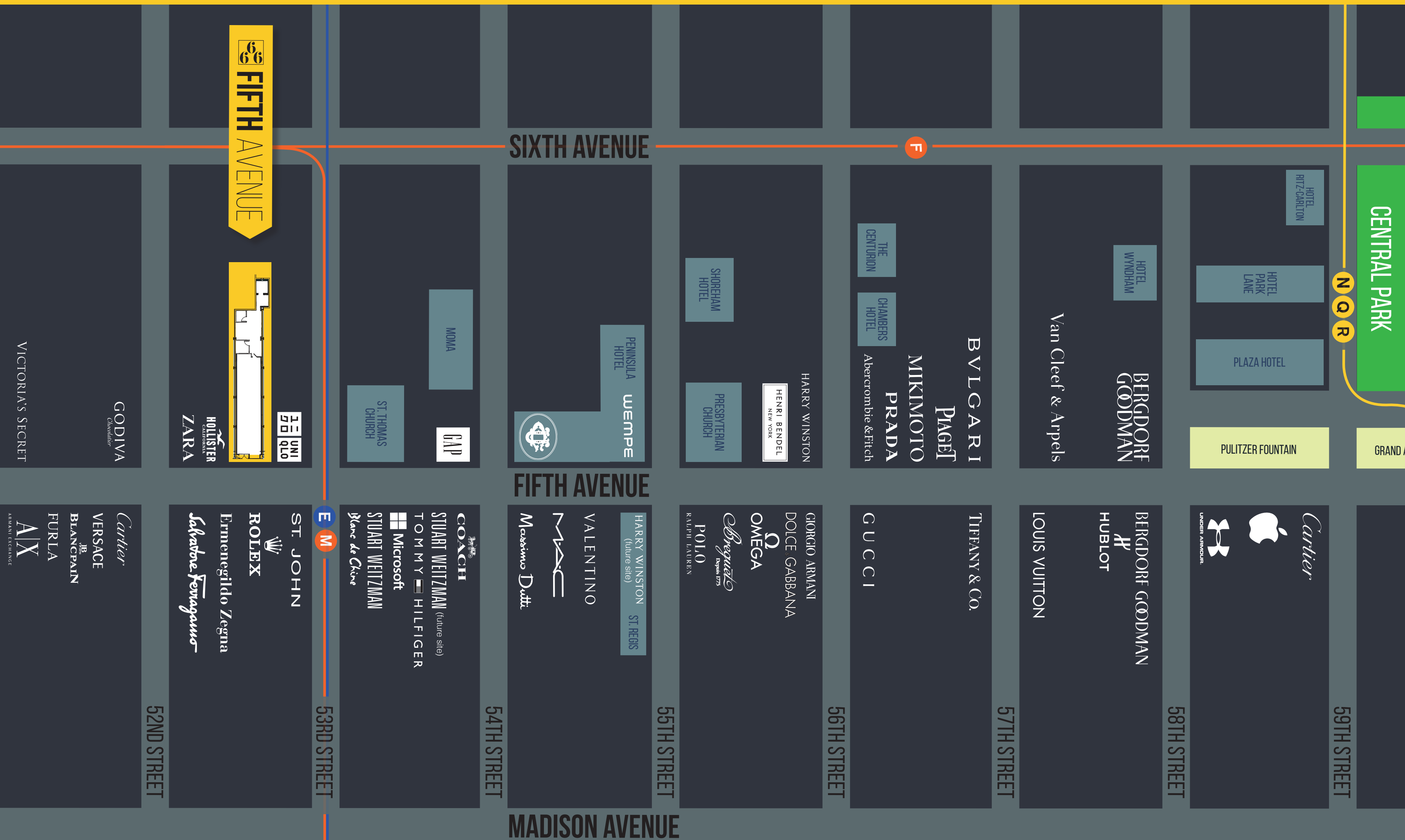

NEIGHBORING TENANTS ON FIFTH AVENUE

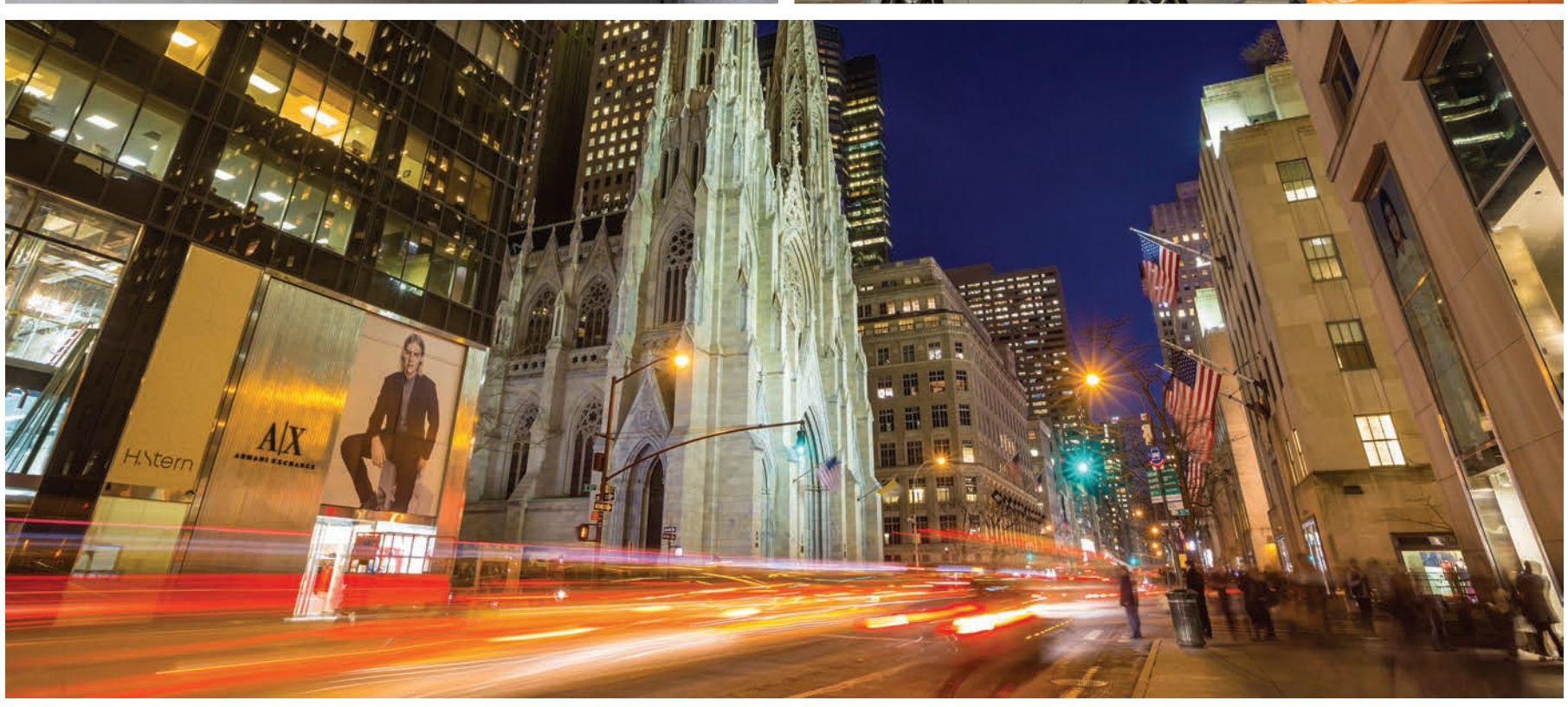



6
66
FIFTH AVE

BETWEEN 52ND AND 53RD STREETS

CONTACT EXCLUSIVE SUBLEASE AGENTS

JASON P. PRUGER
212.372.2092
JPRUGER@NGKF.COM

THOMAS M. CITRON
212.372.2461
TCITRON@NGKF.COM

AARON CUKIER
212.850.5436
ACUKIER@NGKF.COM

GABRIELLA SEMET
212.372.0723
GSEMET@NGKF.COM

**Newmark Grubb
Knight Frank**
Retail

www.ngkf.com/retail

