



# 9501 S O U T H W E S T E R N

±1,704 SF &  
±1,806 SF  
AVAILABLE

SOUTHEAST CORNER OF  
95TH STREET & WESTERN AVENUE  
CHICAGO, IL

RETAIL SPACE  
AVAILABLE

RETAIL SPACE AVAILABLE  
**9501 SOUTH WESTERN**  
 Southeast Corner of 95th St & Western Ave | Chicago, IL

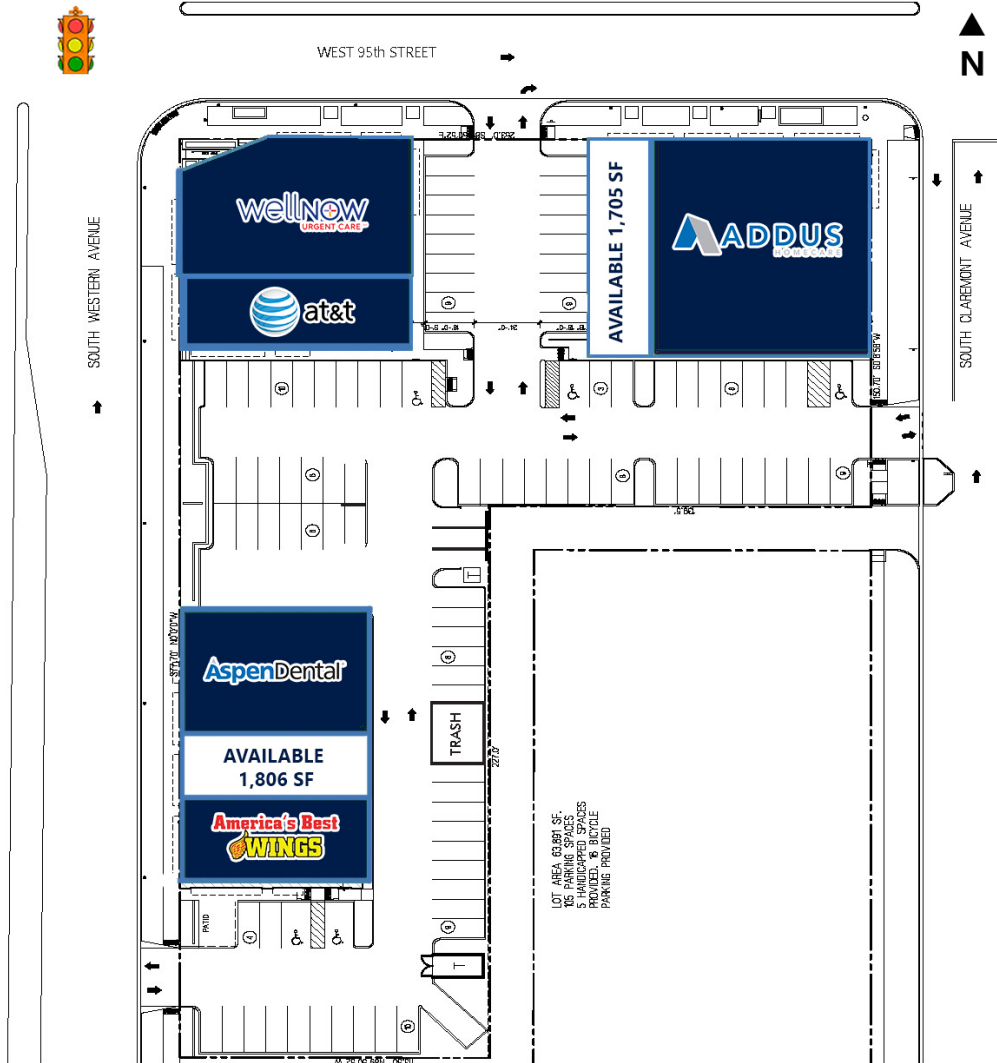

**SPACE AVAILABLE**

±1,704 SF & ±1,806 SF

**SITE SUMMARY**

- Redevelopment of the center; reducing GLA to ±21,416 SF, increasing parking, and opening up site lines for better visibility
- Great visibility at the southeast corner of 95th Street and Western Avenue with a signalized intersection
- Ample parking: ± 105 spaces
- High traffic counts: 31,300 VPD on Western Avenue and 31,000 VPD on 95th Street
- Zoning: B1-2

**POPULATION DENSITY**

17,700	1 Mile
228,838	3 Mile
637,293	5 Mile

**DAYTIME EMPLOYMENT**

17,722	1 Mile
186,627	3 Mile
536,017	5 Mile

**AVERAGE HH INCOME**

\$110,883	1 Mile
\$72,954	3 Mile
\$61,765	5 Mile

**CONTACT**

Matt Cavanagh  
 matt@arcgrp.com  
 (630) 908-5694

© 2019 A•R•C Real Estate. All information is from sources believed reliable, not independently verified, and thus subject to errors, omissions, and modifications such as price, listing, square footage, rates and commissions. All information, estimates and projections subject to change, market assumptions, unknown facts and conditions, and future potentialities. A•R•C Real Estate makes no express or implied representations or warranties, as facts and results may vary materially from all information, estimates and projections. All renderings presented are conceptual.

