



±30,000 SF

751 N. ROHLWING ROAD | ITASCA, ILLINOIS 60143

BUILDING SPECS

BUILDING SIZE	±109,000 SF
AVAILABLE SIZE	±30,000 SF Warehouse (No Office)
CONSTRUCTION	Masonry
PARKING	±60 Cars
CEILING HEIGHT	25' Clear
POWER	200 Amps / 240 Volts
HEATING	Gas Forced Air
LOADING	2 Interior Docks 1 Drive-in Door
POSSESSION	April 2019
LEASE RATE	\$6.25 PSF Modified Gross

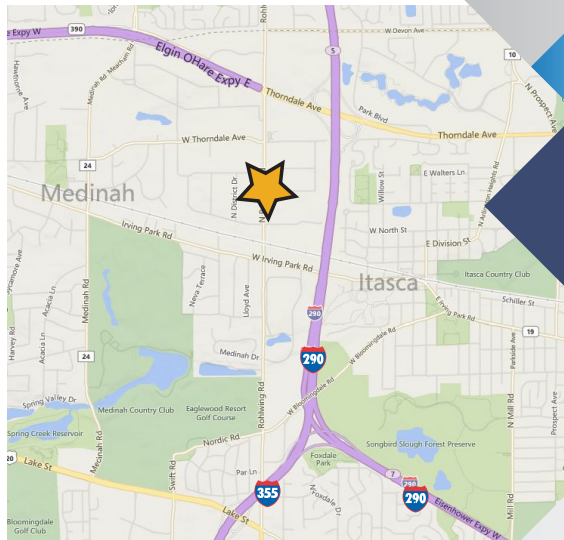

ED BRANDT, SIOR
630-776-7241
edward.brandt@transwestern.com

DAVE PERNICE
847.588.5666
david.pernice@transwestern.com

LAYOUT

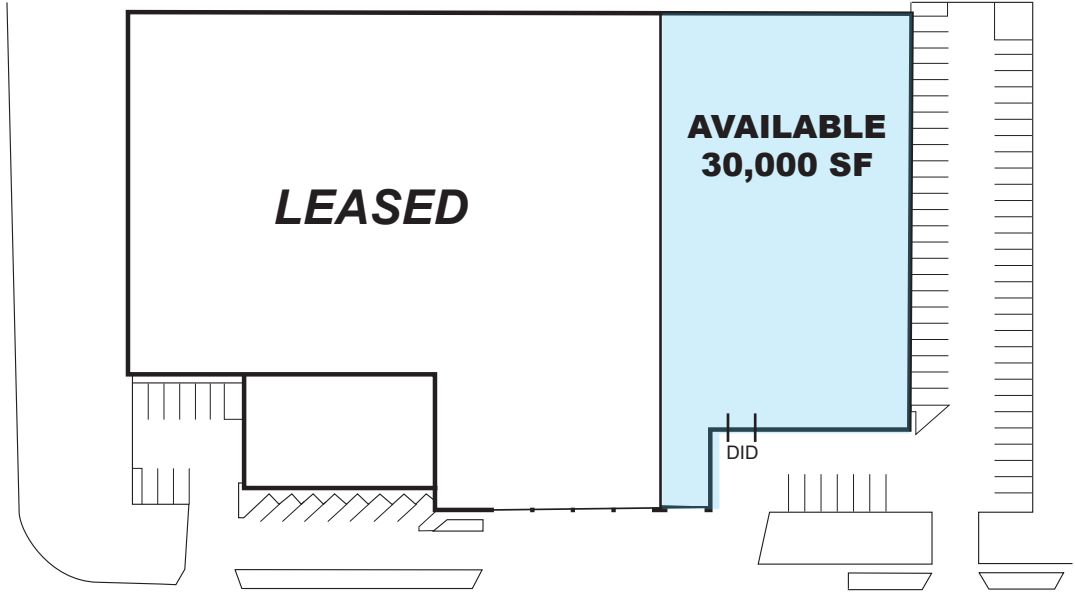

AERIAL



ED BRANDT, SIOR
630-776-7241
edward.brandt@transwestern.com

DAVE PERNICE
847.588.5666
david.pernice@transwestern.com

T TRANSWESTERN®
9550 W. Higgins Road, Suite 250, Rosemont, Illinois 60018
P: 847-588-5700 • F: 847-588-0034 • transwestern.com