



THE VICTOR  

---

*by* WINDSOR

110 BEVERLY STREET, BOSTON, MASSACHUSETTS  
NORTH STATION



## THE AVAILABILITY

1,252 SF

1,976 SF

3,977 SF (second generation)



## THE FACTS

Located in the heart of Bulfinch Triangle/North Station neighborhood

The North Station entrance is directly next to the building. Haymarket is less than a 5 minute walk

Across from The Hub on Causeway, the 1.5M sf mixed-use redevelopment surrounding TD Garden

At the base of a luxury, 286 unit residential building and surrounded by high-end residential & mixed-use projects

North Station sees over 15 million travelers per year, the MBTA lines have an average of 17,800 daily riders



## THE NEIGHBORHOOD

TD Garden | Big Night Live | Boston Public Market | Central Rock Climbing Gym | Night Shift Brewing | Tavern in the Square | A&B Burgers | Title Boxing | Arc Light Cinemas | Ward 8

SITE  
D  
M  
A  
S

# SITE

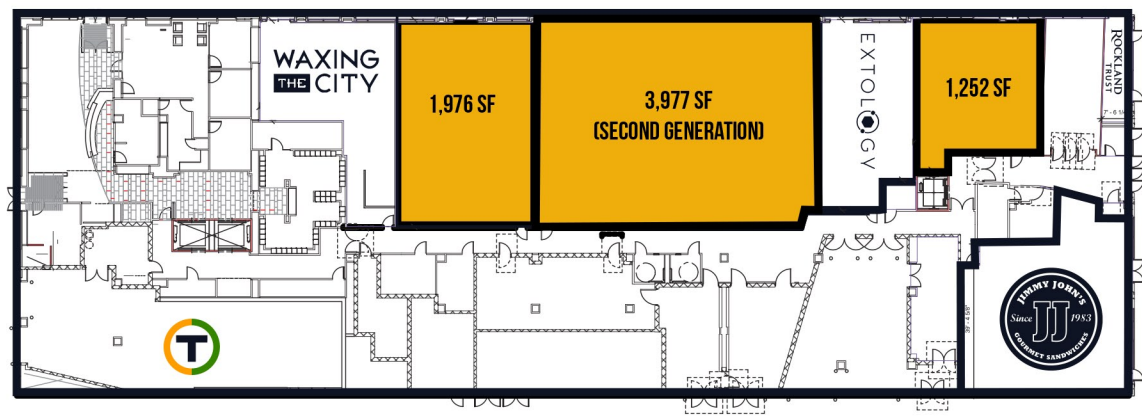
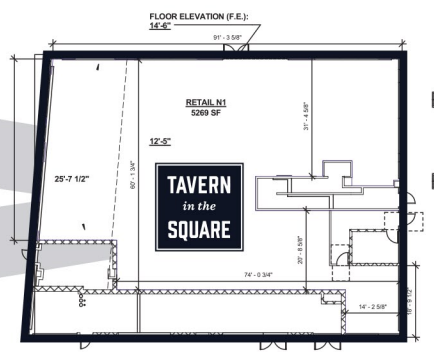

AVAILABLE

## DEMOGRAPHICS

	.25 MILE	.5 MILE	1 MILE
Daytime Population	12,540	106,488	237,938
Population	4,642	21,145	57,591
Med HH Income	\$95,675	\$127,507	\$136,927

# BIRD'S-EYE VIEW

  
**CONVERSE**  
HEADQUARTERS  
750 EMPLOYEES

  
**NIGHT SHIFT  
BREWING**

**THE BEVERLY**  
239 RESIDENTIAL UNITS

1,252 SF | 1,976 SF | 3,977 SF  
AVAILABLE

**HUB ON  
CAUSEWAY**  
UNDER CONSTRUCTION

**TD GARDEN**  
NORTH STATION

 **AMTRAK**



# BULFINCH TRIANGLE, BOSTON



CHARLES RIVER

CHARLESTOWN

CHARLESTOWN NAVY YARD

BOSTON HARBOR



**Boston Properties**  
**THE HUB ON CAUSEWAY**  
 440 UNITS  
 875,000 SF OFFICE  
 270 KEY HOTEL  
 350,000 SF RETAIL  
 UNDER CONSTRUCTION

**star market**

**ARLIGHT**

**BNEG**  
 BIG CITY ENTERTAINMENT GROUP

**LIVE NATION**

**TD GARDEN**  
 3.5M VISITORS ANNUALLY  
 230 GAMES & EVENTS ANNUALLY  
 NORTH STATION  
 15M TRAVELERS ANNUALLY

**LEGAL OYSTERIA**

**sorelle**  
 BAKERY & CAFE

**GARDEN GARAGE**  
 UNDER CONSTRUCTION  
 470 RESIDENTIAL UNITS

**AVALON NORTH STATION**  
 503 UNITS

**Fasty Burger**

**LOVEJOY WHARF**  
 157 UNITS

**CONVERSE**  
 750 EMPLOYEES

**ALCOVE**

**HERD BUILT ENERGY**

**MASSACHUSETTS GENERAL HOSPITAL**  
 14,000 DOCTORS & FACULTY

**au bon pain**  
 cafe bakery

**WYNDHAM**  
 HOTELS AND RESORTS  
 304 ROOMS

**WHOLE FOODS**

**Holiday Inn Express**  
 72 ROOMS

**CONYX**  
 112 ROOMS

**NORTH STATION**  
 17,079 RIDERS

**TITLE**

**EQUAL EXCHANGE**  
 COMMERCIAL REAL ESTATE

**THE VICTOR**  
 286 UNITS

**TAVERN SQUARE**  
 Message Entry  
**WAXING THE CITY**

**SOULCYCLE**

**50 STANIFORD ST**  
 BOARD APPROVED  
 19,500 SF RETAIL SPACE

**CUPPA COFFEE**  
 COFFEE BAR

**TD Bank**

**BOXER**  
 79 ROOMS

**au bon pain**  
 cafe bakery

**88 NORTH WASHINGTON**  
 68 KEY BOUTIQUE HOTEL  
 BOARD APPROVED

**WARD S.**

**THE BEVERLY**  
 101 BEVERLY STREET  
 239 RESIDENTIAL UNITS  
**COURTYARD**  
 by Marriott  
 220 ROOMS

**MASSACHUSETTS STATE HOUSE**

**BULFINCH CROSSING**  
 800+ RES. UNITS  
 1.15M SF OFFICE SPACE  
 82,500 SF RETAIL  
 200 KEY HOTEL  
 UNDER CONSTRUCTION

**ONE CANAL**  
 310 UNITS  
 21,000SF RETAIL

**CITY WINERY**

**BOWDOIN**  
 4,776 RIDERS

**GOVERNMENT CENTER**  
 10,828 RIDERS

**HAYMARKET**  
 11,469 RIDERS

**swissbäkers**

**MOTHER JUICE**

**BON ME**

*George Howell*

**BOSTON PUBLIC MARKET**

**UNION SQUARE DONUTS**



THE VICTOR  
*by* WINDSOR

Lindsey Sandell  
617.369.5936  
lsandell@dartco.com

Rachel Feeley  
617.369.5908  
rfeeley@dartco.com