



## PREMIERE 2<sup>ND</sup> FLOOR OFFICE SPACE FOR LEASE

### LOCATED IN SUNSET PARK NEAR INDUSTRY CITY

#### FEATURES:

- Office Size: 2,400 Sq. Ft.
- Newly Renovated on 2<sup>nd</sup> Floor
- HVAC
- Ceiling Height: 11'
- Fully Sprinklered
- Private Entrance

#### NEARBY:

- Industry City
- Brooklyn-Queens Expressway
- Gowanus Expressway
- Belt Parkway

#### Transportation:

**D N R W** 36<sup>th</sup> St

 **B35, B70 (39<sup>th</sup> St / 1<sup>st</sup> Ave)**

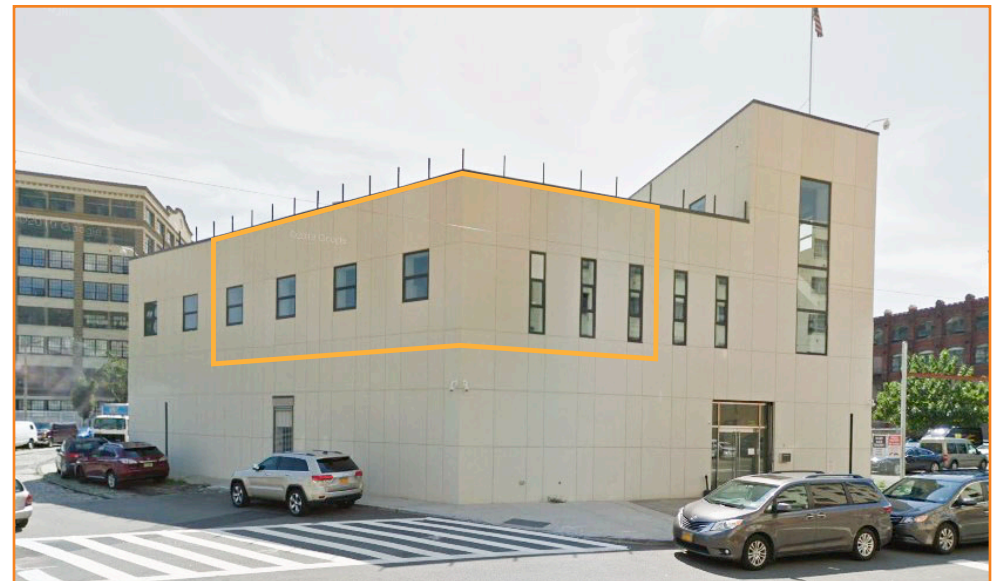

**LEASE PRICE:**

**UPON REQUEST**

**4101 1<sup>ST</sup> AVENUE, BROOKLYN, NY**

**BLOCK: 716**

**LOT: 1**

**ZONING: M3-1**

For Information About This Property  
Contact Exclusive Agents:

**Levi Junik**, Salesperson  
ljunik@pinnaclereny.com  
718-371-6401

**Eli Seewald**, Salesperson  
eseewald@pinnaclereny.com  
718-371-6405

**Abraham Lowy**, Associate Broker  
alow@pinnaclereny.com  
718-784-8488



# PINNACLE REALTY

OF NEW YORK, LLC

[www.pinnaclereny.com](http://www.pinnaclereny.com)

46-34 11th Street • Long Island City, NY 11101

718-784-8282

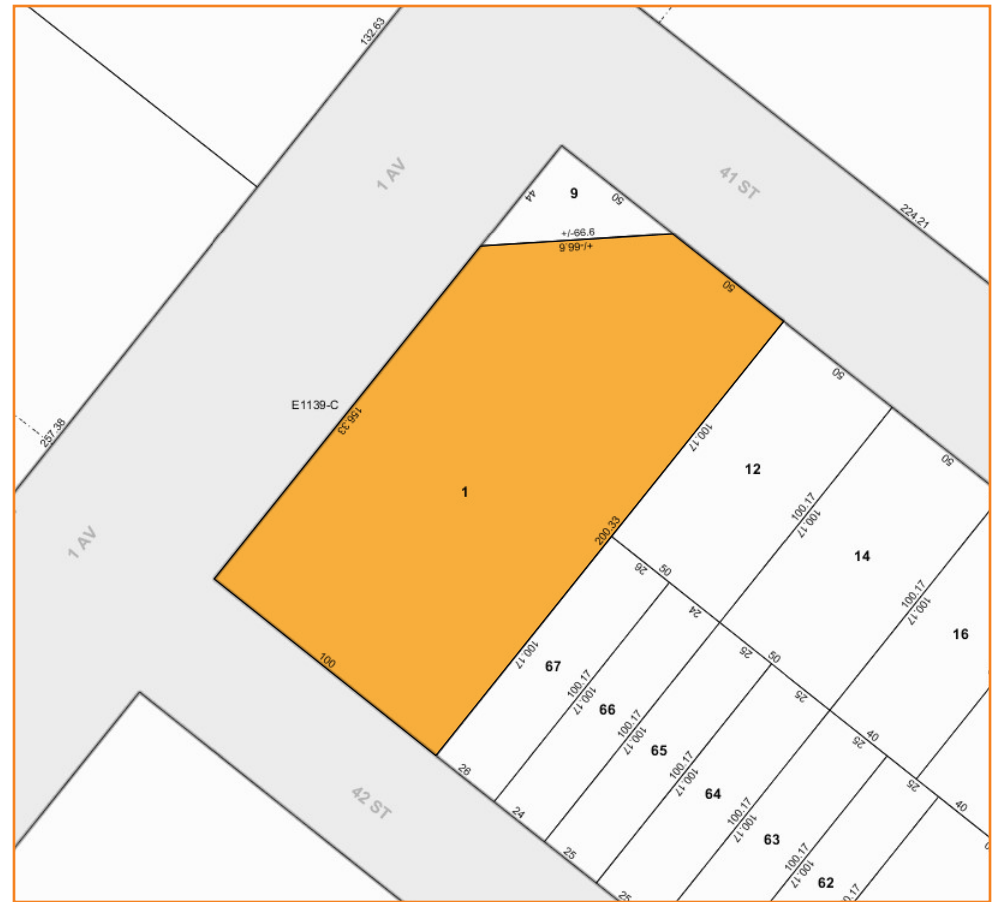
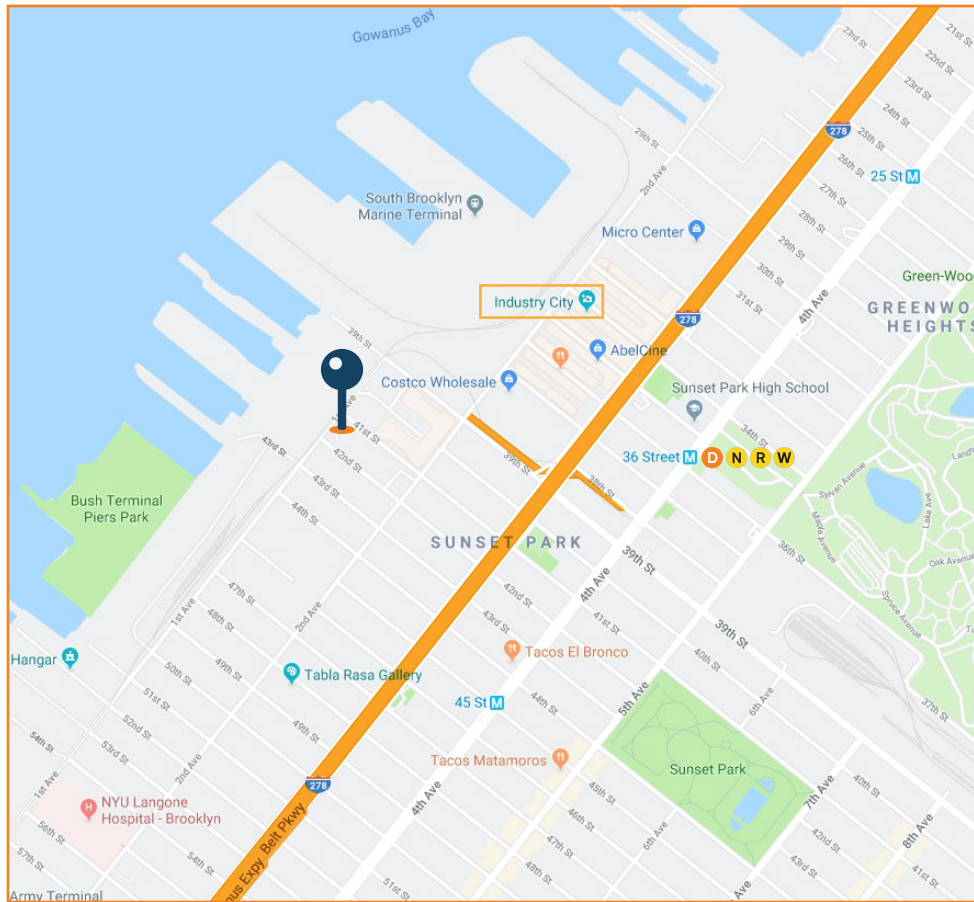



# PINNACLE REALTY

OF NEW YORK, LLC

[www.pinnacleireny.com](http://www.pinnacleireny.com)

46-34 11th Street • Long Island City, NY 11101

718-784-8282

