

NEWMARK

AVAILABLE FOR LEASE

888-898 VETERANS MEMORIAL HIGHWAY



ASKING RENT:

\$29.50 PRSF + electric

AVAILABLE SPACE – VIRTUAL TOURS:

Suite 100 -1st Floor: **4,131 RSF***

Suite 200 - 2nd Floor: **4,320 RSF ***

Suite 230 - 2nd Floor: **7,229 – 9,680 RSF***

Suite 420/430 4th Floor: **17,070 RSF (divisible)**

Suite 510 - 5th Floor: **2,253 RSF**

Suite 515 – 5th Floor: **6,295 RSF**

* (direct lobby level access)

898 Veterans Memorial Highway

Fully Leased

BUILDING AMENITIES:

- Located off the Northern State Parkway & Long Island Expressway
- On-site Management & Security
- Food Service with Indoor & Outdoor Seating
- Fully Equipped Fitness Center with Racquetball Courts
- Auditorium Style Conference Center with Executive Boardroom
- Full-Service Bank Branch On-site
- Huge parking lots surrounding the complex
- Campus-like environment with outdoor space for collaboration

FOR MORE INFORMATION, PLEASE CONTACT EXCLUSIVE BROKERS:

Daniel Oliver

Managing Director

t 631-673-0807

dan.oliver@nmrk.com

Scott Berfas

Managing Director

t 631-673-0808

scott.berfas@nmrk.com

Jordan Oliver

Director

t 631-673-0819

jordan.oliver@nmrk.com

NEWMARK

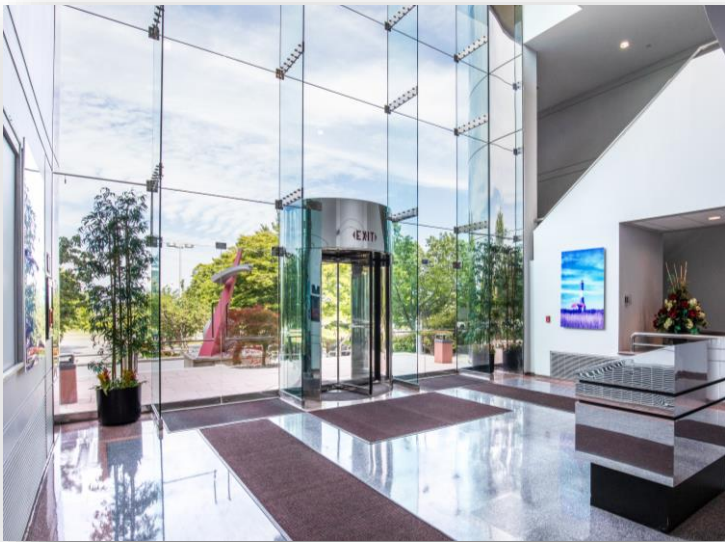

FOR MORE INFORMATION, PLEASE CONTACT EXCLUSIVE BROKERS:

Daniel Oliver
Managing Director
t 631-673-0807
dan.oliver@nmrk.com

Scott Berfas
Managing Director
t 631-673-0808
scott.berfas@nmrk.com

Jordan Oliver
Director
t 631-673-0819
jordan.oliver@nmrk.com