

# HOFF WOODS BUSINESS CENTER

214 HOFF ROAD, UNITS ABC | WESTERVILLE | OH 43081

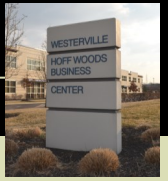

## OFFICE/WAREHOUSE FOR SALE OR LEASE

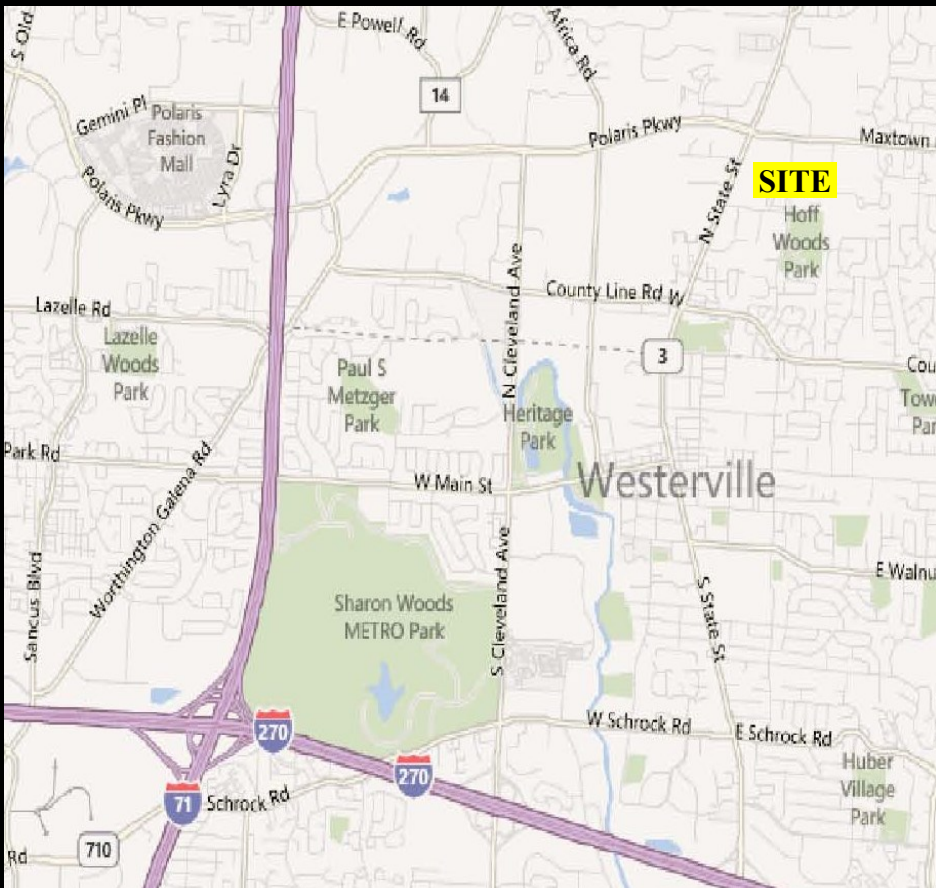

- Office, warehouse & flex options available
- 4,400 SF Available
- Close proximity to retail, banking, restaurants, hotels
- Easy access to I-71, I-270 & SR 23
- 3.45 Parking Spaces / 1000 SF
- Ceiling height 10' in finished office, 16'-20' in warehouse
- Utilities metered separately
- High-end Finishes

Don Brokaw | 614 774 7316 | [dbrokaw@crawfordhoying.com](mailto:dbrokaw@crawfordhoying.com)  
Jamie Moore | 614 565 9024 | [jmoore@crawfordhoying.com](mailto:jmoore@crawfordhoying.com)  
Crawford Hoying Real Estate  
555 Metro Place North, Suite 600 | Dublin OH 43017  
[www.crawfordhoying.com](http://www.crawfordhoying.com)



The information provided herein has been secured from various sources and is subject to change without notice. Although we believe it to be reliable, we make no representations or warranties, express or implied, as to the accuracy of the information. References to square footage or age are approximate. Buyer is responsible for verifying the information and bears all risk for any inaccuracies. Revised 11/7/2013.

# HOFF WOODS BUSINESS CENTER

214 HOFF ROAD, UNITS ABC | WESTERVILLE | OH 43081



## OFFICE/WAREHOUSE FOR SALE OR LEASE

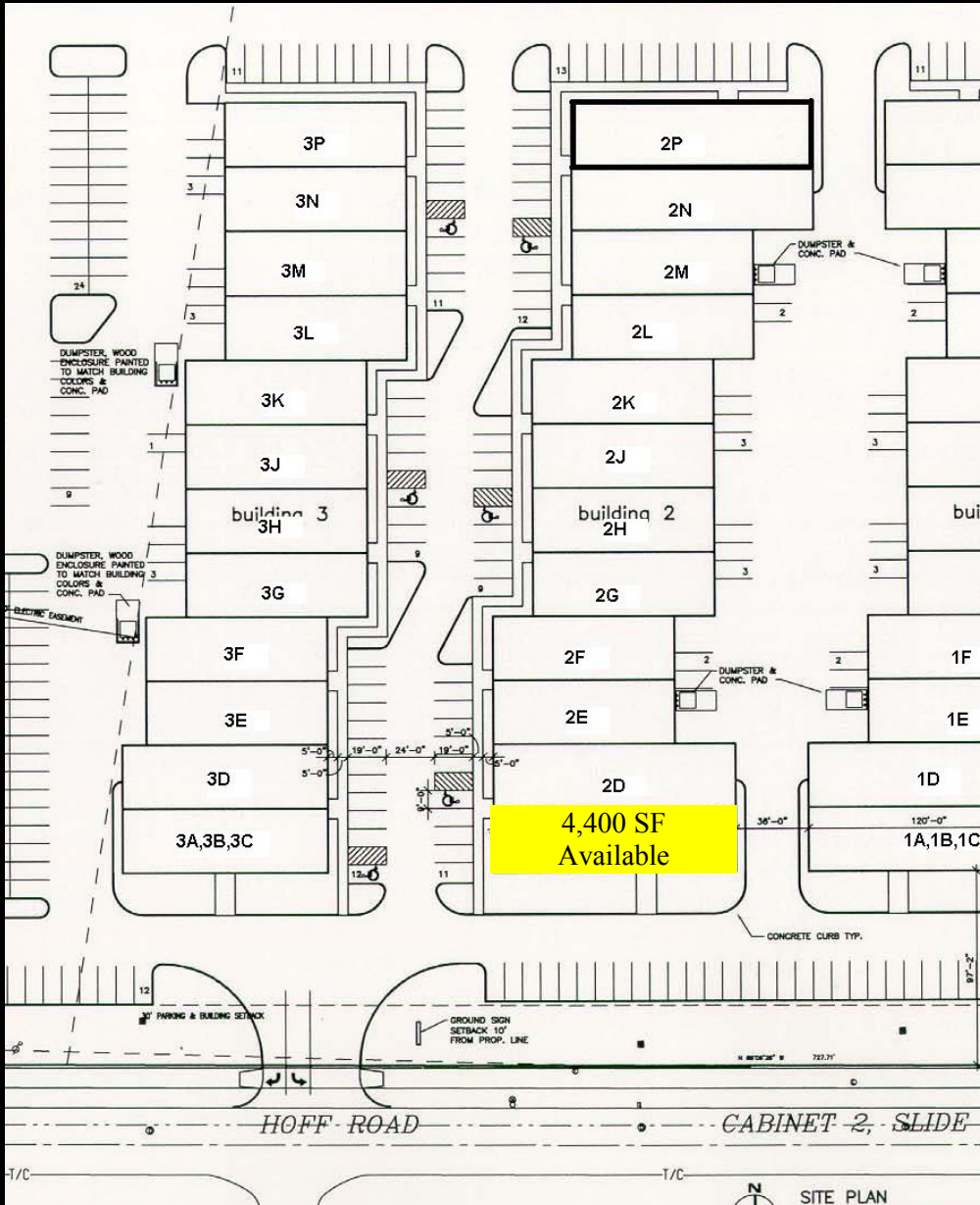

**4,400 SF AVAILABLE**

Don Brokaw | 614 774 7316 | [dbrokaw@crawfordhoying.com](mailto:dbrokaw@crawfordhoying.com)  
Jamie Moore | 614 565 9024 | [jmoore@crawfordhoying.com](mailto:jmoore@crawfordhoying.com)  
Crawford Hoying Real Estate  
555 Metro Place North, Suite 600 | Dublin OH 43017  
[www.crawfordhoying.com](http://www.crawfordhoying.com)



**CRAWFORD HOYING**  
real estate

The information provided herein has been secured from various sources and is subject to change without notice. Although we believe it to be reliable, we make no representations or warranties, express or implied, as to the accuracy of the information. References to square footage or age are approximate. Buyer is responsible for verifying the information and bears all risk for any inaccuracies. Revised 11/7/2013.