

FOR LEASE | ± 3,750 SF AUTOMOTIVE SPACE

2235 Cemo Cir, Gold River, CA 95670



Greg Redman

Dir: 916.677.8172

gredman@tricommercial.com

CalDRE #00984344

TRI Commercial Real Estate Services 532 Gibson Drive, Suite 200, Roseville, CA 95678



FOR LEASE AUTOMOTIVE SPACE

PROPERTY SUMMARY

2235 Cemo Cir
Gold River, CA 95670

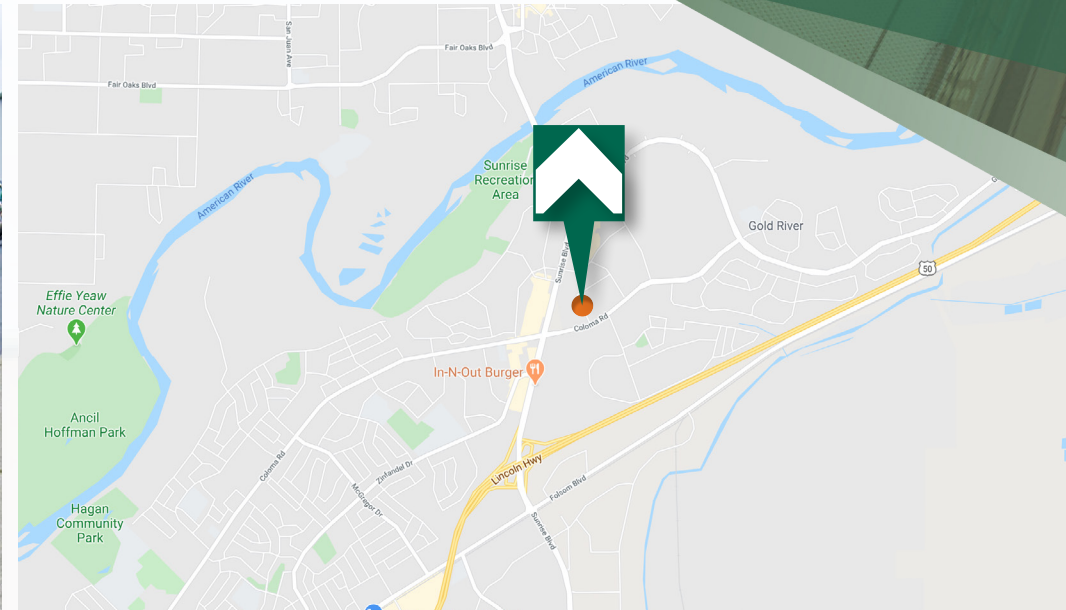

PROPERTY DETAILS

- **SUITE A** - Available
 - ±3,750 SF Total
 - ±1,325 SF Office/Showroom
 - ±1,400 SF Mezzanine
 - One (1) Grade Level Door - 12'x12'
- Great Freeway Access

LEASE SUMMARY

AVAILABLE: Unit A - ±3,750 SF

LEASE RATE: \$0.75/SF

LEASE TYPE: NNN

CLEAR HEIGHT: 16'-18'

ZONING: M-2 Heavy Industrial

ROOF: METAL

FOR LEASE AUTOMOTIVE SPACE

AERIAL / FLOOR PLAN

2235 Cemo Cir
Gold River, CA 95670

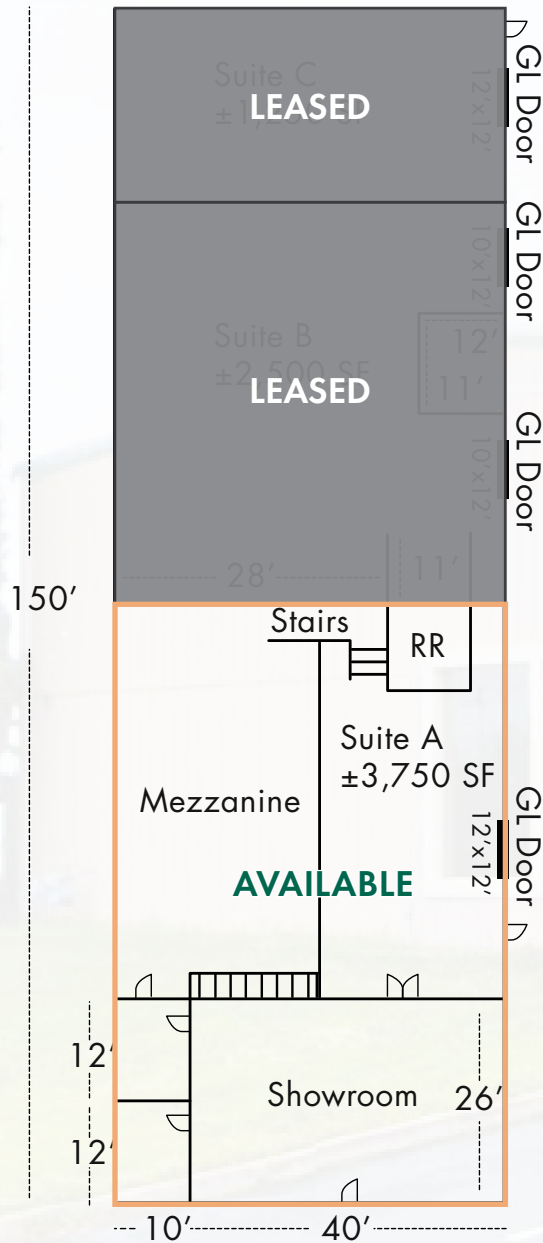

FOR LEASE AUTOMOTIVE SPACE

LOCATION AERIAL

2235 Cemo Cir
Gold River, CA 95670

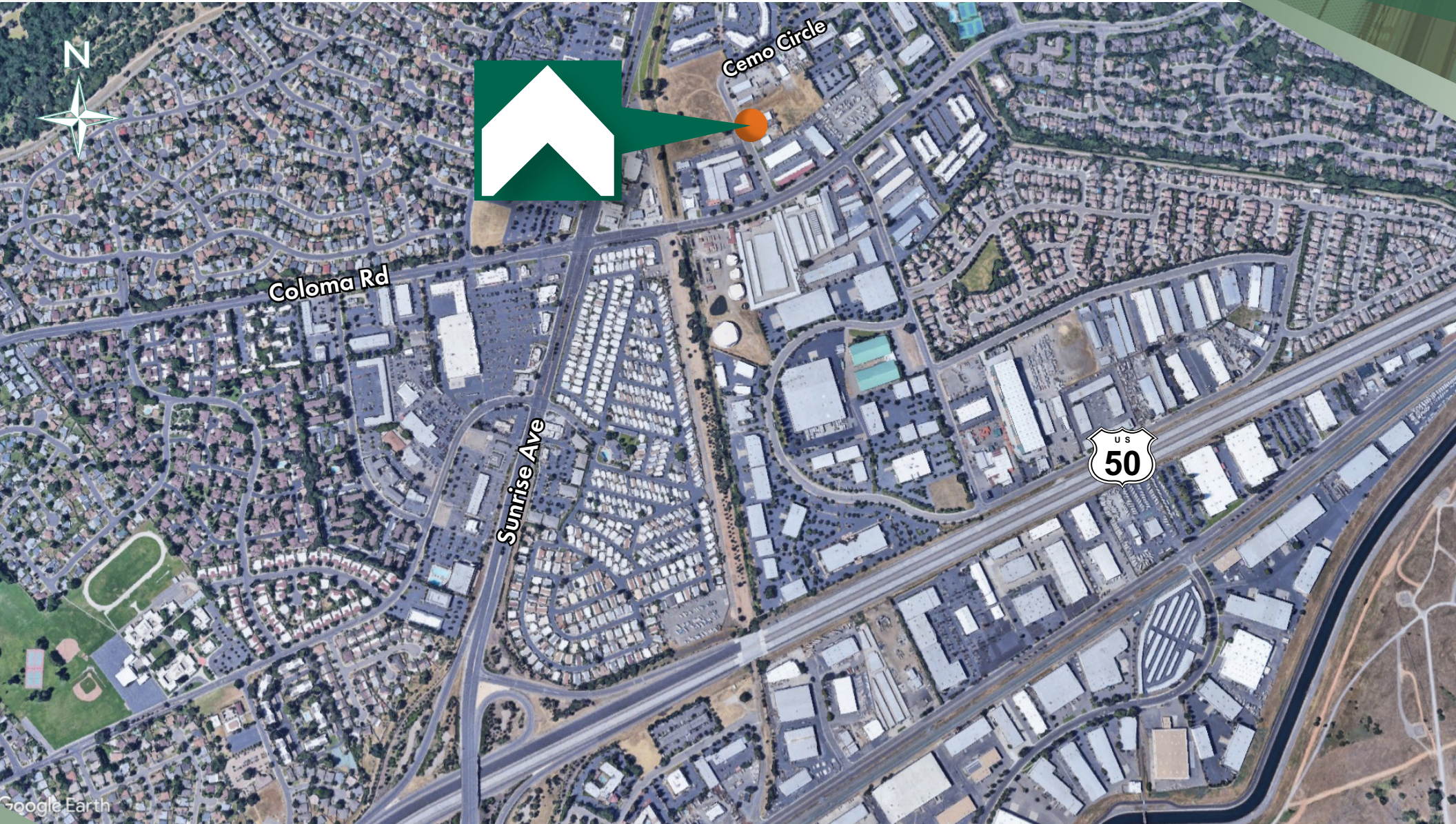

The information in this document was obtained from sources we deem reliable; however, no warranty or representation, expressed or implied, is made as to the accuracy of the information contained herein.