



4301 Hoyt Building

4301 Hoyt Ave, Everett, WA

BUILDING FEATURES

- » Buildout includes reception area, 11 exam rooms, 6 offices, lab area, lunch room
- » 24 parking stalls with additional free street parking
- » Vaulted ceiling reception and waiting area
- » Prominent monument signage available
- » Great freeway access
- » Building available for lease or purchase

AVAILABILITY

- » 5,487 RSF medical office
- » Available with 90-120 days notice

TERMS

- » \$22.00/SF/YR, NNN
- » \$9.82/SF/YR (NNNs)
(excludes utilities & janitorial)
- » TI Allowance available

FOR LEASE

CONTACT INFORMATION:



BRENT JACKSON

+1 425 974 4015

brent.jackson@am.jll.com



4301 Hoyt Building

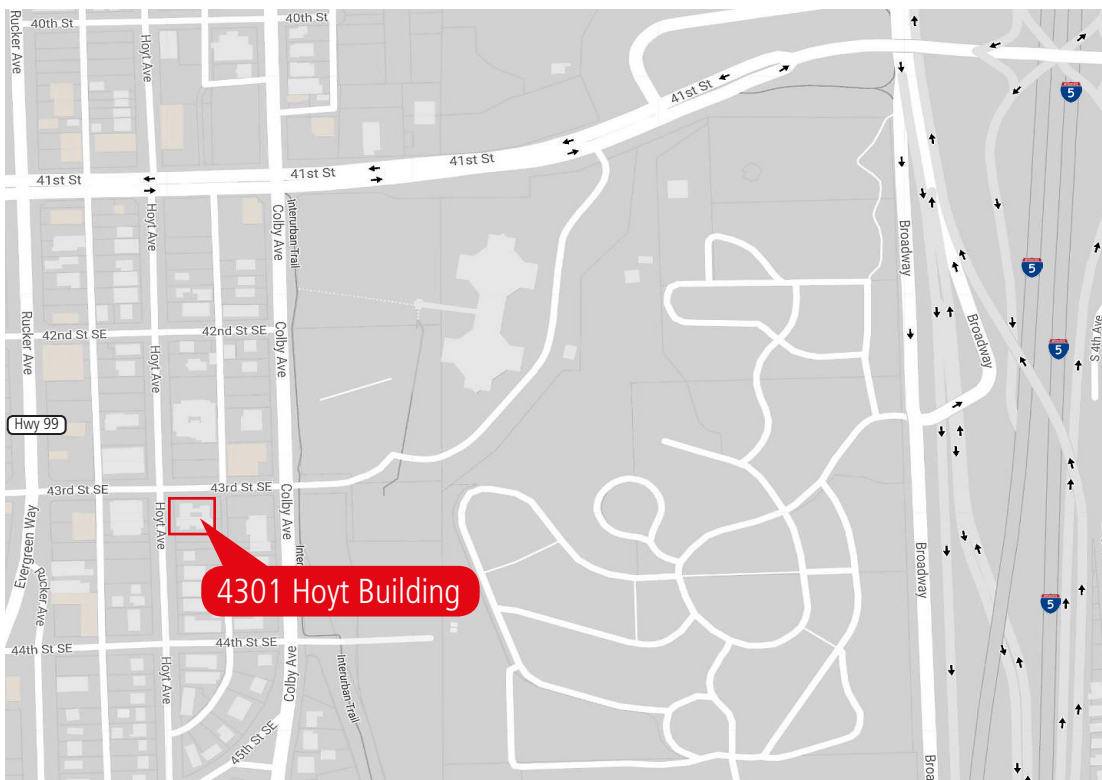
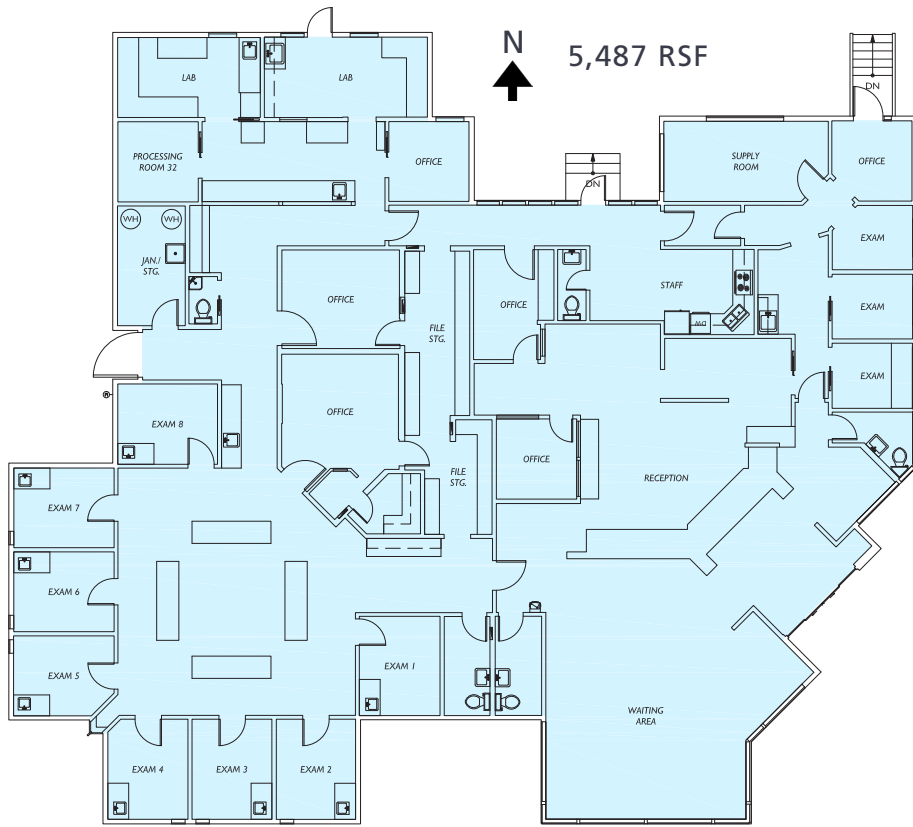

CONTACT INFORMATION



BRENT JACKSON
+1 425 974 4015
brent.jackson@am.jll.com

Jones Lang LaSalle Brokerage, Inc.
©2018 Jones Lang LaSalle IP, Inc. All rights reserved. All information contained herein is from sources deemed reliable; however, no representation or warranty is made to the accuracy thereof.