

FOR LEASE

30,142 SF Warehouse and
Office Space

3011 W. 47th Street
CHICAGO, IL 60632



Property Warehouse Interior

PROPERTY SPECIFICATIONS

Total Available Space ± 30,142 Sq. Ft.

First Floor Space ± 5,143 Sq. Ft.

Second Floor Space ± 25,000 Sq. Ft.

Ceiling Height 9'-11' Clear

Loading 1 Interior Dock, 1 Freight Elevator

Lease Rate \$2.58 PSF Modified Gross

Highlights

- Second floor loading by freight elevator
- Excellent value
- Good natural light
- Available for immediate occupancy

For more information,
please contact:

GAVIN STAINTHORPE

Vice President

312 533-2145

Gavin@NelsonHill.com

MICHAEL J. CONWAY

Associate

312 586-2770

MConway@NelsonHill.com

NelsonHill

1111 S. Western Avenue
Chicago, IL 60612

All information contained herein is
from sources deemed reliable and is
submitted subject to errors, omissions
and to change of price or terms
without notice.



FOR LEASE

30,142 SF Warehouse and
Office Space

3011 W. 47th Street
CHICAGO, IL 60632



2nd Floor Office Space



1st Floor



Available Space Exterior



2nd Floor Warehouse Interior



FOR LEASE

30,142 SF Warehouse and Office Space

3011 W. 47th Street
CHICAGO, IL 60632

FIRST FLOOR PLAN

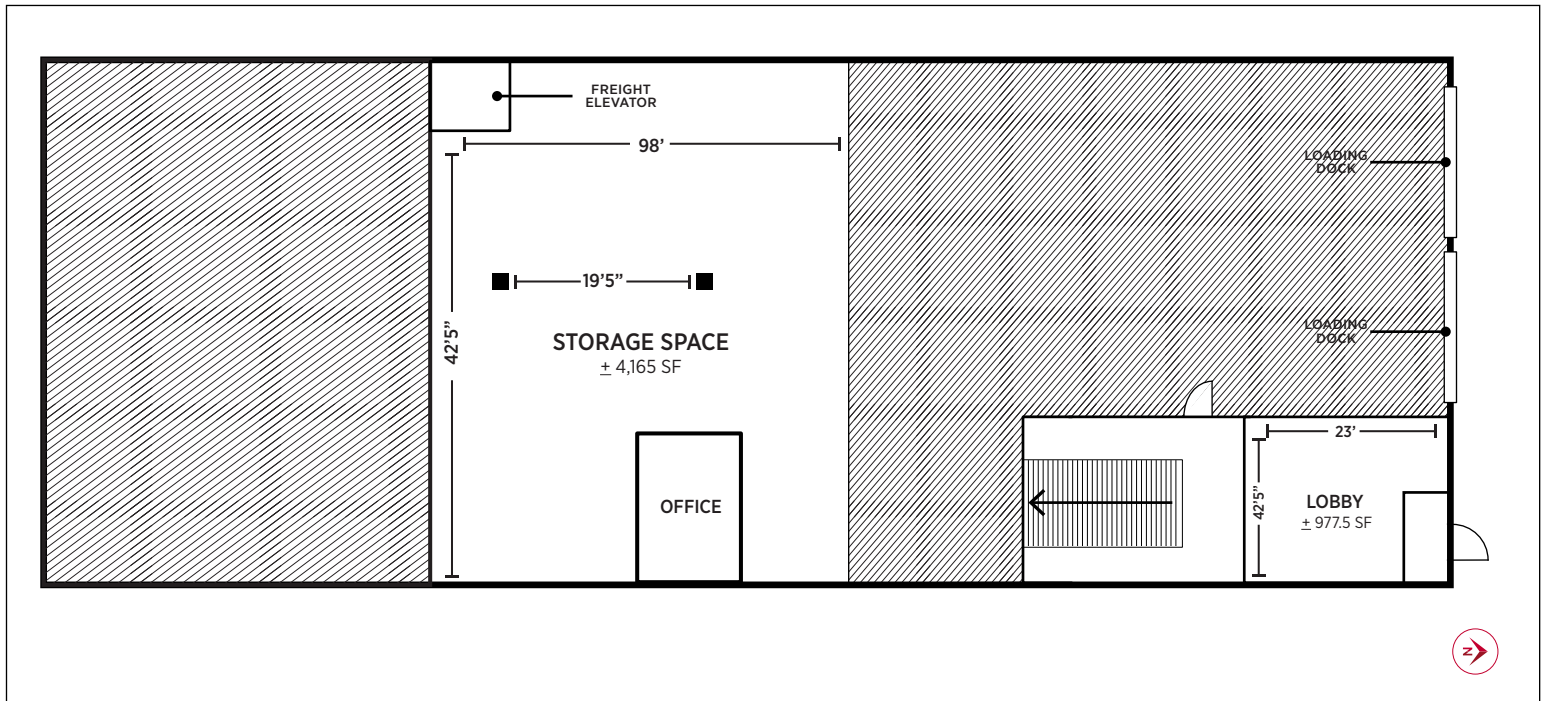

SECOND FLOOR PLAN

