

5035 BRANDIN COURT | FREMONT, CA

15,000± SF WAREHOUSE DISTRIBUTION SPACE AVAILABLE FOR LEASE



CONTACT EXCLUSIVE AGENTS:

FEATURES:

ANDREW STODDARD

astoddard@lee-associates.com

510.903.7618

LIC# 01844721

GARRETT DREW

gdrew@lee-associates.com

510.903.7613

LIC# 01923730

- **AVAILABLE:** 15,000± Square Feet
- **OFFICE AREA:** 2,000± SF, 4 Privates, Conference Room, Restrooms
- **LOADING:** 1 Dock Door & 1 Grade Level Door
- **CLEAR HEIGHT:** 20' Warehouse
- **SPRINKLERS:** .33/2,000 SF
- **PARKING:** 2/1000
- **LEASE RATE:** \$0.90 NNN + \$0.27 PSF Operating Expenses
- Excellent Freeway Visibility, Easy Access To I-880/I-680 Via Automall Parkway. Close Proximity To Tesla, LAM Research, Thermo Fisher, Scientific and Seagate Facilities



COMMERCIAL REAL ESTATE SERVICES

The information contained herein is based on estimates and assumptions and is presented for illustration purposes only. No representations, warranties or guarantees of any kind are made.

5035 BRANDIN COURT | FREMONT, CA

15,000± SF WAREHOUSE DISTRIBUTION SPACE AVAILABLE FOR LEASE

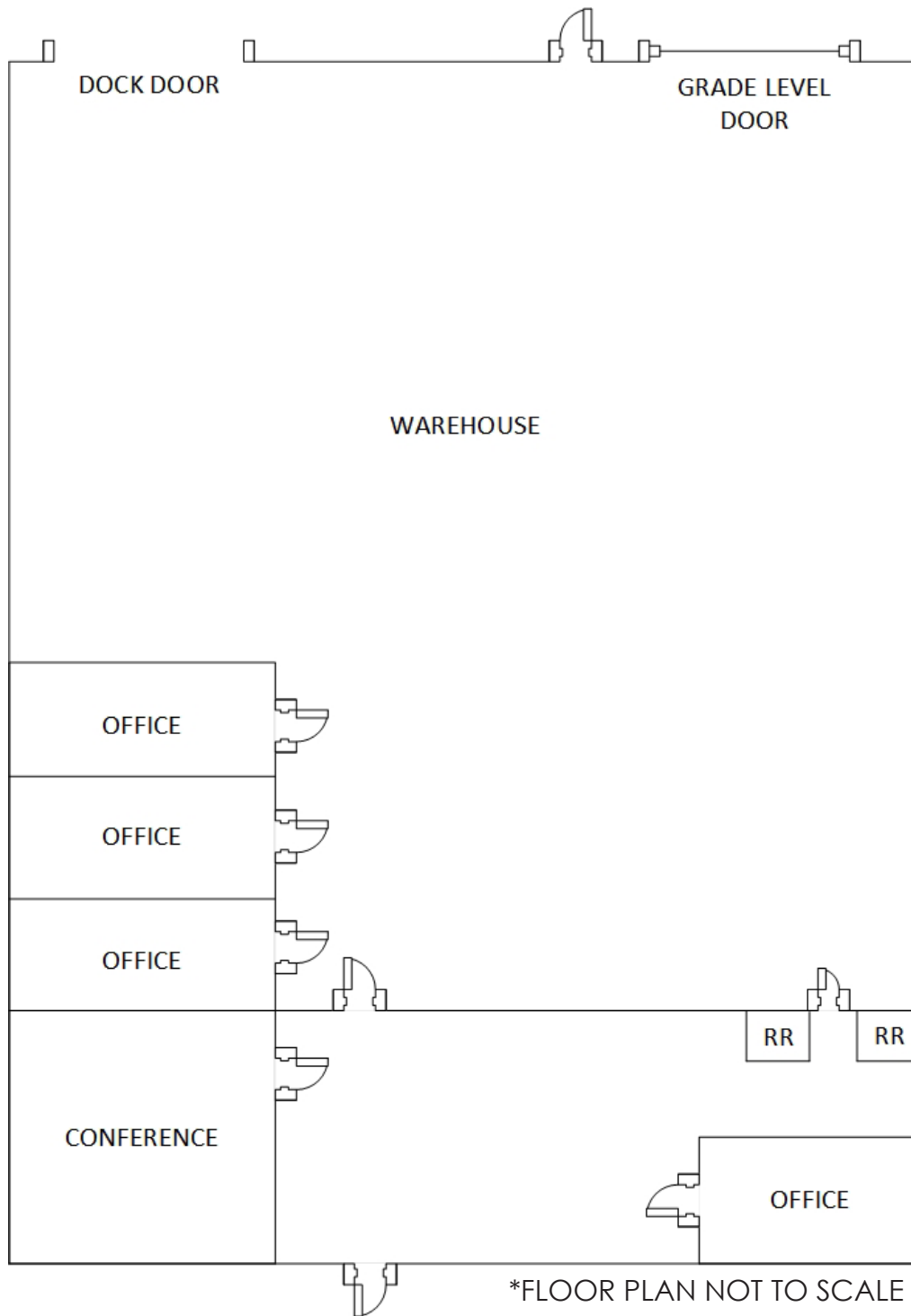

ANDREW STODDARD
astoddard@lee-associates.com

510.903.7618

LIC# 01844721



GARRETT DREW
gdrew@lee-associates.com

510.903.7613

LIC# 01923730

5035 BRANDIN COURT | FREMONT, CA

15,000± SF WAREHOUSE DISTRIBUTION SPACE AVAILABLE FOR LEASE

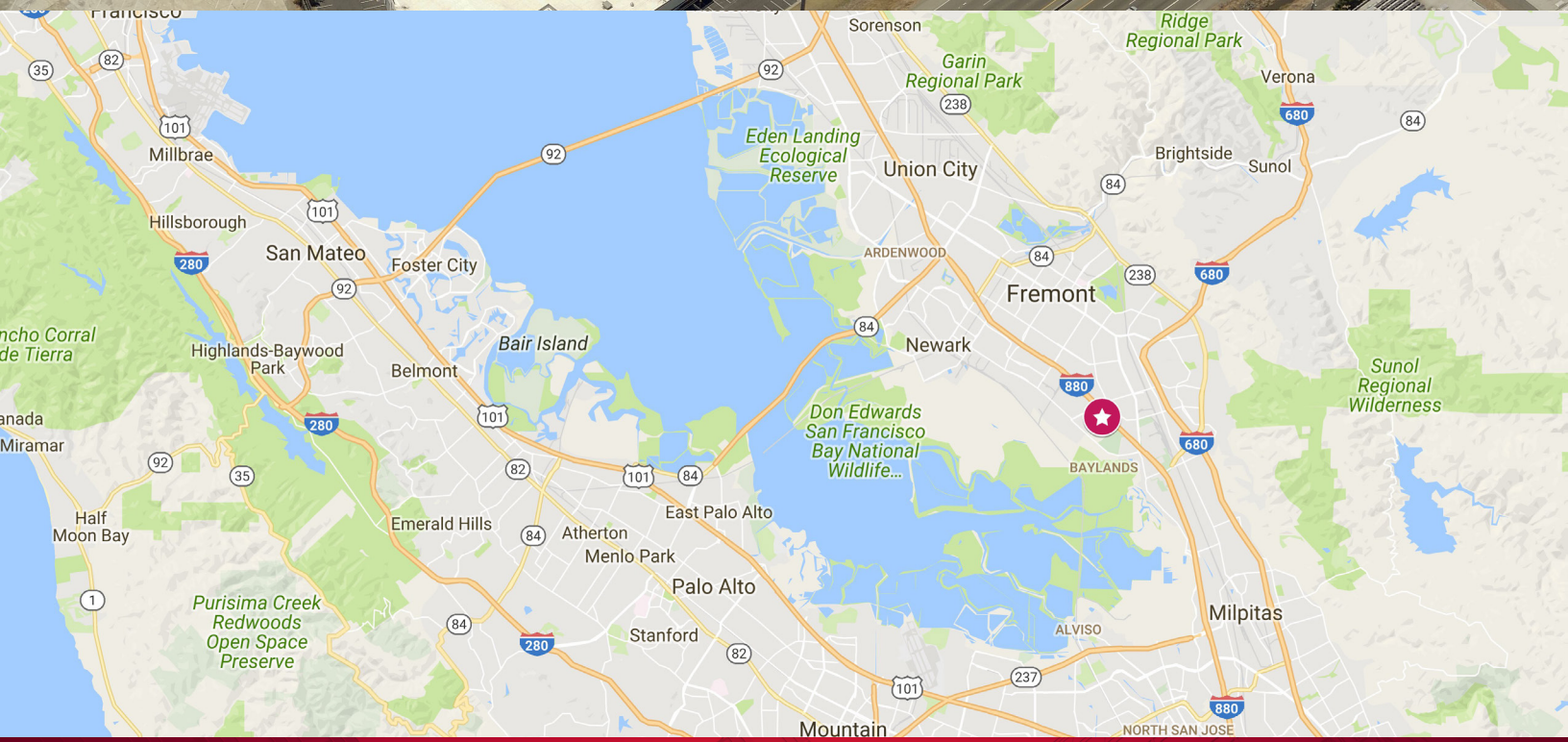

ANDREW STODDARD
astoddard@lee-associates.com
510.903.7618
LIC# 01844721



GARRETT DREW
gdrew@lee-associates.com
510.903.7613
LIC# 01923730